

AIR CONDITIONER SAFETY

You safety and the safety of others are very important.

We have provided many important safety messages in this manual and on your appliance. Always read and obey all safety messages.



This is the safety alert symbol. This symbol alerts you to potential hazards that can kill or hurt you and others. All safety messages will follow the safety alert symbol and either the word "DANGER" or "WARNING". These words mean:

DANGER

You can be killed or seriously injured if you don't immediately follow instructions.

WARNING

You can be killed or seriously injured if you don't follow instructions.

All safety messages will tell you what the potential hazard is, tell you how to reduce the chance of injury, and tell you what can

IMPORTANT SAFETY INSTRUCTIONS

- WARNING:** To reduce the risk of fire, electrical shock or injury when using your air conditioner, follow these basic precautions:
- Plug into a grounded 3 prong outlet.
 - Do not use an extension cord.
 - Do not remove ground prong.
 - Do not use an adapter.
 - Do not use or remove ground prong.
 - Unplug air conditioner before servicing.
 - Use two or more people to move and install air conditioner.

SAVE THESE INSTRUCTIONS

DISPOSING OF THE UNIT

- Before throwing the device, it is necessary to pull back the battery cells and get rid of them safely for recycling reasons.
- When you need to disposal of the unit consult our dealer. If pipes are removed incorrectly, refrigerant may blow out and come into contact with your skin, causing injury. Releasing refrigerant into the atmosphere also damages the environments.
- please recycle or dispose of the packaging material for product in an environmentally responsible manner.
- Never store or ship the air conditioner upside down or sideways to avoid damage to the compressor.
- This appliance is not intended for use by persons (including children) with reduced physical, sensory or mental capabilities, or lack of experience and knowledge, unless they have been given supervision or instruction concerning use of the appliance by a person responsible for their safety.
- Children should be supervised to ensure that they do not play with the appliance.
- The wiring diagram is shown at nameplate on the air conditioner.



WARNING Risk of Fire or Explosion. This unit contains flammable refrigerant. Additional safety precautions must be followed.

- Do not use means to accelerate the defrosting process or to clean, other than those recommended by the manufacturer.
- When handling, installing, and operating the appliance, care should be taken to avoid damage to the refrigerant tubing.
- The appliance shall be stored in a room without continuously operating ignition sources (for example: open flames, an operating gas appliance or an operating electric heater).
- Do not pierce or burn refrigerant tubing. Be aware that refrigerants may not contain an odor.
- Keep ventilation openings clear of obstruction.
- The maximum refrigerant charge amount is shown at nameplate on the air conditioner.
- Do not drill holes in the unit.
- Maintenance, cleaning, and service should only be performed by technicians properly trained and qualified in the use of flammable refrigerants.
- Dispose of air conditioner in accordance with Federal and Local Regulations. Flammable refrigerants require special disposal procedures. Contact a service center. The appliance shall be stored so as to prevent mechanical damage from occurring.

INSTALLATION REQUIREMENTS

Electrical Requirements

WARNING



Electrical Shock Hazard

Plug into a grounded 3 prong outlet. Do not remove ground prong. Do not use an adapter. Do not use an extension cord. Failure to follow these instructions can result in death, fire, or electrical shock.

Recommended Grounding Method

This air conditioner must be grounded. This air conditioner is equipped with a power supply cord with a three-prong grounding plug. The cord must be plugged into a mating, grounded three-prong outlet, grounded in accordance with all local codes and ordinances. If a mating outlet is not available, it is the customer's responsibility to have a properly grounded three-prong outlet installed by a qualified electrical installer.

Wiring requirement

Power supply	Model	Time-delay fuse (or circuit breaker)
208/230V 187.2V min. 253V max.	12K BTU cooling&heating	18A
	18K BTU cooling only	15A
	18K BTU cooling&heating	20A
	24K BTU cooling only	
	24K BTU cooling&heating	

Power Supply Cord

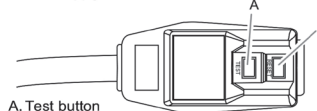

A. Test button
B. Reset button

NOTE:

Your air conditioner's device may differ from the one shown. This room air conditioner is equipped with a power supply cord required by UL. This power supply cord contains state-of-the-art electronics that sense leakage current and power will be disconnected in a fraction of a second.

To test your power supply cord:

- Plug power supply cord into a grounded 3 prong outlet.
- Press RESET (on some devices, a green light will turn on).
- Press TEST (listen for click; Reset button will trip, and on some devices, a green light will turn off).
- Press and release RESET (listen for click; Reset button will latch, and on some devices, a green light will turn on). The power supply cord is ready for operation.

NOTE:

- The Reset button must be pushed in for proper operation.
- The power supply cord must be replaced if it fails to trip when the test button is pressed or fails to reset.
- Do not use the power supply cord as an on/off switch. The power supply cord is designed as a protective device.
- A damaged power supply cord must be replaced with a new power supply cord obtained from the product manufacturer and must not be repaired.
- The power supply cord contains no user serviceable parts. Opening the tamper-resistant case voids all warranty and performance claims.

Tools and Parts

Gather the required tools and parts before starting installation. Read and follow the instructions with any tools listed here.

Tools needed (Not Included)

- Phillips screwdriver
- Tape measure
- Scissors
- Cordless drill and 1/8" bit
- Level
- Pencil

Parts supplied

Check that all parts are included in parts package.

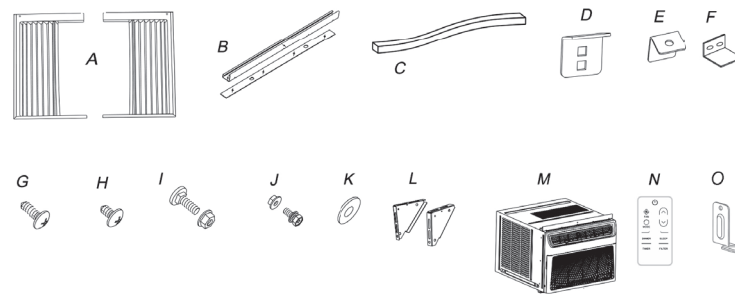

• Accessory type and quantity may vary depending on the model.

- A. Side curtains
- B. Top rail and PE foam seal
- C. Adhesive seal
- D. Angle Brackets
- E. Lock frame (for Vinyl-Clad windows)
- F. Gash lock
- G. 3/4" screws
- H. 1/4" screws
- I. 3/4" Long Flat Head Bolt and Locknut
- J. 1/2" Long Bolt and Locknut
- K. Washer
- L. Left and Right Support Brackets
- M. Air conditioner
- N. Remote control
- O. Lock frame

NOTE:

The F. Baffle is not provided for 12K BTU cooling and heating model. The R.Lock frame is only provided for 12K BTU cooling and heating model. The G.EVA Foam is only provided for E-star models, with E-star LOGO on the control panel.

Unpack the Air Conditioner

WARNING

Excessive Weight Hazard

Use two or more people to move and install air conditioner. Failure to do so can result in back or other injury.

Remove packaging materials

- Remove and dispose of/recycle packaging materials. Remove tape and glue residue from surfaces before turning on the air conditioner. Rub a small amount of liquid dish soap over the adhesive with your fingers. Wipe with warm water and dry.
- Do not use sharp instruments, rubbing alcohol, flammable fluids, or abrasive cleaners to remove tape or glue. These products can damage the surface of your air conditioner.
- Handle the air conditioner gently.
- Remove top rail from the packaging material.

Location Requirements

Before You Begin

Read these instructions completely and carefully.

- IMPORTANT:** Save these instructions for local inspector's use.
- IMPORTANT:** Observe all governing codes and ordinances.
- Note to Installer: Be sure to leave these instructions with the consumer.
- Note to Consumer: Keep these instructions for future reference.
- Skill level: Installation of this appliance requires basic mechanical skills.
- Completion time: Approximately 1 hour.
- We recommend that two people install this product.
- Proper installation is the responsibility of the installer.
- Product failure due to improper installation is not covered under the Warranty.
- You MUST use all supplied parts and use proper installation procedures as described in these instructions when installing this air conditioner.

IMPORTANT: Observe all governing codes and ordinances. Check the location where air conditioner will be installed. Proper installation is your responsibility. Make sure you have everything necessary for correct installation.

The location should provide:

- Do not use an extension cord. The appliance shall be installed in accordance with national wiring regulations.
- Free movement of air in room to be cooled.
- A large enough opening for the air conditioner.

NOTE: Cabinet louvers must not be obstructed. Air must be able to pass through the cabinet louvers freely.

Cooling and Heating models without Cabinet louvers on top

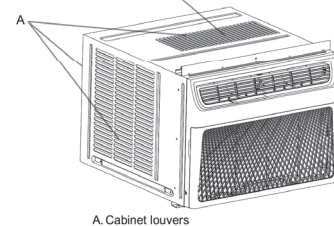

A. Cabinet louvers

• The images shown here are for illustrative purposes only and may be subject to change.

Window Installation

Window opening measurements: These instructions are for a standard double-hung window. You will need to modify them for other types of windows. The air conditioner can be installed without the side curtain panels if needed to fit in a narrow window. See the window opening dimensions. All supporting parts must be secured to firm wood, masonry or metal. The electrical outlet must be within reach of the power cord. Follow the dimensions in the table and illustration for your model

Models	A	B
12K BTU	17" (432mm) min	27" (686mm) - 41" (1041mm)
18K BTU	18 1/2" (470mm) min	29 3/5" (752mm) - 42 1/10" (1069mm)
24K BTU	19 1/10" (485mm) min	32 2/5" (823mm) - 44" (1118mm)

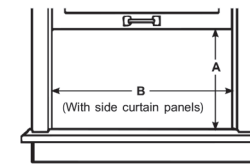

(With side curtain panels)

If AC is Blocked by Storm Window

Add wood as shown, or remove storm window before air conditioner is installed. If storm window frame must remain, be sure the drain holes or slots are not caulked or painted shut. Accumulated rain water or condensation must be allowed to drain out.

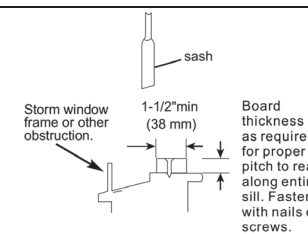

Board thickness as required, for proper pitch to rear, along entire sill. Fasten with nails or screws.

Prepare Air Conditioner for Installation

Remove Air Conditioner from Cabinet

NOTE: Remove any packaging material from cabinet exterior.

- Locate the two Front Panel screws and remove. These screws will be needed to re-install the Front Panel later.
- Push metal cabinet side inward to release plastic tabs on each side of Front Panel.

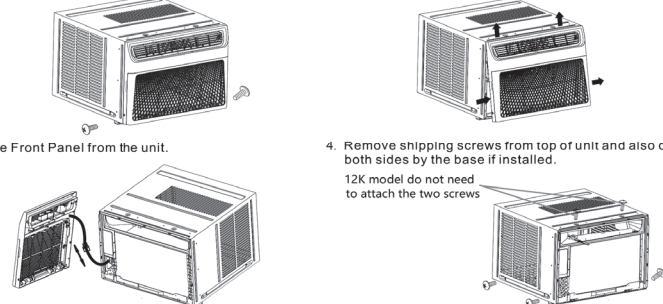

3. Remove Front Panel from the unit.

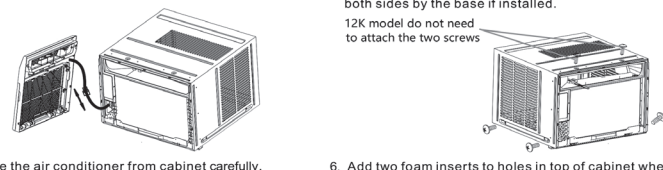

5. Remove the air conditioner from cabinet carefully.



Install Top Angle Rail and Side Retainers

- Remove adhesive strip coating from foam gasket. Attach adhesive side of gasket to bottom of top angle rail. Insert 4 screws from inside of cabinet and secure to top angle rail.
- From inside of cabinet insert 3 screws to attach each side baffle as shown. Attach side baffles with flat side against cabinet and angled edge toward rear of cabinet.

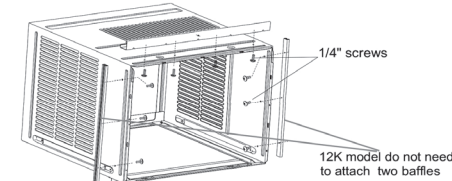

Window Air Conditioner Installation

Install Side Curtains

- Place cabinet on the floor, a bench, or a table.
- Slide "D" section at the end of side curtain into side retainer on each side of the cabinet.
- On each side of cabinet, insert the curtain housing into channel in the top and bottom angle rails.

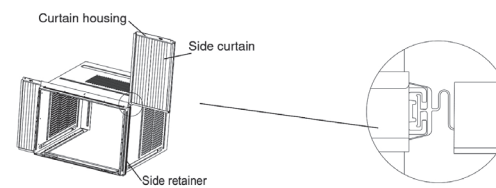

• The images shown here are for illustrative purposes only and may be subject to change.

Place Cabinet in Window

- Open the window and mark the center of window inner sill as shown. Cut the adhesive seal to the width of the lower window sash. Remove the backing from the seal and attach the seal to the bottom of the lower window sash.
- Place cabinet in window with cabinet bracket securely seated over the edge of inner sill as shown in . Bring window down temporarily behind top angle rail to hold cabinet in place.

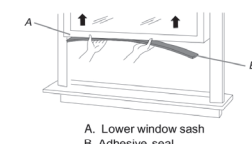

A. Lower window sash
B. Adhesive seal

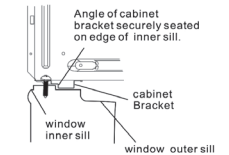

Angle of cabinet bracket securely seated on edge of inner sill.
cabinet Bracket
window inner sill
window outer sill

- Shift cabinet left or right as needed to line up center of cabinet on center line marked on inner sill. For wooden window: Fasten cabinet to window inner sill with two 3/4" long hex head screws into holes (You may wish to pre-drill pilot holes).

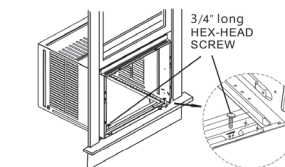

3/4" long HEX-HEAD SCREW

- For Vinyl-Clad window: Place two safety locks into the holes located in the bottom of the cabinet and drive two 3/4" pan-head Phillips locking screws through the safety locks into the cabinet as shown.

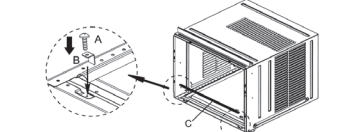

A. 3/4" screws
B. Safety Lock (Only for Vinyl-Clad Window)
C. Bottom Rail Foam Seal

- Remove protective strip from adhesive side of Bottom Rail Foam Seal Apply Seal over screws fastening bottom rail to window inner sill.

Install Support Bracket

- Hold each support bracket flush against outside of sill and tight to bottom of cabinet. Mark brackets at top level of sill. Mark cabinet bottom at distance of sill width. Remove support brackets.
- Attach sill angle brackets to support brackets at marked positions with flat head bolts and nuts. Hand tighten only at this point.

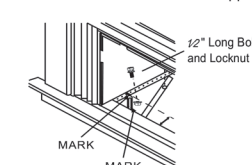

1/2" Long Bolt and Locknut (4)
MARK
MARK

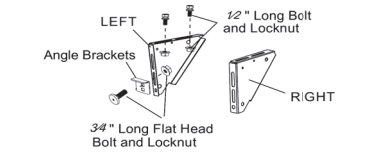

LEFT
RIGHT
1/2" Long Bolt and Locknut
3/4" Long Flat Head Bolt and Locknut

- Insert 1/2" long bolts through appropriate holes in cabinet bottom given the sill width distance. Thread the bolts into the slots of the support brackets. Tighten lock washer nuts onto bolts.

- Place the frame lock between the base and the cabinet sill with 1/4" (6,5mm) screw as shown.

NOTE: This lock frame is only provided for 12K BTU model.

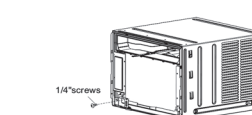

1/4" screws

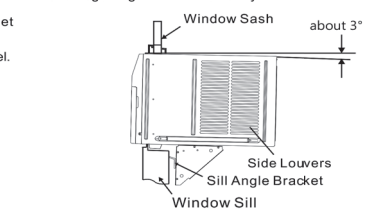

Window Sash about 3"
Side Louvers
Sill Angle Bracket
Window Sill

Attach The Top Rail To Window

- Close window behind top angle rail.
- Attach the top angle rail to window frame: Use a drill bit to drill one hole through the hole in the middle of top angle rail into the window frame, and drive one 3/4" locking screw through the hole in the middle of top angle rail into the window frame as shown.

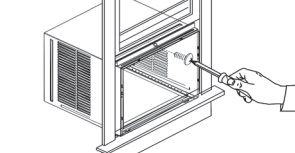

Attach Side Curtains to Window

- Pull the left-hand curtain out until it fits into the window channel.
- Use a 1/8"(3mm) drill bit to drill a starter hole through the hole in the top rail.
- Insert one of the 3/4"(20mm) screws through the left-hand curtain and into the window sash.



A. Window sash
B. Hole in side curtain
C. 3/4" screw

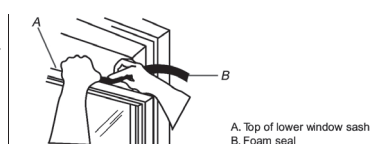

A. Top of lower window sash
B. Foam seal

Install Window Sash Seal and Safety Lock

- Insert foam seal behind the top of the lower window sash and against the glass of the upper window.
- Attach right angle safety lock to top window sash as shown.
- If necessary, trim weather seals to needed length, peel off protective backing, and use to plug any gaps.

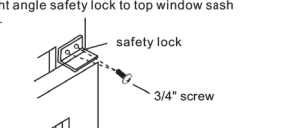

safety lock
3/4" screw

Install Air Conditioner into Cabinet and Install Front Panel to Unit

- Lift air conditioner and slide into cabinet carefully.
- CAUTION:** Do not push on controls or finned coils.
- Be sure air conditioner is firmly seated towards rear of cabinet.
- Reconnect electronics plug if present. Position vent control lever so that it will thread into its channel in the front panel. Hook front panel top tabs into slots on cabinet top, and rotate front panel down so that side tabs snap into place on cabinet. Insert 4 previously removed screws through front panel and into air conditioner.
- Insert air conditioner filter. Reinstall the front grille by hooking bottom tabs into slots on Front Panelbottom, then rotate grille up to snap into place.

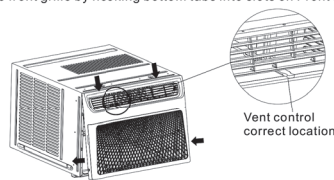

Complete Installation

- Plug into a grounded 3 prong outlet.
- Press **RESET** on the power supply cord. See "Electrical Requirements".

Electrical Shock Hazard

Plug into a grounded 3 prong outlet. Do not use an extension cord. Do not remove ground prong. Do not use an adapter.

Failure to follow these instructions can result in death, fire, or electrical shock.

AIR CONDITIONER USE

Operating your air conditioner properly helps you to obtain the best possible results. This section explains proper air conditioner operation.

- IMPORTANT:**
- If you turn off the air conditioner, wait at least 3 minutes before turning it back on. This prevents the air conditioner from blowing a fuse or tripping a circuit breaker.

- Air conditioner in the Cool mode operation the better limits: Outdoor side 64.4-109.4°F (18-43 °C), ≤80%RH; indoor side 62.6-89.6°F (17-32°C), ≤80%RH.
- Air conditioner in the Heat mode operation the better limits: Outdoor side 19.4-75.2°F (-7-24 °C), ≤80%RH; indoor side 32-80.6°F (0-27°C), ≤80%RH.

NOTE: In the event of a power failure, your air conditioner will operate at the previous settings when the power is restored.

Starting Your Air Conditioner



NOTE: The images shown here are for illustrative purposes only and may be subject to change, the actual descriptions of control panel and their locations may vary depending on the model.

- ON/OFF**
- Press the power button to turn on the air conditioner.
- ON/OFF**
- NOTE:** When the air conditioner is turned on for the first time after it is plugged in, the display will show the current set temperature and will run in the ECO control. After cleaning and replacing the filter, press the **POWER** button for resetting and the **FILTER** light will go off.
 - Select mode. See "Mode".
 - Select fan speed. See "Fan".
 - Set temperature. See "Temperature".

- Mode**
- Press **MODE** repeatedly until you see the indicator light glow for the desired setting.
 - Choose Fan, Dry, Cool, Eco, or Heat.
 - FAN** - To select Fan Only mode.
 - Dry** - Dries the room. The air conditioner automatically selects the temperature. Fan runs at Low speed only.
 - Cool** - Cools the room.
 - Eco** - Cools the room and save energy.
 - Heat** - Heats the room.

NOTE: Heat is available only for heating models.
NOTE: Dry mode should not be used to cool the room.
NOTE: Select **ECO** mode to initiate this function. For E-star models, the fan will continue to run after the compressor shuts off for 2 minutes (4 minutes for the first time), then the fan will shut off for 10 minutes. The fan then cycles run for 2 minutes and 10 minutes off intervals until the room temperature is above the set temperature, at which time the compressor turns back on and Cooling resumes.

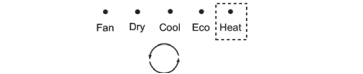

- Temperature**
- Press the plus UP (▲) button to raise the temperature. Each time you press or hold the plus UP (▲) button, the temperature will go up 1°F (1°C) until it reaches 86°F (30°C).

- Press the minus DOWN (▼) button to lower the temperature. Each time you press or hold the DOWN (▼) button, the temperature will go down 1°F (1°C) until it reaches 61°F (16°C). To change the temperature display from °F to °C: Press both the **MODE** and **DOWN (▼)** buttons at the same time for 5 seconds to switch the display from °F to °C.

- Fan**
- NOTE:** The Fan button will operate only when the Cool, Fan, ECO or heat mode has been selected.
- Press **FAN** until you see the indicator light glow for the desired setting.
 - Choose High, Med, Low.
 - High** - for maximum cooling
 - Med** - for normal cooling
 - Low** - for quieter cooling
- NOTE:** In ECO mode, the Fan will run at low speed when compressor turn off.

- Timer Sleep Filter**
- The LED light on control panel for Timer, Sleep, Filter.
 - The function introduction see "using the remote control".

WiFi

WiFi control is available for connected models with this logo on control panel.

- Press the **CONNECT** button for 5s, the LED starts to flash.
 - After the WiFi module connecting the router, the LED keeps on. Or the LED keeps off.
- NOTE:** WiFi control is available only for WiFi control models.

Using the Remote Control

NOTE: Remote control may differ in appearance.

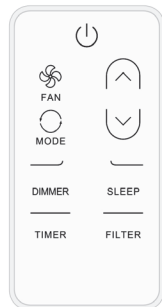

- NOTE:**
- When the first use, please remove the insulated plastic patch.
 - One CR2025 battery (included) powers the remote control. Replace battery after 6 months of use, or when the remote control starts to lose power.
 - Please ensure the correct direction for polarity of the cell same as the indicator on the bracket.
 - Disposal of battery** old batteries must be removed and disposed of in accordance with current legislation as they are harmful to the environment.

Power

Press power button to turn on/off air conditioner.

Fan

Press **FAN** to select High, Med, Low.

NOTE: In Dry mode, Fan speed cannot be set.

Mode

Press **MODE** to select Fan, Dry, Cool, ECO.

- Temperature**
- Press the plus UP (▲) button to raise the temperature. Each time you press or hold the plus UP (▲) button, the temperature will go up 1°F (1°C) until it reaches 86°F (30°C).
 - Press the minus DOWN (▼) button to lower the temperature. Each time you press or hold the DOWN (▼) button, the temperature will go down 1°F (1°C) until it reaches 61°F (16°C).

Changing Air Direction

Use the Vertical Level Vane to direct the air right or left. Use the whole cartridge to direct air up, down or straight ahead.

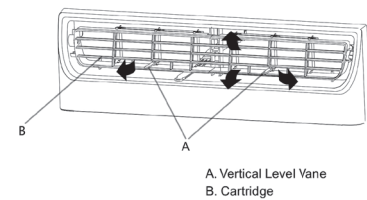

Exhaust Air Vent

- Pull out the exhaust air vent control to Open the exhaust air vent and draw stale or smoky air from the room.
- Push in the exhaust air vent control to close the exhaust air vent for maximum continuous cooling.

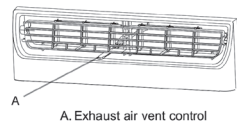

NOTE: The exhaust air vent control will function only when the fan is running.

DIMMER

Press the **DIMMER** button to turn off the control panel display.

NOTE: When in **DIMMER** mode, new control inputs will return display to normal.

Sleep

NOTES: When you press sleep button

- In the Cooling mode, Dry mode, ECO mode, the set temperature will increase by 4°F(2°C) at most, during 2 hours, and continues running at that temperature until auto shut off.
- In Heating mode, the set temperature will decrease by 4°F(2°C) at most, during 2 hours, and continues running at that temperature until auto shut off.

- Press **MODE** to select Cool, Dry or ECO
- Press **FAN** to select High, Med or Low.
- Press the up or down arrow button to set the temperature.
- Press **SLEEP**. After 10 seconds, the lights on the control panel display will dim.

NOTE: The mode and temperature may be adjusted during Sleep control. Fan speed is automatically set to LOW.

SLEEP

- To turn off Sleep control, press **SLEEP** again, or wait 8 hours for the air conditioner to turn off automatically.

NOTE: The air conditioner will return to previous settings after Sleep control is turned off.

Timer

To set timer for a 1-24 hour delay on-off operation:

- Press **TIMER** on remote control, LED display on the air conditioner control panel will flash.

- TIMER**
- Press up or down arrow button to change the delay time from 1 hour to 24 hours.
 - Press **TIMER** on remote control again for **TIMER** confirmation and **TIMER** indicator light on the air conditioner control will be on
 - To cancel the **TIMER**, press the **TIMER** on remote and the **TIMER** indicator light will be off.

Filter

- When the Filter indicator light is lit, remove, clean and replace the air filter. See "Cleaning the Air Filter".
- Press Power button on the machine, or **FILTER** button on remote to reset the filter, after cleaning and replacing the air filter.

NOTE: When the light is on, it will remain on for 180 hours or until you press Clean Filter button.

NOTE: The remote control vary depend of model: The buttons on the remote control may have a different name or location than the remote control shows in this manual.

Normal Sounds

When your air conditioner is operating normally, you may hear sounds such as:

- Droplets of water hitting the condenser, causing a pinging or clicking sound. The water droplets help cool the condenser.
- Air movement from the fan.

- Clicks from the thermostat cycle.
- Vibrations or noise due to poor wall or window construction.
- A high-pitched hum or pulsating noise caused by the modern high-efficiency compressor cycling on and off.

AIR CONDITIONER CARE

Your new air conditioner is designed to give you many years of dependable service. This section tells you how to clean and care for your air conditioner properly. Contact a service center.

Cleaning the Air Filter

The air filter is removable for easy cleaning. A clean filter helps remove dust, lint, and other particles from the air and is important for best cooling and operating efficiency. Check the filter every 2 weeks to see whether it needs cleaning.

- NOTE:** Do not operate the air conditioner without the filter in place.
- Turn off the air conditioner.
 - Open the front panel. Grasp the filter by the handle and pull it out.

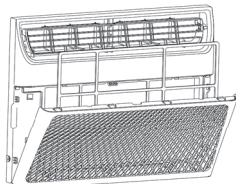

Cleaning the Front Panel

- Turn off the air conditioner.
- Clean the front panel with a soft, damp cloth.
- Air dry the front panel completely.

Repairing Paint Damage

Check once or twice a year for paint damage. This is very important, especially in areas near oceans or where rust is a problem. If needed, touch up with a good grade enamel paint.

Annual Maintenance

Your air conditioner needs annual maintenance to help ensure steady, top performance throughout the year. Call your local authorized dealer to schedule an annual checkup. The expense of an annual inspection is your responsibility.

REMOVING AC FROM WINDOW

- Turn AC off, and disconnect power cord.
- Remove the Front Panel.
- Slide the unit out from cabinet and put the unit down.
- Remove sash seal from between windows, and unscrew safety lock.
- Remove screws installed through frame and frame lock.
- Close the curtain housing.
- Keeping a firm grip on cabinet, raise sash and carefully remove.
- Lift cabinet from window and slide the unit into it.
- Assemble the front panel back. Store parts with the AC.

TROUBLESHOOTING

Before calling for service, try the suggestions below to see whether you can solve your problem without outside help.

Air conditioner does not operate

Electrical Shock Hazard

Plug into a grounded 3 prong outlet. Do not remove ground prong. Do not use an adapter. Do not use an extension cord. Failure to follow these instructions can result in death, fire, or electrical shock.

- The power supply cord is unplugged. Plug into grounded 3 prong outlet. See "Electrical Requirements".
- The power supply cord has tripped (Reset button has popped out). Press and release **RESET** (listen for click; Reset button will latch and on some devices, a green light will turn on) to resume operation.
- A household fuse has blown, or circuit breaker has tripped. Replace the fuse or reset the circuit breaker. If the problem continues, call an electrician. See "Electrical Requirements".
- The Power button has not been pressed. Press the Power button.
- The local power has failed. Wait for power to be restored.

Air conditioner blows fuses or trips circuit breakers

- Too many appliances are being used on the same circuit. Unplug or relocate appliances that share the same circuit.
- Time-delay fuse or circuit breaker of the wrong capacity is being used. Replace with a time-delay fuse or circuit breaker of the correct capacity. See "Electrical Requirements".
- An extension cord is being used. Do not use an extension cord with this or any other appliance.
- You are trying to restart the air conditioner too soon after turning off the air conditioner. Wait at least 3 minutes after turning off the air conditioner before trying to restart the air conditioner.

Air conditioner power supply cord trips (Reset button pops out)

- Disturbances in your electrical current can trip (Reset button will pop out) the power supply cord. Press and release **RESET** (listen for click; Reset button will latch and on some devices, a green light will turn on) to resume operation.

Water drips from the rear of the unit

- You see water dripping from the rear of the unit. Water may be collected in the base pan in highly humid conditions or on rainy days. This water overflows and drips from the rear of the unit.

Water drips from cabinet into your house

- The air conditioner is not properly leveled. The air conditioner should slope slightly downward toward the outside. Level the air conditioner to provide a downward slope toward the outside to ensure proper drainage. See the Installation Instructions.
- NOTE:** Do not drill a hole in the bottom of the metal base and condensate pan.

REFURBISHED PRODUCT LIMITED THIRTY DAY WARRANTY

The **Refurbished Product Service Center** offers the following WARRANTY to the ORIGINAL purchaser of a product which we have refurbished.

This product that has been refurbished is warranted against any electronic or mechanical defects for a period of THIRTY DAYS from the date of the original purchase by the consumer. Since this unit was sold as a refurbished item, the warranty does not apply to any cosmetic appearance items such as scratches. Should a defect occur, the **Refurbished Product Service Center** will repair or, at its option, replace defective unit/parts with new or rebuilt materials without charge for either parts or labor. Replacement unit/parts will be warranted for the remaining portion of the original warranty period.

This warranty does not cover installation or damage from accident, misuse, abuse, improper wiring, incorrect voltage, operating the unit against the instructions in the owner's manual or any product which has been opened, altered, or tampered with.

This warranty does not cover costs for removal and or installation of the unit for repair. Under no circumstances shall the service center be liable for any special, incidental or consequential damages or for any other expenses incurred by reason of use or sale of this product. This warranty is in lieu of any other warranties expressed or implied warranty of merchantability of fitness for particular use or otherwise.

This warranty gives the consumer specific legal rights and they may also have other rights which vary from State to State. Some States do not follow the exclusion or limitation of incidental or consequential damages, hence the above exclusion and limitations may not apply.

Refurbished Product Service Center
13225 Marquardt Avenue Santa Fe Springs, CA 90670
WARRANTY REPAIR INFORMATION

If you need service on your unit during the 30 day warranty period; please go to www.ConsumerServiceRefurbish.com or call the Refurbished Product Service Center at 562-946-3531 to obtain the required claim number. Once you obtain your claim number, pack the unit properly (the original carton is ideal for this purpose) along with a copy of your purchase receipt. Send the unit freight prepaid and insured to:

Refurbished Product Service Center,
Att: Customer Service Department 13225 Marquardt Avenue Santa Fe Springs, CA 90670

Your unit will be promptly exchanged and returned to you. We will refuse to accept delivery of the returned unit unless the assigned claim number appears on the outside of the shipping carton.

Owner's Information
 (Keep for your permanent records)

NAME: _____
 ADDRESS: _____
 CITY: _____ STATE: _____ ZIP CODE: _____
 PHONE: _____ E-MAIL: _____
 MODEL: _____ SERIAL NO.: _____

IMPORTANT INFORMATION

Do not drill holes in the product. Drilling holes in the product can cause the air conditioner to not function properly.

PRINTED IN MEXICO

Elbrd: J.M. / SC: 07-11-2024

OBPN: 4214834-01

SHDML: AW1221DR3W_B

ADD: AW1822CW3W_AW1822DR3W_

AW2422CW3W_AW2422DR3W

8 1 4 1 0 0 2 6 3

