

INSTRUCTION MANUAL

SKITAYON

AIR COOLER

(With Remote Control)

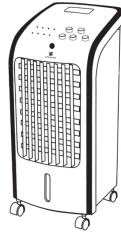

Please read these instructions carefully before operating this product.
The images shown in this manual are for illustrative purposes only.

WARNING

- Do not let the wind inlet be too close to the wall, curtains and so on, or it will block the air flow and affect the wind effect.
- Using it the first time, please check if your voltage is accord with the nameplate for air cooler.
- Before use, please check if the power cord and plug are breakage. Do not the power plug twisted and turned in order to avoid poor contact.
- If the power cord is damaged, contact service center.
- Do not cover the outlet and keep the air fan away from the socket. You must choose the socket which it is up to more than 10A current and don't use the same socket with other machine.
- When air cooler is working, absolutely forbid hand or foreign body inserting the network (especially pay attention to children)
- The appliance is not intended for use by persons (including children) with reduced physical, sensory or mental capability, or lack of experience and knowledge, unless they have been given supervision or instruction concerning use of the appliance by a person responsible for their safety.
- Children should be supervised to ensure that they do not play with the appliance.
- Please turn off the power before pulling out the plug. Do not pull the power cord and do pull the power plug in order to avoid a short-circuit, fire, electric shock.
- Do not pull the power plug by wet hand in order to avoid the risk of electric shock.
- Please pull the plug away from the socket when you do not use it.
- Please do not put the working air cooler on the declining position or not smooth position.
- Please do not work air cooler when it is outdoors or around bath (or shower, or pool).
- At any time, the water level display of water tank must be less than "Max." While the display of water level of water tank must be more than "Min." when air cooler is with cooling(humidifying) function.
- After water tank is injected fair water please not lean (or bump) air cooler when remove air cooler.
- Please do not put anything on air cooler.
- Mustn't cover the outlet and inlet of air cooler.

FUNCTION CONTROL PANEL

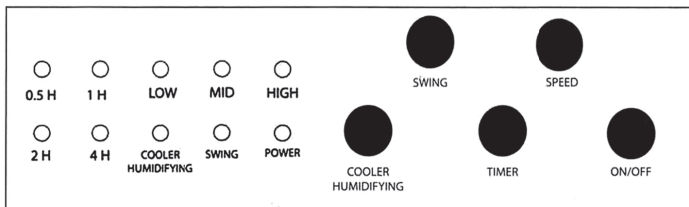

NOTE: The images shown here are for illustrative purposes only and may be subject to change, the actual descriptions of control panel and their locations may vary depending on the model.

1. ON/OFF (Speed) button

- After plug the power cord the buzzer responds a sound.
- Press the button the first time, the indicator "low" of control panel is working while air cooler is working with low speed.

- Press the button the second time, the indicator "Mid" of control panel is working while air cooler is working with medium speed.
- Press the button the third time, the indicator "High" of control panel is working while air cooler is working with high speed .
- Press the button the fourth time, air cooler is not working.

2. Cooler (Humidifying) button

- Press the button the first time when air cooler is working, the indicator "Cooler(red) " of control panel is working.
- Press the button the second time when air cooler is working, the indicator "Humidifying (blue) of control panel is working.
- Press the button the third time when air cooler is working, the indicator is not working while air cooler is not with cooling (humidifying) function.

3. Swing button

- Press the button the first time when air cooler is working , the indicator "Swing" is working while air filter is working .
- Press the button the second time when air cooler is working, the indicator "Swing" is not working while air filter is not working.

4. Timer button

- Press the button the first time when air cooler is working ,the indicator "0.5H" is working while air cooler is not working after 0.5 hour.
- Press the button the second time when air cooler is working, and the indicator "1H" is working and the indicator "0.5H" is not working ,and then air cooler is not working after 1 hour.
- Press the button the third time when air cooler is working , and the indicators "1H" and "0.5H" are working while air cooler is not working after 1 hour.
- Press the button the fourth time when air cooler is working , and the indicators "1H" and "2H" are working while the indicator "0.5H" is not working, and air cooler is not working after 2 hour.
- Press the button the fifth time when air cooler is working , and the indicators "2H" and "0.5H" are working while air cooler is not working after 2.5 hour.
- Press the button the sixth time when air cooler is working , and the indicators "1H" and "2H" are working while the indicator "0.5H" is not working, and air cooler is not working after 3 hour.
- Press the button the fifteen time according to the sequence and the indicators "4H" and "2H" and "1H" and "0.5H" are working while air cooler is not working after 7.5 hour.
- Press the button the sixteen time, air cooler is without timer function while all indicators for timer are not working.

REMOTE CONTROL

1. The remote control battery is CR2025 type. (Batteries not included)
2. You can store the remote control in the slot above the appliance

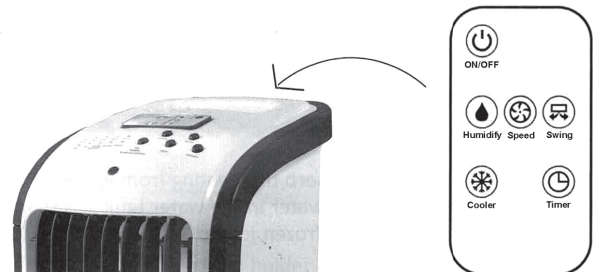

WARNING: WHEN NOT IN USE FOR A LONG PERIOD, THE PLUG MUST ALWAYS BE REMOVED FROM THE SOCKET.

NOTE: The remote control vary depend of model: The buttons on the remote control may have a different name or location than the remote control shows in this manual.

HOW TO INJECT WATER IN THE TANK

Pull out the water tank from the bottom of the back (air cooler), and leak 1/3 of water tank while inject fair water into it.

- Please note the display of water level when injecting water.
- The water level of water tank must be less than “max.” when injecting water.
- The water level of water tank must be more than “min.” when air cooler is with cooling and humidify.
- The frozen ice boxes (or ices) are put into water tank when the client want to get the cooler wind.

Warning:

The water level of water tank is less than “MAX” after ice boxes(or ices) is put water tank.

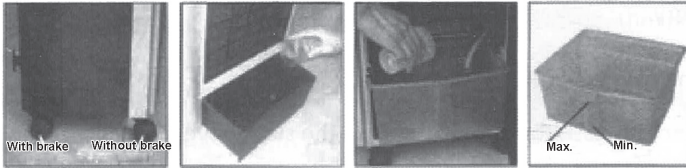

The image shown here is for illustrative purposes only and may be subject to change.

HOW TO USE ICE BOXES

Ice box can store cool and slowly absorb the heating from water while ice boxes can make the temperature of water in the water tank less than it of the surrounding. So Air cooler with frozen ice boxes can blow the cooler wind.

- Put ice boxes in fridge. After ice boxes are frozen successfully, take ice boxes out the fridge.
- Pull the water tank out, and put the frozen ice boxes into water tank.
- One piece air cooler is with two pieces ice boxes in order that the client can make them continuously.

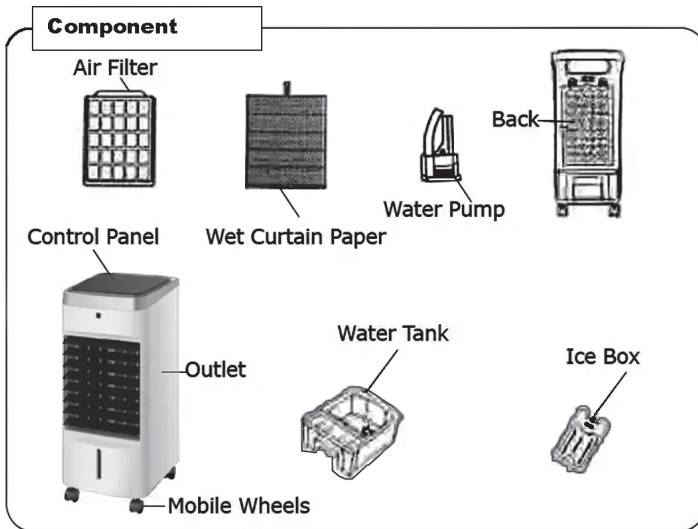

Accessory type and quantity may vary depending on the model.

HOW TO CLEAN

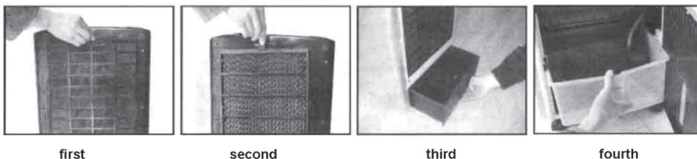

The image shown here is for illustrative purposes only and may be subject to change.

- Clean air filter:
Pull off the plug, and pull the holder of air filter by hand while the air filter is took apart .and then clean air filter by neutral cleaner and soft brush and then clean it by clean fair water, later take the air filter back air cooler.
- Clean the wet curtain paper:
Pull off the plug and take the air filter off and take the wet curtain paper out air cooler. And clean the wet curtain paper by fair water after clean it with cleaner and soft brush, later put back air cooler.

Important:

In order to avoid leak, wet curtain paper must be installed smoothly.

- Clean water tank:
Pull off the plug and take the water tank out while wipe off much scale in the water tank by towel with little cleaner, and then clean water tank by fair water, and later put back air cooler.
- Clean the housing:
Wipe off the housing by neutral cleaner and soft cloth.

NOTE: In order to ensure the highest possible standard for refurbished items, all units are thoroughly inspected as part of the process. For this item, water may be used during the refurbishing process and so; you may notice some condensation in the water reservoir. It is recommended to rinse the water reservoir with fresh water prior to its first use.

REFURBISHED PRODUCT LIMITED THIRTY DAY WARRANTY

The **Refurbished Product Service Center** offers the following WARRANTY to the ORIGINAL purchaser of a product which we have refurbished.

This product that has been refurbished is warranted against any electronic or mechanical defects for a period of THIRTY DAYS from the date of the original purchase by the consumer. Since this unit was sold as a refurbished item, the warranty does not apply to any cosmetic appearance items such as scratches. Should a defect occur, the **Refurbished Product Service Center** will repair or, at its option, replace defective unit/parts with new or rebuilt materials without charge for either parts or labor. Replacement unit/parts will be warranted for the remaining portion of the original warranty period.

This warranty does not cover installation or damage from accident, misuse, abuse, improper wiring, incorrect voltage, operating the unit against the instructions in the owner's manual or any product which has been opened, altered, or tampered with.

This warranty does not cover costs for removal and or installation of the unit for repair. Under no circumstances shall the service center be liable for any special, incidental or consequential damages or for any other expenses incurred by reason of use or sale of this product. This warranty is in lieu of any other warranties expressed or implied warranty of merchantability of fitness for particular use or otherwise.

This warranty gives the consumer specific legal rights and they may also have other rights which vary from State to State. Some States do not follow the exclusion or limitation of incidental or consequential damages, hence the above exclusion and limitations may not apply.

Refurbished Product Service Center
13225 Marquardt Avenue Santa Fe Springs, CA 90670

WARRANTY REPAIR INFORMATION

If you need service on your unit during the 30 day warranty period; please go to www.ConsumerServiceRefurbish.com or call the Refurbished Product Service Center at 562-946-3531 to obtain the required claim number. Once you obtain your claim number, pack the unit properly (the original carton is ideal for this purpose) along with a copy of your purchase receipt. Send the unit freight prepaid and insured to:

Refurbished Product Service Center,
Att: Customer Service Department 13225 Marquardt Avenue Santa Fe Springs, CA 90670

Your unit will be promptly exchanged and returned to you.
We will refuse to accept delivery of the returned unit unless the assigned claim number appears on the outside of the shipping carton.

Owner's Information
(Keep for your permanent records)

NAME: _____
ADDRESS: _____
CITY: _____ STATE: _____ ZIP CODE: _____
PHONE: _____ E-MAIL: _____
MODEL: _____ SERIAL NO.: _____

PRINTED IN MEXICO / Elbrd: J.M. / SC: 07 08-2024
OBPN: N/A / SHDML: BL168DLR