

Please read this manual carefully before operating your set and retain it for future reference. 804109988

READ THIS MANUAL

Inside you will find many helpful hints on how to use and maintain your air conditioner properly. Just a little preventive care on your part can save you a great deal of time and money over the life of your air conditioner. You'll find many answers to common problems in the chart of Troubleshooting Tips. If you review our chart of Troubleshooting Tips first, you may not need to call for service at all.

PRECAUTION

Contact a service center. The air conditioner is not intended for use by young children or invalids without supervision. Young children should be supervised to ensure that they do not play with the air conditioner. When the power cord is to be replaced, replacement work shall be performed by authorized personnel only using only genuine replacement parts. Installation work must be performed in accordance with the National Electric Code by qualified and authorized personnel only.

Safety Precautions

To prevent injury to the user or other people and property damage, the following instructions must be followed. Incorrect operation due to ignoring instruction will cause harm or damage. The seriousness is classified by the following indications.

WARNING This symbol indicates the possibility of death or serious injury.

CAUTION This symbol indicates the possibility of injury or damage to properties only.

Meanings of symbols used in this manual are as shown below.

	Be sure not to do.
	Be sure to follow the instruction.

WARNING

Installation

Don't use a power cord, a plug, or a loose socket which is damaged. Always plug into a grounded outlet. Do not modify or extend the power cord length.

Otherwise, it may cause a fire or electrical shock. Otherwise, it may cause a fire or electrical shock. It will cause electric shock or fire due to heat generation.



Do not disassemble or modify products. Be caution when unpacking and installing. Do not store flammables like gasoline, benzene, thinner, etc. near the air conditioner.

It may cause failure and electric shock. Sharp edges may cause injury. It may cause explosion or fire.



Operation

Do not place heavy object on the power cord and take care so that the cord should not be pressed. Do not share the outlet with other appliances. Take the power plug out if necessary, holding the head of the plug and do not touch it with wet hands.

There is danger of fire or electric shock. It will cause electric shock or fire due to heat generation. Otherwise, it may cause a fire or electrical shock.



Do not place the power cord near a heater. Do not allow water to run into electric parts. Use a soft cloth to clean. Do not use wax, thinner, or a strong detergent.

It may cause fire and electric shock. It will cause failure of machine or electric shock. The appearance of the air conditioner may deteriorate, change color, or develop surface flaws.



Unplug the unit if strange sounds, odors, or smoke come from it. Do not open the suction inlet grill of the product during operation. If water enters the product, turn off the power switch of the main body of appliance. Contact service center after taking the power-plug out from the socket.

Otherwise it may cause fire and electric shock accident. Otherwise, it may electrical shock and failure.



No correlation between fan usage and oxygen depletion. Turn off the power and breaker first when cleansing the unit. Unplug the unit when not using it for a long time.

An oxygen shortage may occur. Since the fan rotates at high speed during operation, it may cause injury. Prevent accidental startup and the possibility of injury.



Do not operate or stop the unit by inserting or pulling out the power plug. Do not damage or use an unspecified power cord. Do not operate with wet hands or in damp environment.

It will cause electric shock or fire due to heat generation. It will cause electric shock or fire. It will cause electric shock.



Hold the plug by the head (not the cable) when taking it out. When gas leaks, open the window for ventilation before operating the unit. Never touch the metal parts of the unit when removing the filter.

It may cause electric shock and damage. Otherwise, it may cause explosion, and a fire. They are sharp and may cause injury.



For inner cleaning, contact an Authorized Service Center or a dealer. Do not use harsh detergent that causes corrosion or damage on the unit. Harsh detergent may also cause failure of product, fire, or electric shock.

CAUTION

Installation

Install the product so the exhaust and noise are not aimed directly at the neighbors. Follow installation instructions exactly.

Be considerate. Otherwise, it may cause vibration or water leakage.



Operation

Do not use this appliance for special purposes such as cooling pets, foods, precision machinery, or objects of art. Do not block the inlet or outlet of air flow. Use a soft cloth to clean. Do not use wax, thinner, or a strong detergent.

It is an air conditioner, not a precision refrigeration system. It may cause product failure. The appearance of the air conditioner may deteriorate, change color, or develop surface flaws.



Do not step on the indoor/outdoor unit and do not put anything on it. Always insert the filter securely. Clean it every two weeks. Do not drink water drained from air conditioner.

It may cause an injury through dropping of the unit or falling down. Operation without filters will cause failure. It contains contaminants and will make you sick.



Be cautious not to touch the sharp edges when installing. Instead of running air conditioning constantly, open a window for fresh air occasionally. Do not insert the hands or bars through the air inlet or outlet during operation.

It may cause injury. You will feel better. Otherwise, it may cause personal injury.



If the liquid from the battery gets onto your skin or clothes, wash it well with clean water. Do not use the remote if the battery has leaked. If you eat the liquid from the battery, brush your teeth and see doctor. Do not use the remote if the battery has leaked.

The chemicals in battery could cause burns or other health hazards. The chemicals in battery could cause burns or other health hazards.



IMPORTANT NOTICE!

Before installing the unit you should detach the front cabinet. Please disassemble the front cabinet, separating it from main unit.

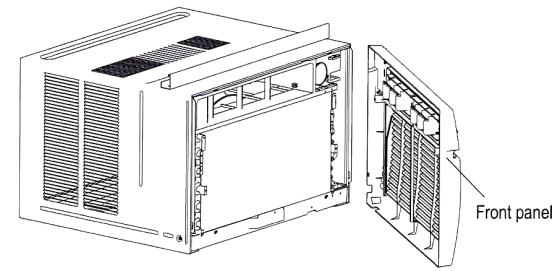

Before Operation

Preparing for Operation

- Contact an installation specialist for installation.
- Plug in the power plug properly.
- Use a dedicated circuit.
- Do not use an extension cord.
- Do not start/stop operation by plugging/unplugging the power cord.
- If the cord/plug is damaged, replace it with only an authorized replacement part.

Usage

- Being exposed to direct airflow for an extended period of time could be hazardous to your health.
- No correlation between fan usage and oxygen depletion.
- Do not use this air conditioner for non-specified special purposes (e.g. preserving precision devices, food, pets, plants, and art objects). Such usage could damage the items.

Cleaning and Maintenance

- Do not touch the metal parts of the unit when removing the filter. Injuries can occur when handling sharp metal edges.
- Do not use water to clean inside the air conditioner. Exposure to water can destroy the insulation, leading to possible electric shock.
- When cleaning the unit, first make sure that the power and breaker are turned off. The fan rotates at a very high speed during operation. There is a possibility of injury if the unit's power is accidentally triggered on while cleaning inner parts of the unit.

Service

For repair and maintenance, contact a Service Center.

Introduction

Symbols Used in this Manual

- This symbol alerts you to the risk of electric shock.
- This symbol alerts you to hazards that could cause harm to the air conditioner.
- NOTICE** This symbol indicates special notes.

Features

WARNING

This appliance should be installed in accordance with the National Electric Code.

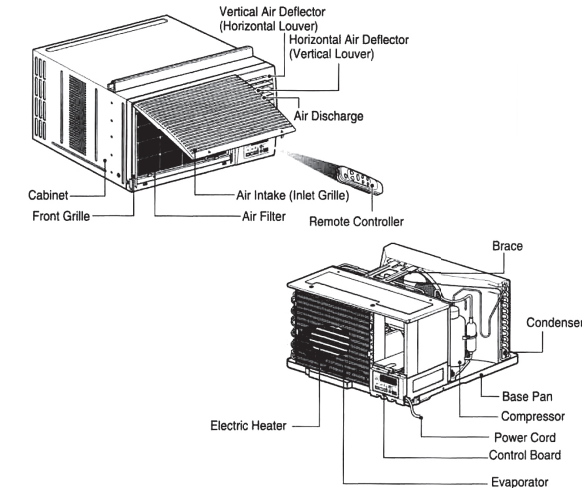

The images shown here are for illustrative purposes only and may be subject to change.

Electrical Safety

Electrical Data

115 V-	Power cord may include a current interrupter device. A test and reset button is provided on the plug case. The device should be tested on a periodic basis by first pressing the TEST button and then the RESET button. If the TEST button does not trip or if the RESET button will not stay engaged, discontinue use of the air conditioner and contact a qualified service technician.
--------	---

NOTICE

Use Wall Receptacle	Power Supply
 Standard 125 V, 3-wire grounding receptacle rated 15 A, 125 VAC	Use 15 AMP, time delay fuse or 15 AMP, circuit breaker.

WARNING
Never push the test button during operation. Otherwise this plug can be damaged. Do not remove, modify, or immerse this plug. If this device trips, the cause should be corrected before further use.

CAUTION
The conductors inside this cord are surrounded by shields, which monitor leakage current. These shields are not grounded. Periodically examine the cord for any damage. Do not use this product in the event the shields become exposed. Avoid shock hazard. This unit cannot be user-serviced. Do NOT open the tamper-resistant sealed portion. All warranties and performance will be voided. This unit is not intended to be used as an ON/OFF switch.

WARNING

USE OF EXTENSION CORDS
RISK OF FIRE could cause serious injury or death. DO NOT use an extension cord with this window air conditioner. DO NOT use surge protectors or multi-outlet adapters with this window air conditioner.

IMPORTANT (PLEASE READ CAREFULLY)

FOR THE USER'S PERSONAL SAFETY, THIS APPLIANCE MUST BE PROPERLY GROUNDED.
The power cord of this appliance is equipped with a three-prong (grounding) plug. Use this with a standard three-slot (grounding) wall power outlet to minimize the hazard of electric shock. The customer should have the wall receptacle and circuit checked by a qualified electrician to make sure the receptacle is properly grounded.
DO NOT CUT OR REMOVE THE THIRD (GROUND) PRONG FROM THE POWER PLUG.
A. SITUATIONS WHEN THE APPLIANCE WILL BE DISCONNECTED OCCASIONALLY
Because of potential safety hazards, we strongly discourage the use of an adapter plug. However, if you wish to use an adapter, a TEMPORARY CONNECTION may be made. Use UL-listed adapter, available from most local hardware stores. The large slot in the adapter must be aligned with the large slot in the receptacle to assure a proper polarity connection.
B. SITUATIONS WHEN THE APPLIANCE WILL BE DISCONNECTED OFTEN.
Do not use an adapter plug in these situations. Unplugging the power cord frequently can lead to an eventual breakage of the ground terminal. The wall power outlet should be replaced by a three-slot (grounding) outlet instead.

Installation

SCREW (TYPE A)	SCREW (TYPE B)	SCREW (TYPE C)	SILL SUPPORT
BOLT	NUT	FRAME CURTAIN	
FOAM-STRIP (Not adhesive backed)	FOAM-PE (Adhesive backed)	Left Guide Panel	Right Guide Panel
FRAME GUIDE	WINDOW LOCKING BRACKET	Curtain	

Have the following tools (not supplied) available for installation

- Phillips head screwdriver
- Ruler
- Scissors or knife
- Level
- Pencil
- Adjustable Wrench

Accessory type and quantity may vary depending on the model.

How to Install the Unit

1. To prevent vibration and noise, make sure the unit is installed securely and firmly.
2. Install the unit where the sunlight does not shine directly on the unit.
3. The outside of the cabinet must extend outward for at least 11" and there should be no obstacles, such as a fence or wall, within 20" from the back of the cabinet because it will prevent heat radiation of the condenser. Restriction of outside air will greatly reduce the cooling efficiency of the air conditioner.

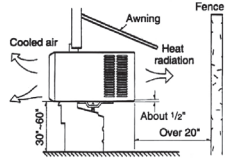

CAUTION

- All side louvers of the cabinet must remain exposed to the outside of the structure.
4. Install the unit slightly tilted so the back is slightly lower than the front (about 1/2"). This will force condensed water to flow to the outside.
 5. Install the unit with the bottom between 30°-60° above the floor level.

Window Requirements

NOTICE

All supporting parts should be secured to firm wood, masonry, or metal.

This unit is designed for installation in standard double hung windows with actual opening widths from 22" to 36". The top and bottom window sash must open sufficiently to allow a clear vertical opening of 14" from the bottom of the upper sash to the window stool.

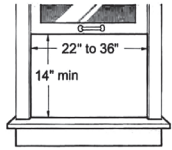

Preparation Of Chassis

1. Remove 4 screws which fasten the cabinet at both sides and at the back. (Keep the screws for later use.)
2. Slide the unit from the cabinet by gripping the base pan handle and pulling forward while bracing the cabinet.
3. Cut the window sash seal to the proper length. Peel off the backing and attach the Foam-PE (adhesive backed) to the underside of the window sash.
4. Insert the frame guides into the bottom of the cabinet.
5. Insert the frame curtain into the upper guide and frame guides.
6. Fasten the curtains to the unit with 8 Type A screws.

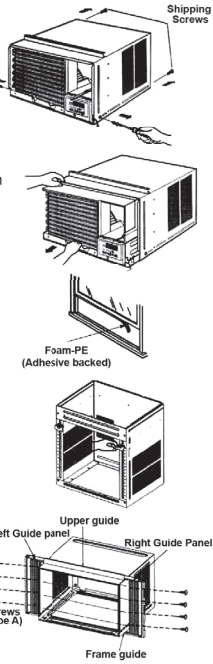

Cabinet Installation

1. Open the window. Mark a line on center of the window stool. Carefully place the cabinet on the window stool and align the center hole on the bottom front with the center line marked in the window stool.
2. Pull the bottom window sash down behind the upper guide until it meets.
3. Loosely assemble the sill support.
4. Select the position that will place the Sill Support near the outermost point on sill.
5. Attach the sill support to the cabinet track hole in relation to the selected position using 2 Type A screws in each support.
6. The cabinet should be installed with a very slight tilt (about 1/2") downward toward the outside. Adjust the bolt and the nut of sill support for balancing the cabinet.
7. Attach the cabinet to the window stool by driving the screws (Type B) through the front angle into window stool.
8. Pull each frame curtain fully to each window sash track.

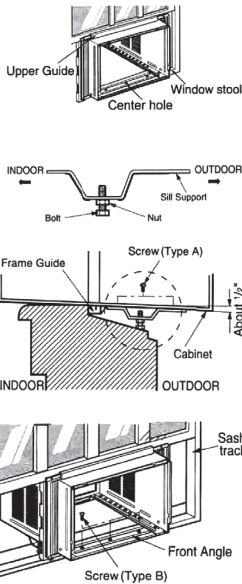

9. Attach each frame curtain the window sash using screws (Type C).
10. Slide the unit into the cabinet.

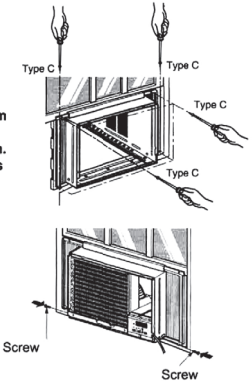

11. Cut the Foam-Strip (not adhesive backed) to the proper length and insert between the upper window sash and the lower window sash.
12. Attach the window locking bracket with a Type C screw.

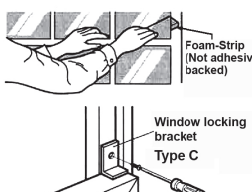

13. Before installing the front grille, pull out the vent control lever located above the unit control knobs, as shown.
14. Attach the front grille to the cabinet by inserting the tabs on the grille into the slots on the front of the cabinet. Push the grille in until it snaps into place.
15. Lift the inlet grille and secure it with a Type A screw through the front grille.
16. Window installation of room air conditioner is now completed. See ELECTRICAL DATA for attaching power cord to electrical outlet.

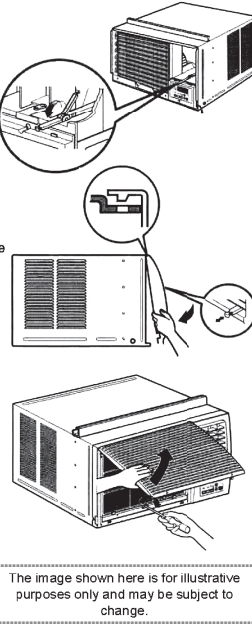

IMPORTANT INFORMATION

Do not drill holes in the product. Drilling holes in the product can cause the air conditioner to not function properly.

The image shown here is for illustrative purposes only and may be subject to change.

Operating Instructions

Remote control

The remote control and control panel will look like one of the following pictures.

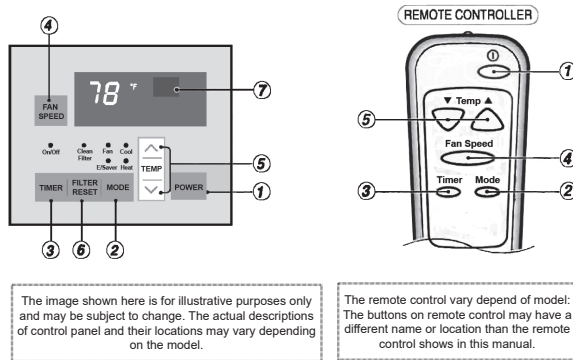

The image shown here is for illustrative purposes only and may be subject to change. The actual descriptions of control panel and their locations may vary depending on the model.

The remote control vary depend of model: The buttons on remote control may have a different name or location than the remote control shows in this manual.

1. POWER
Operation starts when this button is pressed and stops when you press the button again.
2. OPERATION MODE SELECTOR
Push the MODE button to rotate between Energy Saver / Cool / Fan / Heat.
Energy Saver - The fan stops when the compressor stops cooling. Approximately every 3 minutes the fan will turn on and check the room air temperature if cooling is needed.
Cool - Compressor runs and cools the room. Use the A / V and FAN buttons to set the desired temperature and circulation fan speed.
Fan - Fan circulates air but compressor does not run. Use the FAN button to set the desired fan speed.
Heat - Heater runs and heats the room.

3. ON/OFF TIMER
Delay ON - when the air conditioner is off, it can be set to automatically turn on from 1 to 24 hours at its previous mode and fan settings.
Delay OFF - when the air conditioner is on, it can be set to automatically turn off from 1 to 24 hours.
4. FAN SPEED SELECTOR
Use to set the fan speed to Low (F1), High (F2).
5. TEMPERATURE CONTROL
The thermostat monitors room temperature to maintain the desired temperature. The thermostat can be set between 60°F-86°F (16°C-30°C).

6. FILTER RESET
Clean Filter LED will light up to notify you that your filter needs to be cleaned. After cleaning the filter, press 'Filter Reset' button to turn off 'Clean Filter' light.

NOTICE
This feature is a reminder to clean the Air Filter (See Maintenance) for more efficient operation. The LED (light) will illuminate after 250 hours of operation.

7. Remote Signal Receiver
A slight heat odor may come from the unit when first switching to HEAT after the cooling season is over. This odor, caused by fine dust particles on the heater, will dissipate quickly.

AUTO RESTART
During operation in failure of electric power, the unit runs as previous setting operation.

ENERGY SAVER
The unit defaults to Energy Saver mode each time the unit is switched on except restoration after an electrical power outage and fan mode.

CAUTION: The remote controller will not function properly if strong light strikes the sensor window of the air conditioner or if there are obstacles between the remote controller and the air conditioner.

Inserting the Remote Control Battery (Not Supplied)

1. Push out the cover on the back of the remote control with your thumb.
2. Pay attention to polarity and insert one new AAA 1.5V battery.
3. Reattach the cover.

NOTICE
Do not use rechargeable battery. Make sure that the battery is new. Do not mix alkaline, standard (Carbon-zinc) or rechargeable (Nickel-cadmium) battery.
- In order to prevent discharge, remove the battery from the remote control if the air conditioner is not going to be used for an extended period of time. Keep the remote control away from extremely hot or humid places. To maintain optimal operation of the remote control, the remote sensor should not be exposed to direct sunlight.

Ventilation

The ventilation lever must be in the CLOSE position in order to maintain the best cooling conditions. When fresh air is necessary in the room, set the ventilation lever to the OPEN position. The damper is opened and room air is drawn out.

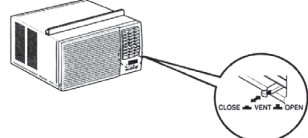

Air Direction

Airflow can be adjusted by changing the direction of the air conditioner's louvers.

- Adjusting Horizontal Air Flow Direction: The horizontal direction is adjusted by moving the lever to the left or right.
- Adjusting Vertical Air Flow Direction: Touch the horizontal louvers to adjust the air airflow up or down.

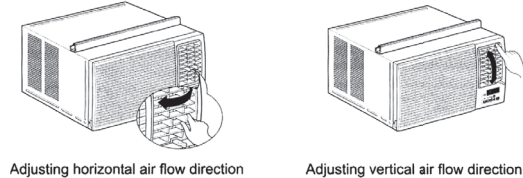

NOTICE
When the unit operates in extremely hot weather, it turns off automatically to protect compressor.

Additional Features

Slinger Fan

This air conditioner is equipped with a slinger fan. The fan has an outer ring that runs in the water that collects in the base pan if it gets deep. That condensate is then picked up by the fan and expelled through the condenser, making the air conditioner more efficient.

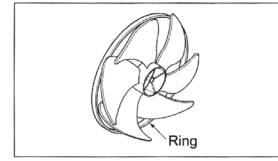

CAUTION: Be careful when inserting the drain pipe. Push away from the sharp fin area to avoid slipping injuring yourself.

Maintenance and Service

Air Filter

Check the air filter at least twice a month to see if cleaning is necessary. Trapped particles in the filter can build up and block the airflow, reducing cooling capacity and causing an accumulation of frost on the evaporator. To clean the air filter:

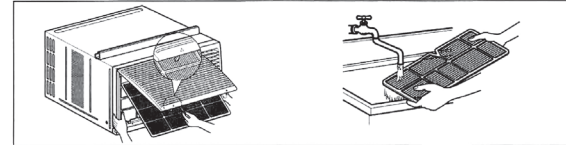

1. Lift the inlet grille upward.
2. Remove the air filter from the front grille by pulling the air filter up slightly.
3. Wash the filter using lukewarm water below 40°C (104 °F).
4. Gently shake the excess water from the filter and replace.

Cleaning The Air Conditioner

The front grille and inlet grille may be wiped with a cloth dampened in a mild detergent solution. The cabinet may be washed with mild soap or detergent and lukewarm water, then polished with liquid wax for Appliances.

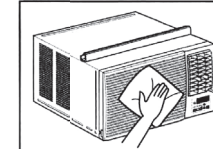

To ensure continued peak efficiency, the condenser coils (outside of unit) should be checked periodically and cleaned if clogged with soot or dirt from the atmosphere.

Common Problems and Solutions

Before Calling for Service

If you have problems with your air conditioner, read the following information and try to solve the problem. If you cannot find a solution, turn off the air conditioner and call a service center.

Air conditioner does not operate

1. Ensure that the air conditioner is plugged into an outlet of the proper voltage and amperage.
2. Check the fuse or circuit breaker.
3. Check whether the voltage is unusually high or low.

Air does not feel cold enough on the cooling setting

1. Ensure that the temperature settings are correct.
2. Check to see if the air filter is clogged with dust. If so, clean the filter.
3. Ensure that the air flow from the outside is not obstructed and that there is a clearance of over 20" between the back of the air conditioner and the wall or fence behind it.
4. Close all doors and windows and check for any source of heat in the room.

Water drip from the rear of the unit

You see water dripping from the rear of the unit. Water may be collected in the base pan in highly humid conditions or on rainy days. This water overflows and drips from the rear of the unit.

Normal Sound

High pitched Chatter

Today's high efficiency compressors may have a high pitched chatter during the cooling cycle.

Sound of Rushing Air

At the front of the unit, you may hear the sound of rushing air being moved by the fan.

Pinging or Swishing

Droplets of water hitting condenser during normal operation may cause "pinging or swishing" sounds.

Vibration

Unit may vibrate and make noise because of poor wall or window construction or incorrect installation.

Gurgling/Hiss

"Gurgling or hissing" noise may be heard due to refrigerant passing through evaporator during normal operation.

Troubleshooting

The air conditioner may be operating abnormally when:

Problem	Possible Causes	What To Do
Air conditioner does not start	The air conditioner is unplugged. The fuse is blown/circuit breaker is tripped. Power failure.	Make sure the air conditioner plug is pushed completely into the outlet. Check the house fuse/circuit breaker box and replace the fuse or reset the breaker. If power failure occurs, turn the mode control to Off. When power is restored, wait 3 minutes to restart the air conditioner to prevent tripping of the compressor overload.
The current interrupter device is tripped.		Press the RESET button located on the power cord plug. If the RESET button will not stay engaged, discontinue use of the air conditioner and contact a qualified service technician.
Air conditioner does not cool as it should	Airflow is restricted. The temp control may not be set correctly. The air filter is dirty. The room may have been hot. Cold air is escaping. Cooling coil has iced up.	Make sure there are no curtains, blinds, or furniture blocking the front of the air conditioner. In COOL model, press the DECREASE* pad. Clean the filter at least every 2 weeks. See the care and Maintenance section. When the air conditioner is first turned on, you need to allow time for the room to cool down. Check for open furnace floor registers and cold air returns. See Air Conditioner Freezing Up below.
Air conditioner freezing up	The cooling coils are iced over.	Ice may block the air flow and obstruct the air conditioner from properly cooling the room. Set the mode control at High Fan or High Cool.
Water drips outside	Hot, humid weather.	This is normal.
Water drips indoors	The air conditioner is not tilted to the outside.	For proper water disposal, make sure the air conditioner slants slightly from the case front to the rear.
Water collects in base pan	Moisture removed from air and drains into base pan.	This is normal for a short period in areas with little humidity; normal for a longer period in very humid areas.
Air conditioner turns on and off rapidly.	Dirty air filter - air restricted. Outside temperature extremely hot.	Clean air filter. Set FAN speed to a faster setting to bring air through cooling coils more frequently.
Noise when unit is cooling	Air movement sound. Window vibration - poor installation.	This is normal. If too loud, set to lower FAN setting. Refer to installation instructions or check with installer.
Remote Sensing Deactivating Prematurely	Remote control not located within range. Remote control signal obstructed.	Place remote control within 20 feet & 120° radius of the front of the unit. Remove obstruction.
Room too cold.	Set temperature too low.	Increase set temperature.

* If you see "CH" in the display, please call a service center.

REFURBISHED PRODUCT LIMITED THIRTY DAY WARRANTY

The Refurbished Product Service Center offers the following WARRANTY to the ORIGINAL purchaser of a product which we have refurbished.

This product that has been refurbished is warranted against any electronic or mechanical defects for a period of THIRTY DAYS from the date of the original purchase by the consumer. Since this unit was sold as a refurbished item, the warranty does not apply to any cosmetic appearance items such as scratches. Should a defect occur, the Refurbished Product Service Center will repair or, at its option, replace defective unit/parts with new or rebuilt materials without charge for either parts or labor. Replacement unit/parts will be warranted for the remaining portion of the original warranty period.

This warranty does not cover installation or damage from accident, misuse, abuse, improper wiring, incorrect voltage, operating the unit against the instructions in the owner's manual or any product which has been opened, altered, or tampered with.

This warranty does not cover costs for removal and/or installation of the unit for repair. Under no circumstances shall the service center be liable for any special, incidental or consequential damages or for any other expenses incurred by reason of use or sale of this product. This warranty is in lieu of any other warranties expressed or implied warranty of merchantability of fitness for particular use or otherwise.

This warranty gives the consumer specific legal rights and they may also have other rights which vary from State to State. Some States do not follow the exclusion or limitation of incidental or consequential damages, hence the above exclusion and limitations may not apply.

Refurbished Product Service Center
13225 Marquardt Avenue Santa Fe Springs, CA 90670

WARRANTY REPAIR INFORMATION

If you need service on your unit during the 30 day warranty period; please go to www.ConsumerServiceRefurbish.com or call the Refurbished Product Service Center at 562-946-3531 to obtain the required claim number. Once you obtain your claim number, pack the unit properly (the original carton is ideal for this purpose) along with a copy of your purchase receipt. Send the unit freight prepaid and insured to:

Refurbished Product Service Center,
Att: Customer Service Department 13225 Marquardt Avenue Santa Fe Springs, CA 90670

Your unit will be promptly exchanged and returned to you. We will refuse to accept delivery of the returned unit unless the assigned claim number appears on the outside of the shipping carton.

Owner's Information
(Keep for your permanent records)

NAME: _____
ADDRESS: _____
CITY: _____ STATE: _____ ZIP CODE: _____
PHONE: _____ E-MAIL: _____
MODEL: _____ SERIAL NO.: _____



804109988



PRINTED IN MEXICO
SC.02-02-2021
OBPN:MFL70559708
SHNMDL: LW8016HR_B
TAB / TEIbrd:J.E.