

“Recipe book is not included”

804109528

IMPORTANT SAFETY INSTRUCTIONS

HOUSEHOLD USE ONLY • READ ALL INSTRUCTIONS BEFORE USE

To reduce the risk of injury, fire, electrical shock, or property damage, basic safety precautions must ALWAYS be followed, including the following warnings and subsequent instructions.

⚠ WARNING

POLARIZED PLUG

⚠ WARNING: To reduce the risk of electric shock, this appliance has a polarized plug (one blade is wider than the other). This plug will fit into a polarized outlet only one way. If the plug does not fit fully into the outlet, reverse the plug. If it still does not fit, contact a qualified electrician to install the proper outlet. **DO NOT** modify the plug in any way.

⚠ WARNING: Extension cords are not recommended for use with this product.

⚠ WARNING: Remove utensils prior to processing. Failure to remove may cause the jar to be damaged or to shatter which may cause personal injury.

⚠ WARNING: Stacked Blade Assembly is sharp, not locked in place and removable, handle with care. When handling the Stacked Blade Assembly always hold it by the shaft. Failure to do so will result in risk of laceration.

⚠ WARNING: Do not immerse the motor base into water or any other liquid.

⚠ WARNING: Handle the Stacked Blade Assembly with care when washing, as the blades are very sharp.

⚠ CAUTION: Do not blend hot liquids, doing so may cause excessive pressure buildup, resulting in risk of the user being burned.

⚠ CAUTION: Never insert your hands in the pitcher as the Stacked Blade Assembly is sharp. Always use a spatula to dislodge food that has stuck to the sides of the pitcher.

To protect against electrical shock, **DO NOT** submerge the appliance or allow the power cord to come into contact with water or any other liquid.

This appliance is not intended for use by children or by persons with reduced physical, sensory, or mental capabilities, or lack of experience and knowledge. Close supervision is necessary when any appliance is used near children. Children should be supervised to ensure that they **DO NOT** play with the appliance.

NEVER leave an appliance unattended when in use.

Appliance accessories are not intended to be used in the microwave as it may result in damage to the accessories.

Turn the appliance Off and remove the power cord from the electrical outlet when not in use, before assembling or disassembling parts and before cleaning. To unplug, grasp the plug and pull from the electrical outlet. **NEVER** pull from the power cord.

DO NOT abuse the power cord.

⚠ CAUTION: Make sure that the motor base is unplugged from the power source before inserting or removing any attachment and before cleaning.

NEVER carry the appliance by the power cord or yank it to disconnect from electrical outlet; instead grasp the plug and pull to disconnect.

DO NOT operate any appliance with a damaged cord or plug, or after the appliance malfunctions, has been dropped or damaged in any manner. This appliance has no serviceable parts.

DO NOT let the power cord hang over the edge of table or counter or touch hot surfaces such as the stove.

ALWAYS use appliance on a dry, level surface.

Keep hands, hair, clothing, as well as utensils out of container while processing to reduce the risk of severe injury to persons or damage to the appliance. A scraper may be used but only when the appliance is not running.

Avoid contact with moving parts.

DO NOT attempt to sharpen blades.

DO NOT use the appliance if blade assembly is bent or damaged.

To reduce risk of injury, **NEVER** place the blade assembly on base without pitcher or bowl properly attached.

DO NOT operate this appliance on or near any hot surfaces (such as gas or electric burner or in a heated oven).

The use of attachments, including canning jars, not recommended by the manufacturer may cause a risk of injury to persons.

DO NOT remove the container from the motor base while the appliance is in operation.

To reduce the risk of injury, **NEVER** operate the appliance without the lid in place; **DO NOT** try to defeat the interlock mechanism; make sure that the attachment is properly installed before operating the appliance.

DO NOT expose containers to extreme temperature changes.

DO NOT overfill.

DO NOT operate the appliance empty.

To reduce the risk of burns, **ALWAYS** allow the appliance to cool before taking off parts and before cleaning.

In the event that the unit overloads, the unit will shut down. Unplug the appliance and let it cool down for approximately 15 minutes before using again.

THIS PRODUCT IS INTENDED FOR HOUSEHOLD USE ONLY. DO NOT use this appliance for anything other than its intended use. **DO NOT** use outdoors.

ALWAYS operate blender with cover in place. If using the pour spout, hold the cover in place on the container when pouring to avoid risk of injury.

GETTING STARTED

The Ninja® Professional Blender is a high powered kitchen tool that is perfect for ice crushing, blending, pureeing and controlled processing. Create all of your favorite recipes quickly and easily with just one touch of a button. For best results, be sure to carefully read all the instructions contained in the manual before using this appliance.

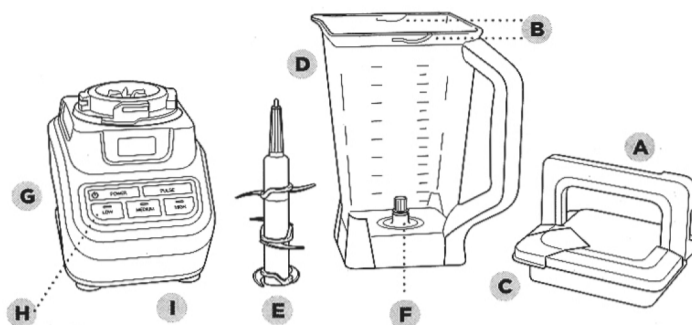

- a Lid with Locking Handle
- b Locking Handle Release Button
- c Pouring Spout with Cap
- d Pitcher
- e Stacked Blade Assembly
- f Gear Shaft
- g Motor Base (Power Cord & Cord Storage not shown)
- h Control Panel
- i Non Slip Bottom

BEFORE FIRST USE

- 1 Remove all packaging material and labels from the appliance. Separate all parts from each other.
- 2 Wash the lid, pitcher, and Stacked Blade Assembly in warm, soapy water. When washing the blade assembly, use a dishwashing utensil with a handle to avoid direct hand contact with blades.
- 3 Handle blade assembly with care to avoid contact with sharp edges. Rinse and air-dry thoroughly.
- 4 The pitcher and Stacked Blade Assembly are dishwasher safe. It is recommended the lid and Stacked Blade Assembly be placed on the top rack. Ensure the Stacked Blade Assembly is removed from the pitcher before placing in the dishwasher.

- 5 Wipe the motor base clean with a damp cloth.

PLEASE KEEP THESE IMPORTANT SAFEGUARDS IN MIND WHEN USING THE APPLIANCE:

Make sure the motor base is plugged in for use.

NEVER add ingredients into the container before placing the Blade Assembly in first.

DO NOT attempt to operate the appliance without the lid on.

NEVER run the appliance empty.

Appliance accessories are not intended to be used in the microwave, as it may result in damage to the accessories.

ASSEMBLY & USE OF THE PITCHER

- 1 Review the Important Safety Instructions on pages 1-2 before proceeding to step 2.
- 2 Place the motor base on a clean, dry, level surface such as a counter or tabletop.

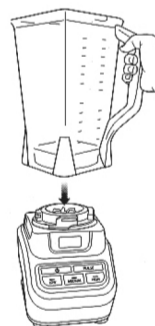

- 3 Align and lower the pitcher onto the motor base.



- 4 Rotate the pitcher clockwise until it locks in place. You will hear a click when the lock is engaged.

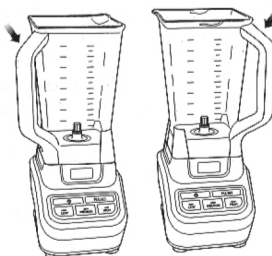

- 5 The pitcher can be placed on the motor base two ways; the handle can be on the front right corner or the front left corner.

- 6 Holding the Stacked Blade Assembly by the top of the shaft, place it onto the drive gear inside the pitcher. Ensure the Stacked Blade Assembly is seated properly and is standing upright.

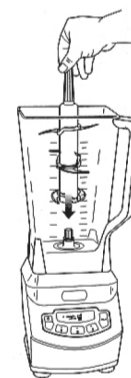

NOTE: The Stacked Blade Assembly will fit loosely on the drive gear.

- 7 Add the ingredients to the pitcher, making sure they do not exceed the highest measured marking line on the side of the pitcher.

NOTE: If you need to add additional ingredients while the appliance is processing, open the pour spout cap and pour the ingredients in through the opening.

NOTE: When blending any kind of liquids, such as mixtures of any drinks or smoothies, do not exceed the “Max Liquid” mark (64 ounces) on the pitcher.

- 8 Plug the power cord into the electrical outlet and press the power button (⏻).

IMPORTANT: As a safety feature, the power button (⏻) will flash and the motor will not work if the pitcher and lid are not installed correctly. When the pitcher and lid are installed properly, the power button (⏻) will be solid, indicating the blender is ready for use.

SAVE THESE INSTRUCTIONS



9 Holding the lid by the handle in the upright position, place it on top of the pitcher, aligning the arrow (▼) located on the lid with the arrow (▲) located on the pitcher's handle. Press the handle down until you hear a click.

10 Select the speed according to your blending requirements*:

- Use the LOW setting for processing and mixing.
- Use the MEDIUM setting for blending and ice crushing.
- Use the HIGH setting for pureeing and liquefying.
- Use the PULSE button for controlled chopping and processing.

*See Blending Chart.

NOTE: Pulse ingredients for even chopping by pressing down in short intervals.

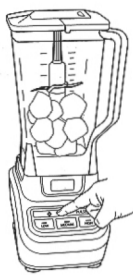

11 When ingredients have reached your desired consistency, stop the appliance by pressing the power button (⏻) and wait for the Stacked Blade Assembly to stop turning.

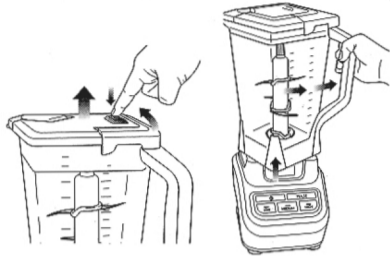

12 To remove the lid, press the release button on the lid, pull the lid handle up to a 90° angle, and lift the lid off. Turn the pitcher counterclockwise and then lift off the base.

13 Open the pour spout cap and use the spout to empty liquid contents.

For thicker consistencies, first remove the lid by pressing the release button and pulling the lid handle up to a 90 degree angle to lift lid off the pitcher. Then, carefully remove the Stacked Blade Assembly by the top of the shaft. Place Stacked Blade Assembly away from the work area to avoid accidental contact. Finally, empty contents from the pitcher.

14 Make sure the unit is unplugged when not in use.

BUTTON	FUNCTION	USE
POWER ⏻	On/Off	Always turn appliance off when not in use.
LOW	Processing & Mixing	Use to mix thin batters, gravies, and marinades; beat eggs; puree cooked foods and uncooked fruits; and chop vegetables for dips and salsa.
MEDIUM	Blending & Ice Crushing	Use to grate hard cheeses; chop and grind nuts; mix dips; cream soups*; blend sauces*, spreads, mixed drinks, smoothies, and milkshakes.
HIGH	Pureeing & Liquefying	Use to mix smoothies, frappes, liquefy thick mixtures and blend whole fruits and vegetables.
PULSE	Controlled Processing & Bursts of Power	Use to control chopping and processing.

*When blending soups and sauces, make sure they're cooled to room temperature first. Ninja® containers are not intended for hot blending.

TROUBLESHOOTING GUIDE

- **Motor doesn't start or Stacked Blade Assembly doesn't rotate.**
Make sure the pitcher is securely placed on motor base.
Make sure the lid is securely on pitcher in the correct position (align arrows).
The blender is turned off. Press the power button (⏻) to turn on.
Check that the plug is securely inserted into the electrical outlet.
Check the fuse or circuit breaker.
The unit has overheated. Unplug and wait approximately 15 minutes before using again.
- **Ingredients are unevenly chopped.**
Either you are chopping too many ingredients at one time, or the pieces are not of even size. Process smaller amounts per batch.
- **Ingredients are chopped too fine or is too watery.**
The ingredients have been over-processed. Use PULSE button for controlled processing.
- **Ingredients collects on lid or on the sides of the pitcher.**
The mixture is too thick. Add more liquid.
- **You cannot achieve snow from solid ice.**
Do not use ice that has been sitting out or has started to melt. Use ice straight from the freezer and make sure the pitcher is completely dry before adding ice.

CARE & MAINTENANCE

CLEANING

- 1 Separate all parts from each other.
- 2 **Hand-Washing:** Wash the pitcher, lid, and Stacked Blade Assembly in warm, soapy water. When washing the Stacked Blade Assembly, use a dishwashing utensil with a handle to avoid direct hand contact with blades. Handle blade assembly with care to avoid contact with sharp edges. Rinse and air-dry thoroughly.

Dishwasher: The pitcher, lid, and Stacked Blade Assembly are all dishwasher safe. The lid and Stacked Blade Assembly are top-rack dishwasher safe. Ensure the Stacked Blade Assembly is removed from the pitcher before placing in the dishwasher.
- 3 Wipe the motor base clean with a damp cloth.

STORING

- 1 Store the Ninja® Professional upright with the Stacked Blade Assembly inside the pitcher with the lid secured on top. Do not place anything on top. Loosely wrap the power cord around the cord storage hook in the back of the unit.

RESETTING THE MOTOR THERMOSTAT

The Ninja® Professional features a unique safety system that prevents damage to the unit's motor and drive system should you inadvertently overload the unit. **If the unit is overloaded, the motor will stop.** To reset the unit, follow the resetting procedure below:

- 1 Unplug the unit from the electrical outlet.
- 2 Remove and empty the pitcher and ensure no ingredients are jamming the Stacked Blade Assembly.
- 3 Allow the unit to cool for approximately 15 minutes.
- 4 Place the pitcher onto the base and plug the unit into the electrical outlet.
- 5 Proceed to use the unit as before, making sure to not exceed the recommended maximum capacities.

NOTE:
In order to ensure the highest possible standard for refurbished items, all units are thoroughly inspected as part of the process. For this item, water may be used during the refurbishing process and so; you may notice some condensation in the water reservoir. It is recommended to rinse the water reservoir with fresh water prior to its first use.

REFURBISHED PRODUCT LIMITED NINETY DAYS WARRANTY

The **Refurbished Product Service Center** offers the following WARRANTY to the ORIGINAL purchaser of a product which we have refurbished.

This product that has been refurbished is warranted against any electronic or mechanical defects for a period of NINETY DAYS from the date of the original purchase by the consumer. Since this unit was sold as a refurbished item, the warranty does not apply to any cosmetic appearance items such as scratches. Should a defect occur, the **Refurbished Product Service Center** will repair or, at its option, replace defective unit/parts with new or rebuilt materials without charge for either parts or labor. Replacement unit/parts will be warranted for the remaining portion of the original warranty period.

This warranty does not cover installation or damage from accident, misuse, abuse, improper wiring, incorrect voltage, operating the unit against the instructions in the owner's manual or any product which has been opened, altered, or tampered with.

This warranty does not cover costs for removal and or installation of the unit for repair. Under no circumstances shall the service center be liable for any special, incidental or consequential damages or for any other expenses incurred by reason of use or sale of this product. This warranty is in lieu of any other warranties expressed or implied warranty of merchantability of fitness for particular use or otherwise.

This warranty gives the consumer specific legal rights and they may also have other rights which vary from State to State. Some States do not follow the exclusion or limitation of incidental or consequential damages, hence the above exclusion and limitations may not apply.

Refurbished Product Service Center
13225 Marquardt Avenue Santa Fe Springs, CA 90670.

WARRANTY REPAIR INFORMATION

If you need service on your unit and this product requires repair during the 90 days warranty period; please go to www.ConsumerServiceRefurbish.com or call the **Refurbished Product Service Center** at 562-946-3531 to obtain the required return authorization (RA) number. Pack the unit properly (the original carton is ideal for this purpose) along with a copy of your purchase receipt and a letter describing the problem. Send the unit freight prepaid and insured to:

Refurbished Product Service Center,
Att: Customer Service Department 13225 Marquardt Avenue Santa Fe Springs, CA 90670

Your unit will be promptly repaired and returned to you. We will refuse to accept delivery of the returned unit unless the assigned RA number appears on the outside of the shipping carton.

Owner's Information
(Keep for your permanent records)

NAME: _____
 ADDRESS: _____
 CITY: _____ STATE: _____ ZIP CODE: _____
 PHONE: _____ E-MAIL: _____
 MODEL: _____ SERIAL NO.: _____

