

- a Nutri Ninja® Cup
 - b Nutri Ninja To-Go Lid
 - c Nutri Ninja Blade Assembly
 - d 64 oz. Bowl
 - e Bowl Lid
 - f Chopping Blade Assembly (bowl)
 - g Dough Blade Assembly (bowl)
 - h 72 oz. Pitcher
 - i Pitcher Lid with Locking Handle
 - j Stacked Blade Assembly (pitcher)
 - k Motor Base
- l Power Cord (not shown)
- NOTE:** Attachments are not interchangeable.
NOTE: Accessories may vary depending on the model.

IMPORTANT SAFETY INSTRUCTIONS For Household Use Only

WHEN USING ELECTRICAL APPLIANCES, BASIC SAFETY PRECAUTIONS SHOULD ALWAYS BE FOLLOWED, INCLUDING THE FOLLOWING:

READ ALL INSTRUCTIONS BEFORE USING YOUR NINJA® SUPRA KITCHEN SYSTEM.

POLARIZED PLUG

⚠ WARNING: To reduce the risk of electric shock, this appliance has a polarized plug (one blade is wider than the other). This plug will fit into a polarized outlet only one way. If the plug does not fit fully into the outlet, reverse the plug. If it still does not fit, contact a qualified electrician to install the proper outlet. **DO NOT** modify the plug in any way.

⚠ WARNING: Extension cords are not recommended for use with this product.

⚠ WARNING: TO REDUCE THE RISK OF FIRE, ELECTRIC SHOCK OR INJURY:

- 1 **⚠ WARNING:** Remove utensils prior to processing.
- 2 **⚠ CAUTION:** Blade assemblies are sharp, not locked in place and removable, handle with care. When handling the blade assemblies, always hold them by the shaft.
- 3 **⚠ CAUTION:** Blade Assemblies are not locked in place and are removable. If using the pour spout, ensure the lid is fully locked onto the pitcher. If pouring with the lid removed, ALWAYS remove the blade assembly first.
- 4 **⚠ CAUTION:** Do not blend hot liquids.
- 5 **⚠ CAUTION:** We do not recommend grinding in any of our Nutri Ninja® Cups.
- 6 To protect against electrical shock, do not submerge the appliance or allow the power cord to come into contact with water or any other liquid.
- 7 **DO NOT** allow the appliance to be used by children. Close attention is necessary when used near children. This is not a toy.
- 8 Never leave an appliance unattended when in use.
- 9 Appliance accessories are not intended to be used in the microwave as it may result in damage to the accessories.
- 10 Turn the appliance Off and remove the power cord from the electrical outlet when not in use, before assembling or disassembling parts and before cleaning. To unplug, grasp the plug and pull from the electrical outlet. Never pull from the power cord.
- 11 **DO NOT** abuse the power cord. Never carry the appliance by the power cord or yank it to disconnect from electrical outlet; instead grasp the plug and pull to disconnect.
- 12 **DO NOT** operate any appliance with a damaged cord or plug, or after the

appliance malfunctions, has been dropped or damaged in any manner. This appliance has no serviceable parts.

- 13 **DO NOT** let the power cord hang over the edge of table or counter or touch hot surfaces such as the stove.
- 14 Always use appliance on a dry, level surface.
- 15 Keep hands, hair, clothing, as well as utensils out of container while processing to reduce the risk of severe injury to persons or damage to the appliance. A scraper may be used but only when the appliance is not running.
- 16 Avoid contact with moving parts.
- 17 **DO NOT** attempt to sharpen blades.
- 18 **DO NOT** use the appliance if blade assembly is bent or damaged.
- 19 To reduce risk of injury, never place the blade assembly on base without pitcher or bowl properly attached.
- 20 **DO NOT** operate this appliance on or near any hot surfaces (such as gas or electric burner or in a heated oven).
- 21 The use of attachments or accessories including canning jars, not recommended by the manufacturer may result in fire, electric shock or personal injury.
- 22 **DO NOT** remove the container from the motor base while the appliance is in operation.
- 23 To reduce the risk of injury, **NEVER** operate the appliance without the lid in place; **DO NOT** try to defeat the interlock mechanism; make sure that the attachment is properly installed before operating the appliance.
- 24 **DO NOT** expose containers to extreme temperature changes.
- 25 **DO NOT** overfill.
- 26 **DO NOT** operate the appliance empty.
- 27 To reduce the risk of burns, always allow the appliance to cool before taking off parts and before cleaning.
- 28 In the event that the unit overloads, the unit will shut down. Unplug the appliance and let it cool down for approximately 15 minutes before using again.
- 29 **THIS PRODUCT IS INTENDED FOR HOUSEHOLD USE ONLY.** Do not use this appliance for anything other than its intended use. Do not use outdoors.
- 30 The maximum rating is based on the Stacked Blade Assembly (pitcher) that drives the greatest power and other recommended attachments may draw significantly less power or current.

SAVE THESE INSTRUCTIONS

TECHNICAL SPECIFICATIONS

Voltage:	120V., 60Hz.
Pitcher Capacity:	72 oz. (9 cups, 2.15 L)
MAX Liquid Capacity:	64 oz. (8 cups, 1.9 L)
Bowl Capacity:	64 oz. (8 cups, 1.8 L)
Nutri Ninja® Cup Capacity:	16 oz. (2 cups, 470 ml)

FEATURES:

- Total Crushing® Technology
- Extra Large, 72 oz. Pitcher (MAX Liquid Capacity: 64 oz.) - BPA Free
- 64 oz. Bowl - BPA Free
- Nutri Ninja® Cup - BPA Free
- Lock-In Lid
- Easy to Clean Electronic Control Panel
- Sturdy, Non-Slip Base
- Hidden Drain Holes - prevent water build up from dishwasher

Getting To Know Your Ninja® Supra Kitchen System

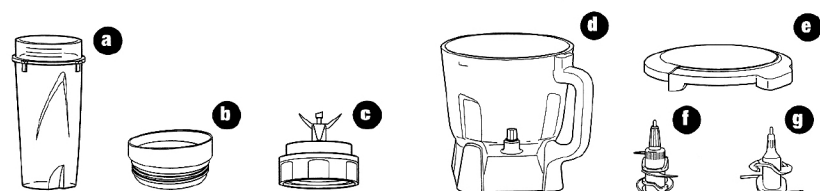

Using the Ninja® Supra Kitchen System

PLEASE KEEP THESE IMPORTANT SAFEGUARDS IN MIND WHEN USING THE APPLIANCE:

- ⚠ WARNING:** Never leave the appliance unattended while in use.
 - ⚠ WARNING:** Secure the appliance while in use by pressing down on the lid with one hand.
 - ⚠ CAUTION:** Blade assemblies are sharp, not locked in place and removable, handle with care. When handling the blade assemblies, always hold them by the shaft.
 - ⚠ CAUTION:** Do not blend hot liquids.
 - ⚠ CAUTION:** Never remove the container while the appliance is still running.
 - ⚠ CAUTION:** We do not recommend grinding in any of our Nutri Ninja® Cups.
- IMPORTANT:** Never add ingredients into the container before placing the attachment in first.
- IMPORTANT:** Attachments are not interchangeable.
- IMPORTANT:** DO NOT attempt to operate the appliance without the lid on.
- IMPORTANT:** Never run the appliance empty.
- IMPORTANT:** Appliance accessories are not intended to be used in the microwave as it may result in damage to the accessories.

Recipe book is not included

⚠ CAUTION: Blade Assemblies are not locked in place and are removable. If using the pour spout, ensure the lid is fully locked onto the blender pitcher.

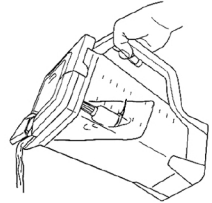

⚠ CAUTION: Blade Assemblies are not locked in place and are removable. If pouring with the lid removed, ALWAYS remove the Blade Assembly first.

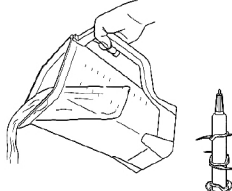

⚠ CAUTION: Blade assemblies are sharp, not locked in place and removable, handle with care. When handling the blade assemblies, always hold them by the shaft.

BEFORE FIRST USE

- 1 Remove all packaging material and labels from the appliance.
- 2 Wash the lids, pitcher, bowl, Nutri Ninja cups and blade assemblies in warm, soapy water with a soft cloth.
- ⚠ CAUTION:** Handle the blade assemblies with care when washing, as the blades are very sharp.
- 3 Rinse and dry thoroughly.
- 4 The pitcher, bowl, Nutri Ninja cups, lids and blade assemblies, are all dishwasher safe. It is recommended that the lids and blade assemblies be placed on the top rack. Ensure that the blade assemblies are removed from the containers before placing in the dishwasher.
- 5 Wipe the motor base clean with a damp cloth.

Assembly and Use for the 72 oz. Pitcher

- ⚠ WARNING:** Never leave the appliance unattended while in use.
- ⚠ WARNING:** Remove utensils prior to processing. Failure to remove may cause the container to be damaged or to shatter, which may cause personal injury.
- ⚠ CAUTION:** Handle the Stacked Blade Assembly with care, as the blades are very sharp.
- ⚠ CAUTION:** Do not blend hot liquids.
- IMPORTANT:** Make sure that the motor base is plugged in for use.

ASSEMBLY

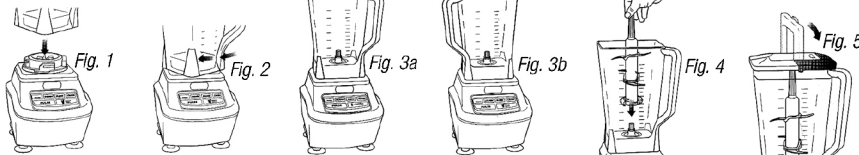

- 1 Place the motor base on a clean, dry, level surface such as a counter or table top.
- 2 Align and lower the Pitcher onto the motor base. (Fig. 1) Handle should be aligned slightly to the right of the "LOCK" symbol on the motor base.
- 3 Rotate the pitcher clockwise until it locks in place. You will hear a click when the lock is engaged. (Fig. 2)
- 4 The pitcher can be placed on the motor base two ways; the handle can be on the front right corner or the front left corner. (Fig. 3a, Fig. 3b)
- 5 Holding the Stacked Blade Assembly by the top of the shaft, place it onto the drive gear inside the pitcher. Ensure that the Stacked Blade Assembly is seated properly and is standing upright. (Fig. 4)
- NOTE:** The Stacked Blade Assembly will fit loosely on the drive gear.
- 6 Add the ingredients to the pitcher, making sure that they do not exceed the highest measured marking line on the side of the pitcher.

NOTE: If you need to add additional ingredients while the appliance is processing, open the pour spout cap and pour the ingredients in through the opening.

NOTE: When blending any kind of liquids, such as mixtures of any drinks or smoothies, do not exceed the "Max liquid" mark (1.9 L) on the pitcher

- 7 Plug the power cord into the electrical outlet and press the power button (⏻).

IMPORTANT: As a safety feature, the power button (⏻) will flash and the motor will not work if the pitcher and lid are not installed correctly. When the pitcher and lid are installed properly, the power button (⏻) will be solid, indicating that the appliance is ready for use.

- 8 Holding the lid by the handle in the upright position, place it on top of the pitcher aligning the arrow (↖) located on the lid with the arrow (↗) located on the pitcher's handle. (Fig. 5) Press the handle down until you hear a click.

- ⚠ WARNING:** Never leave the appliance unattended while in use.
- ⚠ WARNING:** Remove utensils prior to processing. Failure to remove may cause the cup to be damaged or to shatter, which may cause personal injury.
- ⚠ CAUTION:** Handle the Stacked Blade Assembly with care, as the blades are very sharp.
- ⚠ CAUTION:** Do not blend hot liquids.
- IMPORTANT:** Make sure that the motor base is plugged in for use.

USE

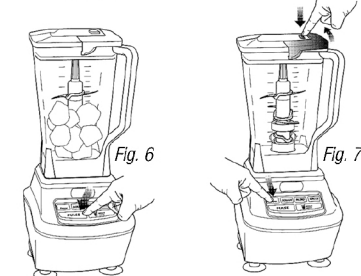

REMOVAL

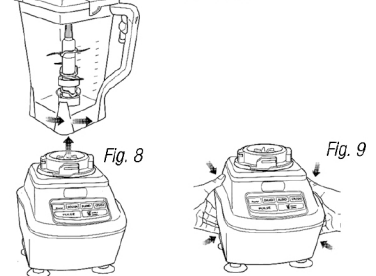

Illustrations may differ from actual product.

- Select the speed that best suits your needs. (Fig. 6)
- NOTE:** Pulse ingredients for even chopping by pressing down in short intervals.
- When you have reached your desired consistency, stop the appliance by pressing the power button (⏻) and wait for the Stacked Blade Assembly to stop turning. (Fig. 7)
 - To remove the lid, press the release button on the lid, pull the lid handle up to a 90° angle and lift the lid off. Turn the pitcher counterclockwise and then lift off the base. (Fig. 7, Fig. 8)
- CAUTION:** Never insert your hands in the pitcher as the Stacked Blade Assembly is sharp. Always use a spatula to dislodge food that has stuck to the sides of the pitcher.
- Depending on the consistency of the contents in the container, open the pour spout cap and use the spout to empty liquid contents. For thicker consistencies,

- remove the lid and Stacked Blade Assembly carefully (by its shaft), then empty contents from the container.
- CAUTION:** Stacked Blade Assembly is not locked in place and is removable. If using the pour spout, ensure the lid is fully locked onto the blender pitcher.
- For thicker consistencies, remove the lid and Stacked Blade Assembly carefully (by its shaft), then empty contents from the container. To remove the lid, press the release button on the lid and pull the lid handle up to a 90° angle and lift the lid off the blender pitcher.
- CAUTION:** Stacked Blade Assembly is not locked in place and is removable. If pouring with the lid removed, ALWAYS remove the Stacked Blade Assembly first.
- Make sure that the unit is unplugged when not in use.
 - To release the motor base from the counter or table top, place your hands underneath both sides of the motor base and gently pull the unit up and towards you. (Fig. 9)

USING THE CHOPPING BLADE ASSEMBLY

- Place the motor base on a clean, dry, level surface such as a counter or table top.
 - Secure the bowl onto the motor base.
 - Holding the Chopping Blade Assembly by the shaft, place it onto the gear shaft inside the bowl. Ensure that the Chopping Blade Assembly fits around the gear shaft and that it is standing straight. (Fig. 1)
 - Add the ingredients and secure the bowl lid onto the bowl. (Fig. 1)
 - Plug the power cord into the electrical outlet and press on the power button (⏻). (Fig. 2) Select the speed that best suits your needs. Pulse ingredients for even chopping by pressing down in short intervals.
- NOTE:** Please refer to "Speed Settings & Uses" chart for suggested uses and speeds.
- When you have reached your desired consistency, stop the appliance by pressing the power button (⏻) and wait for the blade to stop turning.
 - To remove the lid, press the release button on the lid and pull the lid handle up to a 90° angle. (Fig. 2)
 - Turn the bowl counter-clockwise and lift it to remove it from the motor base. (Fig. 3)
- CAUTION:** If pouring from the bowl, ALWAYS remove the blade assembly first before pouring.
- To release the motor base from the counter or table top, place your hands underneath both sides of the motor base and gently pull the unit up and towards you. (Fig. 4)

USING THE DOUGH BLADE ASSEMBLY

- IMPORTANT:** Use only the "DOUGH" button when using this attachment.
- Place the motor base on a clean, dry, level surface such as a counter or table top.
 - Secure the bowl onto the motor base.
 - Holding the Dough Blade Assembly by the shaft, place it onto the gear shaft inside the bowl. Ensure that the Dough Blade Assembly fits around the gear shaft and that it is standing straight. (Fig. 5)
 - Add the ingredients and secure the bowl lid onto the bowl. (Fig. 5)
 - Plug the power cord into the electrical outlet and press on the power button (⏻).
 - To remove the lid, press the release button on the lid and pull the lid handle up to a 90° angle. (Fig. 2)
 - Turn the bowl counter-clockwise and lift it to remove it from the motor base. (Fig. 3)
 - To release the motor base from the counter or table top, place your hands underneath both sides of the motor base and gently pull the unit up and towards you. (Fig. 4)

Assembly and Use for the Nutri Ninja® Cup

- WARNING:** Never leave the appliance unattended while in use.
- WARNING:** Remove utensils prior to processing. Failure to remove may cause the container to be damaged or to shatter, which may cause personal injury.
- CAUTION:** Handle the Nutri Ninja Blade Assembly with care, as the blades are very sharp.
- CAUTION:** Do not blend hot liquids.
- IMPORTANT:** Make sure that the motor base is plugged in for use.

ASSEMBLY

USE

REMOVAL

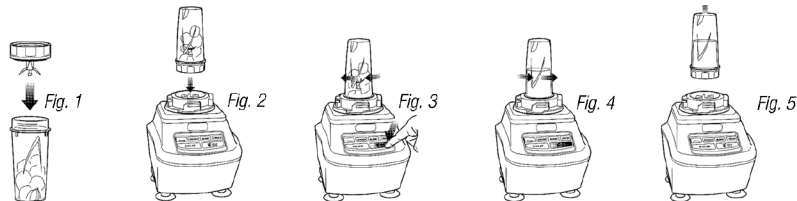

For best results, use short "PULSES"... Practice makes perfect!!

- Place the motor base on a clean, dry, level surface such as a counter or table top.
- Add ingredients to the Nutri Ninja cup.
- Place the Nutri Ninja Blade Assembly onto the cup and screw it tightly until you have a good seal. (Fig. 1)
- Turn the Nutri Ninja cup upside down and place it onto the motor base, aligning the tabs on the cup with the motor base. Turn the Nutri Ninja cup clockwise to lock into place. You will hear a click when the lock is engaged. (Fig. 2) Turn the power button on, the Single Serve button will illuminate.
- Press down on the Single Serve button in short intervals to activate. (Fig. 3)
- Once you have reached your desired consistency, turn the power button off. Turn the Nutri Ninja cup counter clockwise and pull straight up to remove. (Fig. 4, Fig. 5)

- NOTE:** Do not overfill! To avoid spilling, do not add ingredients past the "Max" fill line.
- Turn the cup upright and remove the Nutri Ninja Blade Assembly by twisting the blade assembly clockwise.
 - Place the To-Go drinking lid onto the Nutri Ninja cup, twist to seal and enjoy!
 - Make sure that the motor base is unplugged when not in use.
 - To release the motor base from the counter or table top, place your hands underneath both sides of the motor base and gently pull the unit up and towards you. (Fig. 6)

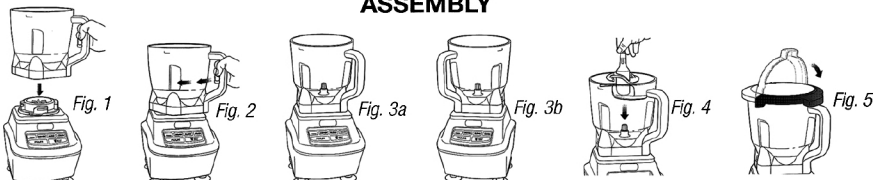

Fig. 6

Assembly and Use for the 64 oz. Bowl

- WARNING:** Never leave the appliance unattended while in use.
- WARNING:** Remove utensils prior to processing. Failure to remove may cause the container to be damaged or to shatter, which may cause personal injury.
- CAUTION:** Handle the Chopping Blade Assembly with care, as the blades are very sharp.
- CAUTION:** Do not blend hot liquids.
- IMPORTANT:** Make sure that the motor base is plugged in for use.

ASSEMBLY



- Place the motor base on a clean, dry, level surface such as a counter or table top.
 - Align and lower the Bowl onto the motor base. (Fig. 1) Handle should be aligned slightly to the right of the "LOCK" symbol on the motor base.
 - Rotate the bowl clockwise as far as it will go to lock in place. (Fig. 2)
 - The bowl can be placed on the motor base two ways; the handle can be on the front right corner or the front left corner. (Fig. 3a, Fig. 3b)
 - Holding the desired blade assembly by the top of the shaft, place it onto the drive gear inside the bowl. Ensure that the blade assembly is seated properly and is standing upright. (Fig. 4)
- NOTE:** The blade assembly will fit loosely on the drive gear.
- Add the ingredients to the bowl, making sure that they do not exceed the highest measured marking line on the side of the bowl.

- Holding the lid by the handle in the upright position, place it on top of the bowl aligning the arrow (▼) located on the lid with the arrow (▲) located on the bowl's handle. (Fig. 5) Press the handle down until you hear a click.

NOTE: The 64 oz. bowl is not intended for blending drinks. Do not overfill.

- Plug the power cord into the electrical outlet and press the power button (⏻).

IMPORTANT: As a safety feature, the power button (⏻) will flash and the motor will not work if the bowl and lid are not installed correctly. When the bowl and lid are installed properly, the power button (⏻) will be solid, indicating that the appliance is ready for use.

USE

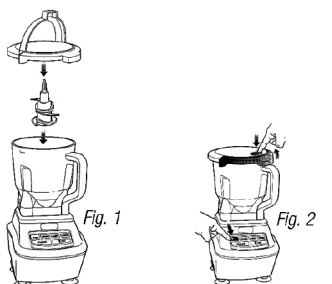

REMOVAL

USE



Illustrations may differ from actual product.

Speed Setting & Uses

FUNCTION	CONTAINER	ATTACHMENT	SPEED BUTTON	TYPE OF FOOD
Nutri Ninja® Blending	Nutri Ninja Cup	Nutri Ninja Blade Assembly	Single Serve	Smoothies Frappes Milk Shakes
Mincing	Nutri Ninja Cup	Nutri Ninja Blade Assembly	Single Serve	Onion Garlic Herbs
Kneading	Bowl	Dough Blade Assembly	Dough	Bread dough Pie dough Pizza dough Pretzel dough
Dough Mixing	Bowl	Dough Blade Assembly	Dough	Cookie dough
Processing	Pitcher/Bowl Nutri Ninja Cup	Stacked Blade Assembly Chopping Blade Assembly Nutri Ninja Blade Assembly	Blend Pulse Single Serve	Pâtés Stewed fruits Dips Apple sauce Spreads Soups* Baby food
Emulsifying	Bowl	Chopping Blade Assembly	Blend	Salad Dressings Dips Sauces*
Grinding	Bowl	Chopping Blade Assembly	Blend	Meat
Grating	Bowl Nutri Ninja Cup	Chopping Blade Assembly Nutri Ninja Blade Assembly	Crush Pulse Single Serve	Grated cheese Bread crumbs Spices
Chopping	Bowl Nutri Ninja Cup Pitcher	Chopping Blade Assembly Nutri Ninja Blade Assembly Stacked Blade Assembly	Pulse Single Serve Crush	Salsa Vegetables Nuts
Mixing	Bowl	Dough Blade Assembly	Dough	Light cake mixes Batters
Ice Crushing	Pitcher Nutri Ninja Cup	Stacked Blade Assembly Nutri Ninja Blade Assembly	Crush Single Serve	Ice
Pureeing	Pitcher Nutri Ninja Cup	Stacked Blade Assembly Nutri Ninja Blade Assembly	Crush Single Serve	Smoothies Smooth soups Milkshakes

* When blending blending sauces and soups, make sure they're cooled to room temperature first - Ninja® containers are not intended for hot blending.

Care & Maintenance

HOW TO CLEAN

- CAUTION:** Make sure that the motor base is unplugged from the power source before inserting or removing any attachment and before cleaning.
- CAUTION:** DO NOT immerse the motor base into water or any other liquid.
- CAUTION:** Handle the blade assemblies with care, as the blades are very sharp.

NOTE: All jars, lids, discs and blade assemblies are dishwasher safe. Place the lids and blade assemblies on the top rack only. All jars, lids and plastic components of blade are BPA free.

- Separate/remove all parts from each other.
 - Clean the motor base with a damp cloth and wipe dry.
 - Place the pitcher, Nutri Ninja® cup and bowl in the dishwasher. Place the lids and blade assemblies on the top rack.
- OR**
- Carefully hand wash the lids, pitcher, bowl, Nutri Ninja cups and blade assemblies in warm, soapy water with a soft cloth.

HOW TO STORE

- Store the **Ninja® Supra Kitchen System** upright with the pitcher on the motor base, Stacked Blade Assembly inside the pitcher and lid locked on the

pitcher. Do not place anything on top. Store the Food Processor Bowl with the Chopping Blade Assembly inside and the lid locked on the bowl. Store the Nutri Ninja™ cup with the Nutri Ninja Blade Assembly attached to the cup and all other attachments along side the appliance or in a cabinet where they will not be damaged and won't cause a hazard.

RESETTING THE MOTOR THERMOSTAT

The **Ninja Supra Kitchen System** features a unique safety system which prevents damage to the unit's motor and drive system should you inadvertently overload your appliance. **If the appliance is being overloaded, the motor will stop. Allow the appliance to cool for approximately 15 minutes.** To reset the appliance, follow the resetting procedure below:

- Unplug the appliance from the electrical outlet.
- Remove and empty the container and ensure that no food is jamming the blade assembly.
- Allow the appliance to cool for approximately 15 minutes.
- Re-install the container onto the base and re-plug the appliance into the electrical outlet.
- Proceed to use the appliance as before making sure not to exceed the recommended maximum capacities.

Troubleshooting Guide

PROBLEMS	POSSIBLE REASONS & SOLUTIONS
Motor Doesn't Start or Blade Assembly Doesn't Rotate.	Make sure the container is securely placed on motor base. Make sure the lid is securely on container in the correct position (align arrows). The appliance is turned "Off". Press the power button (⏻) to turn "On". Check that the plug is securely inserted into the electrical outlet. Check the fuse or circuit breaker. The unit has overheated or overcharged. Unplug and wait approximately 15 minutes before using again. Check to make sure the unit is not overloaded.
Food is Unevenly Chopped.	Either you are chopping too much food at one time, or the pieces are not of even size and processing smaller amounts per batch.
Food is Chopped Too Fine or is Too Watery.	The food has been over processed. Use pulse button for controlled processing.
Food Collects On Lid or On the Sides of the Container.	The mixture is too thick. Add more liquid.
You Cannot Achieve Snow From Solid Ice.	Do not use ice that has been sitting out or has started to melt. Use ice straight from the freezer.
Motor Base Won't Stick to Counter or Table Top.	Make sure surface and suction feet are wiped clean. Suction feet will only stick to smooth surfaces. Suction feet WILL NOT stick on some surfaces such as, wood, tile and non-polished finishes. DO NOT attempt to use appliance when the motor base is stuck to a surface that is not secure, (cutting board, platter, plates, etc.).



PRINTED IN MEXICO SC: 06-13-2017_8P
OBPN: BL780_30_IB_150924_1 Elbrd: Y.T.
SC: 12-03-2018_TAB (ReDesign) MODEL: BL780_B

8 0 4 1 0 6 3 2 4