

NINJA®

NUTRI-BLENDER

OWNER'S GUIDE

TECHNICAL SPECIFICATIONS

Voltage: 120V-, 60Hz

PLEASE READ CAREFULLY AND KEEP FOR FUTURE REFERENCE.



804106516

Recipe book is not included.

IMPORTANT SAFETY INSTRUCTIONS

PLEASE READ CAREFULLY BEFORE USE • FOR HOUSEHOLD USE ONLY

	Read and review instructions for operation and use.
	Indicates the presence of a hazard that can cause personal injury, death or substantial property damage if the warning included with this symbol is ignored.
	For indoor and household use only.
When using electrical appliances, basic safety precautions should always be followed, including the following:	

⚠ WARNING

To reduce the risk of fire, electric shock, serious injury, death, or damage when using this appliance, follow these basic safety precautions.

General Precautions

- 1 Read all instructions prior to using the appliance and its accessories.
- 2 Carefully observe and follow all warnings and instructions. This unit contains electrical connections and moving parts that potentially present risk to the user.
- 3 **ALWAYS** exercise care when handling the Pro Extractor Blades® Assembly. The blades are sharp, handle carefully. **ONLY** grasp the Pro Extractor Blades Assembly by the outer perimeter of the blade assembly base. Failure to use care when handling the blade assembly will result in a risk of laceration.
- 4 Take your time and exercise care during unpacking and appliance setup. This appliance contains sharp, loose blades that can cause injury if mishandled.
- 5 Take inventory of all contents to ensure you have all parts needed to properly and safely operate your appliance.
- 6 Blades are sharp. Handle carefully.
- 7 Unplug the appliance from the outlet when not in use, before assembling or disassembling parts, and before cleaning. To unplug, grasp the plug by the body and pull from the outlet. **NEVER** unplug by grasping and pulling the flexible cord.
- 8 Before use, wash all parts that may contact food. Follow washing instructions covered in this instruction manual.
- 9 To protect against the risk of electric shock, **DO NOT** submerge the appliance or allow the power cord to contact any form of liquid.
- 10 **DO NOT** use this appliance outdoors. It is designed for indoor household use only.
- 11 This appliance has important markings on the plug blade. The attachment plug or entire cordset (if plug is molded onto cord) is not suitable for replacement. If damaged, the appliance shall be replaced.
- 12 This appliance has a polarized plug (one prong is wider than the other). To reduce the risk of electric shock, this plug will fit in a polarized outlet only one way. If the plug does not fit fully in the outlet, reverse the plug. If it still does not fit, contact a qualified electrician. **DO NOT** modify the plug in any way.
- 13 **DO NOT** operate any appliance with a damaged cord or plug, or after the appliance malfunctions or is dropped or damaged in any manner. This appliance has no user-serviceable parts. If damaged, contact a service center.
- 14 Extension cords should **NOT** be used with this appliance.
- 15 **DO NOT** allow children to operate this appliance or use as a toy. Close supervision is necessary when any appliance is used near children.
- 16 This appliance is **NOT** intended to be used by people with reduced physical, sensory, or mental capabilities, or lack of experience and knowledge, unless they have been given supervision or instruction concerning use of the appliance by a person responsible for their safety.
- 17 Before each use, inspect blade assembly for damage. If a blade is bent or damage is suspected, contact a service center.
- 18 **DO NOT** attempt to sharpen blades.
- 19 **DO NOT** allow the unit or the cord to hang over the edges of tables or counters. The cord may become snagged and pull the appliance off the work surface.
- 20 **DO NOT** allow any part of the unit to contact hot surfaces, including stoves and other heating appliances.
- 21 **ALWAYS** use the appliance on a dry and level surface.
- 22 **NEVER** place a blade assembly on the power pod without it first being attached to the cup.
- 23 Keep hands, hair, and clothing out of the container when loading and operating
- 24 **ONLY** use attachments and accessories that are provided with the product or are recommended by SharkNinja. The use of attachments including canning jars not recommended or sold by SharkNinja may cause fire, electric shock, or injury.
- 25 During operation and handling of the appliance, avoid contact with moving parts.
- 26 **DO NOT** operate the appliance with an empty container.
- 27 **DO NOT** fill containers past the **MAX FILL** or **MAX LIQUID** lines.
- 28 **DO NOT** microwave any containers or accessories provided with the appliance.
- 29 **DO NOT** perform grinding operations.

- 30 Before operation, ensure all utensils are removed from containers. Failure to remove utensils can cause containers to shatter and potentially result in personal injury and property damage.
- 31 **NEVER** operate the appliance without lids and caps in place. **DO NOT** attempt to defeat the interlock mechanism. Ensure the container and lid are properly installed before operation.
- 32 **DO NOT** expose the containers and accessories to extreme temperature changes. They may experience damage.
- 33 **NEVER** leave the appliance unattended while in use.
- 34 **DO NOT** blend hot liquids. Doing so may result in pressure buildup and steam exposure that can pose a risk of the user being burned.
- 35 If you find unmixed ingredients sticking to the sides of the cup, stop the appliance, remove the blade assembly, and use a scraper to dislodge ingredients.
- 36 **DO NOT** attempt to remove the container and lids from the power pod while the blade assembly is still spinning. Allow the appliance to come to a complete stop before removing lid and container.
- 37 Remove the Pro Extractor Blades® Assembly from the Ninja® Cup upon completion of blending. **DO NOT** store ingredients before or after blending them in the cup with the blade assembly attached. Some foods may contain active ingredients or release gases that will expand if left in a sealed container, resulting in excessive pressure buildup that can pose a risk of injury. For ingredient storage in the cup, use only Spout Lid to cover.
- 38 If the appliance overheats, a thermal switch will activate and temporarily disable the motor. To reset, unplug the appliance and allow it to cool for approximately 15 minutes before using again.
- 39 The maximum wattage rating for this appliance is based on the configuration of the Pro Extractor Blades Assembly and Ninja Cup. Other configurations may draw less power or current.
- 40 **DO NOT** process dry ingredients without adding liquid to the cup. It is not intended for dry blending.
- 41 To protect against risk of electrical shock, **DO NOT** immerse the power pod in water or other liquid. Unplug the power pod before cleaning.

SAVE THESE INSTRUCTIONS

BEFORE FIRST USE

DID YOU KNOW?

- You can take your drinks on the go using the Spout Lids or Storage Lid.
- The containers, lids, and blade assembly are BPA free and dishwasher safe.

- 1 Remove all packaging materials from the appliance. Exercise care when unpacking blade assembly, as the blades are sharp.
- 2 Wash containers, lids, and blade assembly in warm, soapy, water using a dishwashing utensil with a handle to avoid direct contact with the blades. Exercise care when handling blade assembly, as the blades are sharp.
- 3 Thoroughly rinse and air-dry all parts.

NOTE: Handle the Pro Extractor Blades® Assembly by grasping around the perimeter of the blade assembly base.

NOTE: All attachments are dishwasher safe. Ensure blade assembly and lids are removed from their containers before placing in the dishwasher. Exercise care when handling blade assembly.

NOTE: In order to ensure the highest possible standard for refurbished items, all units are thoroughly inspected as part of the process. For this item, water may be used during the refurbishing process and so; you may notice some condensation in the water reservoir. It is recommended to rinse the water reservoir with fresh water prior to its first use.

GETTING TO KNOW YOUR NINJA® NUTRI-BLENDER

- A** Power Pod
- B** Ninja Cup
- C** Pro Extractor Blades® Assembly
- D** Spout Lid
- E** Storage Lid *included with some models

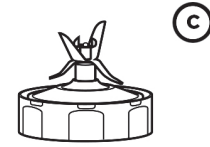

NOTE: Accessory type, appearance and quantity may vary depending on the model.

CARE & MAINTENANCE

CLEANING

- 1 Separate all parts.
- 2 Wash all containers in warm, soapy water with a soft cloth.

Hand-Washing

Wash cups, lids, and blade assembly in warm, soapy water. Use a dishwashing utensil with a handle to avoid direct contact with the blades. Exercise care when handling the blade assembly as the blades are sharp. Thoroughly rinse and air-dry all parts.

Dishwasher

Cups, lids, and blade assembly are dishwasher safe. Ensure the blade assembly and lid are removed from the cup before placing in the dishwasher.

Power Pod

Unplug the power pod before cleaning. Wipe power pod with a clean, damp cloth.

NEVER directly spray the pod with water or other liquids.

DO NOT use abrasive cloths/pads/brushes to clean the pod, as this can dull or scratch the surface.

RESETTING THE MOTOR THERMOSTAT

This unit features a unique safety system that prevents damage to the motor and drive system should you inadvertently overload it. If the unit is overloaded, the motor will be temporarily disabled. Should this occur, follow the reset procedure below.

- 1 Unplug the power pod.
- 2 Allow the power pod to cool for approximately 15 minutes.
- 3 Remove the blade assembly. Empty the container and ensure no ingredients are jamming the blade assembly.

IMPORTANT: Ensure that maximum capacities are not exceeded. This is the most typical cause of appliance overload.

USING THE NINJA® NUTRI-BLENDER

- 1 Plug in power pod and place on a clean, dry, level surface such as a countertop or table.



- 2 Add ingredients to the Ninja Cup. **DO NOT** add ingredients past the **MAX LIQUID** line on the cup.



- 3 Place the Blade Assembly on the top of the cup and turn clockwise to seal.

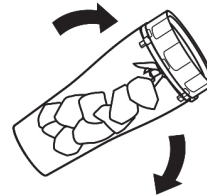

- 4 Turn cup upside down so the bottom of the blade assembly is flat on the worktop.

- 5 Place the cup on the power pod. Press down on the cup to pulse or blend.

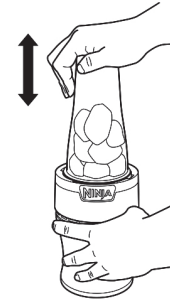

- 6 When blending is complete, lift up the cup to remove.

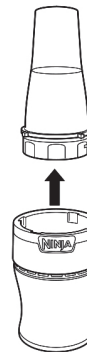

- 7 Turn cup over so blade assembly is on top. Twist blade assembly counterclockwise to remove. To take your blended contents on the go, place the spout lid on cup and turn clockwise to seal. Do not store with the blades attached.

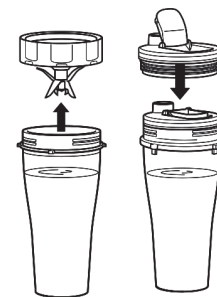

TROUBLESHOOTING GUIDE

⚠ WARNING: To reduce the risk of shock and unintended operation, turn power off and unplug unit before troubleshooting.

Motor Doesn't Start or Blade Assembly Doesn't Rotate.

- Check that the power pod is clean and there is no food blocking connection when placing on containers.
- There is too much food in the container. Remove some ingredients to be below the maximum liquid line and try blending again.
- The unit has overheated. Unplug and wait approximately 15 minutes before using again.
- Check that the plug is securely inserted into the electrical outlet or try another outlet.

Food is Unevenly Chopped.

Either there is too much food in the container, or the pieces are too big. Try cutting the food into smaller pieces of even size and processing smaller amounts per batch.

Food is Chopped Too Fine or is Too Watery.

The food has been over processed. Use brief pulses or process for shorter time. Let the Pro Extractor Blades® Assembly come to a complete stop between pulses.

You Cannot Achieve Snow From Solid Ice.

Do not use ice that has been sitting out or has started to melt. Be sure to use short pulses in the beginning to break up large pieces.

REFURBISHED PRODUCT LIMITED NINETY DAYS WARRANTY

The **Refurbished Product Service Center** offers the following WARRANTY to the ORIGINAL purchaser of a product which we have refurbished.

This product that has been refurbished is warranted against any electronic or mechanical defects for a period of NINETY DAYS from the date of the original purchase by the consumer. Since this unit was sold as a refurbished item, the warranty does not apply to any cosmetic appearance items such as scratches. Should a defect occur, the **Refurbished Product Service Center** will repair or, at its option, replace defective unit/parts with new or rebuilt materials without charge for either parts or labor. Replacement unit/parts will be warranted for the remaining portion of the original warranty period.

This warranty does not cover installation or damage from accident, misuse, abuse, improper wiring, incorrect voltage, operating the unit against the instructions in the owner's manual or any product which has been opened, altered, or tampered with.

This warranty does not cover costs for removal and or installation of the unit for repair. Under no circumstances shall the service center be liable for any special, incidental or consequential damages or for any other expenses incurred by reason of use or sale of this product. This warranty is in lieu of any other warranties expressed or implied warranty of merchantability of fitness for particular use or otherwise.

This warranty gives the consumer specific legal rights and they may also have other rights which vary from State to State. Some States do not follow the exclusion or limitation of incidental or consequential damages, hence the above exclusion and limitations may not apply.

Refurbished Product Service Center
13225 Marquardt Avenue Santa Fe Springs, CA 90670.

WARRANTY REPAIR INFORMATION

If you need service on your unit and this product requires repair during the 90 days warranty period; please go to www.ConsumerServiceRefurbish.com or call the **Refurbished Product Service Center** at 562-946-3531 to obtain the required return authorization (RA) number. Pack the unit properly (the original carton is ideal for this purpose) along with a copy of your purchase receipt and a letter describing the problem. Send the unit freight prepaid and insured to:

Refurbished Product Service Center,
Att: Customer Service Department 13225 Marquardt Avenue Santa Fe Springs, CA 90670

Your unit will be promptly repaired and returned to you.

We will refuse to accept delivery of the returned unit unless the assigned RA number appears on the outside of the shipping carton.

Owner's Information
(Keep for your permanent records)

NAME: _____
ADDRESS: _____
CITY: _____ STATE: _____ ZIP CODE: _____
PHONE: _____ E-MAIL: _____
MODEL: _____ SERIAL NO.: _____

PRINTED IN MEXICO/ SC:07.21.2021
obpn:BN300Series_IB_MP_Mv6_201109
shnmd:BN300_30_BP - Pags:TAB elbr:m.c.

8 0 4 1 0 6 5 1 6



Note: The images shown here are for illustrative purpose only and may be subject to change.