



Recipe book is not included.

804106999A

FOODI® POWER MIXER™ SYSTEM

IMPORTANT SAFETY INSTRUCTIONS

PLEASE READ CAREFULLY BEFORE USE • FOR HOUSEHOLD USE ONLY

	Read and review instructions for operation and use.
	Indicates the presence of a hazard that can cause personal injury, death or substantial property damage if the warning included with this symbol is ignored.
	For indoor and household use only.
When using electrical appliances, basic safety precautions should always be followed, including the following:	

WARNING

To reduce the risk of injury, fire, electrical shock or property damage, basic safety precautions must always be followed, including the following numbered warnings and subsequent instructions. Do not use appliance for other than intended use.

- 1 Read all instructions prior to using the appliance and its accessories.
- 2 Carefully observe and follow all warnings and instructions. This unit contains electrical connections and moving parts that potentially present risk to the user.
- 3 **ALWAYS** exercise care when handling the immersion blender attachment. The blades are sharp; handle carefully. **ONLY** grasp the immersion blender attachment by the upper bell or shaft. Failure to use care when handling the immersion blender attachment will result in a risk of laceration.
- 4 Immersion blender arm blades are sharp. Handle carefully.
- 5 Before each use, inspect blades for damage. If a blade is bent or damage is suspected, contact a service center.
- 6 **DO NOT** attempt to sharpen blades.
- 7 Take your time and exercise care during unpacking and appliance setup. This appliance contains sharp, loose blades that can cause injury if mishandled.
- 8 Take inventory of all contents to ensure you have all parts needed to properly and safely operate your appliance.
- 9 Unplug the appliance from the outlet when not in use, before assembling or disassembling parts, and before cleaning. To unplug, grasp the plug by the body and pull from the outlet. **NEVER** unplug by grasping and pulling the flexible cord.
- 10 Before use, wash all parts that may contact food. Follow washing instructions covered in this instruction manual.
- 11 To protect against the risk of electric shock, **DO NOT** submerge the power base, hand mixer attachment. **DO NOT** allow the power cord to contact any form of liquid. Unplug the power base before cleaning.
- 12 Remove any accessories from the hand mixer attachment before washing.
- 13 **DO NOT** use this appliance outdoors. It is designed for indoor household use only.
- 14 This appliance has important markings on the plug. The attachment plug or entire cordset (if plug is molded onto cord) is not suitable for replacement. If damaged, the appliance shall be replaced.
- 15 This appliance has a polarized plug (one prong is wider than the other). To reduce the risk of electric shock, this plug will fit in a polarized outlet only one way. If the plug does not fit fully in the outlet, reverse the plug. If it still does not fit, contact a qualified electrician. **DO NOT** modify the plug in any way.
- 16 **DO NOT** operate any appliance with a damaged cord or plug, or after the appliance malfunctions or is dropped or damaged in any manner. This appliance has no user-serviceable parts. If damaged, contact a service center.
- 17 Extension cords should **NOT** be used with this appliance.
- 18 **DO NOT** allow children to operate this appliance or use as a toy. Close supervision is necessary when any appliance is used near children.
- 19 This appliance is **NOT** intended to be used by people with reduced physical, sensory, or mental capabilities, or lack of experience and knowledge, unless they have been given supervision or instruction concerning use of the appliance by a person responsible for their safety.
- 20 Fully unwind the power cord before use. **DO NOT** allow the unit or the cord to hang over the edges of tables or counters. The cord may become snagged and pull the appliance off the work surface.
- 21 **DO NOT** allow any part of the unit to contact hot surfaces, including stoves and other heating appliances.
- 22 **ALWAYS** use the appliance on a dry and level surface.
- 23 Keep hands, hair, and clothing out of the container when loading and operating.
- 24 **ONLY** use attachments and accessories that are provided with the product or are recommended by SharkNinja. The use of attachments not recommended or sold by SharkNinja may cause fire, electric shock, or injury.
- 25 During operation and handling of the appliance, avoid contact with moving parts.
- 26 **DO NOT** operate the appliance with an empty container.
- 27 **DO NOT** microwave any containers or accessories with the appliance, except the blending vessel.
- 28 **DO NOT** perform grinding operations.
- 29 Before operation, ensure all utensils are removed from containers. Failure to remove utensils can cause containers to shatter and potentially result in personal injury and property damage.
- 30 **DO NOT** expose the containers and accessories to extreme temperature changes. They may experience damage.
- 31 **NEVER** leave the appliance unattended while in use.
- 32 **DO NOT** process dry ingredients without adding liquid to the immersion blender. They are not intended for dry blending.
- 33 Keep hands and utensils out of containers while processing to reduce the risk of severe personal injury or damage to the unit. A scraper may be used **ONLY** when the unit is not running.
- 34 Immediately release the power button on the power base in the event that the appliance malfunctions during the immersion blender. Immediately press the power button on the hand mixer handle in the event that the appliance malfunctions during use of the hand mixer.
- 35 Make sure that the power base is securely attached to the hand mixer attachment, immersion blender attachment.
- 36 Always ensure the hand mixer accessories are fitted securely in place into the hand mixer attachment before processing.
- 37 **DO NOT** use containers if they are cracked or chipped.
- 38 To avoid contact with steam and hot surfaces, **DO NOT** reach across top of vessel in which you are processing.
- 39 If the appliance overheats, a thermal switch will activate and temporarily disable the motor. To reset, unplug the appliance and allow it to cool for approximately 15 minutes before using again.

SAVE THESE INSTRUCTIONS

PARTS

NOTE: Attachments and accessories vary by model.

- A Power Base (attached power cord not shown)
- B Hand Mixer Attachment
- C Immersion Blender Attachment
- D Beater
- E Whisk*

*Not included with all models

There are a variety of accessories that are compatible with this Power Mixer™ System series.

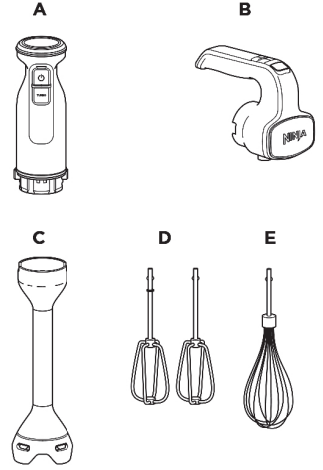

The images shown here are for illustrative purposes only and may be subject to change.

BEFORE FIRST USE

IMPORTANT: Review all warnings before proceeding

NOTE: Attachments and accessories vary by model.

- 1 Remove all packaging materials from the unit. Exercise care when unpacking the immersion blender attachment.
- 2 Wash immersion blender attachment, beaters, whisk, and warm, soapy water. Use a dishwashing utensil with a handle to avoid direct contact with the blades on the immersion blender attachment. Exercise care when handling blade assemblies, as blades are sharp. Thoroughly rinse and air-dry all parts.
- 3 Wipe the power base, hand mixer attachment with clean, damp cloth.

CONTROL PANEL

USING THE HAND MIXER CONTROL PANEL

- 1 **EJECT**
Push to remove the beaters or other accessories.
- 2 **SPEED RANGE INDICATOR**
LEDs illuminate to indicate speed settings 1 through 5.
- 3 **POWER**
Press to turn the unit on or off.
- 4 **TURBO**
Press and **hold** to quickly jump to speed 5.
- 5 **SPEED SELECTOR**
Increase or decrease speed by pressing the up and down arrow buttons.

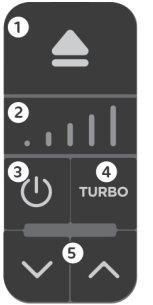

USING THE IMMERSION BLENDER CONTROL PANEL

- 1 **POWER**
Press and **hold continuously** to blend. The unit will not blend unless the power button is pressed down.
- 2 **TURBO**
While continuously holding the , press and hold the **TURBO** button to ramp up to high speed. By default, the unit will start on low speed.

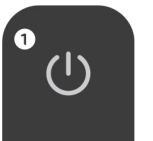

The actual descriptions of control panel and their locations may vary, depending on the model.

HAND MIXER ATTACHMENT ASSEMBLY (accessories vary by model)

IMPORTANT:

- Review all warnings before proceeding
- The hand mixer attachment is **NOT** dishwasher safe.

- 1 Install the hand mixer attachment to the power base by aligning the arrow on the power base with the arrow on the mixer attachment. Then, push the power base onto the attachment to lock into place.

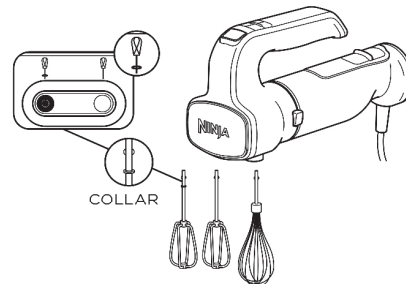
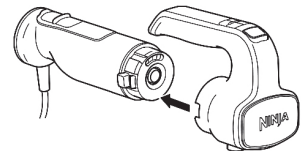

- 2 Attach both beaters, the whisk using the accessory slots on the mixer head. Insert the beater with the collar into the slot with the diagram showing a collar. The whisk can be inserted into either slot. You will hear a slight click when locked in place.

- 3 Plug the unit in and power on. The unit will begin mixing on speed 1. Use the speed selector to increase or decrease speed.

Speeds 1 & 2	Use speeds 1-2 when combining dry ingredients, such as flour, into liquid ingredients and when making thicker doughs, such as bread doughs.
Speeds 3 & 4	Use speeds 3-4 when making cookie doughs, batters, quick breads, frostings, and most other recipes.
Speed 5	Use speed 5 for whipping cream, mousse, or egg whites.

NOTE: Start on speed 1, then slowly ramp up to prevent ingredients from splattering.

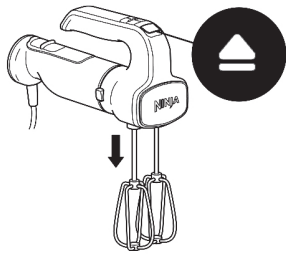

- 4 Press \odot to turn the unit off. To remove the beaters or other accessories, press the eject button. Ensure the beaters or other accessories come to a complete stop before pressing the eject button.

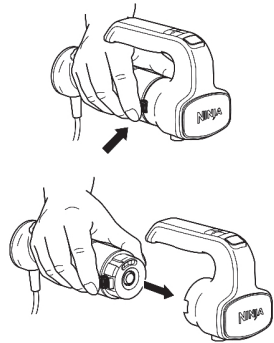

- 5 To remove the power base from the hand mixer attachment, first press the power button to turn the unit off, then unplug the unit. Press and hold the release buttons on either side of the power base to remove the mixer attachment.
- 6 Refer to the Care & Maintenance section for cleaning and storage instructions.

IMMERSION BLENDER ATTACHMENT ASSEMBLY (accessories vary by model)

IMPORTANT: Review all warnings before proceeding

- 1 Install the immersion blender attachment to the power base by aligning the arrow on the power base with the arrow on the immersion blender attachment. Then, push the power base onto the attachment to lock into place. Plug the unit in.

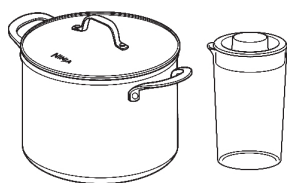
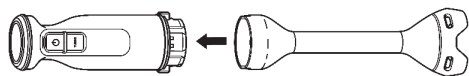

- 2 Prior to blending, make sure to use a container large enough to fully submerge the blender head in ingredients. Once submerged, there should be ample room in the container to avoid overflowing and splashing.

Blending Vessel (not included)

- 3 Submerge the vents of the blender head in the ingredients. Press and **hold** the \odot while using an up-and-down motion to blend, making sure to stop blending anytime the vents are no longer submerged. While continuously holding \odot to blend, press and hold the TURBO button to ramp up to high speed.

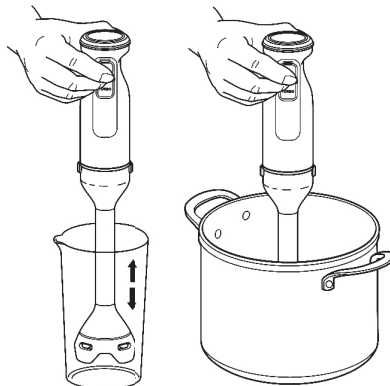

LOW	Use to blend liquids, such as mayo or dressing, or soups and sauces with soft ingredients, such as tomato sauce.
TURBO	Use for tougher ingredients, such as butternut squash, or for smooth purees, such as hummus.

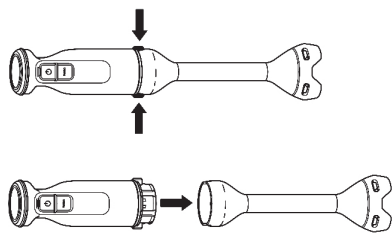

- 4 To remove the power base from the immersion blender attachment, first unplug the unit. Press and hold the release buttons on either side of the power base to remove the immersion blender attachment.

- 5 Refer to the Care & Maintenance section for cleaning and storage instructions.

The images shown here are for illustrative purposes only and may be subject to change.

CARE & MAINTENANCE

CLEANING

• Hand-Washing

Wash immersion blender attachment, beaters and whisk, in warm, soapy water. Use a dishwashing utensil with a handle to avoid direct contact with the blades on the immersion blender attachment.

• Dishwasher

All attachments, with the exception of the power base processing and hand mixing attachment, are dishwasher safe.

• Motor Base, Hand Mixer Attachment

Unplug the power base before cleaning. Wipe the power base and hand mixing attachment with a clean, damp cloth. Do not submerge these parts in water.

• STORING

For cord storage, wrap the cord with the plastic clip.

* Accessory type and quantity may vary depending on the model.

RESETTING THE MOTOR

This unit features a unique safety system that prevents damage to the motor and drive system should you inadvertently overload it. If the unit is overloaded, the motor will be temporarily disabled. Should this occur, follow the reset procedure below.

- 1 Unplug the unit from the electrical outlet.
- 2 Allow the unit to cool for approximately 15 minutes.
- 3 Remove the attachment. Make sure no ingredients are jamming the accessory.

If your unit needs servicing, please contact a service center.

NOTE:

In order to ensure the highest possible standard for refurbished items, all units are thoroughly inspected as part of the process. For this item, water may be used during the refurbishing process and so; you may notice some condensation in the water reservoir. It is recommended to rinse the water reservoir with fresh water prior to its first use.

TROUBLESHOOTING GUIDE

⚠ WARNING: To reduce the risk of shock and unintended operation, turn power off and unplug unit before troubleshooting.

Unit doesn't turn on.

- Ensure the unit is plugged into a working outlet.
- Make sure to fully lock an attachment onto the power base. Align the arrow on the power base with the arrow on the desired attachment. Then push the power base onto the attachment to lock in place.
- Check that the bottom of power base is clean and there is no food blocking connection when installing attachments.
- When using the chopper, make sure that the blade is properly installed and the processing lid is sitting in the notches of the chopper bowl.

Hand mixer control panel is illuminated but mixer will not start.

- Press power (\odot) on the hand mixer handle, and the unit will automatically start.

Cannot install hand mixer accessories or hand mixer accessories are wobbly when installed.

- To install the hand mixer accessories, match the beater that has the collar (the disc on the shaft) to the hole on the hand mixer with the icon of a collar.

Hand mixer is spraying ingredients.

- Use speed 1 when combining dry and liquid ingredients.
- Start on speed 1 and slowly ramp up to prevent ingredients from splattering.

Immersion blender will only run momentarily.

- Press and **hold** the \odot to blend. Holding the power button continuously to blend ensures that the blade only runs when you're in control.

Immersion blender is spraying ingredients.

- We recommend using a cooking pot, a large glass measuring container (not included with all models) to blend ingredients.
- The container should be large enough for the blender head to be fully submerged in the ingredients, along with ample room in the container to avoid overflowing and splashing.
- Submerge the vents of the blender head in the ingredients. Move the immersion bell in an up-and-down motion through the ingredients to blend, making sure to stop blending anytime the vents are not submerged.

Food is stuck in immersion blender blade.

- Power the unit off and unplug the power base. Use a spatula or other kitchen utensil to dislodge the food. Handle the immersion blender attachment with care and do not attempt to dislodge food using your hand.

Cannot remove attachments.

- Be sure to press the release buttons on the side of the power base to remove attachments. Do not pull hand mixer accessories from the power base without using the release buttons.
- To remove hand mixer accessories, press the eject button on the top of the hand mixer control panel.

The unit stopped blending or mixing.

- Do not run the unit more than 10 minutes continuously. Unplug the unit from the electrical outlet and allow it to cool for 15 minutes.

Hand mixer control panel is flashing.

- The unit may have overheated or there is something jammed in the attachments. Unplug the unit from the electrical outlet and allow it to cool for 15 minutes. Remove the beaters or other accessories and ensure no ingredients are jamming the attachments. If output is too thick and ingredients are not processing properly, add more liquid.

REFURBISHED PRODUCT LIMITED NINETY DAYS WARRANTY

The **Refurbished Product Service Center** offers the following WARRANTY to the ORIGINAL purchaser of a product which we have refurbished.

This product that has been refurbished is warranted against any electronic or mechanical defects for a period of NINETY DAYS from the date of the original purchase by the consumer. Since this unit was sold as a refurbished item, the warranty does not apply to any cosmetic appearance items such as scratches. Should a defect occur, the **Refurbished Product Service Center** will repair or, at its option, replace defective unit/parts with new or rebuilt materials without charge for either parts or labor. Replacement unit/parts will be warranted for the remaining portion of the original warranty period.

This warranty does not cover installation or damage from accident, misuse, abuse, improper wiring, incorrect voltage, operating the unit against the instructions in the owner's manual or any product which has been opened, altered, or tampered with.

This warranty does not cover costs for removal and or installation of the unit for repair. Under no circumstances shall the service center be liable for any special, incidental or consequential damages or for any other expenses incurred by reason of use or sale of this product. This warranty is in lieu of any other warranties expressed or implied warranty of merchantability of fitness for particular use or otherwise.

This warranty gives the consumer specific legal rights and they may also have other rights which vary from State to State. Some States do not follow the exclusion or limitation of incidental or consequential damages, hence the above exclusion and limitations may not apply.

Refurbished Product Service Center
13225 Marquardt Avenue Santa Fe Springs, CA 90670.

WARRANTY REPAIR INFORMATION

If you need service on your unit and this product requires repair during the 90 days warranty period; please go to www.ConsumerServiceRefurbish.com or call the **Refurbished Product Service Center** at 562-946-3531 to obtain the required return authorization (RA) number. Pack the unit properly (the original carton is ideal for this purpose) along with a copy of your purchase receipt and a letter describing the problem. Send the unit freight prepaid and insured to:

Refurbished Product Service Center,
Att: Customer Service Department 13225 Marquardt Avenue Santa Fe Springs, CA 90670

Your unit will be promptly repaired and returned to you.

We will refuse to accept delivery of the returned unit unless the assigned RA number appears on the outside of the shipping carton.

Owner's Information
(Keep for your permanent records)

NAME: _____

ADDRESS: _____

CITY: _____ STATE: _____ ZIP CODE: _____

PHONE: _____ E-MAIL: _____

MODEL: _____ SERIAL NO.: _____

TECHNICAL SPECIFICATIONS

Voltage: 120V~, 60Hz

PRINTED IN MEXICO SC: 30-05-2023 Shnmdl: CI100_B
obpn: CI100Series_IB_MP_Mv9_220420 Pags: TAB Elbr: J.E.
se removieron accesorios. Dough Hook, Chopper Pressing Lid, Chopper Blade Assembly, Cup Chopper Bowl, Chopper Storage Lid, Blending Vessel.

