

# NINJA

PROGRAMMABLE  
**XL 14-CUP**  
COFFEE MAKER

RECIPE BOOK IS NOT INCLUDED

## IMPORTANT SAFEGUARDS

READ ALL INSTRUCTIONS BEFORE USE • HOUSEHOLD USE ONLY

Read all instructions before using your NINJA® PROGRAMMABLE COFFEE MAKER.

When using electrical appliances, basic safety precautions should always be followed, including the following:

### WARNING

#### General Precautions

- This appliance can be used by persons with reduced physical, sensory, or mental capabilities or lack of experience and knowledge if they have been given supervision or instruction concerning use of the appliance in a safe way and understand the hazards involved.
- To reduce the risk of electric shock, this appliance has a polarized plug (one blade is wider than the other). As a safety feature, this plug will fit into a polarized outlet only one way. If the plug does not fit fully into the outlet, reverse the plug. If it still does not fit, contact a qualified electrician. **DO NOT** force into outlet or try to modify to fit.
- Keep the appliance and its cord out of reach of children. **DO NOT** allow the appliance to be used by children. Close supervision is necessary when used near children.
- To eliminate a choking hazard for young children, discard all packaging materials immediately upon unpacking.
- Children shall not play with the appliance.
- To protect against fire, electric shock, and injury to persons, **DO NOT** immerse cord, plugs, or body of machine in water or other liquid.
- NEVER** carry the appliance by the power cord or pull it to disconnect from electrical socket; instead grasp the plug and pull to disconnect.
- DO NOT** operate any appliance with a damaged cord or plug, or after the appliance malfunctions, or has been dropped or damaged in any manner.
- For household and work top use only. **DO NOT** let the power cord hang over the edge, or touch hot surfaces such as the stove.
- NEVER** use socket below counter.
- To avoid risk of fire, electrical shock, or damage to the unit, **DO NOT** store or use unit in an appliance garage or under a wall cabinet.
- Unplug from outlet when either the appliance or display clock is not in use and before cleaning. Allow to cool before putting on or taking off parts and before cleaning the appliance.
- Turn off and allow to cool before putting on or taking off parts, and before cleaning the appliance.

#### Operating Notice

- The use of an accessory not recommended by the manufacturer may create an overflow condition and scalding hazard, or result in fire, electric shock, or personal injury.
- ALWAYS** use appliance on a clean, dry, level surface.
- DO NOT** place appliance on or near a hot gas or electric burner or in a heated oven. **DO NOT** let cord touch hot surfaces or hang over edges of tables or counters.
- DO NOT** use this appliance for anything other than its intended use.
- DO NOT** use outdoors.

- DO NOT** touch hot surfaces. Use handles or knobs.
- ALWAYS** place a vessel beneath the brew basket to receive the brewed coffee.
- Scalding may occur if brew basket is opened during a brew or clean cycle.
- DO NOT** remove the vessel while the appliance is running without the Drip Stop in the closed position. Return the vessel quickly and open the Drip Stop to continue the brew.
- DO NOT** fill water reservoir with anything other than water, as other liquids may damage your brewer.
- DO NOT** overfill the water reservoir. Fill water only to the Max Fill line.
- DO NOT** run the appliance without water.
- Exceeding maximum brew basket capacity may cause overflow. **DO NOT** use fine or espresso ground coffee.

#### Carafe

- The carafe is designed for use with this appliance only. **DO NOT** place carafe on or near a hot gas or electrical burner, or in a heated oven.
- DO NOT** set a hot carafe on a wet or cold surface.
- DO NOT** use a cracked or scratched carafe or a carafe that has a loose or weakened handle.
- DO NOT** clean carafe with abrasive cleaners, steel wool pads, or other abrasive materials.
- DO NOT** place carafe in microwave.
- DO NOT** expose carafe to extreme temperature changes.
- DO NOT** drink directly from the carafe. Liquid from the carafe may be very hot.
- DO NOT** use the carafe to store food when not in use.
- Ensure the carafe is completely empty before starting a cleaning or brewing cycle. Starting a cycle with water, coffee, or tea in the carafe will cause an overflow.

#### Care & Maintenance

- Allow the appliance to cool before removing any parts and before cleaning.
- To prevent illness from bacterial growth in the appliance, follow all cleaning instructions in the Care & Maintenance section of this Owner's Guide.
- Clean the system on a weekly basis.
- If the product is not operating properly, contact a service center.
- Cleaning and user maintenance shall not be made by children unless they are older than 8 and supervised.

#### Cord Statement

- A short power-supply cord is provided to reduce the risks resulting from becoming entangled in or tripping over a longer cord.
- DO NOT** use an extension cord. **DO NOT** use an external timer or separate remote-control system.

**WARNING**  
Risk of fire or electric shock  
Do not remove bottom cover.

	Indicates to read and review instructions to understand operation and use of product.
	Indicates the presence of a hazard that can cause personal injury, death or substantial property damage if the warning included with this symbol is ignored.
	Do not immerse in any liquids.
	Take care to avoid contact with hot surface. Always use hand protection to avoid burns.
	For indoor and household use only.

## READ AND SAVE THESE INSTRUCTIONS

### PARTS

- |   |                            |
|---|----------------------------|
| A Coffee Maker (power cord & storage not shown) | E Brew-Through Lid         |
| B Removable Water Reservoir                     | F Glass Carafe             |
| C Water Reservoir Lid                           | G Adjustable Warming Plate |
| D Removable Brew Basket                         | H Control Panel            |
|   | I Showerhead               |

#### NOTE:

In order to ensure the highest possible standard for refurbished items, all units are thoroughly inspected as part of the process. For this item, water may be used during the refurbishing process and so; you may notice some condensation in the water reservoir. It is recommended to rinse the water reservoir with fresh water prior to its first use.

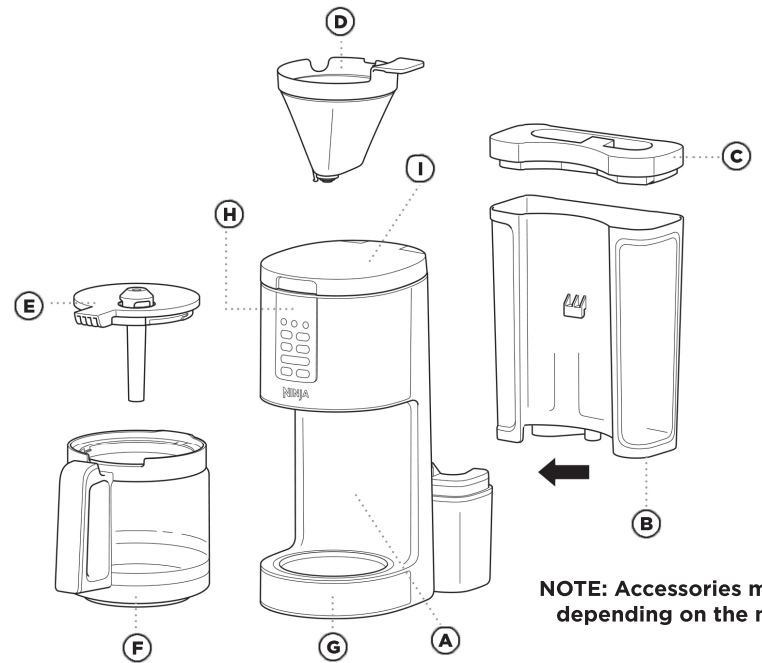

NOTE: Accessories may vary depending on the model.

The images shown here are for illustrative purposes only and may be subject to change.

### USING THE CONTROL PANEL

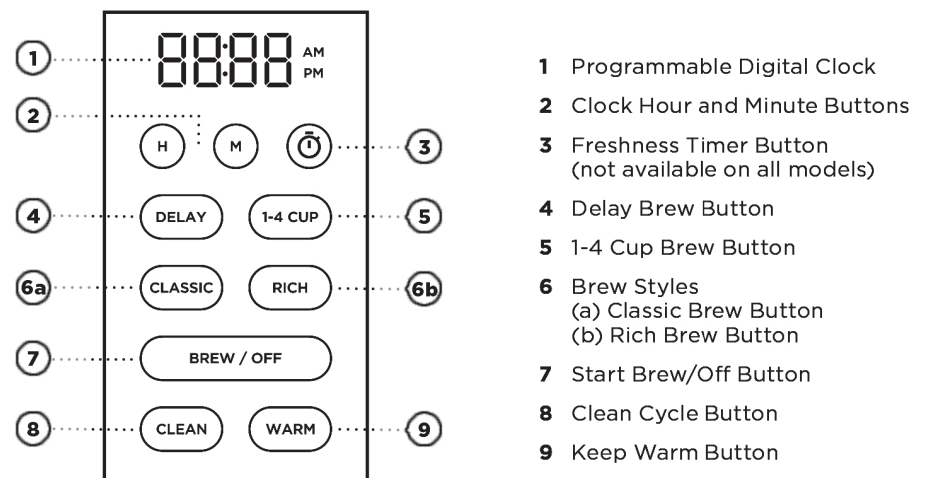

The actual descriptions of control panel and their locations may vary, depending on the model.

### FEATURES OF THE NINJA PROGRAMMABLE COFFEE MAKER

- 1-4 CUP Brew** Brewing 4 cups of coffee or fewer? When the 1-4 CUP button is selected, the coffee maker's brew cycle will be optimized for brewing smaller batches, resulting in the most flavorful coffee.

**IMPORTANT: DO NOT** fill the reservoir higher than the 4 cup line, as the unit will use up the total amount of water in the reservoir regardless of the 1-4 CUP setting.

- CLASSIC Brew** Smooth, well-balanced flavor.
- RICH Brew** For a richer coffee but still smooth.
- Freshness Timer (Not available on all models)** Lets you know how long your coffee has been waiting for you. Press the freshness timer once to show the amount of time that has passed since brewing completed. The freshness timer counts up to a maximum of 4 hours.
- Auto-Off** The unit will automatically shut off after 15 minutes of no interaction. To manually shut off the unit, press and hold BREW/OFF for 3 seconds.
- Keep Warm** Keep your brew at the ideal temperature for up to 4 hours. The Adjustable Warming Plate will activate when a brew has started and is set to remain on for 2 hours. Press WARM to turn it off.

### PREPARING FOR USE

#### BEFORE FIRST USE

- Remove all packaging material and stickers from the coffee maker.
- Wash the water reservoir, carafe, brew basket, and permanent filter in warm, soapy water with a soft cloth. Rinse parts and dry thoroughly.
- Plug in the power cord.
- Fill the reservoir to the 14 cup line with fresh water and place it on the base.
- Place the empty carafe on the base and prime the system by running a full carafe on Classic brew with water only. After the cycle is complete, discard the water.

NOTE: We recommend fresh, cool, filtered water. Well water is not recommended.

### SETTING THE CLOCK

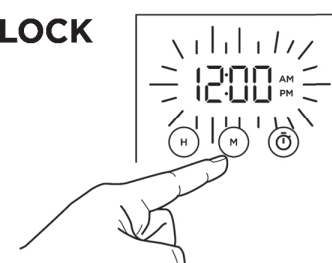

- Plug the power cord into an electrical outlet and the digital clock will begin to flash.
- Use the **H** and **M** buttons to set the clock to the current time. The AM or PM indicator will illuminate on the right side of the display as you are setting the time.
- When the desired time is reached, allow 5 seconds for it to set.

NOTE: If you unplug the brewer or experience a power loss, you will need to reset the clock the next time the brewer is powered on.

PRINTED IN MEXICO SC: 24-1120220  
BPN: DCM200\_Series\_IB\_REV\_Mv3\_220414  
SHNMDL: DCM200\_B\_TAB\_Elbrd: J.E.



804106935





## HOW TO BREW

- Place the brewer on a dry, clean, and level surface. Plug your brewer in to power it on.
- Remove the water reservoir from the unit by lifting it straight up. Remove the lid entirely and fill the water reservoir to the desired level.
- Place the brew basket in the unit.  
Paper filter not included

**NOTE:** If using a paper filter, fold the paper filter along the seams, open it fully, and firmly press it into the filter holder, making sure it is fully seated.

- Add your desired amount of coffee grounds to the filter.
- Place the brew-through lid on the carafe and turn clockwise to lock into place. Then place carafe under the brew basket.

- Select either **CLASSIC** or **RICH** brew style. If you are brewing 4-cups or less, also select **1-4 CUP**.
- Press **BREW** to start brewing. When the brewing is complete, the unit will beep, the clock will display "End", and the warming plate will remain on for the set amount of time.

**NOTE:** Each brew has a pre-infusion cycle with varying times. The brew will begin, pause for a short period of time, and then continue brewing. This pre-infusion cycle is used to evenly saturate the coffee grounds.

**NOTE:** Do not add more more cups of water than coffee you want to brew, as the unit will use up the total amount of water in the reservoir regardless of the 1-4 CUP setting.

- Use a descaling solution specifically formulated for coffeemaker cleaning and follow the directions on the package. Fill the water reservoir up to, but not exceeding, the 14-Cup Line.

### OR

Add 16 oz. of white vinegar to the water reservoir, then fill the rest of the reservoir with water up to, but not exceeding, the 14-Cup Line.

**IMPORTANT:** Use only white vinegar.

- Once the water reservoir is filled with your cleaning solution or vinegar mixture, press the **CLEAN** button. The clean cycle will take up to an hour. To cancel the clean cycle, press the **CLEAN** button again.
- The unit will beep when the clean cycle successfully completes.
- Empty the contents of the carafe and place it back under the brew basket. Clean the water reservoir with warm,

soapy water to remove any cleaning solution that could affect the flavor of your coffee.

- Refill the reservoir with fresh water up to, but not exceeding, the 14-Cup Line and set the empty carafe beneath the brew basket.
- Flush the system by running a 14-Cup Classic Brew cycle with water only. After the cycle is complete, discard the water and thoroughly clean the carafe.

**NOTE:** The clean cycle will take up to an hour. If you cancel the clean cycle, your machine will not be properly descaled.

**NOTE:** Running a water-only clean cycle will not descale the brewer properly.

**NOTE:** Hard water will cause scale buildup faster than soft water, and the brewer will need to be cleaned more often.

## PREPARING & USING YOUR NINJA® PROGRAMMABLE COFFEE MAKER

### USING THE NINJA SCOOP (NOT INCLUDED)

A Scoop is used for accurately measuring coffee grounds. A scoop is equivalent to 2 tbsps. of coffee. Measurements are based on level scoops and may be adjusted to your preferred taste.

### PREVENTING COFFEE OVERFLOW

Always measure with level scoops of a medium grind size. When using decaf coffee, use fewer scoops.

### COFFEE MEASUREMENT CHART

SERVING SIZE	CUPS OF COFFEE	WATER
1-4 Cups (Select 1-4 CUP button)	2 cups	2-cup line
	4 cups	4-cup line
6-14 Cups	6 cups	6-cup line
	8 cups	8-cup line
	10 cups	10-cup line
	12 cups	12-cup line
	14 cups	14-cup line

### COFFEE FRESHNESS TIMER (NOT AVAILABLE ON ALL MODELS)

The coffee freshness timer lets you know how long your coffee has been waiting for you since the end of your previous brew. At the end of every brew, the freshness timer will activate (as indicated by the LED next to the button when pressed), and it will begin counting. To view the freshness timer after a brew, press the Freshness Timer Button once and the clock time will change to show the amount of time that has passed since the previous brew cycle was completed. Press again at anytime to display the clock time. The freshness timer runs for 4 hours. After 4 hours is reached, the timer will stop, the LED will turn off, and the display will automatically switch back to the clock.

**NOTE:** If you press the freshness timer button and the clock flashes "00:00", then either a brew has not been completed or the timer has exceeded the 4 hour maximum.

**EXAMPLE:** Image below shows that it has been 17 minutes since last brew.

**NOTE:** The freshness timer can only be activated and viewed after a brew cycle has completed. The time and delay brew cannot be set when the freshness timer is displayed (indicated by the illuminated LED to the right of the button).

### PROGRAMMING DELAY BREW

**NOTE:** The unit must remain on for the Delay Brew function to work. **DO NOT** unplug the unit after setting Delay Brew.

- Plug in the power cord.
- After filling the water reservoir and adding ground coffee to the filter, be sure the reservoir and brew basket are securely in place. Place the empty carafe under the brew basket.
- Press **DELAY**. The clock will flash "12:00" or the last time that was set. Use the hour (H) and minute (M) buttons to set the time you would like the Delay Brew to begin. The AM or PM indicator will illuminate on the right side of the display as you are setting the time.
- Select the brew style, and your selection will illuminate. If brewing fewer than 4 cups, press **1-4 CUP**.
- Once you have set the time and brew style, press **DELAY** or **BREW** to activate, or wait 5 seconds for Delay Brew to lock in. When activated, the unit will beep, and **DELAY** will remain illuminated.
- To cancel the program, press **DELAY**.

## CARE & MAINTENANCE

### ADJUSTABLE WARMING PLATE

The warming plate will turn on once the brew has started. By default, the warming plate will remain on for 2 hours and will automatically turn off after the time has elapsed. To manually turn off the warming plate, press the **WARM** button after the brew has completed. You can turn the warming plate back on by pressing **WARM** again. Wait until the surface has cooled completely before touching.

**NOTE:** The unit will continue to brew if additional water is added to the reservoir. **DO NOT** add more water when using the **WARM** function.

### KEEP WARM TIME & TEMPERATURE ADJUSTMENT

#### (TEMPERATURE ADJUSTMENT IS NOT AVAILABLE ON ALL MODELS.)

You can adjust how long the warming plate remain on (up to 4 hours) and/or set the temperature to High, Medium, or Low.

By default, the warming plate is set to remain on for 2 hours. To change the time/temperature settings of the warming plate, follow these instructions:

- Press and hold the **WARM** button until the clock flashes, displaying how long the warming plate is currently set to stay on.
- Quickly press the hour (H) or minute (M) button to adjust the time up to 4 hours or decrease the time to 0 hours. Press **WARM** to set the new time. Or wait 5 seconds, and the unit will beep, signifying the new time has been set.
- To change the temperature, press the hour (H) or minute (M) button, then press **WARM**, or wait 5 seconds for the temperature to lock in. To keep the same temperature, press **WARM**, or wait 5 seconds for the same temperature to lock in.

**NOTE:** If you set the warming time to 0 hours, it will skip the warming temperature menu. When set to 0 hours, the warming plate will not automatically activate during or after a brew cycle, but you can still manually turn it on by pressing **WARM**.

### CLEANING AFTER A BREW

- After the unit has cooled, remove the brew basket and discard the grounds and paper filter, if used. If using the permanent filter, wash it thoroughly with soap and warm water or place on the top rack of the dishwasher.
- Empty the water reservoir and hand-wash or place in the dishwasher with opening facing downwards. We recommend thoroughly washing the water reservoir weekly.

**NOTE:** For best results, we recommend rinsing the reservoir after brewing.

- We recommend cleaning your carafe with warm, soapy water and a soft brush, or placing it on the top rack of your dishwasher. **DO NOT** use a wire brush.

**NOTE:** The glass carafe, brew-through lid, permanent filter, water reservoir, water reservoir lid, and scoop are dishwasher safe.

- After the coffee maker has cooled, wipe down the main unit, showerhead, and water reservoir shelf with a cloth and warm water. **DO NOT** immerse the coffee maker in water.

### TO CLEAN AND DESCALE YOUR NINJA PROGRAMMABLE COFFEE MAKER

The clean function allows you to clean your unit whenever you would like. As a guideline, we recommend running a clean cycle if it is taking significantly more time to brew than normal.

**NOTE:** Make sure the 1-4 CUP button is not selected/illuminated before running a clean cycle.

- Set the empty carafe beneath the brew basket.

\* (SCOOP NOT INCLUDED)

## TROUBLESHOOTING GUIDE

### There is sediment in my coffee.

- If using a permanent filter, the sediment at the bottom of the brewed coffee may be due to using finely ground coffee.
- To reduce the amount of sediment in the brewed coffee, use a slightly coarser grind or use a paper filter. (Permanent filter not included)

**NOTE: DO NOT** use paper filter in conjunction with the permanent filter, as this could cause water and/or coffee to clog or back up in the filter basket.

- Using too many grounds can cause the filter holder to overflow. Once cooled, clean out the filter holder and refill using the appropriate amount of coffee (1 scoop per 2 cups).

### Paper filter is folding over.

- The unit is designed to take a filter not included. Be sure you are using this size and shape, as larger sizes may fold over. Allow the filter holder to cool before handling. Be sure the paper filter is folded along its two seams and is pressed firmly into the filter holder. Alternatively, you can wet the sides of the paper filter to temporarily adhere it to the filter holder. (Permanent filter not included)

### Coffee is too weak.

- For stronger coffee, use the Rich Brew setting. If you want an even bolder flavor, you can add more coffee grounds to the filter.

### Coffee is too strong.

- For milder coffee, try the Classic Brew setting. If you want an even milder flavor, use fewer grounds in the filter. (Permanent filter not supplied)

### Coffee is leaking.

- After removing the water reservoir, there may be a small amount of water in the reservoir valve. This can be easily removed with a dry cloth.
- If the leak is coming from the bottom of the brew basket, the removable filter holder valve may be clogged. Rinse the filter holder with water and press the valve repeatedly until the clog is cleared.
- If the leak is coming from the bottom of the coffee maker, contact a service center.

### Brew will not start.

**NOTE:** The brew will begin, pause, and then continue. This process is used to evenly saturate the coffee grounds.

- Ensure the unit is powered on and the display is illuminated. If there are no lights, the machine is not getting power; try a different outlet.

- Check to make sure there is water in the water reservoir.

- Make sure the carafe is in place. The brewer will not dispense coffee if the carafe is not under the brew basket. If it is not in place, the brew will remain in the brew basket, which could lead to overflow.

- If the brew still does not start, it may be time to run a clean cycle. Please refer to the To Clean and Descaling Your Ninja® Programmable Coffee Maker section.

### Brew cycle is too slow.

- A full carafe brew will take approximately 12-15 minutes. If a full carafe brew takes longer than expected, you may need to run a clean cycle. Please refer to the To Clean and Descaling your Ninja® Programmable Coffee Maker section.

### Carafe overflowed.

- The carafe may not have been empty prior to brewing, or the water level exceeded the Max Fill line on the water reservoir prior to brewing. Reminder **DO NOT** add additional water to the reservoir after a brew or cleaning cycle has already started.

- The carafe holds 70 fl. oz. To avoid overflows, make sure carafe is empty prior to brewing and the water reservoir is not filled past the 14-Cup Line.

### Brew basket overflowed.

- Check that the carafe is in place with the lid secured. If the carafe is in place, the bottom of the filter holder may be clogged. This can happen with finely ground coffee or too many coffee grounds in the filter holder. Rinse the filter holder with water and press the valve repeatedly until the clog is cleared.

- Decaf coffee grounds will absorb water differently. Use fewer scoops when using decaf grounds.

**NOTE:** We recommend using medium-grind coffee

### REFURBISHED PRODUCT LIMITED NINETY DAY WARRANTY

The **Refurbished Product Service Center** offers the following WARRANTY to the ORIGINAL purchaser of a product which we have refurbished.

This product that has been refurbished is warranted against any electronic or mechanical defects for a period of NINETY DAYS from the date of the original purchase by the consumer. Since this unit was sold as a refurbished item, the warranty does not apply to any cosmetic appearance items such as scratches. Should a defect occur, the **Refurbished Product Service Center** will repair or, at its option, replace defective unit/parts with new or rebuilt materials without charge for either parts or labor. Replacement unit/parts will be warranted for the remaining portion of the original warranty period.

This warranty does not cover installation or damage from accident, misuse, abuse, improper wiring, incorrect voltage, operating the unit against the instructions in the owner's manual or any product which has been opened, altered, or tampered with.

This warranty does not cover costs for removal and or installation of the unit for repair. Under no circumstances shall the service center be liable for any special, incidental or consequential damages or for any other expenses incurred by reason of use or sale of this product. This warranty is in lieu of any other warranties expressed or implied warranty of merchantability of fitness for particular use or otherwise.

This warranty gives the consumer specific legal rights and they may also have other rights which vary from State to State. Some States do not follow the exclusion or limitation of incidental or consequential damages, hence the above exclusion and limitations may not apply.

**Refurbished Product Service Center**  
13225 Marquardt Avenue Santa Fe Springs, CA 90670

### WARRANTY REPAIR INFORMATION

If you need service on your unit during the 90 day warranty period; please go to [www.ConsumerServiceRefurbish.com](http://www.ConsumerServiceRefurbish.com) or call the Refurbished Product Service Center at 562-946-3531 to obtain the required claim number. Once you obtain your claim number, pack the unit properly (the original carton is ideal for this purpose) along with a copy of your purchase receipt. Send the unit freight prepaid and insured to:

**Refurbished Product Service Center,**  
Att: Customer Service Department 13225 Marquardt Avenue Santa Fe Springs, CA 90670

Your unit will be promptly exchanged and returned to you. We will refuse to accept delivery of the returned unit unless the assigned claim number appears on the outside of the shipping carton.

**Owner's Information**  
(Keep for your permanent records)

NAME: \_\_\_\_\_

ADDRESS: \_\_\_\_\_

CITY: \_\_\_\_\_

STATE: \_\_\_\_\_

ZIP CODE: \_\_\_\_\_

PHONE: \_\_\_\_\_

E-MAIL: \_\_\_\_\_

MODEL: \_\_\_\_\_

SERIAL NO.: \_\_\_\_\_