



OWNER'S GUIDE

Professional Blender

“Recipe book is not included”

CAUTION:

BE CAREFUL Contains loose, SHARP blades

IMPORTANT: Read this owner's manual before using this product for the first time.

IMPORTANT SAFETY INSTRUCTIONS For Household Use Only

WHEN USING ELECTRICAL APPLIANCES, BASIC SAFETY PRECAUTIONS SHOULD ALWAYS BE FOLLOWED, INCLUDING THE FOLLOWING:

READ ALL INSTRUCTIONS BEFORE USING YOUR NINJA® PROFESSIONAL BLENDER.

POLARIZED PLUG

WARNING: To reduce the risk of electric shock, this appliance has a polarized plug (one blade is wider than the other). This plug will fit into a polarized outlet only one way. If the plug does not fit fully into the outlet, reverse the plug. If it still does not fit, contact a qualified electrician to install the proper outlet. DO NOT modify the plug in any way.

WARNING: Extension cords are not recommended for use with this product.

TECHNICAL SPECIFICATIONS

Voltage: 120V., 60Hz.

Pitcher Capacity: 72 oz. (9 cups, 2.1 L)
MAX Liquid Capacity: 64 oz. (8 cups, 1.9 L)

WARNING:

TO REDUCE THE RISK OF FIRE, ELECTRIC SHOCK OR INJURY:

- WARNING:** Remove utensils prior to processing. Failure to remove may cause the jar to be damaged or to shatter which may cause personal injury.
- WARNING:** Stacked Blade Assembly is sharp, not locked in place and removable, handle with care. When handling the Stacked Blade Assembly, always hold by the shaft. Failure to do so will result in a risk of laceration.
- WARNING:** Stacked Blade Assembly is sharp and not locked in place. If using the pour spout, ensure the lid is fully locked onto the pitcher. If pouring with the lid removed, carefully remove the Stacked Blade Assembly first, holding it by the shaft. Failure to do so will result in a risk of laceration.
- CAUTION:** Do not blend hot liquids, doing so may cause excessive pressure build-up, resulting in risk of the user being burned.
- To protect against electrical shock, do not submerge the appliance or allow the power cord to come into contact with water or any other liquid.
- DO NOT** allow young children to operate the appliance or use as a toy. Close supervision is necessary when any appliance is used near children.
- Never leave an appliance unattended when in use.

- Turn the appliance Off and remove the power cord from the electrical outlet when not in use, before assembling or disassembling parts and before cleaning. To unplug, grasp the plug and pull from the electrical outlet. Never pull from the power cord.
- Appliance accessories are not intended to be used in the microwave as it may result in damage to the accessories.
- DO NOT** abuse the power cord. Never carry the appliance by the power cord or yank it to disconnect from electrical outlet; instead grasp the plug and pull to disconnect.
- DO NOT** operate any appliance with a damaged cord or plug, or after the appliance malfunctions, has been dropped or damaged in any manner. This appliance has no serviceable parts.
- DO NOT** let the power cord hang over the edge of table or counter or touch hot surfaces such as the stove.
- Always use the appliance on a dry, level surface.
- Keep hands, hair, clothing, as well as utensils out of container while processing to reduce the risk of severe injury to persons or damage to the appliance. A scraper may be used but only when the appliance is not running.
- Avoid contact with moving parts.
- DO NOT attempt to sharpen blades.**
- DO NOT** use the appliance if blade assembly is bent or damaged.
- To reduce risk of injury, never place the blade assembly on base without pitcher properly attached.
- DO NOT** operate this appliance on or near any hot surfaces (such as gas or electric burner or in a heated oven).
- The use of attachments or accessories including canning jars, not recommended by the manufacturer may result in fire, electric shock or personal injury.
- DO NOT** remove the pitcher from the motor base while the appliance is in operation.
- To reduce the risk of injury, **NEVER** operate the appliance without the lid in place; **DO NOT** try to defeat the interlock mechanism; make sure that the attachment is properly installed before operating the appliance.
- DO NOT** expose the pitcher to extreme temperature changes.
- DO NOT** overfill. Never fill past the “Max” line.
- DO NOT** operate the appliance empty.
- To reduce the risk of burns, always allow the appliance to cool before taking off parts and before cleaning.
- In the event that the unit overheats, a thermal switch will become activated and shut off the motor. To reset the appliance, unplug the appliance and let it cool down for approximately 15 minutes before using again.
- THIS PRODUCT IS INTENDED FOR HOUSEHOLD USE ONLY.** Do not use this appliance for anything other than its intended use. Do not use outdoors.
- The maximum rating is based on the Stacked Blade Assembly (pitcher) that drives the greatest power and other recommended attachments may draw significantly less power or current.

The Ninja® Professional Blender is a high powered kitchen tool that is perfect for ice crushing, blending, pureeing and controlled processing. Create all of your favorite recipes fast and easy with just one touch of a button. For best results, be sure to carefully read all the instructions contained in the manual before using this appliance.

FEATURES:

- Easy lock lid with built-in pour spout
- Total Crushing® Technology
- Extra Large 72 oz. pitcher (MAX Liquid Capacity: 64 oz.) - BPA Free
- Easy to clean electronic control panel
- Cord storage
- Non Slip Bottom

SAVE THESE INSTRUCTIONS

Getting Started

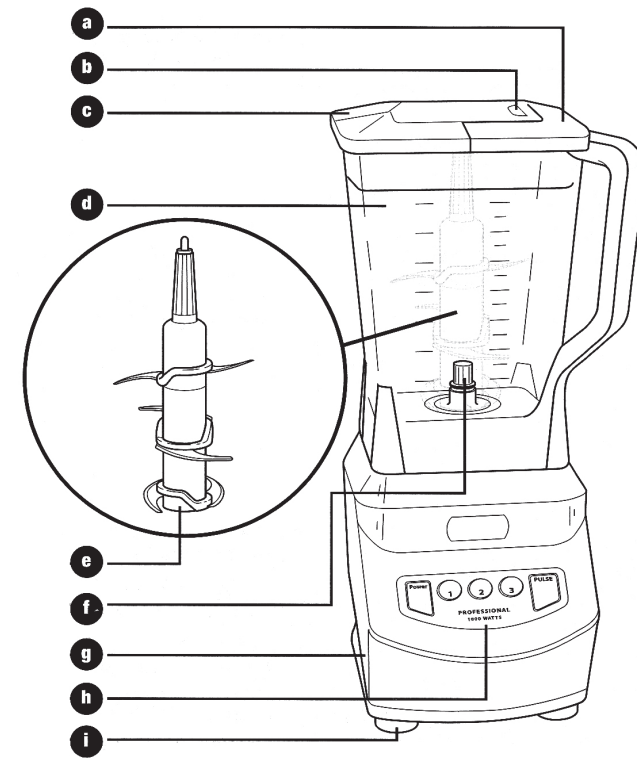

- a Lid with Locking Handle
- b Locking Handle Release Button
- c Pouring Spout with Cap
- d Pitcher
- e Stacked Blade Assembly
- f Gear Shaft
- g Motor Base
- h Control Panel
- i Non Slip Bottom
- j Power Cord (not shown)
- k Cord Storage (in back) (not shown)

NOTE: Accessories may vary depending on the model. The images shown here are for illustrative purposes only and may be subject to change.

Before First Use

PLEASE KEEP THESE IMPORTANT SAFEGUARDS IN MIND WHEN USING THE APPLIANCE:

IMPORTANT: Make sure that the motor base is plugged in for use.

IMPORTANT: Never add ingredients into the container before placing the Blade Assembly in first.

IMPORTANT: DO NOT attempt to operate the appliance without the lid on.

IMPORTANT: Never run the appliance empty.

IMPORTANT: Appliance accessories are not intended to be used in the microwave as it may result in damage to the accessories.

NOTE: In order to ensure the highest possible standard for refurbished items, all units are thoroughly inspected as part of the process. For this item, water may be used during the refurbishing process and so; you may notice some condensation in the water reservoir. It is recommended to rinse the water reservoir with fresh water prior to its first use.

WARNING: Stacked Blade Assembly is sharp and not locked in place. If using the pour spout, ensure the lid is fully locked onto the pitcher. Failure to do so will result in a risk of laceration.

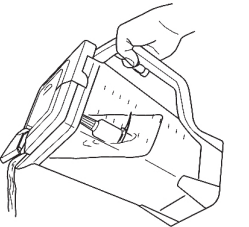

WARNING: Stacked Blade Assembly is sharp and not locked in place. If pouring with the lid removed, carefully remove the Stacked Blade Assembly first, holding it by the shaft. Failure to do so will result in a risk of laceration.

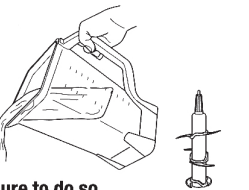

CAUTION: Do not immerse the motor base into water or any other liquid.

- Remove all packaging material. Separate/remove all parts from each other.
- Wash the lid, pitcher and Stacked Blade Assembly in warm, soapy water. When washing the Stacked Blade Assembly, use a dishwashing utensil with a handle to avoid direct hand contact with blades.
- WARNING:** Handle the Stacked Blade Assembly with care when washing, as the blades are sharp.
- Handle blade assemblies with care to avoid contact with sharp edges. Rinse and air dry thoroughly.
- The pitcher, lid and Stacked Blade Assembly are all dishwasher safe. It is recommended that the lid and Stacked Blade Assembly go on the top rack. Ensure that the Stacked Blade Assembly is removed from the pitcher before placing in the dishwasher.
- The motor base can be wiped clean with a damp cloth.

Assembly and Use of the Pitcher

- ⚠ **WARNING:** Handle the Stacked Blade Assembly with care, as the blades are sharp.
 - ⚠ **WARNING:** Remove utensils prior to processing. Failure to remove may cause the pitcher to be damaged or to shatter, which may cause personal injury.
 - ⚠ **WARNING:** Never leave the appliance unattended while in use.
 - ⚠ **CAUTION:** Do not blend hot liquids, doing so may cause excessive pressure buildup, resulting in risk of the user being burned.
- IMPORTANT:** Make sure that the motor base is plugged in for use.

ASSEMBLY

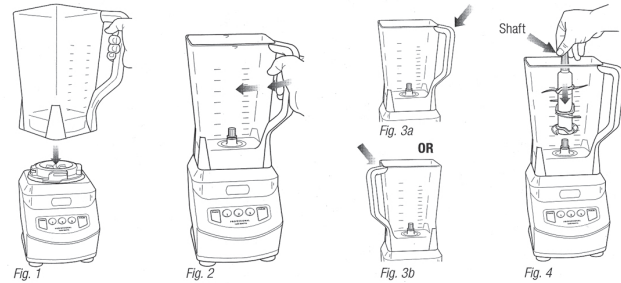

- 1 Review warning and caution statements above before proceeding to number 2.
- 2 Place the motor base on a clean, dry, level surface.
- 3 Lower the pitcher onto the motor base. (Fig. 1)
- 4 Rotate the pitcher to the left as far as it will go. As the pitcher rotates, it will lower and the safety tabs on the bottom of the pitcher will slide under the safety tabs on the top of the motor base. (Fig. 2)
- 5 The pitcher can be placed on the motor base two ways; the handle can be on the front right corner or the front left corner. (Fig. 3a, Fig. 3b)

- 6 Holding the Stacked Blade Assembly by the shaft, place it onto the gear shaft inside the pitcher. (Fig. 4) Ensure that the Stacked Blade Assembly fits around the gear shaft and that the blade shaft is standing straight.

NOTE: The Stacked Blade Assembly will fit loosely on the drive gear.

USE

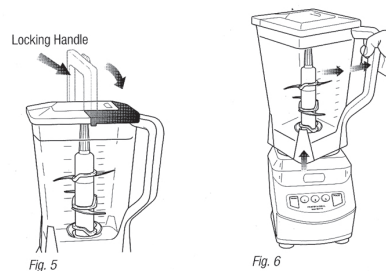

- 9 Review warning and caution statements before proceeding to number 10.
- 10 Holding the lid by the handle in the upright position, place it on top of the pitcher aligning the arrow (▼) located on the lid with the arrow (▲) located on the bowl's handle. (Fig. 5)
- 11 Select the speed according to your blending requirements*:
 - Use the speed 1 button for processing and mixing.
 - Use the speed 2 button for blending and ice crushing.
 - Use the speed 3 button for pureeing and liquefying.
 - Use the pulse button for controlled chopping and processing.

* See Blending Chart.

NOTE: If you need to add additional ingredients while the blender is processing, open the pouring spout cap and pour the ingredients in through the opening.

REMOVAL



NOTE: Accessories may vary depending on the model.

- 12 Press power button (⏻) or the same speed button a second time to stop the Stacked Blade Assembly or press a different button to change the speed.
- 13 To remove the pitcher, press the power button (⏻) to turn the appliance 'Off'. Wait for the Stacked Blade Assembly to stop moving before removing. (Fig. 6)
- ⚠ **WARNING:** Never insert your hands in the pitcher as the Stacked Blade Assembly is sharp. Always use a spatula to dislodge food that has stuck to the sides of the pitcher.
- 14 Open the pour spout cap and use the spout to empty liquid contents.
- 15 For thicker consistencies, first remove the lid by pressing the release button and pulling the lid handle up to a 90 degree angle to lift lid off the pitcher. Then, carefully remove the Stacked Blade Assembly by the top of the shaft. Place Stacked Blade Assembly away from the work area to avoid accidental contact. Finally, empty contents from the pitcher. (Fig. 7)
- 16 Make sure that the unit is unplugged when not in use.

Care & Maintenance

HOW TO CLEAN

- ⚠ **CAUTION:** Make sure that the motor base is unplugged from the power source before inserting or removing any Stacked Blade Assembly and before cleaning.
- ⚠ **CAUTION:** DO NOT immerse the motor base into water or any other liquid.

- 1 Separate/remove all parts from each other.
- 2 **Hand Washing:** Wash the container, lid and blade assembly in warm, soapy water. When washing the blade assembly, use a dish-washing utensil with a handle to avoid direct hand contact with blades. Handle blade assembly with care to avoid contact with sharp edges. Rinse and air dry thoroughly.

Dishwasher: The container, lid and blade assembly are all dishwasher safe. The lid and blade assembly are topshelf dishwasher safe. Ensure that the blade assembly is removed from the container before placing in the dishwasher.
- ⚠ **WARNING:** Handle the Stacked Blade Assembly with care when washing, as the blades are sharp. Contact with the blades' edges can result in laceration.
- 3 Wipe the motor base clean with a damp cloth.

HOW TO STORE

- 1 Store the Ninja® Professional Blender upright with the Stacked Blade Assembly inside the pitcher with the lid secured on top. Do not place anything on top. Tuck power cord in cord storage compartment in the back of the unit.

RESETTING THE MOTOR THERMOSTAT

The Ninja® Professional Blender features a unique safety system which prevents damage to the unit's motor and drive system should you inadvertently overload your appliance. **If the appliance is being overloaded, the motor will stop. Allow the appliance to cool for approximately 15 minutes.** To reset the appliance, follow the resetting procedure below:

- 1 Unplug the appliance from the electrical outlet.
- 2 Remove and empty the container and ensure that no food is jamming the Stacked Blade Assembly.
- 3 Allow the appliance to cool for approximately 15 minutes.
- 4 Re-install the container onto the base and re-plug the appliance into the electrical outlet.
- 5 Proceed to use the appliance as before making sure not to exceed the recommended maximum capacities.

Blending Chart

BUTTON	FUNCTION	USE
POWER ⏻	On/Off	Always turn appliance 'Off' when not in use.
1	Processing & Mixing	Use to mix thin batters, gravies and marinades, scramble eggs, puree cooked foods and uncooked fruits and chop vegetables for dips and salsa.
2	Blending & Ice Crushing	Use to grate hard cheeses, cream soups*, beat dips, grind nuts, thorough chopping, blend sauces* and spreads. Blend mixed drinks, powdered drinks or milk shakes. Crush ice cubes for snow cones, chilled beverages or frozen slushes.
3	Pureeing & Liquefying	Use to mix smoothies, frappes, liquefy thick mixtures and blend whole fruits and vegetables.
PULSE	Controlled Processing & Bursts of Power	Use to control chopping and processing.

* When blending soups or sauces, make sure they're cooled to room temperature first - Ninja containers are not intended for hot blending.

Troubleshooting Guide

PROBLEMS	POSSIBLE REASONS & SOLUTIONS
Motor Doesn't Start or Stacked Blade Assembly doesn't Rotate.	Make sure the pitcher is securely placed on motor base. Make sure the lid is securely on pitcher in the correct position (align arrows). The blender is turned 'Off'. Press the power button (⏻) to turn 'On'. Check that the plug is securely inserted into the electrical outlet. Check the fuse or circuit breaker. The unit has overheated or overloaded. Unplug and wait approximately 15 minutes before using again.
Food is Unevenly Chopped.	Either you are chopping too much food at one time, or the pieces are not of even size and processing smaller amounts per batch.
Food is Chopped Too Fine or is Too Watery.	The food has been over processed. Use pulse button for controlled processing.
Food Collects On Lid or On the Sides of the Pitcher.	The mixture is too thick. Add more liquid.
You Cannot Achieve Snow From Solid Ice.	Do not use ice that has been sitting out or has started to melt. Use ice straight from the freezer.

REFURBISHED PRODUCT LIMITED NINETY DAYS WARRANTY

The **Refurbished Product Service Center** offers the following WARRANTY to the ORIGINAL purchaser of a product which we have refurbished.

This product that has been refurbished is warranted against any electronic or mechanical defects for a period of NINETY DAYS from the date of the original purchase by the consumer. Since this unit was sold as a refurbished item, the warranty does not apply to any cosmetic appearance items such as scratches. Should a defect occur, the **Refurbished Product Service Center** will repair or, at its option, replace defective unit/parts with new or rebuilt materials without charge for either parts or labor. Replacement unit/parts will be warranted for the remaining portion of the original warranty period.

This warranty does not cover installation or damage from accident, misuse, abuse, improper wiring, incorrect voltage, operating the unit against the instructions in the owner's manual or any product which has been opened, altered, or tampered with.

This warranty does not cover costs for removal and or installation of the unit for repair. Under no circumstances shall the service center be liable for any special, incidental or consequential damages or for any other expenses incurred by reason of use or sale of this product. This warranty is in lieu of any other warranties expressed or implied warranty of merchantability of fitness for particular use or otherwise.

This warranty gives the consumer specific legal rights and they may also have other rights which vary from State to State. Some States do not follow the exclusion or limitation of incidental or consequential damages, hence the above exclusion and limitations may not apply.

Refurbished Product Service Center
13225 Marquardt Avenue Santa Fe Springs, CA 90670.

WARRANTY REPAIR INFORMATION

If you need service on your unit and this product requires repair during the 90 days warranty period; please go to www.ConsumerServiceRefurbish.com or call the **Refurbished Product Service Center** at 562-946-3531 to obtain the required return authorization (RA) number. Pack the unit properly (the original carton is ideal for this purpose) along with a copy of your purchase receipt and a letter describing the problem. Send the unit freight prepaid and insured to:

Refurbished Product Service Center,
Att: Customer Service Department 13225 Marquardt Avenue Santa Fe Springs, CA 90670

Your unit will be promptly repaired and returned to you. We will refuse to accept delivery of the returned unit unless the assigned RA number appears on the outside of the shipping carton.

Owner's Information
(Keep for your permanent records)

NAME: _____
ADDRESS: _____
CITY: _____ STATE: _____ ZIP CODE: _____
PHONE: _____ E-MAIL: _____
MODEL: _____ SERIAL NO.: _____

SharkNinja Operating LLC
US: Newton, MA 02459
CAN: Ville St-Laurent, QC H4S 1A7
Ninja and Total Crushing are registered trademarks of SharkNinja Operating LLC.

Euro-Pro and Ninja are registered trademarks of Euro-Pro Operating LLC.
Total Crushing is trademark of Euro-Pro LLC.
Illustrations may differ from actual product. The specifications contained herein are subject to change without notice.
For SharkNinja U.S. Patent information visit www.sharkninja.com/USPatents.

© 2016 SharkNinja Operating LLC

Printed in Mexico / Sc:07.07.2017_Pgs.: TAB
Obpn: NJ600CO_30_E_IB_161006_1
Shnmdl: NJ600CO_B / Re-design03.11.2019.TAB

804107863

