

NINJA®

OWNER'S GUIDE

"Recipe book is not included"

PROFESSIONAL BLENDER

804106955



IMPORTANT SAFETY INSTRUCTIONS

PLEASE READ CAREFULLY BEFORE USE • FOR HOUSEHOLD USE ONLY

	Read and review instructions for operation and use.
	Indicates the presence of a hazard that can cause personal injury, death or substantial property damage if the warning included with this symbol is ignored.
	For indoor and household use only.
When using electrical appliances, basic safety precautions should always be followed, including the following:	

WARNING

To reduce the risk of injury, fire, electrical shock or property damage, basic safety precautions must always be followed, including the following numbered warnings and subsequent instructions. Do not use appliance for other than intended use.

- Read all instructions prior to using the appliance and its accessories.
- Carefully observe and follow all warnings and instructions. This unit contains electrical connections and moving parts that potentially present risk to the user.
- Take your time and exercise care during unpacking and appliance setup. This appliance contains sharp, loose blades that can cause injury if mishandled.
- Take inventory of all contents to ensure you have all parts needed to properly and safely operate your appliance.
- Blades are sharp. Handle carefully.
- This product is provided with a Stacked Blade Assembly. **ALWAYS** exercise care when handling blade assembly. The blade assembly is sharp and is **NOT** locked in place in its container. The blade assembly is designed to be removable to facilitate cleaning and replacement if needed. **ONLY** grasp the blade assembly by the top of the shaft. Failure to use care when handling the blade assembly will result in a risk of laceration.
- Turn the appliance **OFF**, then unplug the appliance from the outlet when not in use, before assembling or disassembling parts, and before cleaning. To unplug, grasp the plug by the body and pull from the outlet. **NEVER** unplug by grasping and pulling the flexible cord.
- Before use, wash all parts that may contact food. Follow washing instructions covered in this instruction manual.
- Before each use, inspect blade assembly for damage. If a blade is bent or damage is suspected, contact a service center.
- DO NOT** use this appliance outdoors. It is designed for indoor household use only.
- This appliance has a polarized plug (one prong is wider than the other). To reduce the risk of electric shock, this plug will fit in a polarized outlet only one way. If the plug does not fit fully in the outlet, reverse the plug. If it still does not fit, contact a qualified electrician. **DO NOT** modify the plug in any way.
- DO NOT** operate any appliance with a damaged cord or plug, or after the appliance malfunctions or is dropped or damaged in any manner.
- This appliance has important markings on the plug blade. The entire supply cord is not suitable for replacement. If damaged, please contact SharkNinja for service.
- Extension cords should **NOT** be used with this appliance.
- To protect against the risk of electric shock, **DO NOT** submerge the appliance or allow the power cord to contact any form of liquid.
- DO NOT** allow the cord to hang over the edges of tables or counters. The cord may become snagged and pull the appliance off the work surface.
- DO NOT** allow the unit or the cord to contact hot surfaces, including stoves and other heating appliances.
- ALWAYS** use the appliance on a dry and level surface.
- DO NOT** allow children to operate this appliance or use as a toy. Close supervision is necessary when any appliance is used near children.
- This appliance is **NOT** intended to be used by people with reduced physical, sensory, or mental capabilities, or lack of experience and knowledge, unless they have been given supervision or instruction concerning use of the appliance by a person responsible for their safety.
- ONLY** use attachments and accessories that are provided with the product or are recommended by SharkNinja. The use of attachments, including canning jars, not recommended or sold by SharkNinja may cause fire, electric shock, or injury.
- NEVER** place the blade assembly on the motor base without it first being attached to the container with the lid also in place.
- Keep hands, hair, and clothing out of the container when loading and operating.
- During operation and handling of the appliance, avoid contact with moving parts.
- DO NOT** fill container past the **MAX FILL** or **MAX LIQUID** lines.
- DO NOT** operate the appliance with an empty container.
- DO NOT** microwave container or accessories provided with the appliance.
- NEVER** leave the appliance unattended while in use.
- DO NOT** blend hot liquids. Doing so may result in pressure buildup and steam exposure that can pose a risk of the user being burned.
- DO NOT** process dry ingredients with the Stacked Blade Assembly.
- DO NOT** perform grinding operations with the Stacked Blade Assembly.
- NEVER** operate the appliance without lids and caps in place. **DO NOT** attempt to defeat the interlock mechanism. Ensure the container and lid are properly installed before operation.
- Before operation, ensure all utensils are removed from container. Failure to remove utensils can cause container to shatter and potentially result in personal injury and property damage.
- Keep hands and utensils out of container while chopping to reduce the risk of severe personal injury or damage to the blender/food chopper. A scraper may be used **ONLY** when the blender or processor is not running.
- DO NOT** open pour spout cap while blender is operating.
- If you find unmixed ingredients sticking to the sides of the pitcher, stop the appliance, remove the lid, and use a spatula to dislodge ingredients. **NEVER** insert your hands into the pitcher, as you may contact one of the blades and experience a laceration.

- DO NOT** attempt to remove the container or lid from the motor base while the blade assembly is still spinning. Allow the appliance to come to a complete stop before removing lids and containers.
- If the appliance overheats, a thermal switch will activate and temporarily disable the motor. To reset, unplug the appliance and allow it to cool for approximately 30 minutes before using again.
- DO NOT** expose the container and accessories to extreme temperature changes. They may experience damage.
- Upon completion of processing, ensure the blade assembly is removed **BEFORE** emptying container's contents. Remove the blade assembly by carefully grasping the top of the shaft and lifting it from the container. Failure to remove the blade assembly before emptying the container results in a risk of laceration.
- If using the pour spout, hold the cover in place on the container or ensure lid lock is engaged when pouring to avoid risk of injury.
- The maximum wattage rating for this appliance is based on the configuration of the Stacked Blade Assembly and the pitcher.
- DO NOT** submerge the motor base or control panel in water or other liquids. **DO NOT** spray motor base or control panel with any liquid.
- DO NOT** attempt to sharpen blades.
- Turn off the appliance and unplug the motor base before cleaning.

SAVE THESE INSTRUCTIONS

PARTS

- | | |
|--|---|
| A Lid with Locking Handle | G Motor Base |
| B Locking Handle Release Button | H Control Panel |
| C Pouring Spout with Cap | I Non Slip Bottom |
| D Pitcher | J Power Cord (not shown) |
| E Stacked Blade Assembly | K Cord Storage (in back) (not shown) |
| F Gear Shaft | |

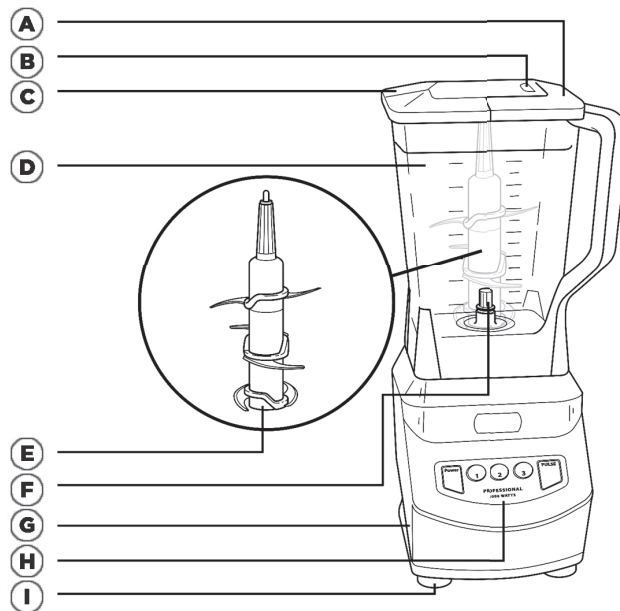

• Accessory type and quantity may vary depending on the model.

BEFORE FIRST USE

IMPORTANT: Review all warnings on before proceeding.

- Remove all packaging material from the appliance. Separate/remove all parts from each other.
- Wash the lid, pitcher and Stacked Blade Assembly in warm, soapy water. When washing the Stacked Blade Assembly, use a dishwashing utensil with a handle to avoid direct hand contact with blades.
- Handle blade assemblies with care to avoid contact with sharp edges. Rinse and air dry thoroughly.
- The pitcher, lid and Stacked Blade Assembly are all dishwasher safe. It is recommended that the lid and Stacked Blade Assembly go on the top rack. Ensure that the Stacked Blade Assembly is removed from the pitcher before placing in the dishwasher.
- The motor base can be wiped clean with a damp cloth.

FEATURES

- Easy lock lid with built-in pour spout
- Total Crushing® Technology
- Extra-large 72 oz. pitcher (MAX liquid capacity: 64 oz.) – BPA-free
- Easy to clean electronic control panel
- Cord storage
- Non-slip bottom

• The image shown here is for illustrative purposes only and may be subject to change.

TECHNICAL SPECIFICATIONS

Voltage: 120V~, 60Hz

PLEASE READ CAREFULLY AND KEEP FOR FUTURE REFERENCE.

USING THE PITCHER

IMPORTANT: Review all warnings on before proceeding.

IMPORTANT: As a safety feature, the motor will not work if the pitcher and lid are not installed correctly. When the pitcher and lid are installed properly, the ready light will be solid green, indicating that the blender is ready for use.

- 1 Place the motor base on a clean, dry, level surface.

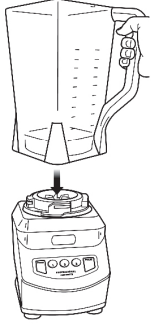

- 2 Lower the pitcher onto the motor base.



- 3 Rotate the pitcher to the left as far as it will go. As the pitcher rotates, it will lower and the safety tabs on the bottom of the pitcher will slide under the safety tabs on the top of the motor base.

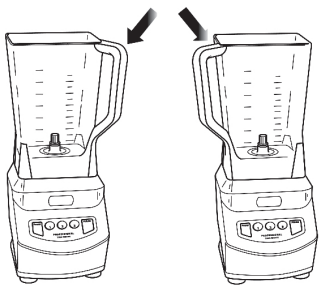

- 4 The pitcher can be placed on the motor base two ways; the handle can be on the front right corner or the front left corner.

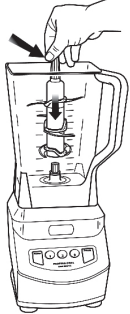

- 5 Holding the Stacked Blade Assembly by the shaft, place it onto the gear shaft inside the pitcher. Ensure that the Stacked Blade Assembly fits around the gear shaft and that the blade shaft is standing straight.

NOTE: The Stacked Blade Assembly will fit loosely on the drive gear.

- 6 Add the ingredients to the pitcher. Make sure your total of ingredients don't go higher than the highest measured marking line on the side of the pitcher.

NOTE: When blending any kind of liquids, such as mixtures of any drinks or smoothies, do not exceed the "Max liquid" mark (64 oz.) on the pitcher

- 7 Plug the power cord into the electrical outlet.

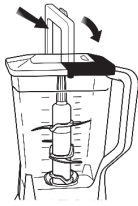

- 10 Holding the lid by the handle in the upright position, place it on top of the pitcher aligning the arrow ▼ located on the lid with the arrow ▲ located on the bowl's handle.

- 11 Select the speed according to your blending requirements*:

- Use the speed 1 button for processing and mixing.
- Use the speed 2 button for blending and ice crushing.
- Use the speed 3 button for pureeing and liquefying.
- Use the pulse button for controlled chopping and processing.

NOTE: If you need to add additional ingredients while the blender is processing, open the pouring spout cap and pour the ingredients in through the opening.

*See Blending Chart

- 12 Press power button (⏻) or the same speed button a second time to stop the Stacked Blade Assembly or press a different button to change the speed.

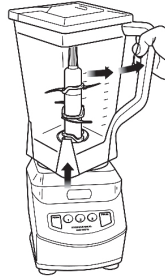

- 13 To remove the pitcher, press the power button (⏻) to turn the appliance Off. Wait for the Stacked Blade Assembly to stop moving before removing.

- 14 Open the pour spout cap and use the spout to empty liquid contents.

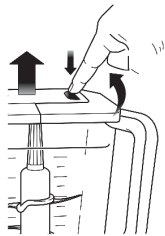

- 15 For thicker consistencies, first remove the lid by pressing the release button and pulling the lid handle up to a 90 degree angle to lift lid off the pitcher. Then, carefully remove the Stacked Blade Assembly by the top of the shaft. Place Stacked Blade Assembly away from the work area to avoid accidental contact. Finally, empty contents from the pitcher.

- 16 Make sure that the unit is unplugged when not in use.

BLENDING CHART

BUTTON	FUNCTION	USE
POWER (⏻)	On/Off	Always turn appliance Off when not in use.
1	Processing & Mixing	Use to mix thin batters, gravies and marinades, scramble eggs, puree cooked foods and uncooked fruits and chop vegetables for dips and salsa.
2	Blending & Ice Crushing	Use to grate hard cheeses, cream soups*, beat dips, grind nuts, thorough chopping, blend sauces* and spreads. Blend mixed drinks, powdered drinks or milk shakes. Crush ice cubes for snow cones, chilled beverages or frozen slushes.
3	Pureeing & Liquefying	Use to mix smoothies, frappes, liquefy thick mixtures and blend whole fruits and vegetables.
PULSE	Controlled Processing & Bursts of Power	Use to control chopping and processing.

* When blending soups or sauces, make sure they're cooled to room temperature first. Ninja containers are not intended for hot blending.

CARE & MAINTENANCE

CLEANING

Separate/remove all parts from each other.

• Hand-Washing

Wash the container, lid and blade assembly in warm, soapy water. When washing the blade assembly, use a dish-washing utensil with a handle to avoid direct hand contact with blades. Handle blade assembly with care to avoid contact with sharp edges. Rinse and air dry thoroughly.

• Dishwasher

The container, lid and blade assembly are all dishwasher safe. The lid and blade assembly is topshelf dishwasher safe. Ensure that the blade assembly is removed from the container before placing in the dishwasher.

• Motor Base

Turn off the unit and unplug the motor base before cleaning. Wipe motor base with a clean, damp cloth. Please contact a service center.

STORING

Store the Ninja® Professional Blender upright with the Stacked Blade Assembly inside the pitcher with the lid secured on top. Do not place anything on top. Tuck power cord in cord storage compartment in the back of the unit.

RESETTING THE MOTOR THERMOSTAT

The Ninja Professional Blender features a unique safety system which prevents damage to the unit's motor and drive system should you inadvertently overload your appliance. **If the appliance is being overloaded, the motor will stop. Allow the appliance to cool for approximately 15 minutes.** To reset the appliance, follow the resetting procedure below:

- 1 Unplug the appliance from the electrical outlet.
- 2 Remove and empty the container and ensure that no food is jamming the Stacked Blade Assembly.
- 3 Allow the appliance to cool for approximately 15 minutes.
- 4 Re-install the container onto the base and re-plug the appliance into the electrical outlet.
- 5 Proceed to use the appliance as before making sure not to exceed the recommended maximum capacities.

If your unit needs servicing, please contact a service center.

TROUBLESHOOTING GUIDE

⚠ WARNING: To reduce the risk of shock and unintended operation, turn power off and unplug unit before troubleshooting.

Motor doesn't start or stacked blade assembly doesn't rotate.

- Make sure the pitcher is securely placed on motor base.
- Make sure the lid is securely on pitcher in the correct position (align arrows).
- The blender is turned Off. Press the power button (⏻) to turn blender On.
- Check that the plug is securely inserted into the electrical outlet.
- Check the fuse or circuit breaker.
- The unit has overheated or overloaded. Unplug and wait approximately 15 minutes before using again.

Food is Unevenly Chopped.

- Either you are chopping too much food at one time, or the pieces are not of even size and processing smaller amounts per batch.

Food is Chopped Too Fine or is Too Watery.

- The food has been over processed. Use pulse button for controlled processing.

Food Collects On Lid or On the Sides of the Pitcher.

- The mixture is too thick. Add more liquid.

You Cannot Achieve Snow From Solid Ice.

- **DO NOT** use ice that has been sitting out or has started to melt. Use ice straight from the freezer.

REFURBISHED PRODUCT LIMITED NINETY DAYS WARRANTY

The **Refurbished Product Service Center** offers the following WARRANTY to the ORIGINAL purchaser of a product which we have refurbished.

This product that has been refurbished is warranted against any electronic or mechanical defects for a period of NINETY DAYS from the date of the original purchase by the consumer. Since this unit was sold as a refurbished item, the warranty does not apply to any cosmetic appearance items such as scratches. Should a defect occur, the **Refurbished Product Service Center** will repair or, at its option, replace defective unit/parts with new or rebuilt materials without charge for either parts or labor. Replacement unit/parts will be warranted for the remaining portion of the original warranty period.

This warranty does not cover installation or damage from accident, misuse, abuse, improper wiring, incorrect voltage, operating the unit against the instructions in the owner's manual or any product which has been opened, altered, or tampered with.

This warranty does not cover costs for removal and or installation of the unit for repair. Under no circumstances shall the service center be liable for any special, incidental or consequential damages or for any other expenses incurred by reason of use or sale of this product. This warranty is in lieu of any other warranties expressed or implied warranty of merchantability of fitness for particular use or otherwise.

This warranty gives the consumer specific legal rights and they may also have other rights which vary from State to State. Some States do not follow the exclusion or limitation of incidental or consequential damages, hence the above exclusion and limitations may not apply.

Refurbished Product Service Center
13225 Marquardt Avenue Santa Fe Springs, CA 90670.

WARRANTY REPAIR INFORMATION

If you need service on your unit and this product requires repair during the 90 days warranty period; please go to www.ConsumerServiceRefurbish.com or call the **Refurbished Product Service Center** at 562-946-3531 to obtain the required return authorization (RA) number. Pack the unit properly (the original carton is ideal for this purpose) along with a copy of your purchase receipt and a letter describing the problem. Send the unit freight prepaid and insured to:

Refurbished Product Service Center,
Att: Customer Service Department 13225 Marquardt Avenue Santa Fe Springs, CA 90670

Your unit will be promptly repaired and returned to you.

We will refuse to accept delivery of the returned unit unless the assigned RA number appears on the outside of the shipping carton.

Owner's Information
(Keep for your permanent records)

NAME: _____

ADDRESS: _____

CITY: _____ STATE: _____ ZIP CODE: _____

PHONE: _____ E-MAIL: _____

MODEL: _____ SERIAL NO.: _____

SharkNinja Operating LLC

Illustrations may differ from actual product. We are constantly striving to improve our products, therefore the specifications contained herein are subject to change without notice.

NINJA and TOTAL CRUSHING are registered trademarks of Shark Ninja Operating LLC.

This product may be covered by one or more U.S. patents. See sharkninja.com/patents for more information.

© 2021 SharkNinja Operating LLC

• The image shown here is for illustrative purposes only and may be subject to change.

804106955



PRINTED IN MEXICO Elbrd: J.E.
OBPN: NJ601AMZ_IB_MP_Mv5_210622
SC: 07-06-2023 TAB SHNMDL: IZ862H_B