



Portable  
PH

Before using this product, please read this manual carefully and keep it for future reference.

## CAUTION

- For support, please contact a service center.
- This appliance is not intended for use by people (including children) with reduced physical, sensory or mental capabilities or lack of experience and knowledge, unless they have been given supervision or instruction concerning use of the appliance by a person responsible for their safety.
- Children should be supervised to ensure that they do not play with the air conditioner.
- The appliance shall be installed in accordance with national wiring regulations.
- Do not operate your air conditioner in a humid room such as a bathroom or laundry room.

## Safety Precautions

To prevent injury to the user or other people and property damage, the instructions shown here must be followed. Incorrect operation due to ignoring of instructions may cause harm or damage. The level of risk is shown by the following indications.

**WARNING** This symbol indicates a hazardous situation which, if not avoided, could result in death or serious injury.

**CAUTION** This symbol indicates a hazardous situation, which, if not avoided, could result in minor or moderate injury.

**NOTICE** This symbol addresses practices not related to physical injury.

## WARNING

- Plug in power cord plug properly. Otherwise, it may cause electric shock or fire due to excess heat generation.
- Do not modify power cord length or share the outlet with other appliances as it may cause electric shock or fire due to overheating.
- Always ensure effective grounding. Incorrect grounding may cause electric shock.
- Unplug the unit if you notice unusual sounds or smells, or smoke comes from it. A damaged product may cause fire and electric shock.
- Keep firearms away from the unit.
- Ventilate room before operating the air conditioner if there is a gas leakage from another appliance.
- Do not operate or stop the unit by inserting or pulling out the power cord plug. Do not operate with wet hands or in very humid environments. It may cause electric shock.
- Do not allow water to come into contact with any electric parts. It may cause failure or electric shock.
- Do not use the socket if it is loose or damaged. It may cause fire and electric shock.
- Do not place the power cord close to heating appliances. It may cause fire and electric shock.
- Do not disassemble or modify unit. It may cause failure and electric shock.
- Do not damage or use an alternate power cord. It may cause fire and electric shock.
- If the power cord is damaged, it must be replaced by the manufacturer or an authorized service center or a similarly qualified person in order to avoid a hazard.
- Do not direct airflow straight into persons to avoid possible health hazard.
- Do not open the unit during operation. It may cause electric shock.
- Do not use the power cord near flammable gas or combustibles, such as gasoline, benzene, thinner, etc. It may cause an explosion or fire.

- Avoid fire hazard or electric shock. Do not use an extension cord or an adaptor plug. Do not remove any prongs from the power cord.
- Be sure the air conditioner is properly grounded. To minimize shock and fire hazards, proper grounding is important. The power cord is equipped with a three-prong grounding plug for protection against shock hazards.
- Your air conditioner must be used in a properly grounded wall receptacle. If the wall receptacle you intend to use is not adequately grounded or protected by a time delay fuse or circuit breaker, have a qualified electrician install the proper receptacle. Ensure the receptacle is accessible after the unit installation.
- Be sure the electrical service is adequate for the model you have chosen. This information can be found on the serial plate, which is located on the side of the cabinet and behind the grille.
- Do not drink water drained from the air conditioner.

## CAUTION

- When the air filter is to be removed, do not touch the metal parts of the unit. It may cause injury.
- When the unit needs cleaning, switch off, and turn off the circuit breaker. Do not clean unit when power is on as it may cause fire, electric shock or injury.
- Do not place obstacles around air inlets or inside of air outlet. It may cause failure or accident.
- Clean with a soft cloth only. Do not use strong detergents that contain wax or thinners as it may damage the product.
- Use caution when unpacking and installing. Sharp edges could cause injury.
- Do not clean the air conditioner with water. Water may enter the unit and degrade the insulation which could lead to electric shock.

- Do not put a pet or house plant where it will be exposed to direct air flow. This could injure the pet or harm the plant.
- Hold the plug by the head of the power plug when taking it out. Otherwise, it may cause electric shock and damage.
- Ensure that the installation is properly secured to prevent the product from potentially falling.
- Do not place heavy objects on the power cord and ensure that the cord is not compressed. Otherwise, there is danger of fire or electric shock.
- If water is spilled on the unit, turn off the unit and switch off the circuit breaker. Isolate supply by taking the power-plug out and contact a qualified service technician.
- Do not use near gas stove or other gas burning appliances, as air flow may affect gas combustion.
- Do not use for any purpose other than room comfort. Do not use this air conditioner to preserve precision devices, food, pets, plants, and art objects. It may cause deterioration.
- Turn off the main power switch if the unit is not to be used for an extended time.
- Always insert the filters securely. Clean filter once every two weeks. Operation without filters may cause failure.

## Operation of Current Device

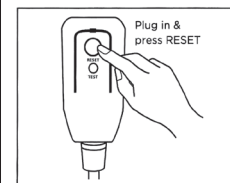

The power supply cord contains a measurement current device that senses damage to the power cord. Test your power supply cord as follows:

- Plug in the air conditioner.
- The power supply cord will have TWO buttons on the plug head. Press the TEST button. You will notice a click as the RESET button pops out.
- Press the RESET Button. You will notice a click as the button engages.
- The power supply cord is now supplying electricity to the unit. (On some products this is also indicated by a light on the plug head.)

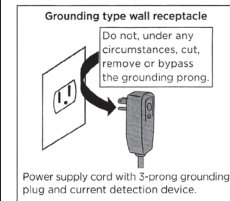

The power supply cord with this air conditioner contains a current detection device designed to reduce the risk of fire.

In the event that the power supply cord is damaged, it can not be repaired. It must be replaced with a cord from the manufacturer.

## NOTICE

- Do not use this device to turn the unit on or off.
- Always make sure the RESET button is pushed in for correct operation.
- The power supply must be replaced if it fails to reset when either the TEST button is pushed, or it can not be reset. Please contact a service center.

## EXPLANATION OF SYMBOLS DISPLAYED ON THE UNIT

	WARNING	This symbol shows that this appliance used a flammable refrigerant. If the refrigerant is leaked and exposed to an external ignition source, there is a risk of fire.
	CAUTION	This symbol shows that the operation manual should be read carefully.
	CAUTION	This symbol shows that a service personnel should be handling this equipment with reference to the installation manual.
	CAUTION	This symbol shows that information is available such as the operating manual or installation manual.

## WARNING (for using R32 refrigerant only)

- Do not try to accelerate the defrosting process or methods of cleaning that are not recommended by the manufacturer.
- The appliance shall be stored in a room without a continuously operating ignition source (for example, open flames or an operating gas appliance) or an ignition source (for example, an operating electric heater) close to the appliance. The appliance shall also be stored in a room without ignition sources.
- Do not pierce or burn.
- Be aware that the refrigerants may not contain an odor.
- Keep ventilation openings clear of obstruction.
- Flammable refrigerant R32 is used within air conditioner. Please follow the instructions carefully to handle, install, clean, and service the air conditioner to avoid damage or hazard. Do not dispose of air conditioner in regular trash. Contact qualified agency for proper disposal.
- No open fire or devices that generate spark/arcing shall be around the air conditioner to avoid causing ignition of the flammable refrigerant used. Please follow the instructions carefully to store or maintain the air conditioner to prevent mechanical damage from occurring.



Caution: Risk of fire/flammable materials (Required for R32/R290 units only)



IMPORTANT NOTE: Read this manual carefully before installing or operating your new air conditioning unit. Make sure to save this manual for future reference.

## Unit Specifications and Features

### Preparation

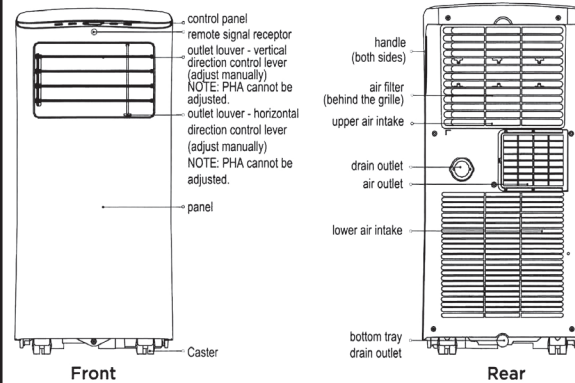

### Design and Compliance Notes

#### Design Notice:

In order to ensure the optimal performance of our products, the design specifications of the unit and remote control are subject to change without prior notice.

#### Energy Rating Information:

This product is tested in accordance to the DOE SACC capacity energy rating test.

#### Unit Temperature Range:

Mode	Temperature Range
Cool	17°C - 35°C (62°F - 95°F)
Dry	13°C - 35°C (55°F - 95°F)

### EXHAUST HOSE INSTALLATION:

The exhaust hose and adaptor must be installed or removed in accordance with the usage mode. For COOL or AUTO mode, exhaust hose must be installed. For FAN or DEHUMIDIFY exhaust hose must be removed.

## Operating Instructions

### Control Panel Features

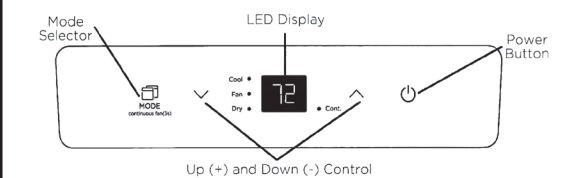

#### Mode Button

Selects the desired operating mode. Each time you press the button, a mode is selected in a sequence that goes from COOL, FAN and DRY. The mode light illuminates and indicates the selected mode.

#### LED display

Shows the set temperature while on cool mode. While on DRY and FAN modes, it shows the room temperature.

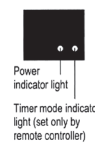

## NOTE

On above modes, the unit operates the auto fan speed automatically. You can set fan speed only by the remote controller on COOL and FAN modes.

#### Up (+) and Down (-) Buttons

Used to adjust (increasing/decreasing) temperature settings in 1°C/1°F increments in a range of 17°C/62°F to 30°C/86°F.

## NOTE

The control is capable of displaying temperature in degrees Fahrenheit or degrees Celsius. To convert from one to the other, press and hold the Up and Down buttons at the same time for 3 seconds.

#### Power Button

Power switch on/off.

## Operating Instructions

### COOL operation

- Press the "MODE" button until the "COOL" indicator light comes on.
- Press the UP and DOWN buttons "+" or "-" to select your desired room temperature. The temperature can be set within a range of 17°C-30°C/62°F-86°F.
- The fan speed is automatically set to auto. Use the remote to adjust the fan speed if desired.

### DRY operation

- Press the "MODE" button until the "DRY" indicator light comes on.
- While in this mode, you cannot select a fan speed or adjust the temperature. The fan motor operates at LOW speed.
- Keep windows and doors closed for the best dehumidifying effect.

### FAN operation

- Press the "MODE" button until the "FAN" indicator light comes on.
- Press the "FAN SPEED" button to choose the fan speed. The temperature cannot be adjusted.

### Other Features

#### SLEEP/ECO operation

This feature can be activated from the remote control ONLY. To activate SLEEP feature, the set temperature will increase by 1°C/2°F in 30 minutes. The set temperature will then increase by another 1°C/2°F after an additional 30 minutes. This new temperature will be maintained for 7 hours before it returns to the originally selected temperature. This ends the Sleep mode and the unit will continue to operate as originally programmed.

## NOTE

This feature is unavailable in FAN or DRY mode.

#### COMFORTSENSE

Feature (optional)

### Continuous drain hose

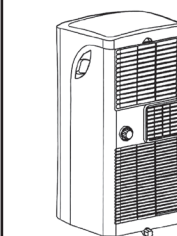
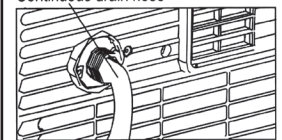

## NOTE

- When the water level of the bottom tray reaches a predetermined level, the unit beeps 8 times. The digital display shows "P1." At this time the air conditioning/dehumidification process will immediately stop. However, the fan motor will continue to operate (this is normal). Carefully move the unit to a drain location, remove the bottom drain plug and let the water drain away. Reinstall the bottom drain plug and restart the machine until the "P1" symbol disappears. If the error repeats, contact a service center.

## NOTE

When one of the above malfunctions occurs, turn off the unit and check for any obstructions. Restart the Unit. If the malfunction persists, turn off the unit and unplug the power cord. Contact a service center.

## Installation Instructions

### Choosing the Right Location



Your installation location should meet the following requirements:

- The unit must be near a window to install the exhaust hose and window kit into.
- Make sure that you install your unit on an even surface to minimize noise and vibration.
- The unit must be installed near a grounded plug, and the Collection Tray Drain (found on the back of the unit) must be accessible.
- The unit should be located at least 12" (30cm) from the nearest wall to ensure proper air conditioning. Obstacles should be at least 19.7" (50cm) away from the outlet louver.
- DO NOT cover the Intakes, Outlets or Remote Signal Receptor of the unit, as this could cause damage to the unit.

## NOTE

This feature can be activated from the remote control ONLY. The remote control serves as a remote thermostat allowing for the precise temperature control at its location.

To activate the Follow Me/Temp Sensing feature, point the remote control towards the unit and press the Follow Me/Temp Sensing button. The remote display is actual temperature at its location. The remote control will send this signal to the air conditioner every 3 minutes until the ComfortSense button is pressed again. If the unit does not receive the Follow Me/Temp Sensing signal during any 7 minutes interval, the unit will exit the Follow Me/Temp Sensing mode.

#### Constant Fan button

Feature (optional) in cooling or Dry mode, press the button for 3 seconds to turn on or off the constant fan function. When the function is turned on, the constant fan light will illuminate, identifying the fan continuous run for cooling. When the function is turned off, the constant fan light will go out, identifying the fan cycle run with compressor stop.

#### AUTO-RESTART

If the unit shuts off unexpectedly due to a power outage, it will restart with the previous set function when the power resumes.

#### WAIT 3 MINUTES BEFORE RESUMING OPERATION

After the unit has stopped, it cannot be restarted until 3 minutes time has elapsed. This is to protect the unit. Operation will automatically resume after 3 minutes.

#### AIRFLOW DIRECTION ADJUSTMENT

- Adjust the air flow direction manually:
  - The louver can be set to the desired position manually.
  - Do not place any heavy objects or other loads on the louver, doing so will cause damage to the unit.
  - Keep the louver fully opened during operation.

## Recommend Installation

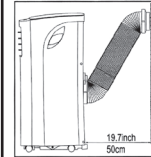

## WARNING

- This air-conditioning unit is a hermetically sealed unit that contains fluorinated gasses. For specific information on the type of gas and the amount, please refer to the relevant label on the unit itself.
- Service, maintenance and repair of this unit must be performed by a certified technician.
- Product recycling must be done according to local regulations.

## Tools Needed (Not Supplied)

- Phillips screwdriver
- Knife or scissors
- Tape measure or ruler
- Saw (optional, to shorten window adaptor for narrow windows).

## Accessories

Your Window Installation Kit fits windows 26.5"-48" (67.5-123cm) and can be shortened for smaller windows.

Part	Description	Part	Description
	Unit adaptor		Window slider B
	Exhaust hose		Foam seal A-B (adhesive)
	Window slider adaptor		Foam seal C (Non-adhesive)
	Bolt or Screw		Security bracket and 2 screws
	Window slider A		Remote controller (For remote control models only)

Accessory type and quantity may vary depending on the model.

## Window Installation Kit

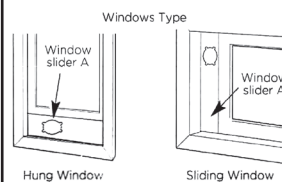
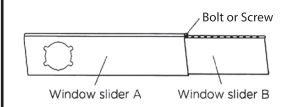
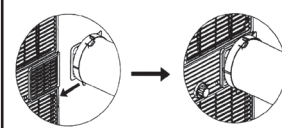
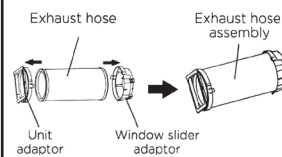

- Preparing the exhaust hose assembly**  
Press the exhaust hose into the window slider adaptor and the unit adapter until the plastic clips click onto the hose.

- Install the exhaust hose assembly to the unit**  
Slide the Exhaust hose into the air outlet opening of the unit along the arrow direction.

- Preparing the adjustable window slider**

- Depending on the size of your window, adjust the size of the window slider.
- If the length of the window requires two window sliders, use the bolt or screw to fasten the window sliders once they are adjusted to the proper length.

## NOTE

Once the Exhaust Hose assembly and Adjustable Window Slider are prepared, choose from one of the following two installation methods.

#### Type 1: Hung window installation

- Cut the adhesive foam seal A and B strips to the proper lengths, and attach them to the window sash and frame as shown.

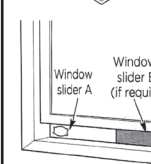
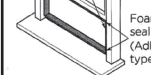

- Insert the window slider assembly into the window opening.



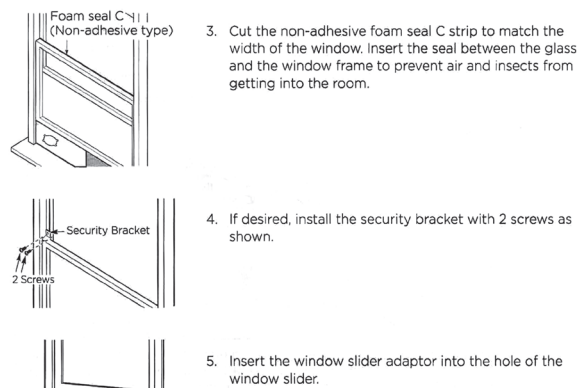

3. Cut the non-adhesive foam seal C strip to match the width of the window. Insert the seal between the glass and the window frame to prevent air and insects from getting into the room.



4. If desired, install the security bracket with 2 screws as shown.

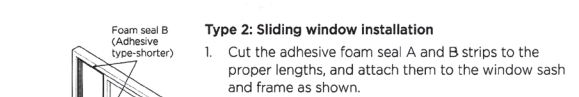

5. Insert the window slider adaptor into the hole of the window slider.



1. Cut the adhesive foam seal A and B strips to the proper lengths, and attach them to the window sash and frame as shown.

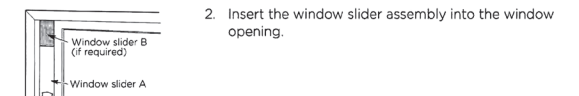

2. Insert the window slider assembly into the window opening.

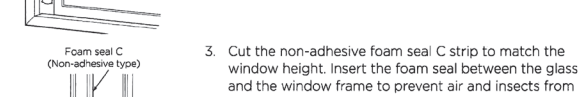

3. Cut the non-adhesive foam seal C strip to match the window height. Insert the foam seal between the glass and the window frame to prevent air and insects from getting into the room.

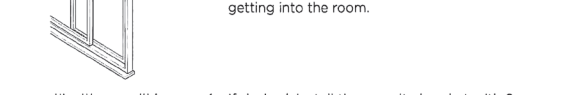

4. If desired, install the security bracket with 2 screws as shown.

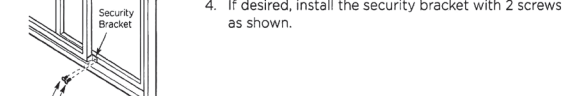

5. Insert the window slider adaptor into the hole of the window slider.

**NOTE**

To ensure proper functioning, DO NOT overextend or bend the hose. Make sure there are no obstacles within 0.5m (1.6ft) of the air outlet of the exhaust hose for the exhaust system to properly function. All illustrations in this manual are for explanation purposes only. Your air conditioner may slightly differ.

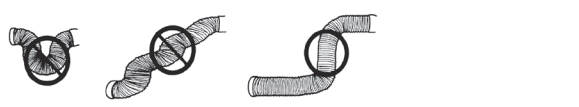

**Care and Cleaning**

- Safety Precautions**
- Always unplug the unit before cleaning or servicing.
  - DO NOT use flammable liquids or chemicals to clean the unit.
  - DO NOT wash the unit under running water. Doing so causes electrical danger.
  - DO NOT operate the machine if the power supply was damaged during cleaning. A damaged power cord must be replaced with a new cord from the manufacturer.

- Clean the Air Filter**
- Maintenance Tips**
- Be sure to clean the air filter every 2 weeks for optimal performance.
  - The water collection tray should be drained immediately after P1 error occurs, and before storage to prevent mold.
  - In households with animals, you will have to periodically wipe down the grill to prevent blocked airflow due to animal hair.



**CAUTION**  
DO NOT operate the unit without filter because dirt and lint will clog it and reduce performance.

**Clean the Unit**

Clean the unit using a damp, lint-free cloth and mild detergent. Dry the unit with a dry, lint-free cloth.

**Store the Unit When Not in Use**

- Drain the unit's water collection tray according to the instructions in the following section.
- Run the unit on FAN mode for 12 hours in a warm room to dry it and prevent mold.
- Turn off the unit and unplug it.
- Clean the air filter according to the instructions in the previous section. Reinstall the clean, dry filter before storing.
- Remove the batteries from the remote control.

**NOTE**

Be sure to store the unit in a cool, dark place. Exposure to direct sunlight or extreme heat can shorten the lifespan of the unit.

**Troubleshooting Tips**

Before calling for service, review this list. It may save you time and expense. This list includes common occurrences that are not the result of defective workmanship or materials in this appliance.

Problem	Solution
Unit does not turn on when pressing ON/OFF button	Displays P1 Error Code and means the water collection tray is full. Turn off the unit, drain the water from the water collection tray, and restart the unit. If room temperature is lower than the set temperature in COOL mode, reset the temperature.
Unit does not cool well	The air filter is blocked with dust or animal hair. Turn off the unit and clean the filter according to the instructions. Exhaust hose is not connected or is blocked. Turn off the unit, disconnect the hose, check for blockage, and reconnect the hose. Temperature setting is too high; decrease the set temperature. Make sure all windows and doors are closed. The room area could be too large; doublecheck the cooling area. Check the room for possible heat sources and remove them if possible.
The unit is noisy and/or vibrates too much.	The floor is not level. Place the unit on a flat, level surface. The air filter is blocked with dust or animal hair. Turn off the unit and clean the filter according to the instructions.
The unit makes a gurgling sound.	This sound is caused by the refrigerant flow inside the unit and is normal.
Unit will not connect to WiFi or App does not work (some models).	For additional support and troubleshooting tips, follow the link in this QR code: 

**Remote Control Instructions**

**Using The Remote Control**

**Location of the remote controller**  
Use the remote controller within a distance of 8 meters / 26 feet from the appliance, pointing it towards the receiver. Reception is confirmed by a beep.

**CAUTION**

- The air conditioner will not operate if curtains, doors or other materials block the signals from the remote controller to the indoor unit.
- Prevent any liquid from falling into the remote controller. Do not expose the remote controller to direct sunlight or heat.
- If the infrared signal receiver on the indoor unit is exposed to direct sunlight, the air conditioner may not function properly. Use curtains to prevent the sunlight from falling on the receiver.
- If other electrical appliances react to the remote controller, either move these appliances or call a service center.

**Remote Control Specifications**

Model	RG57H3(B)/BGCEFU1-M
Rated voltage	3.0V (Dry batteries R03/LR03x2)
Signal receiving range	8 m (approx. 26 ft.)
Environment	-5°C - 60°C (23°F - 140°F)

**Function Buttons**

Before you begin using your new air conditioner, make sure to familiarize yourself with its remote control. The following is a brief introduction to the remote control itself. For instructions on how to operate your air conditioner, refer to the Operating Instructions section of this manual.

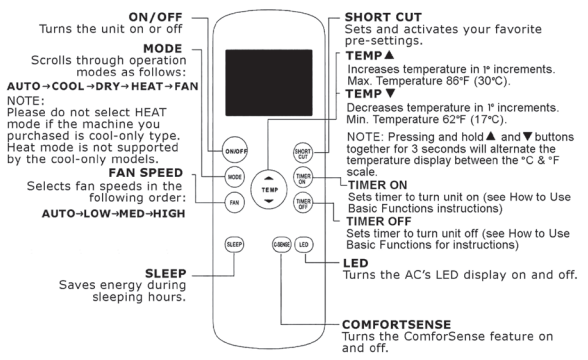

The remote control vary depend of model. The buttons on the remote control may have a different name or location than the remote control shows in this manual.

**Handling the Remote Control**  
**Not sure what a function does?**  
Refer to the Operating Instructions section of this manual for detailed descriptions of the functions available using the remote.

**Notice**

Button designs on your unit may differ slightly from the examples below. If the unit does not have a specific function, using that function's button on the remote control will have no effect.

**INSERTING AND REPLACING BATTERIES**

- Your air conditioning unit comes with two AAA batteries. Insert the batteries in the remote control before use.
- Slide the back cover of the remote control downward, exposing the battery compartment.
  - Insert the batteries, paying attention to align the (+) and (-) ends of the batteries with the symbols inside the battery compartment.
  - Slide the battery cover back into place.

**BATTERY NOTES**

- For optimum product performance:
- Do not mix old and new batteries, or batteries of different types.
  - Do not leave batteries in the remote control if you don't plan on using the device for more than 2 months.

**BATTERY DISPOSAL**

Ensure used batteries are disposed of properly.

**TIPS FOR USING REMOTE CONTROL**

- The remote control must be used within 26 feet / 8 meters of the unit.
- The unit will beep when it receives a signal from the remote.
- Curtains, other materials, and direct sunlight can interfere with the IR signal receiver.
- In order to properly transmit a command, the ON/OFF indicator must be illuminated on the remote's display. (See the Remote LED Screen Indicators section for more information.)

**Remote LED Screen Indicators**

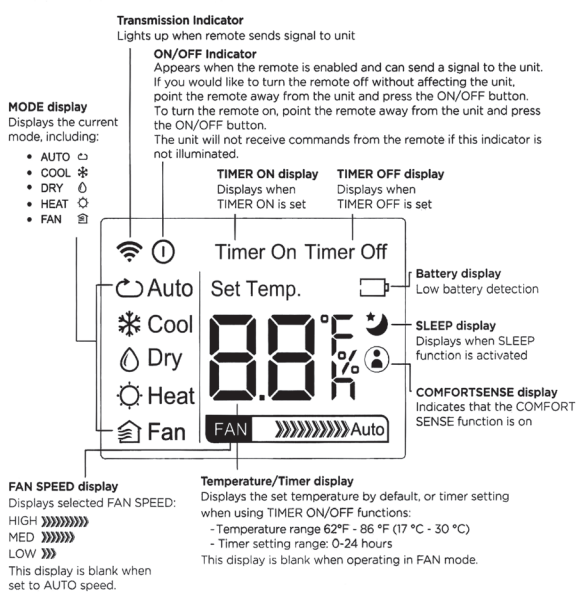

**Basic Functions**

**SETTING THE DESIRED TEMPERATURE**  
1. The operating temperature range for this unit is 62°F-86°F (17-30°C). You can increase or decrease the set temperature in 1°F (1°C) increments by pressing the ↑ or ↓ buttons.

**CHANGING THE MODE**  
1. To change the operating mode, press the MODE button until the desired mode appears on the remote's display.  
2. Set the desired temperature.

**NOTICE**

If the unit does not change when the button is pressed, check that the ON/OFF indicator is illuminated. If it is not, point the remote at the unit and press the ON/OFF button.

**Changing the Fan Speed**

1. To change the fan speed, press the FAN button until the desired fan speed appears on the remote's display.

**NOTE**

If the unit does not change when the button is pressed, check that the ON/OFF indicator is illuminated. If it is not, point the remote at the unit and press the ON/OFF button.

**Timer Functions**

Your air conditioning unit has two timer-related functions:  
**TIMER ON** - sets the amount of time after which the unit will automatically turn on.  
**TIMER OFF** - sets the amount of time after which the unit will automatically turn off.

**TIMER ON function**

The TIMER ON function allows you to set a period of time after which the unit will automatically turn on, such as when you come home from work.

- Press the TIMER ON button. By default, the last time period that you set and an "h" (indicating hours) will appear on the display.

**NOTICE**

This number indicates the amount of time after the current time after which you want the unit to turn on. For example, if you set TIMER ON for 2 hours, "2.0h" will appear on the screen, and the unit will turn on after 2 hours.

- Press the TIMER ON button repeatedly to set the time that you want the unit to turn on.
- Wait 2 seconds, then the TIMER ON function will be activated. The digital display on your remote control will then return to the temperature display.

**TIMER OFF function**

The TIMER OFF function allows you to set a period of time after which the unit will automatically turn off, such as when you wake up.

- Press the TIMER OFF button. By default, the last time period that you set and an "h" (indicating hours) will appear on the display.

**NOTICE**

This number indicates the amount of time after the current time after which you want the unit to turn off. For example, if you set TIMER OFF for 2 hours, "2.0h" will appear on the screen, and the unit will turn off after 2 hours.

- Press the TIMER OFF button repeatedly to set the time that you want the unit to turn off.
- Wait 2 seconds, then the TIMER OFF function will be activated. The digital display on your remote control will then return to the temperature display.

**NOTE**

When setting the TIMER ON or TIMER OFF functions, up to 10 hours, the time will increase in 30 minute increments with each press. After 10 hours and up to 24, it will increase in 1 hour increments. The timer will revert to zero after 24 hours.  
You can turn off either function by setting the timer to "0.0h".

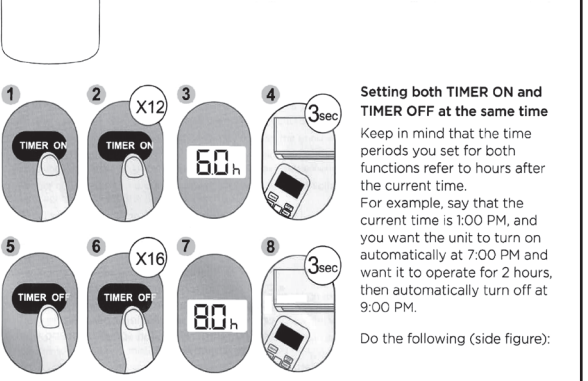

Do the following (side figure):

Example: Setting the unit to turn on after 6 hours, operate for 2 hours, then turn off (see the figure below)

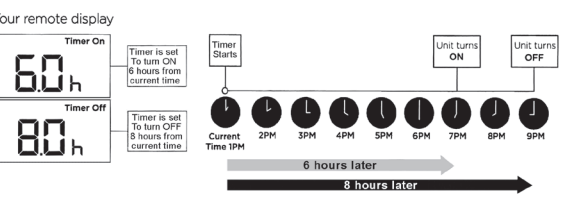

**Advanced Functions**

**SLEEP Function**

The SLEEP function is used to decrease energy use while you sleep (and don't need the same temperature settings to stay comfortable).

**Note: The SLEEP function is not available in FAN or DRY mode.**

**COMFORTSENSE Function**

The COMFORTSENSE function enables the remote control to measure the temperature at its current location. When using AUTO, COOL, or HEAT functions, measuring ambient temperature from the remote control (instead of from the indoor unit itself) will enable the air conditioner to optimize the temperature around you and ensure maximum comfort.

- Press COMFORTSENSE button to activate function. The remote control will send temperature signal to the unit every three minutes.
- Press COMFORTSENSE button again to turn off this function.

**REFURBISHED PRODUCT LIMITED THIRTY DAY WARRANTY**

The **Refurbished Product Service Center** offers the following WARRANTY to the ORIGINAL purchaser of a product which we have refurbished.

This product that has been refurbished is warranted against any electronic or mechanical defects for a period of THIRTY DAYS from the date of the original purchase by the consumer. Since this unit was sold as a refurbished item, the warranty does not apply to any cosmetic appearance items such as scratches. Should a defect occur, the **Refurbished Product Service Center** will repair or, at its option, replace defective unit/parts with new or rebuilt materials without charge for either parts or labor. Replacement unit/parts will be warranted for the remaining portion of the original warranty period.

This warranty does not cover installation or damage from accident, misuse, abuse, improper wiring, incorrect voltage, operating the unit against the instructions in the owner's manual or any product which has been opened, altered, or tampered with.

This warranty does not cover costs for removal and/or installation of the unit for repair. Under no circumstances shall the service center be liable for any special, incidental or consequential damages or for any other expenses incurred by reason of use or sale of this product. This warranty is in lieu of any other warranties expressed or implied warranty of merchantability of fitness for particular use or otherwise.

This warranty gives the consumer specific legal rights and they may also have other rights which vary from State to State. Some States do not follow the exclusion or limitation of incidental or consequential damages, hence the above exclusion and limitations may not apply.

**Refurbished Product Service Center**  
13225 Marquardt Avenue Santa Fe Springs, CA 90670

**WARRANTY REPAIR INFORMATION**

If you need service on your unit during the 30 day warranty period; please go to [www.ConsumerServiceRefurbish.com](http://www.ConsumerServiceRefurbish.com) or call the Refurbished Product Service Center at 562-946-3531 to obtain the required claim number. Once you obtain your claim number, pack the unit properly (the original carton is ideal for this purpose) along with a copy of your purchase receipt. Send the unit freight prepaid and insured to:

**Refurbished Product Service Center,**  
Attn: Customer Service Department 13225 Marquardt Avenue Santa Fe Springs, CA 90670

Your unit will be promptly exchanged and returned to you. We will refuse to accept delivery of the returned unit unless the assigned claim number appears on the outside of the shipping carton.

**Owner's Information**  
(Keep for your permanent records)

NAME: \_\_\_\_\_  
ADDRESS: \_\_\_\_\_  
CITY: \_\_\_\_\_ STATE: \_\_\_\_\_ ZIP CODE: \_\_\_\_\_  
PHONE: \_\_\_\_\_ E-MAIL: \_\_\_\_\_  
MODEL: \_\_\_\_\_ SERIAL NO.: \_\_\_\_\_