

NINJA™

FOODI™ Slot Toaster

804106687

NOTE: Recipe book is not included.

TECHNICAL SPECIFICATIONS

Voltage: 120V - 60Hz



IMPORTANT SAFEGUARDS

HOUSEHOLD USE ONLY • READ ALL INSTRUCTIONS BEFORE USE

When using electrical appliances, basic safety precautions should always be followed, including the following:

⚠ WARNING

- 1 Read all instructions prior to use.
- 2 Remove and discard all packaging materials and labeling before use.
- 3 This appliance can be used by persons with reduced physical, sensory or mental capabilities or lack of experience and knowledge if they have been given supervision or instruction concerning use of the appliance in a safe way and understand the hazards involved.
- 4 Take inventory of all contents to ensure you have all parts needed to properly and safely operate.
- 5 **DO NOT** run the unit without the crumb tray fully installed.
- 6 **DO NOT** run the unit in the Oven position without the bake tray fully inserted. **DO NOT** override the bake tray detect switch.
- 7 Keep the appliance and its cord out of reach of children. Do not allow the appliance to be used by children. Close supervision is necessary when used near children.
- 8 **DO NOT** use an extension cord. A short power-supply cord is used to reduce the risk of children grabbing the cord or becoming entangled and to reduce the risk of people tripping over a longer cord.
- 9 **DO NOT** let cord hang over edges of tables or counters or touch hot surfaces, including stoves and other heating ovens.
- 10 **NEVER** use outlet below counter.
- 11 **NEVER** leave the unit unattended while in use.
- 12 **DO NOT** cover crumb tray or bake tray or any part of the unit with metal foil. This may cause the unit to overheat or cause a fire.
- 13 To protect against electrical shock **DO NOT** immerse cord, plugs, or main unit housing in water or other liquid.
- 14 **DO NOT** use the unit with damage to the power cord or plug. Regularly inspect the unit and power cord. If the unit malfunctions or has been damaged in any way, immediately stop use and call a Service center.
- 15 Prevent food contact with heating elements. Excessive or oversized food loads, metal foil packages, or utensils must **NOT** be inserted as they may cause risk of fire or electric shock.
- 16 Extreme caution must be used when the unit contains hot food. Improper use may result in personal injury.
- 17 **ALWAYS** use the lightest toast setting when heating toaster pastries.
- 18 **DO NOT** cover the air intake vents or air outlet vents while unit is operating. Doing so will prevent even cooking and may damage the unit or cause it to overheat.
- 19 **DO NOT** insert anything in the ventilation slots and do not obstruct them.
- 20 **DO NOT** use accessory and attachments not recommended or sold by SharkNinja.
- 21 **DO NOT** place items on top of surface, including food, while unit is operating except for authorized recommended Ninja accessories.
- 22 Before placing any accessories into the unit ensure they are clean and dry.
- 23 Intended for countertop use only. **DO NOT** place the unit near the edge of a countertop. Ensure the surface is level, clean and dry.
- 24 This unit is for household use only. **DO NOT** use this unit for anything other than its intended use. Misuse may cause injury.
- 25 **DO NOT** use outdoors. **DO NOT** use in moving vehicles or boats.
- 26 **DO NOT** operate in enclosed space or under cabinets.
- 27 Provide adequate space above (minimum 10"/254mm) and on all sides (minimum 4"/102mm) for air circulation.
- 28 **DO NOT** place anything on the unit during operation. A fire may occur if the unit is covered or touching flammable material, including curtains, draperies, walls, or the like when in operation.
- 29 **DO NOT** spray any type of aerosol spray or flavoring inside the unit while cooking.
- 30 Use caution when inserting and removing anything from the unit, especially when hot.
- 31 Outlet voltages can vary, affecting the performance of your product. To prevent possible illness, use a thermometer to check that your food is cooked to the temperatures recommended.
- 32 **DO NOT** insert metal utensils such as a knife into the unit to remove jammed toast, bagels or any other items. This can damage the heating elements or cause electric shock.
- 33 Unplug the unit and allow it to cool before cleaning any food that become stuck or spilled into cavity.
- 34 **DO NOT** place any of the following materials in the unit: paper, cardboard, plastic, roasting bags and the like. They may cause fire.
- 35 Extreme caution should be exercised when using containers constructed of any materials other than metal or glass.
- 36 **DO NOT** touch hot surfaces. Unit surfaces are hot during and after operation. To prevent burns or personal injury, **ALWAYS** use protective hot pads or insulated oven mitts and use available handles and knobs.
- 37 Please refer to the Cleaning & Maintenance section for regular maintenance of the unit.
- 38 Cleaning and user maintenance shall not be made by children.
- 39 Press the power button to turn unit off and allow to cool completely before cleaning, moving and flipping for storage.
- 40 Unplug from outlet when not in use. To unplug, grasp the plug by the body and pull from the outlet. Never unplug by grasping and pulling the flexible cord.
- 41 **DO NOT** clean with metal scouring pads. Pieces can break off the pad and touch electrical parts, causing a risk of electrical shock.
- 42 **DO NOT** store any materials, other than supplied accessories, in the unit when not in use.
- 43 **DO NOT** use the unit as a source of heat or for drying.
- 44 **DO NOT** use bake tray without handle installed.

PARTS

- A** Main Unit
(Attached power cord not shown)

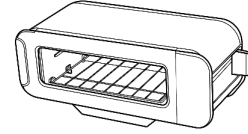

NOTE: Crumb tray in back of unit is not fully removable.

- B** Bake Tray
(Place in unit for Oven position functions)
Hand-wash only

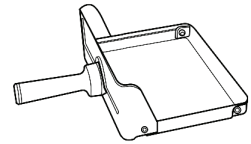

ASSEMBLY INSTRUCTIONS: Permanently attach handle to the bake tray by screwing in clockwise until fully attached.

MOVING BETWEEN COOKING POSITIONS

- 1 Flip unit down to the Oven position.
- 2 Push toast lever back to open the cooking cavity. There will be audible click. "LOC" will appear on the display if toast lever is not in the lock position.
- 3 Insert bake tray. Select function and set cook time and temp.
- 4 Press START/STOP to begin cooking.

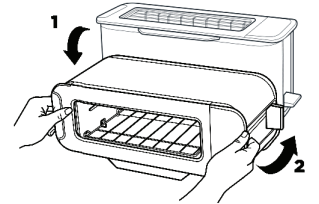

NOTE: Sneak a peek at your food during cooking by removing the bake tray. The unit will pause until bake tray has been reinserted.

NOTE: Accessories may vary depending on the model. Refer to quick guide, if available. The images shown here are for illustrative purposes only and may be subject to change.

BEFORE FIRST USE

- 1 Remove and discard any packaging material, stickers, and tape from the unit.
- 2 Remove all accessories from the package and read this manual carefully. Please pay particular attention to operational instructions, warnings, and important safeguards to avoid any injury or property damage.
- 3 Wash the bake tray in warm, soapy water, then rinse and dry thoroughly. **NEVER** submerge the main unit in water.
- 4 We recommend flipping the unit to the Oven position, placing the bake tray inside the unit, and running it on Bake at 400°F for 10 minutes without adding food. See instructions on moving to the Oven position for Bake. Make sure the area is well ventilated, as some odor may be released. This removes any packaging residue and odor traces that may be present. This is completely safe and not detrimental to the performance of the toaster.

NOTE: For longest accessory life, we recommend hand-washing the accessories.

USING THE CONTROL PANEL

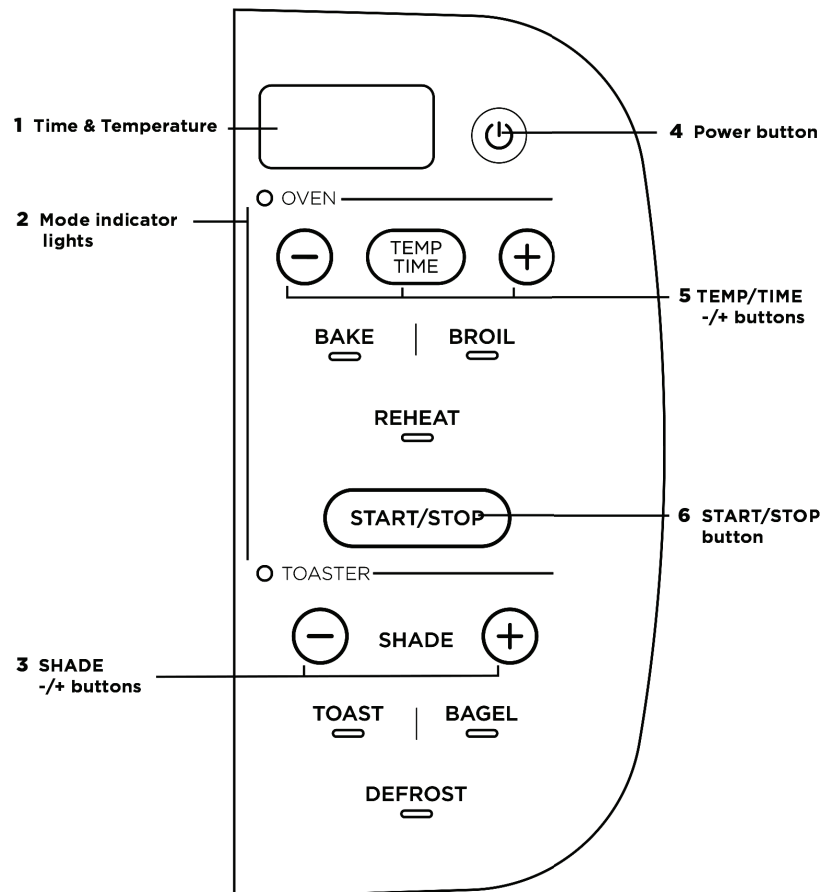

FUNCTIONS

BAKE: Evenly bakes everything from your favorite personal pizzas to biscuits.

BROIL: Broils and evenly browns the tops of foods like cheesy toast.

REHEAT: Quickly reheat cooked foods like a slice of pizza.

TOAST: Evenly toasts up to 2 slices of bread to your perfect level of darkness.

BAGEL: Perfectly toast up to 2 bagel halves when they're placed cut-side forward in the toaster. The icon on the unit will show instructed direction.

DEFROST: Toggle on for added time when using Toast or Bagel functions with frozen bread.

NOTE: The Defrost and Reheat functions are not included on all models.

NOTE: The image shown here is for illustrative purposes only and may be subject to change. The actual descriptions of control panel and their locations may vary, depending on the model.

Indicates to read and review instructions to understand operation and use of product.

Indicates the presence of a hazard that can cause personal injury, death or substantial property damage if the warning included with this symbol is ignored.

Take care to avoid contact with hot surface. Always use hand protection to avoid burns.

For indoor and household use only.

SAVE THESE INSTRUCTIONS

SharkNinja Operating LLC

Illustrations may differ from actual product. We are constantly striving to improve our products, therefore the specifications contained herein are subject to change without notice.

NINJA is a registered trademark of SharkNinja Operating LLC.
FOODI is a trademark of SharkNinja Operating LLC.

For SharkNinja U.S. patent information, visit sharkninja.com/uspatents.
© 2021 SharkNinja Operating LLC.

CONTROL PANEL DISPLAY & OPERATING BUTTONS

- 1 Time & Temperature display:** Shows the cook time and will count down when cooking is in progress. Press TEMP/TIME button to toggle to temperature display.
- 2 Mode Indicator lights:** Signify Oven or Toaster orientation. Flip unit down and slide lever back until it clicks into place to lock toaster in oven position.

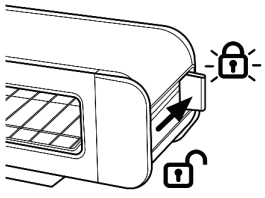

NOTE: "LOC" will appear on the display if toast lever is not in the lock position.

- 3 SHADE +/- buttons:** Adjust the toast shade for Toast and Bagel functions.
- 4 Power button:** Press to turn unit on or off.
- 5 TEMP/TIME +/- buttons:** Press TEMP/TIME to toggle between selections, then use +/- buttons to adjust.

NOTE: Cook time and temperature will revert to the same settings from the last time the unit was in use.

- 6 START/STOP button:** Press to start or stop cooking or toasting. Cooking will begin shortly thereafter.

NOTE: The cook time and temperature may be adjusted at any time during cooking.

USING YOUR FOODI™ FLIP TOASTER

USING THE COOKING FUNCTIONS

To turn on the unit, plug the power cord into a wall outlet, and press the button.

Flipping to the Oven Position

From the Toaster position, flip the unit down and push the toast lever back. To lock position or until you hear an audible click.

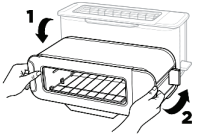

NOTE: To unlock lever, simply flip the unit back up to Toaster Position.

Bake

- Flip unit down to the horizontal position and push the lever back to lock position. Select BAKE. The last temperature set will appear on the display.
- Use the +/- buttons to select a temperature between 250°F and 400°F. Press the TEMP/TIME button to lock in the temperature.
- Press the TEMP/TIME button again to see the time display. Then use the +/- buttons to select a time between 1 minute and 45 minutes.
- Place ingredients on the bake tray and insert in unit Press START/STOP. Cooking will begin when the tray is correctly inserted. Cook will not start if the tray is not fully inserted.
- During cooking, you can remove the bake tray to check on food. The timer will pause until the bake tray has been reinserted in the unit.
- When cook time reaches zero, the unit will beep.

Broil

- Flip unit down to the horizontal position and push the lever back to lock position. Select BROIL.
- Press the TEMP/TIME button to see the time display. Then use the +/- buttons to select a time between 1 minute and 10 minutes.

NOTE: Broil operates on high (400°F). The temperature cannot be adjusted.

- Place ingredients on the bake tray and insert tray in unit Press START/STOP. Cooking will begin when the tray is correctly inserted.
- During cooking, you can remove the bake tray to check on food. The timer will pause until the bake tray has been reinserted in the unit.
- When cook time reaches zero, the unit will beep.

Reheat

- Flip unit down to the horizontal position and push lever back to lock position. Select REHEAT. The last temperature set will appear on the display.
- Use the +/- buttons to select a temperature between 250°F and 350°F. Press the TEMP/TIME button to lock in the temperature.
- Press the TEMP/TIME button again to see the time display. Then use the +/- buttons to select a time between 1 minute and 45 minutes.

- Place ingredients on the bake tray and insert tray in unit Press START/STOP. Cooking will begin when the tray is correctly inserted.
- During cooking, you can remove the bake tray to check on food. The timer will pause until the bake tray has been reinserted in the unit.
- When cook time reaches zero, the unit will beep.

NOTE: If cooking for less than 10 minutes, the clock will count down by minutes and seconds. If cooking for 10 minutes or more, the clock will count down by minutes only until the times reaches below 10 minutes.

NOTE: Reheat function not available on all units.

Flipping to the Toaster Position

From the Oven position, flip the unit up. The toast lever will spring up to reset for toasting.

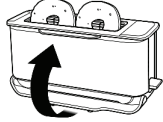

TIPS FOR CHOOSING YOUR SHADE SELECTION

- With multiple slices, place next to each other. Make sure there is no overlap of the slices so they can toast consistently. If bread slices do not fit next to each other, try rotating them sideways for a better fit.
- For drier or stale breads, adjust the shade lower than your standard setting.
- For freshly baked or whole wheat breads, adjust the shade higher than your standard setting.
- For bread with an unsmooth surface (like English muffins), adjust the shade higher than your standard setting. Be sure to slice bread evenly for consistent toasting.
- For thick-cut pieces, adjust the shade higher than your standard setting. Be sure to slice bread evenly for consistent toasting.
- Split bagels in half before toasting. Place the cut side facing you, with the control panel on the right side.
- For frozen waffles, frozen French toast, or frozen bagels, use the appropriate function and toggle on Defrost.
- Do not place buttered bread in the unit. Butter after toasting.
- Be aware that very thin slices may burn. Use the lowest shade selection and monitor while toasting.

SETTING	COLOR
1-2	Light
3-5	Medium
6-7	Dark

Toast

- Flip unit up to the vertical position. Select the TOAST function.
- Use the +/- SHADE buttons to select the desired shade level.

NOTE: There is no temperature adjustment available for the Toast function.

- Place bread slices in the unit. Push the lever down to start toasting.

NOTE: Check on progress during toasting by lifting lever to raise toast. Toasting will not pause, so push lever back down promptly after checking.

- When toasting time reaches zero, the unit will beep and the lever and toast will pop up. Cancel a cycle early by pressing the START/STOP button.

NOTE: The unit uses an algorithm to ensure consistent shade results whether toasting from a cold or pre-warmed unit. As a result, the total toast time may change — to add more or less time, press the shade buttons.

NOTE: Heating elements will cycle on and off during cooking to maintain the set temperature.

Bagel

- Flip unit up to the vertical position. Select the BAGEL function.
- Use the +/- SHADE buttons to select the desired shade level.

NOTE: The image shown here is for illustrative purposes only and may be subject to change.

- Place bagel halves, cut-side facing you, in the unit. Push the lever down to start toasting.

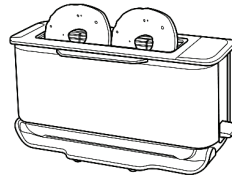

- When toasting time reaches zero, the unit will beep and the lever and bagel halves will pop up. Cancel a cycle early by pressing the START/STOP button.

NOTE: Heating elements will cycle on and off during toasting to maintain the set temperature.

NOTE: Check on progress during toasting by lifting lever to raise bagel slices. Toasting will not pause, so push lever back down promptly after checking.

NOTE: The unit uses an algorithm to ensure consistent shade results whether toasting with a cold or pre-warmed unit. As a result, the total toast time per shade level may vary. To add more or less time, press the shade buttons.

Defrost

- Defrost can be used with either the Toast or Bagel function.
- Toggle Defrost on to add extra time for defrosting bread before toasting.

ERROR MESSAGES & FAQ

ERROR MESSAGES

"CALL CUST SrVC" followed by "Er1," "Er2," "Er3," "Er4," "Er5," "Er6," or "Er7"

Turn off and unplug the unit and call a Service center.

FAQ

Why won't the unit turn on?

- Make sure the power cord is securely plugged into the outlet.
- Try plugging the cord into a different outlet.
- Reset the circuit breaker if necessary.
- Press the Power button.
- If the issue persists after following the steps above, contact a Service center. **Why aren't the Oven functions illuminated when the unit is in the horizontal position?**

Make sure the toast lever is pushed all the way back to open the cooking cavity. You will hear a click when the lever is fully pushed back.

- Make sure the flip foot is on the bottom of the unit.

Can I look at my food while the unit is cooking?

- Yes, when the unit is in the horizontal position, you can remove the bake tray at any time to check on your food. The cook time will pause until you reinsert the tray. Auto-shutoff will occur after the bake tray has been removed for 10 minutes.
- When the unit is in the vertical position, you can lift the toast lever at any point to check on progress without canceling toasting.

Can I restore the unit to its default settings?

- The unit will remember the last setting used for each function, even if you unplug it. To restore the unit's default settings for each function, press the two SHADE buttons simultaneously for 5 seconds.

Why do the heating elements appear to be turning on and off?

- This is normal. The unit is designed to control temperature precisely for every function by adjusting the heating elements' power levels.

REFURBISHED PRODUCT LIMITED NINETY DAYS WARRANTY

The **Refurbished Product Service Center** offers the following WARRANTY to the ORIGINAL purchaser of a product which we have refurbished.

This product that has been refurbished is warranted against any electronic or mechanical defects for a period of NINETY DAYS from the date of the original purchase by the consumer. Since this unit was sold as a refurbished item, the warranty does not apply to any cosmetic appearance items such as scratches. Should a defect occur, the **Refurbished Product Service Center** will repair or, at its option, replace defective unit/parts with new or rebuilt materials without charge for either parts or labor. Replacement unit/parts will be warranted for the remaining portion of the original warranty period.

This warranty does not cover installation or damage from accident, misuse, abuse, improper wiring, incorrect voltage, operating the unit against the instructions in the owner's manual or any product which has been opened, altered, or tampered with.

This warranty does not cover costs for removal and or installation of the unit for repair. Under no circumstances shall the service center be liable for any special, incidental or consequential damages or for any other expenses incurred by reason of use or sale of this product. This warranty is in lieu of any other warranties expressed or implied warranty of merchantability of fitness for particular use or otherwise.

This warranty gives the consumer specific legal rights and they may also have other rights which vary from State to State. Some States do not follow the exclusion or limitation of incidental or consequential damages, hence the above exclusion and limitations may not apply.

Refurbished Product Service Center
13225 Marquardt Avenue Santa Fe Springs, CA 90670.

WARRANTY REPAIR INFORMATION

If you need service on your unit and this product requires repair during the 90 days warranty period; please go to www.ConsumerServiceRefurbish.com or call the **Refurbished Product Service Center** at 562-946-3531 to obtain the required return authorization (RA) number. Pack the unit properly (the original carton is ideal for this purpose) along with a copy of your purchase receipt and a letter describing the problem. Send the unit freight prepaid and insured to:

Refurbished Product Service Center,
Att: Customer Service Department 13225 Marquardt Avenue Santa Fe Springs, CA 90670

Your unit will be promptly repaired and returned to you.

We will refuse to accept delivery of the returned unit unless the assigned RA number appears on the outside of the shipping carton.

Owner's Information
(Keep for your permanent records)

NAME: _____
ADDRESS: _____
CITY: _____ STATE: _____ ZIP CODE: _____
PHONE: _____ E-MAIL: _____
MODEL: _____ SERIAL NO.: _____



PRINTED IN MEXICO Elbrd: M.C.
OBPN: ST100SERIES_IB_SHEET_MP_Mv6_210520
SC: 02-08-2021_TAB MODEL: ST100_B

