

Please read this manual before use the unit.

## IMPORTANT SAFETY INSTRUCTIONS

### For Household Use Only

WHEN USING YOUR SHARK NAVIGATOR® DLX VACUUM, BASIC SAFETY PRECAUTIONS SHOULD ALWAYS BE FOLLOWED, INCLUDING THE FOLLOWING:

READ ALL INSTRUCTIONS BEFORE USING YOUR SHARK® NAVIGATOR® DLX VACUUM.

#### POLARIZED PLUG:

This appliance has a polarized plug (one blade is wider than the other). As a safety feature, this plug will fit into a polarized outlet only one way. **Do not force into the outlet or try to modify the plug to fit.**

#### ⚠WARNING:

TO REDUCE THE RISK OF ELECTRIC SHOCK OR INJURY DO NOT USE OUTDOORS OR ON WET SURFACES.

#### ⚠WARNING:

TO REDUCE THE RISK OF FIRE, ELECTRIC SHOCK OR INJURY:

#### GENERAL ELECTRICAL SAFETY:

- Unplug from electrical outlet when not in use and before servicing.
- DO NOT** use vacuum with a damaged cord or plug.
- DO NOT** pull or carry vacuum by the cord.
- DO NOT** unplug by pulling on cord; to unplug, grasp the plug, not the cord.
- DO NOT** handle plug or vacuum cleaner with wet hands.
- DO NOT** run the vacuum over the power cord.
- DO NOT** close a door on the cord.
- DO NOT** pull cord around sharp corners.
- DO NOT** leave appliance when plugged in.

- Keep power cord away from heated surfaces.
- Turn off all controls before plugging or unplugging vacuum cleaner.
- Always turn off this appliance before connecting or disconnecting the motorized nozzle.

#### HOSE ATTACHMENTS:

- DO NOT** use if air flow is restricted; if the air paths, the hose or the extension tube become blocked, turn the vacuum cleaner off. Remove all obstructions before you turn on the unit again.
- Keep the end of the hose, wands and other openings away from face and body.
- Keep rotating brush and suction openings away from hair, face, fingers, uncovered feet or loose clothing.
- Only use manufacturer's recommended attachments.

#### GENERAL USE:

- Use only as described in this manual.
- DO NOT** put any objects into openings.
- Keep your work area well lit.
- Keep the vacuum moving over the carpet surface at all times to avoid damaging the carpet fibers.
- DO NOT** place vacuum on unstable surfaces such as chairs or tables.
- DO NOT** allow young children to operate the vacuum or use as a toy.
- DO NOT** use vacuum cleaner if it has been dropped, damaged, left outdoors or submerged in water. Call a service center.

#### CYCLONIC CHAMBER/DUST CUP/FILTERS:

- Before turning on the vacuum:
  - Make sure that dust cup and all filters are in place after routine maintenance.

- Make sure that all components and filters are thoroughly dry after routine cleaning.
- Make sure accessories are free of blockages.
- Only use filters and accessories provided with this unit. [Failure to do so will void the warranty]

#### GENERAL CLEANING:

- DO NOT** run the vacuum over large-sized objects.
- DO NOT** pick up hard or sharp objects such as glass, nails, screws or coins that could damage the vacuum cleaner.
- DO NOT** pick up smoking or burning objects such as hot coals, cigarette butts, fireplace ash, or matches.
- DO NOT** use to pick up drywall dust.
- DO NOT** pick up flammable or combustible materials such as lighter fluid, gasoline, kerosene or use in areas where they may be present.
- DO NOT** pick up toxic solutions such as chlorine bleach, ammonia or drain cleaner.
- DO NOT** use in an enclosed space where vapors are present from paint, paint thinner, moth-proofing substances, flammable dust or other explosive or toxic materials.
- DO NOT** vacuum up any liquids.
- DO NOT** immerse vacuum cleaner in water or other liquids.
- DO NOT** use outdoors or on wet surfaces; use only on dry surfaces.
- Use extra care when cleaning on stairs.

## SAVE THESE INSTRUCTIONS

### REFURBISHED PRODUCT LIMITED NINETY DAYS WARRANTY

The **Refurbished Product Service Center** offers the following WARRANTY to the ORIGINAL purchaser of a product which we have refurbished.

This product that has been refurbished is warranted against any electronic or mechanical defects for a period of NINETY DAYS from the date of the original purchase by the consumer. Since this unit was sold as a refurbished item, the warranty does not apply to any cosmetic appearance items such as scratches. Should a defect occur, the **Refurbished Product Service Center** will repair or, at its option, replace defective unit/parts with new or rebuilt materials without charge for either parts or labor. Replacement unit/parts will be warranted for the remaining portion of the original warranty period.

This warranty does not cover installation or damage from accident, misuse, abuse, improper wiring, incorrect voltage, operating the unit against the instructions in the owner's manual or any product which has been opened, altered, or tampered with.

This warranty does not cover costs for removal and or installation of the unit for repair. Under no circumstances shall the service center be liable for any special, incidental or consequential damages or for any other expenses incurred by reason of use or sale of this product. This warranty is in lieu of any other warranties expressed or implied warranty of merchantability of fitness for particular use or otherwise.

This warranty gives the consumer specific legal rights and they may also have other rights which vary from State to State. Some States do not follow the exclusion or limitation of incidental or consequential damages, hence the above exclusion and limitations may not apply.

Refurbished Product Service Center  
13225 Marquardt Avenue Santa Fe Springs, CA 90670.

### WARRANTY REPAIR INFORMATION

If you need service on your unit and this product requires repair during the 90 days warranty period; please go to **www.ConsumerServiceRefurbish.com** or call the **Refurbished Product Service Center** at 562-946-3531 to obtain the required return authorization (RA) number. Pack the unit properly (the original carton is ideal for this purpose) along with a copy of your purchase receipt and a letter describing the problem. Send the unit freight prepaid and insured to:

Refurbished Product Service Center,  
Att: Customer Service Department 13225 Marquardt Avenue Santa Fe Springs, CA 90670

Your unit will be promptly repaired and returned to you.

We will refuse to accept delivery of the returned unit unless the assigned RA number appears on the outside of the shipping carton.

#### Owner's Information (Keep for your permanent records)

NAME: \_\_\_\_\_  
ADDRESS: \_\_\_\_\_  
CITY: \_\_\_\_\_ STATE: \_\_\_\_\_ ZIP CODE: \_\_\_\_\_  
PHONE: \_\_\_\_\_ E-MAIL: \_\_\_\_\_  
MODEL: \_\_\_\_\_ SERIAL NO.: \_\_\_\_\_

## Getting Started

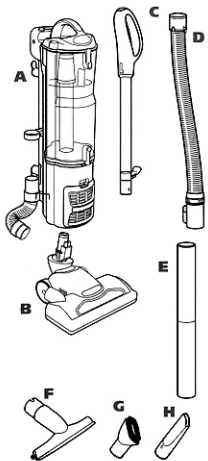

### WHAT'S IN THE BOX YOU JUST OPENED:

- A** Vacuum Body
- B** Floor Power Nozzle
- C** Handle Assembly
- D** Super Stretch Hose
- E** Cleaning Wand
- F** Upholstery Tool
- G** Dusting Brush
- H** Crevice Tool

Accessory type, appearance may vary depending on the model.

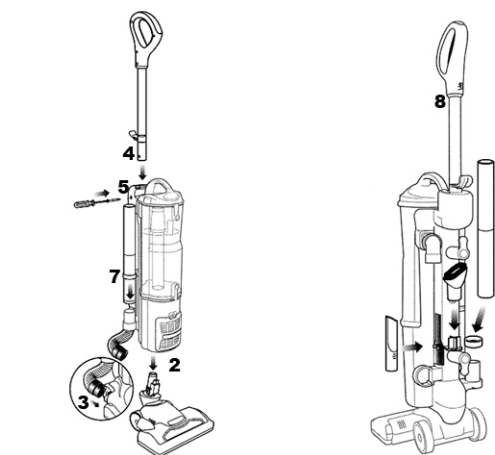

### Your Shark® Navigator® DLX is easy to assemble:

- Lay your vacuum body on a level surface.
- Slide the electrical connection from the power nozzle into the main body to click into place.
- Connect the hose from the main body to the power nozzle; push with a slight turning motion to create a snug fit.
- Slide the handle assembly into the upright unit aligning the hose hook on the handle assembly with the power cord hooks on the back of the unit.

- Secure the handle assembly in place with included bolt.
- Place the vacuum in the upright position.
- Insert the Cleaning Wand into the center post on the tool caddy.
- Store the Crevice Tool, Dusting Brush on the back of the unit.

## Getting Started

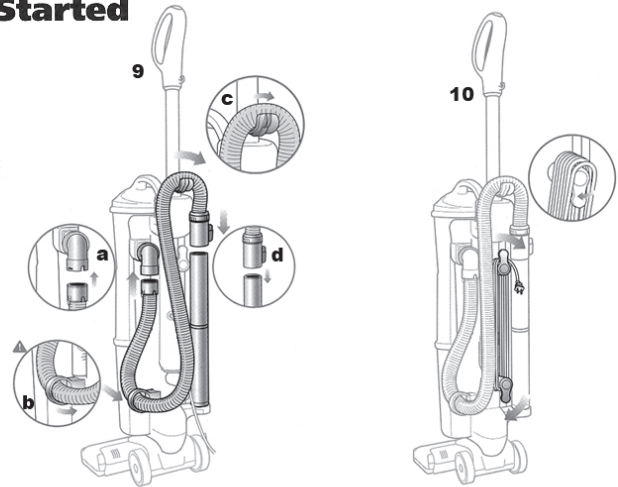

### 9 Attach the Super Stretch Hose:

- Snap hose into swivel connector
- Route under anti-tip hook to prevent vacuum from tipping
- Route over upper hose holder
- Press securely onto cleaning wand with handle

#### ⚠IMPORTANT:

Insert the hose into the wand. This completes the air path and enables suction to reach the Floor Power Nozzle.

### 10 To store the vacuum:

When storing your vacuum, wind the cord around the two cord holders and secure with cord clip:

- Quick Cord release at the top of the unit – place in the upright position.
- Cord holder near the base – turn it until it is pointing down. To release the cord, turn the Quick Cord release to the left or right.

### 11 To carry the vacuum:

With the unit in the standing position, lift by the Dust Cup Assembly Handle (carry handle).

- ⚠CAUTION:** When lifting or carrying, **DO NOT** press Dust Cup Assembly release button.

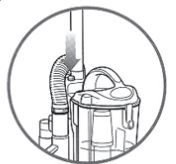

## Using the Vacuum

- ⚠IMPORTANT:** To protect your carpets, the brushroll will only turn on when you have pulled the handle back towards you and released the Floor Power Nozzle.

### 3 Power Switch Settings

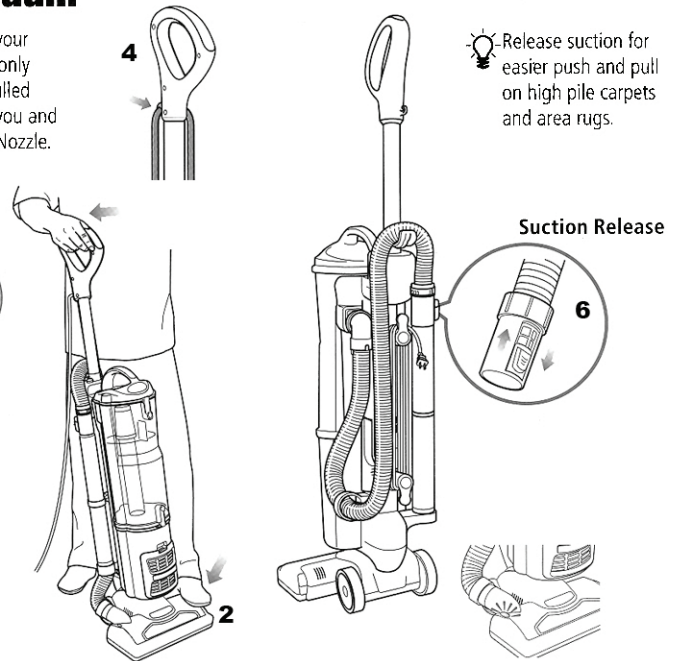
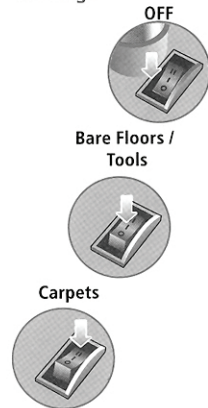

Your **Shark® Navigator® DLX** Vacuum can be used to clean bare floors or carpets – with the click of a switch.

Stand the vacuum into the upright position.

Plug in the vacuum.

- Start with the Power Switch in the "0" - Off position.
- Place your foot on the Floor Power Nozzle and pull handle towards you.
- Set the Power Switch to desired cleaning setting.
- Push the power cord into the groove on the handle and then secure the power cord into the cord clip.

- Press the On/Off switch to the "I" position to vacuum bare floors or cleaning with the hose (straight suction only) or to the "II" position to engage the motorized floor brush (for vacuuming carpets and rugs).

- Due to the huge suction power of this vacuum, it may become necessary to adjust the suction release on the hose. If the vacuum is difficult to push or pull or if it is lifting up area rugs, adjust the suction release by opening the valve at the top end of the hose. Close the suction release valve for maximum suction when vacuuming floors or when using the Wide Upholstery Tool.**

#### ⚠IMPORTANT:

Your Brushroll Indicator Light will illuminate solid green when the brushroll is on, or solid red if there is a blockage. This feature is designed to protect your Lifetime Belt that powers your brushroll. **See Checking for Blockages**

#### ⚠NOTE:

The height of your power nozzle has been optimized for easy pushing and superior cleaning on all floor types, so there is no need to make any height adjustments as you transition to different floor & carpet types.

## Cleaning with the Vacuum Accessories

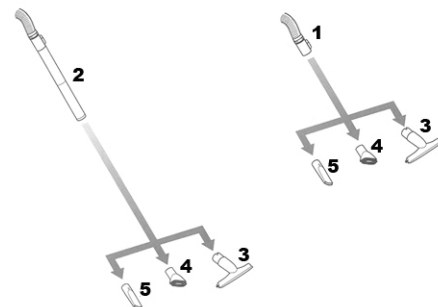

Before cleaning with your accessories:

Stand vacuum into upright position.

### Secure Super Stretch Hose in the anti-tip hook to prevent tipping.



Select the "I" - On position for suction only cleaning.

- ⚠DO NOT** pull vacuum cleaner around by the hose.
- ⚠DO NOT** overextend the hose.

#### Vacuum Accessories

Your vacuum comes with a Super Stretch Hose and Cleaning Wand. Use one or the other to attach your cleaning accessories.

#### 1 Using the Super Stretch Hose:

Stand the vacuum into upright position.

Remove the hose from the Cleaning Wand.

Push the selected tool into the hose connector.

#### 2 Using the Cleaning Wand:

Stand the vacuum into upright position.

Remove the Cleaning Wand (with hose attached) from the unit.

Push the selected tool into the end of the Cleaning Wand.

#### 3 Wide Upholstery Tool

#### 4 Dusting Brush

#### 5 Crevice Tool

## Maintenance

For best results empty the Dust Cup Assembly after each use, as needed during prolonged usage or when it reaches the **MAX** fill line.

### DO NOT OVERFILL.

Turn vacuum off before emptying.

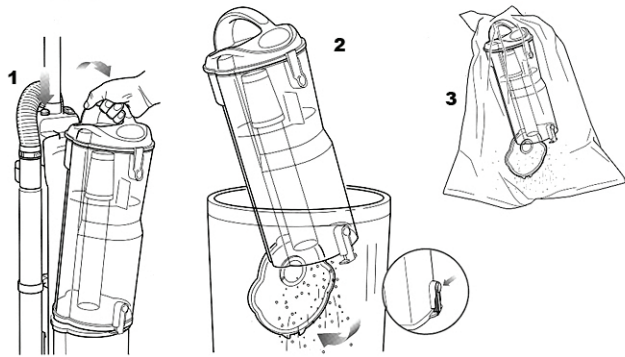

#### To empty the Dust Cup:

- 1** Grip carry handle and press the Dust Cup release button to remove.
  - 2 Option A:** For Quick Empty: Insert Dust Cup deep inside trash receptacle to contain dust and debris.  
Press the bottom Dust Cup release button; tap container gently to dislodge and release dust and debris.  
Snap door in place.
  - 3 Option B:** For Allergy Sufferers: Wrap a trash bag around the Dust Cup leaving space at the bottom for the door to swing open.  
Locate the Dust Cup Door release button within the trash bag and press to release as you shake the dust cup to empty dust and debris.  
Snap the bottom door in place.
- ⚠️ Important:** If the Dust Cup Door does not swing open after pressing the release button, push the door open using the bottom door tabs.

- ⚠️ Note:** Some dust and debris may remain in the top of your dust cup on or near the metal screen. It is not necessary to completely remove this material before continuing to vacuum; *Shark®* advanced cyclonic action will sweep the metal screen clean once you begin to refill your dust cup.
- ⚠️ Note:** Option B can also be performed outside of the home to further minimize releasing dust back into the air. Carry just the Dust Cup and trash bag outside.

COMPONENT	MAINTENANCE SCHEDULE
1 Dust Cup	Empty each time you vacuum.
2 Pre-Motor Foam Filter	Rinse and air dry every month under normal use.
3 Pre-Motor Felt Filter	Rinse and air dry every month under normal use.
4 Post-Motor HEPA Filter	Clean once a year under normal use.

- ⚠️ DO NOT** operate the vacuum without ALL the filters in place.  
**⚠️ DO NOT** operate the vacuum with WET filters.

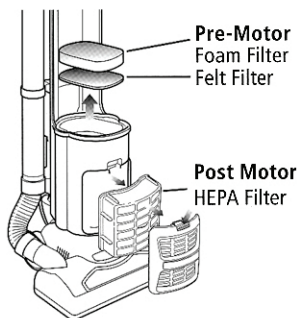

#### To clean the pre-motor filters:

- 1 Remove the dust cup.
  - 2 Pull the 2 filters out from the top of the motor base.
  - 3 Rinse the filters thoroughly in lukewarm water until the water runs clear.
- ⚠️ DO NOT** put the filters in the washing machine or dishwasher.
- NOTE:** The material in the filters will discolor over time. This is **NORMAL** and will not affect the performance of the filters.
- 4 Squeeze out excess water and let air-dry for at least 24 hours before replacing. Do not use a hair dryer or other heating methods to dry.
  - 5 Place the felt filter in first, then the foam filter.
  - 6 Replace the dust cup.

- ⚠️ IMPORTANT:** Loss of Suction may occur if foam filter is not cleaned every month. Rinse and allow to air dry completely. Also, tap loose dirt off filter between washes as needed. Foam filters may appear dirty after use - this is normal.

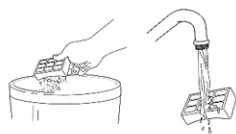

#### To clean the post-motor HEPA filter:

- 1 Remove the filter cover from the front of the vacuum by pulling up on the tab and pulling the cover away from the vacuum.
  - 2 Take out the HEPA filter by pulling it straight out.
  - 3 Turn the HEPA filter over so that the dirty side is on the bottom and vigorously tap it clean against a garbage can to remove any dust.
  - 4 Wash the HEPA filter under the tap using lukewarm water with the dirty side face down until the water runs clear.
- ⚠️ DO NOT** put the HEPA filter in the washing machine or dishwasher.
- NOTE:** The material in the filter will discolor over time. This is **NORMAL** and will not affect the performance of the filter.
- 5 Allow the HEPA filter to air dry for 24 hours. Do not use a hair dryer or other heating methods to dry.
  - 6 Once the HEPA filter is dry, replace it back into the vacuum.
  - 7 Replace the cover by inserting the two tabs into the holes at the bottom and then swinging the cover up until it clicks into place.

## Troubleshooting

PROBLEM	POSSIBLE REASON & SOLUTIONS
<b>Airflow is restricted. No suction or light suction.</b>	Check filters to see if they need cleaning. Follow instructions for rinsing and drying the filters before re-inserting back into the vacuum. (See "Maintenance" sections for instructions.) Dust cup may be full; empty dust cup. Check hose, hose connections, nozzles and accessories for blockages; clear blockages if required. Close the suction release on the hose to increase suction power. If dust cup is empty, and attachment inlets are clear, check for other blockages. (See "Checking for Blockages" for instructions.)
<b>Motorized floor brush has become jammed or has shut off.</b>	Immediately turn off and unplug vacuum, disconnect the nozzle and remove blockage before reconnecting and turning vacuum back on. (See "Checking for Blockages" for instructions.)
<b>Vacuum turns off on its own.</b>	This vacuum cleaner is equipped with a motor protective thermostat. If for some reason your vacuum overheats, the thermostat will automatically turn the unit off. Should this occur, perform the following steps to restart the motor thermostat: 1. Move the On/Off switch to the "O" (Off) position. 2. Unplug the vacuum. 3. Empty the dust cup and clean filters. (See "Maintenance" sections for instructions.) 4. Check for blockages in hose, accessories and inlet openings. (See "Checking for Blockages" for instructions.) 5. Allow the unit to cool for a minimum of 45 minutes. 6. Plug in the vacuum. 7. Turn the On/Off switch to the "I" (On) position to restart the vacuum. <b>Note:</b> If vacuum still does not start, contact a service center.

## Checking for Blockages

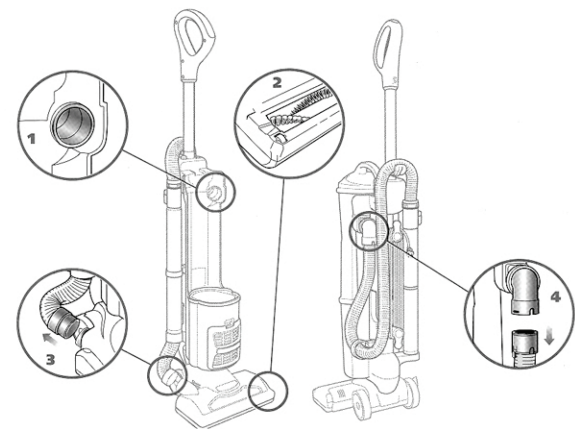

Unplug the vacuum before checking for blockages.

Reassemble all parts securely before operating vacuum.

Blockages may cause your vacuum to overheat and shut down. If so, clear the blockages, then follow the instructions for **Resetting the Motor Thermostat**

- ⚠️ WARNING:** Never insert sharp objects into any opening to clear an obstruction.
- ⚠️ IMPORTANT:** Damages caused while clearing or attempting to clear blockages are not covered under your product's limited warranty.

#### 1 Dust Cup Air Duct:

- Stand vacuum into upright position.
- Remove Dust Cup Assembly and empty Dust Cup if necessary.
- Disconnect the Super Stretch Hose.
- Check Air Duct behind Dust Cup for clogs; clear before replacing Dust Cup Assembly.

#### 2 Intake Opening behind the Brushroll:

- Lay the vacuum flat to expose brushroll.
- Check opening behind the brushroll for clogs.
- Clear the opening.
- Clear the brushroll; use scissors to carefully cut away threads, hair or other debris that might be trapped in the bristles.

#### 3 Floor Power Nozzle Hose Connector:

- Lay vacuum flat.
- Remove Nozzle Hose and check for clogs.
- Push the Hose Connector back onto the Floor Power Nozzle.

#### 4 Hose:

- Stand vacuum upright.
- Remove hose from both the unit and Cleaning Wand ends.
- Inspect both ends and the length of the hose for clogs.
- Return the hose to the unit.

## Troubleshooting

**WARNING:**  
To reduce the risk of electric shock, the power cord must be disconnected before performing maintenance/troubleshooting checks.

PROBLEM	POSSIBLE REASON & SOLUTIONS
<b>Vacuum is not picking up dirt.</b>	Check filters to see if they need cleaning. Follow instructions for rinsing and drying the filters before re-inserting back into the vacuum. (See "Maintenance" sections for instructions.) Dust cup may be full; empty dust cup. Check hose and hose connections for blockages; clear blockages if required. If dust cup is empty, and attachment inlets are clear, check for other blockages. (See "Checking for Blockages" for instructions.)
<b>Vacuum lifts scatter rugs (lightweight, movable rugs).</b>	Suction is powerful. Take care when vacuuming scatter-type rugs or rugs with delicately sewn edges. Open the suction release on the hose to decrease suction power.

## Maintenance

Rotating Brush

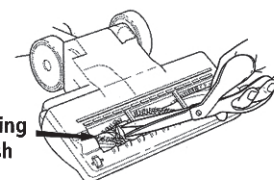

#### Cleaning The Motorized Floor Brush

When your motorized floor brush needs cleaning or locks onto an object, it automatically shuts down to prevent damage to your lifetime belt. The indicator light will illuminate red warning you to turn off the vacuum and clear blockage immediately. The light will reset itself once blockage has been cleared and power has been cycled on/off or vacuum has been locked in the upright position.

- 1 Detach the motorized floor brush from the detachable canister.

- 2 Inspect the opening underneath and the rotating brush. If a build-up of debris is present, remove it. Carefully cut anything wound around the rotating brush with scissors. Avoid damaging or cutting the bristles.

**Resetting the Motor Thermostat**  
Your *Shark® Navigator® DLX* Vacuum is equipped with a protective Motor Thermostat. If the motor should overheat, the thermostat shuts off the power.

**To reset the Motor Thermostat:**  
Move the Power Button to the "O" - Off position.

- Unplug the vacuum.
  - Check for clogged hose or filter; unplug hose and replace filter. Refer to **Checking for Blockages**
  - Wait 45 minutes for vacuum to cool; then plug in the vacuum.
  - Turn the Power Switch to the "I" - On position to start the vacuum.
- Note: If vacuum still does not start, contact a Service Center.

#### TECHNICAL SPECIFICATIONS

Voltage: 120V  
Watts: 1200W  
Amps: 10A  
Hertz: 60Hz

804108253



W

Printed in Mexico  
Sc: 09.11.2018  
Pgs.:TAB  
Obpn:NV70\_NV71\_series\_26\_IB\_E\_160803\_2  
Shnmdl: NV70\_26\_BP\_ELBD:I.A.  
804108253\_upholstery tool\_24.sep.2020  
Re-Desing\_se agrego garantia / 19-01-2022 / j.e.