

BRAUN

MultiServe
Coffee maker

814100120



IMPORTANT SAFEGUARDS

When using electrical appliances, basic safety precautions should always be followed to reduce the risk of fire, electric shock and/or injury to persons, including the following:

READ ALL INSTRUCTIONS.

1. The appliance is not intended for use by persons (including children) with reduced physical, sensory or mental capabilities, or lack of experience and knowledge, unless they have been given supervision or instructions concerning use of the appliance by a person responsible for their safety.
2. Always unplug appliance from outlet when not in use and before cleaning. Allow to cool before putting on or taking off parts and before cleaning the appliance.
3. To protect against the risk of electric shock, do not put cord, plugs or appliances in water or other liquids.
4. The use of attachments/accessories not sold or recommended by Braun may cause fire, electrical shock or risk of injuries to persons.
5. Regularly inspect the power cord, power plug and actual appliance for any damage. Do not operate if damaged in any way or after the appliance malfunctions. Immediately cease use of the appliance and Contact a Service Center.
6. Do not use outdoors or for anything other than its intended purpose.
7. Snap lid securely onto carafe before serving any coffee.
8. Scalding may occur if the reservoir cover is opened during the brewing cycle.
9. The glass carafe is designed for use with this appliance only. It must never be used on a range top or in a microwave oven.
10. Do not set a hot carafe on a wet or cold surface.
11. Do not use cracked carafe or a carafe having a loose or weakened handle.
12. Do not clean carafe or keep warm plate with abrasive cleansers, steel wool pads, or other abrasive materials.
13. Do not immerse in water.
14. Do not touch hot surfaces. Use handles and buttons.
15. Do not let cord hang over edge of table or counter, or touch hot surface.
16. Do not place on or near a hot gas or electric burner, or in a heated oven.
17. Always fill water reservoir first, then plug cord into the wall outlet. To disconnect, press the „On/Off“ button, then remove plug from wall outlet.
18. Warning: Risk of fire or electric shock. Do not remove the base panel. No user serviceable parts are inside. Repair should be done by authorized service personnel only.
19. Do not operate your appliance in an appliance garage or under a wall cabinet. When storing in an appliance garage always unplug the unit from the electrical outlet. Not doing so could create a risk of fire, especially if the appliance touches the walls of the garage or the door touches the unit as it closes.
20. Never open the reservoir cover during the brewing cycle, even if no water is draining from the filter basket, since extremely hot water/coffee can spill out from the filter basket and cause injury. If water/coffee is not draining from the filter basket during the brewing cycle, unplug the unit and wait 10 minutes before opening the top cover and checking the filter basket.
21. We suggest you save all packing materials in the event that future shipping of the machine is needed. Keep all plastic bags away from children.
22. This appliance has a polarized plug (one blade is wider than the other). To reduce the risk of electric shock, this plug will fit in a polarized outlet only one way. If the plug does not fit fully in the outlet, reverse the plug. If it still does not fit, contact a qualified electrician. Do not modify the plug in any way.

SAVE THESE INSTRUCTIONS

FOR HOUSEHOLD USE ONLY

SPECIAL CORD SET INSTRUCTIONS

A short power-supply cord is provided to reduce the risks resulting from becoming entangled in or tripping over a longer cord.

Longer detachable power supply cords or extension cords are not recommended, but may be used if care is exercised. If an extension cord is used:

- (1) the marked electrical rating of the cord set or extension cord should be at least as great as the electrical rating of the appliance,
- (2) the cord should be arranged so that it will not drape over the countertop or tabletop where it can be pulled on by children or tripped over unintentionally

* Both the design specifications and these user instructions are subject to change without notice.

Please do not dispose of the product in the household waste at the end of its useful life. Disposal can take place at appropriate collection points provided in your country.

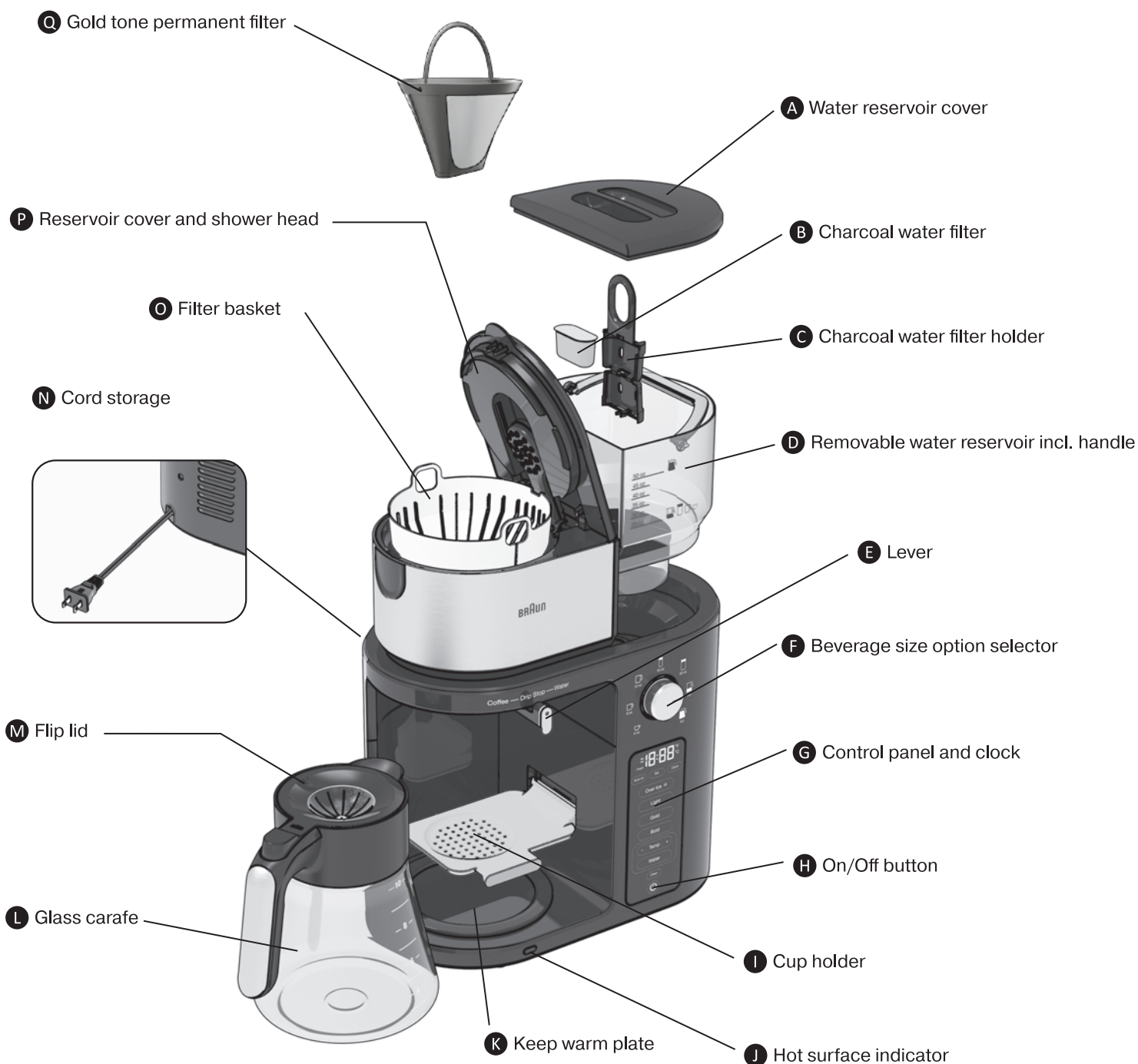

R 2-sided coffee measuring scoop



Note: The image shown here is for illustrative purposes only and may be subject to change. The actual number of accessories may vary depending on the model.

NOTE: In order to ensure the highest possible standard for refurbished items, all units are thoroughly inspected as part of the process. For this item, water may be used during the refurbishing process and so; you may notice some condensation in the water reservoir. It is recommended to rinse the water reservoir with fresh water prior to its first use.

Control Panel

Display shows the following options:

- Time of the day ①
- Temperature (F/C)*
 - Hot water function ②
- Freshness Indicator – Provides an indication of your coffee freshness based on the period of time since brewing started. ③

Functions: ④

Auto on: Use to program the start time of the brew cycle and activate the brew cycle.

Set: Use to program the time of day and auto on.

Clock: Use to set/change time of day.

Over Ice: Use to brew over-ice coffee.

Light/Gold/Bold: Use to select the brew mode and start the brew cycle.

Temp:* Use to select the water temperature (-/+) when heating up water. To change from F to C press + and - at the same time for a few seconds.

Water:* Use to begin the hot water dispensing.

Clean: Descaling indicator and use to activate the descaling process.

On/Off button: Use to switch on/off the unit.

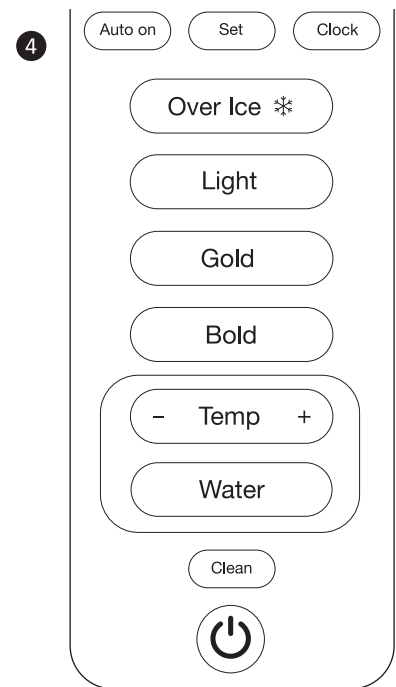
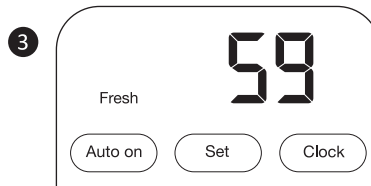
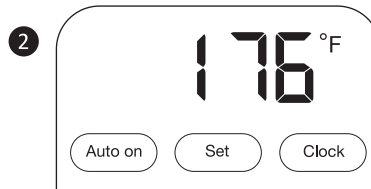

*The image shown here is for illustrative purposes only and may be subject to change. The actual descriptions of control panel and their locations may vary, depending on the model.

Before first use

Please read instructions carefully and completely before using the appliance.

Remove all packaging material and stickers from the appliance.

Switch on the appliance.

Set “time of day”, “water hardness level” and “altitude” (see explanation in dedicated paragraphs hereafter).

During the setting process the information displayed will be saved after 10 seconds.

Run the coffee maker through a complete brew cycle without ground coffee.

Use a full carafe (10 cups) of fresh cold water. This will remove any dust from the manufacturing process or residues that have remained in the unit.

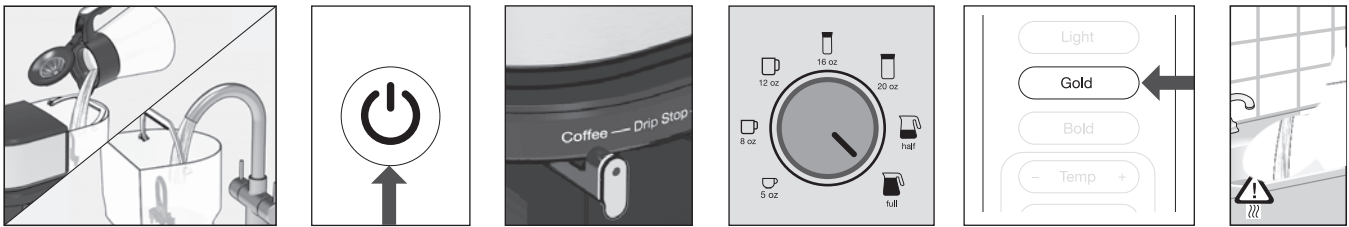

If the H2O error appears remove and replace the water tank and repeat the process.

EN Time of day

When the coffee maker is first plugged in or when power is restored after an interruption, the display starts flashing 2:00 AM and you hear an acoustic signal.

1. Switch on and press and hold CLOCK for 2 seconds.
2. Press and hold SET to scroll through the hours. Release it once the desired hour is displayed.
3. To set the minutes, press CLOCK. The minutes start flashing.
4. Press and hold SET to scroll through the minutes. Release it once the desired minutes are displayed.
5. Press CLOCK again to save the desired time.

NOTE: When the number count passes 12, the PM light will be displayed.

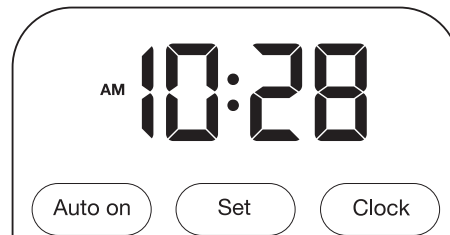

Water hardness level

Set the water hardness level on the coffee maker to the water hardness level for your local area.

1. Switch on the appliance and press and hold CLEAN for 2 seconds.
2. The default setting (h3) is flashing.
3. Press SET to scroll through the options (h1 = soft, h2 = normal, h3 = hard) and select the appropriate water hardness level.
4. Press CLEAN to save the hardness level.

Altitude	0 m – 499 m / 0 ft – 1637 ft	500 m – 999 m / 1638 ft – 3278 ft	1000 m – 1499 m / 3279 ft – 4918 ft	1500 m – 1999 m / 4919 ft – 6558 ft	2000 m > / 6559 ft >
Parameter	A 1	A 2	A 3	A 4	A 5

Altitude setting

To ensure your coffee maker works properly at higher altitudes, enable the altitude setting. This setting avoids that the coffee maker develops steam rather than boiling at the standard boiling temperature (100°C/212°F).

1. Switch on the appliance. Press and hold SET for 2 seconds.
2. The default setting (A 1) is flashing.
3. Press SET to scroll through the following options:
4. Press and hold SET for 2 seconds to save the desired altitude.

Operation Instructions

Installing the Charcoal Water Filter *Not included**

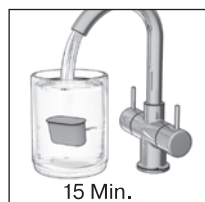
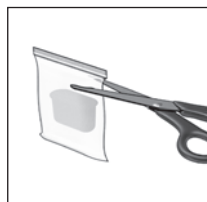

Use of the charcoal water filter is optional, but strongly recommended. The filter eliminates chlorine, bad tastes and odors from tap water. The coffee maker will operate normally without it. Replacement water filters can be purchased in stores, through the Braun website, or by calling Customer Service.

Switching On/Off

- To switch on the coffee maker press the On/Off button (H). The green indicator light will illuminate indicating that the coffee maker is in “ready” mode. Time of the day is displayed.

NOTE: When switching on and the lever is in position “Drip Stop”, the On/Off button starts flashing.

- To switch off the coffee maker, press the On/Off button again. The green indicator light will turn off indicating that the coffee maker is in “stand by” mode. Time of day remains visible.

NOTE: If the On/Off button is pressed and no further function is selected within 60 seconds the coffee maker goes into “stand by” mode. The last selected brewing mode and the LED of the On/Off button disappear. To get out of stand by mode, press the On/Off button.

Programming the Coffee Maker

Before programming, always switch the coffee maker on.

NOTE: The coffee maker features a 60-second power loss back-up system that remembers all programmed information, including time of day and auto on time in the event of a power interruption.

Setting the AUTO ON Time

The AUTO ON time can be set for any time, day or night. “PM” is displayed on the LED for nighttime program times.

1. Place the lever in position “Coffee” or “Drip Stop”.
2. Press AUTO ON for a minimum of 2 seconds.
3. The time of day in the display starts flashing.
4. Press and hold SET to scroll through the hours. Release it once the desired hour is displayed.
5. To set the minutes, press AUTO ON. The minutes in the display starts flashing.
6. Press and hold SET to scroll through the minutes. Release it once the desired minutes is displayed.

7. Press AUTO ON to save the desired time.
8. The set auto on time disappears after a few seconds and the time of day shows on the display.

Activate the AUTO ON Time

This function can only be activated if the AUTO ON time and the time of the day have been set.

- Place the lever (E) in position “Coffee” and select the beverage size (F).
- Place the carafe or your empty cup underneath the brew basket outlet. For smaller cups use the Single-serve cup holder.
- Press AUTO ON and select the desired taste. AUTO ON turns permanently on. The coffee maker will start to brew at the preset auto on time.
- The preset AUTO ON time and the selected taste disappears after a few seconds.
- To switch off the function, press AUTO ON again: AUTO ON will disappear.

NOTE: The AUTO ON function remains activated and is permanently on even when the appliance has been switched off.

Features

Beverage Size Option Selector

The keep warm plate and the freshness indicator are only activated with size options



Hot surface indicator: after the unit is turned off, the light will remain on until the keep warm plate has cooled down.

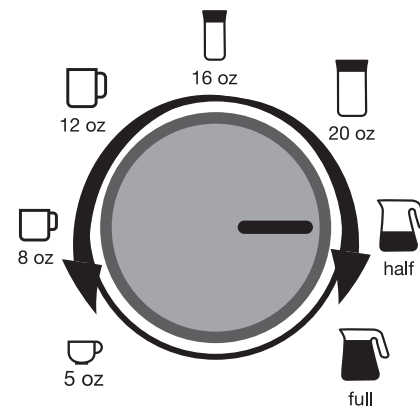

Single-Serve Cup Holder

Pull down the cup holder to brew directly into your favorite cup or mug.

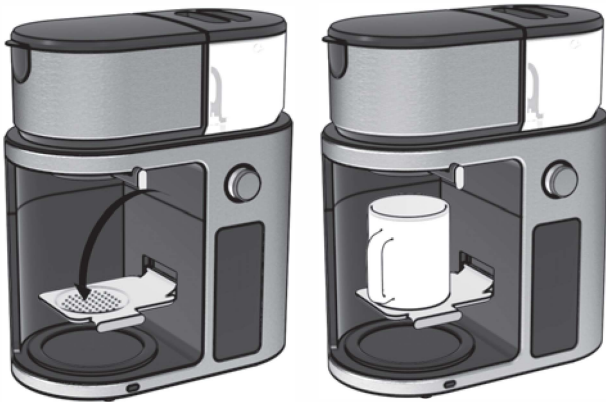

All other steps are described under “Making Coffee”.

Brew modes

Light

Gold

Bold

Light: Brew setting is automatically adjusted so you get a milder cup of coffee.

Gold: This mode has been certified by the SCA (Specialty Coffee Association) to meet their rigorous technical requirements using the black filter basket, a paper filter and water volume of 1.5L (corresponding to the 50 oz. mark in the water tank) with a brew ratio of 55 g of coffee to 1.0L of water (82.5 g of coffee for 1.5 L).



If a brewer passes all of the tests in the certification procedure, as conducted by the SCA, that brewer will be eligible to be recognized as an exemplary home brewer and join the short list of SCA Certified Home Brewers.

The Braun coffee maker has met these SCA requirements when using the “Gold” setting.

Bold: Brew setting is automatically adjusted so you get a stronger cup of coffee.

Making Coffee

1. Fill fresh, cold water in the water reservoir.

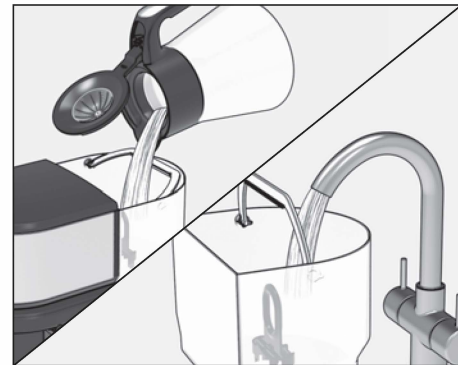

2. Insert the gold tone permanent filter (Q) or a paper filter (cone type # 4) in the filter basket (O). Never use both at the same time
3. Add the desired amount of ground coffee, corresponding to the number of cups being brewed. We recommend using the Braun coffee measuring scoop. Refer to the indications on the Braun coffee measuring scoop (S).
4. Close the water reservoir and place the carafe or your empty cup underneath the filter basket outlet.
5. Press the On/Off button (H).
6. Place the lever (E) in position “Coffee”.



7. Select the beverage size (F).

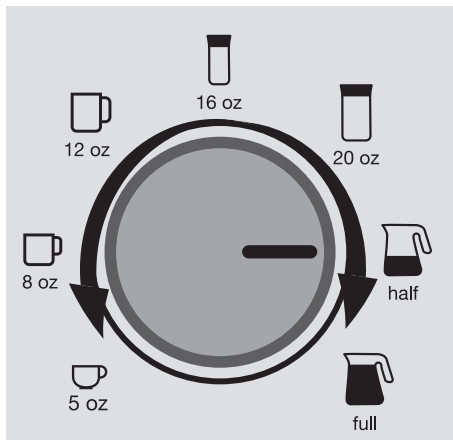

8. Select your brew mode to start the brew cycle. After the brew mode has been selected the brewing process starts immediately.

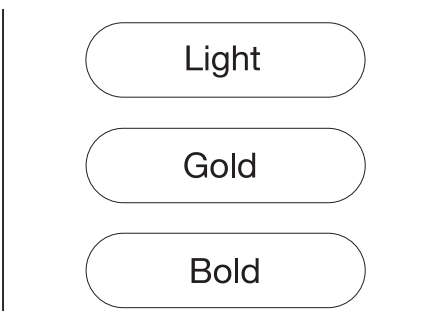

9. During brewing, the On/Off button and the selected brewing mode are illuminated continuously.

10. The unit will beep when the brew is complete.

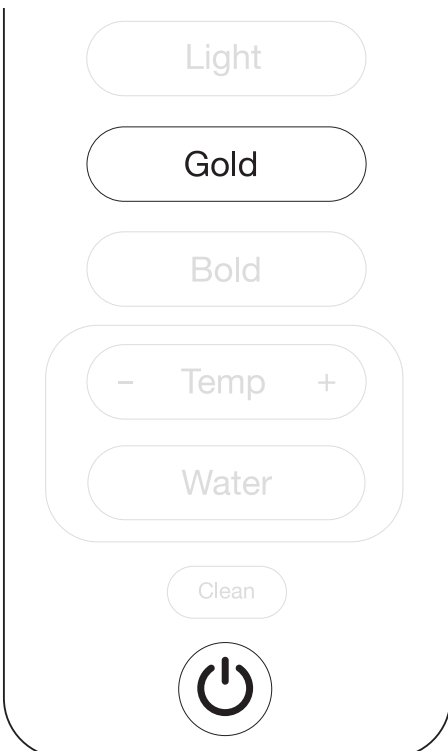

11. Place the lever in position "Drip Stop".



12. If the size options half or full have been selected the coffee maker goes into the keep warm function.

After 4 hours the coffee maker switches off automatically.

To turn off the keep warm plate beforehand, press the on/off button. The On/Off button light will turn off to indicate the coffee maker is off.

Note! Hot surface indicator: after the unit is turned off, the light will remain on until the keep warm plate has cooled down.

Recommended Use of 2-sided coffee measuring scoop

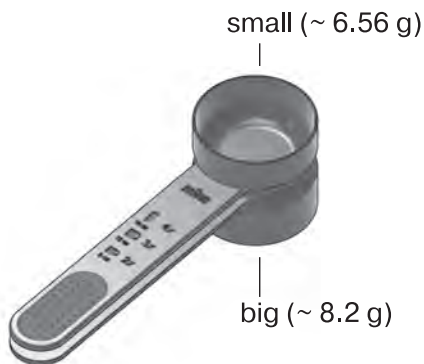

2-sided coffee measuring scoop

For a standard cup of coffee (5oz) our recommendation is to use one small measuring scoop per cup. See table below.

To adjust the strength of the coffee to your personal taste, reduce or increase the quantity of coffee ground used.

To brew a SCA golden cup use the quantities indicated in the dedicated section of the table below.

	5 oz	8 oz	12 oz	16 oz	20 oz	half	full
Braun recommendation	1 small	1 big	2 big	3 big	4 small	5 small	10 small
SCA golden cup	1 big	2 small	3 small	4 small	4 big	5 big	10 big

For Best Results

- When using paper filters, be sure that it is completely open and fully inserted in the basket. It may help to fold and flatten the seams of the paper filter beforehand.
- Once the coffee has finished brewing, stir it before serving to blend the flavors. The coffee at the bottom of the carafe will be somewhat stronger than the coffee at the top.

Brew over – ice coffee

1. Fill fresh, cold water in the water reservoir.
2. Insert the gold tone permanent filter (Q) or a paper filter (cone type # 4) in the filter basket (O). Never use both at the same time
3. Add the desired amount of ground coffee, corresponding to the number of cups being brewed. We recommend using the Braun coffee measuring scoop. Refer to the indications on the Braun coffee measuring scoop (S).
4. Fill your desired carafe/cup up to the top with ice cubes and place it underneath the filter basket outlet.
5. Press the On/Off button (H).
6. Place the lever (E) in position “Coffee”.



7. Select the beverage size (F).

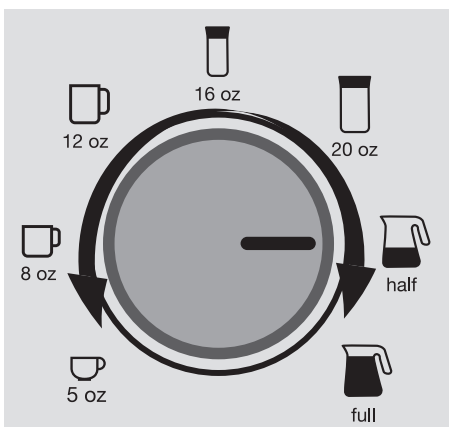

8. Press the “Over Ice” button.

Over Ice ❄️

9. Select the brew mode to start the brewing cycle. It is recommended to use the Bold mode for an intense over-ice coffee.
10. The selected brew mode and the On/Off button (H) are illuminated continuously during the brewing process.
11. The unit will beep when the brew is complete and the selected brew mode and “Over Ice” turn off.
12. Place the lever (E) in position “Drip Stop”.



NOTE: Be sure the cup size fits to the selected beverage size. Never fill ice cubes in the water reservoir. We recommend using the carafe or a thermo-resistant glass.

Pause during brewing process

1. Move the lever (E) to “Drip Stop” position.



2. The brewing process will be paused and the selected brewing mode is flashing.
3. The lever should be moved back to the “Coffee” position within maximum 2 minutes.



4. The brewing process will be continued.

NOTE: If the lever is not moved back to “Coffee” position within 2 minutes, the brewing process is terminated with an acoustic signal. If you pause the brewing process the GOLD/SCA brew mode requirements might not be met.

Dispensing hot water (certain models only)

1. Fill fresh, cold water in the water reservoir.
2. Place the carafe on the keep warm plate or a cup on the cup holder.
3. Press the On/Off button.
4. Place the lever (E) in position “Hot Water”. The buttons “Water” and “Temp” are illuminated. The default temperature is shown in the display.

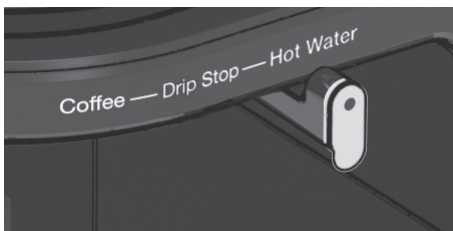

5. Press + or - on the “Temp” button to select the temperature. You can choose one of the 6 pre-set temperatures.

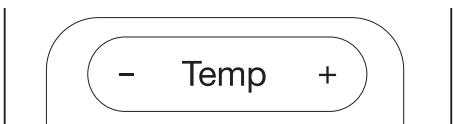

6. Select the beverage size (F).

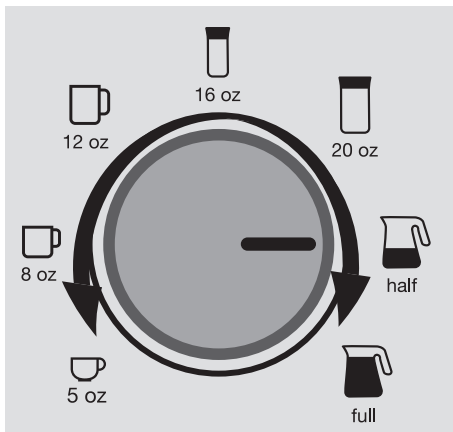

7. Press “Water” to start the dispensing process. The button “Water” and the On/Off button are illuminated.

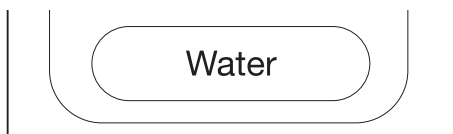

8. If dispensing is completed the process is terminated with an acoustic signal.
9. Place the lever (E) in position “Drip Stop”.

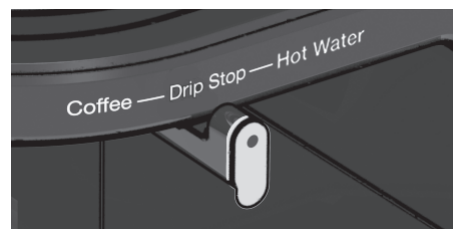

Recommended Temperature Setting Chart

70°C / 158 °F	75°C / 167°F	80°C / 176°F
White tea Thé blanc Té blanco	Green tea Thé vert Té verde	Jasmine tea Thé au jasmin Té de jazmin

Descaling

For the best performance from your Braun coffee maker, descale the unit when the LED CLEAN turns permanently on. This indicates it is time to descale your coffee maker.

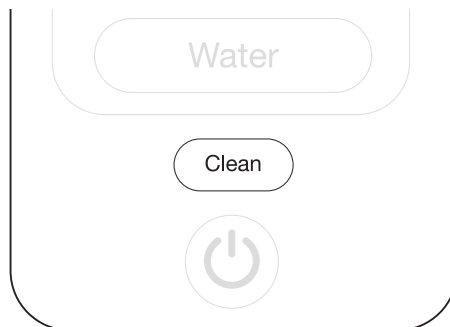

Frequency will depend upon the hardness of your tap water, beverage size and how often you use the coffee maker.

We recommend using the Braun Descaling Solution (can be purchased in stores, through the Braun website, or by calling Customer Service).

1. Press the On/Off button (K).
2. CLEAN turns permanently on.
3. Fill the descaling solution (follow packaging instruction on the descaling agent) in the water reservoir.
4. Remove the gold tone permanent filter (Q) and the charcoal filter(B).
5. Place the empty carafe in its position on the keep warm plate (H).
6. Place the lever in position “Coffee”.



7. Press CLEAN, then press SET to start the descaling process.



CLEAN starts flashing and the countdown timer starting from “23” appears in the display.



Once the descaling process has started, it is not possible to stop the program until finished.

8. When the water reservoir is empty the countdown timer in the display shows “4” and CLEAN turns permanently on.



9. Empty the carafe.
10. Refill the water reservoir with a full carafe (not exceeding 10 cups) of fresh water, place the empty carafe on the keep warm plate and press again CLEAN to start the rinsing cycle. CLEAN will start flashing again.
11. When the descaling program has been completed, the On/Off button and CLEAN turn off.
12. Empty the carafe and rinse it thoroughly with water.

We recommend running the coffee maker through two complete brew cycles to flush the unit after descaling. Use a full carafe of fresh cold water each time.

Cleaning and Maintenance

- Always turn coffee maker off and remove the plug from the electrical outlet before cleaning.
- Lift up the reservoir cover. Remove the gold tone permanent filter and discard the ground coffee.
- Remove the carafe from the keep warm plate and discard any remaining coffee.
- The filter basket, gold tone permanent filter, carafe including lid and the water reservoir including lid can be washed in warm, soapy water and rinsed thoroughly, or cleaned in the upper rack of the dishwasher. Dry all parts after use.
- Do not use any scouring agents or harsh cleansers on any part of the coffee maker.

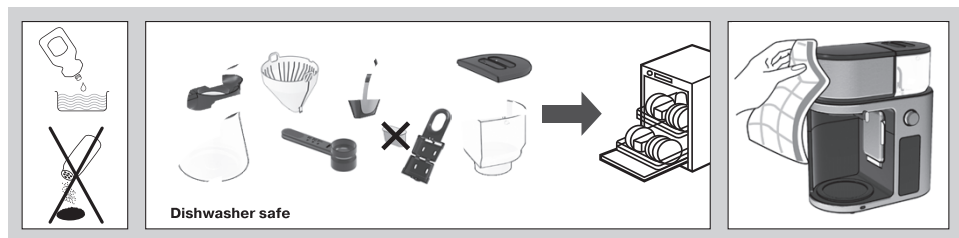

- Never immerse the unit in water or other liquids.
- To clean base, simply wipe with a clean, damp cloth and dry before storing.
- Do not put any water in the unit once the filter basket has been removed. Wipe the area under the filter basket with a damp cloth.
- Fingerprints and other blemishes on the housing can be wiped off with soap and water or a non-abrasive cleaning solution.
- Do not dry the inside of the water reservoir with a cloth, as lint may remain.

Troubleshooting guide

PROBLEM	CAUSE	SOLUTION
Display shows H2O with first use.	If this occurs during first time use.	Repeat the steps described under “Before first use”. If the message remains, replace the water tank and turn the unit off and on to reset the sensor and clear the message. If this does not resolve, contact a Service Center.
Display shows H2O while brewing.	Ensure you have enough water in the tank for the beverage size you have selected.	Ensure the water tank is full or has enough water for the selected drink size. If the message remains, replace the water tank and turn the unit off and on to reset the sensor and clear the message. If this does not resolve, contact a Service Center.
Display shows a number not preceded by “E”.	The unit is in the descaling mode. The unit will remain in this mode until the descaling process has been completed. Note that unplugging the unit will not bypass the descaling process.	Please refer to “Descaling”
Display does not show a time	The appliance is unplugged	Plug unit in
Display flashes “2:00 AM”	<ul style="list-style-type: none"> Initial operation There was a power outage 	Set clock
It is not possible to set the AUTO ON time	<ul style="list-style-type: none"> Lever not positioned in the “Coffee” position Clock has not been set 	<ul style="list-style-type: none"> Position lever in position “Coffee” Set clock time
It is not possible to activate the AUTO ON time	<ul style="list-style-type: none"> AUTO ON time has not been set 	<ul style="list-style-type: none"> Set AUTO ON time
Coffee is not brewing	<ul style="list-style-type: none"> The appliance is unplugged There was a power outage Brew mode was not selected There is no water in the water reservoir The appliance is in stand-by mode AUTO-ON function is not activated Lever is positioned in “Drip Stop” position Water reservoir cover is not closed 	<ul style="list-style-type: none"> Plug unit in Wait for power to be restored Select brew mode to start Pour water into the water reservoir Switch on the appliance Activate AUTO-ON function Place lever in position “Coffee” Close the water reservoir cover
The coffee maker is only brewing water	There are no coffee grounds in the filter basket	Add the desired amount of coffee to the filter
The coffee maker is overflowing	The filter basket is not properly inserted	Insert the filter basket correctly
	Using too much coffee grounds	Remove filter from the filter basket If using a paper filter, replace with new one Restart the coffee brewing process with proper amount of coffee grounds (not exceeding 10 coffee measuring scoops or tablespoons)
	Using coffee that is too finely ground	Use only coffee that is ground for drip coffee makers
	Paper filter and gold tone permanent filter are used together	Use either paper or the gold tone permanent filter, never both at the same time
	The coffee flow through the lid is blocked	Remove the insert from the middle of the lid Rinse the lid properly under running water
The coffee is too bitter	The filter basket spring popped out during cleaning	Reattach the spring to the filter basket
	Using too much coffee ground	Reduce the quantity of coffee ground to one small measuring scoop per cup used for a milder, lighter result, or adjust according to preference.
There are coffee grounds at the bottom of the carafe	The paper filter was not inserted correctly into the filter basket	Rinse filter basket, set filter into the filter basket and restart brewing
	<ul style="list-style-type: none"> Paper filter collapsed Coffee powder is too finely ground 	<ul style="list-style-type: none"> Remove filter, rinse filter basket and restart brewing with a new paper filter Use only coffee that is ground for drip coffee makers
On/Off button is flashing.	The lever is on “Drip Stop”.	Move the lever to “Coffee” or “Hot water” (if available depending the model).
After the brewing process is finished some water remains in the water reservoir.	This is normal. The unit only uses the amount of water according to the chosen beverage size option.	
Display shows “Lid”	Lid of the water reservoir is open	Close the lid

Displayshows E02, E18		Removethe carafe. Unplug the appliance, wait for 5 minutes and plug in again. Perform a decalcification. If the error persistscontact a service center.
Displayshows E12		Removethe carafe. Unplug the appliance, wait for 5 minutes, plug in again and retry. If the error occursagain contact a Service Center.

REFURBISHED PRODUCT LIMITED THIRTY DAY WARRANTY

The **Refurbished Product Service Center** offers the following WARRANTY to the ORIGINAL purchaser of a product which we have refurbished.

This product that has been refurbished is warranted against any electronic or mechanical defects for a period of THIRTY DAYS from the date of the original purchase by the consumer. Since this unit was sold as a refurbished item, the warranty does not apply to any cosmetic appearance items such as scratches. Should a defect occur, the **Refurbished Product Service Center** will repair or, at its option, replace defective unit/parts with new or rebuilt materials without charge for either parts or labor. Replacement unit/parts will be warranted for the remaining portion of the original warranty period.

This warranty does not cover installation or damage from accident, misuse, abuse, improper wiring, incorrect voltage, operating the unit against the instructions in the owner's manual or any product which has been opened, altered, or tampered with.

This warranty does not cover costs for removal and or installation of the unit for repair. Under no circumstances shall the service center be liable for any special, incidental or consequential damages or for any other expenses incurred by reason of use or sale of this product. This warranty is in lieu of any other warranties expressed or implied warranty of merchantability of fitness for particular use or otherwise.

This warranty gives the consumer specific legal rights and they may also have other rights which vary from State to State. Some States do not follow the exclusion or limitation of incidental or consequential damages, hence the above exclusion and limitations may not apply.

Refurbished Product Service Center
13225 Marquardt Avenue Santa Fe Springs, CA 90670

WARRANTY REPAIR INFORMATION

If you need service on your unit during the 30 day warranty period; please go to www.ConsumerServiceRefurbish.com or call the Refurbished Product Service Center at 562-946-3531 to obtain the required claim number. Once you obtain your claim number, pack the unit properly (the original carton is ideal for this purpose) along with a copy of your purchase receipt.

Send the unit freight prepaid and insured to:

Refurbished Product Service Center,
Att: Customer Service Department 13225 Marquardt Avenue Santa Fe Springs, CA 90670

Your unit will be promptly exchanged and returned to you.
We will refuse to accept delivery of the returned unit unless the assigned claim number appears on the outside of the shipping carton.

Owner's Information
(Keep for your permanent records)

NAME: _____

ADDRESS: _____

CITY: _____ STATE: _____ ZIP CODE: _____

PHONE: _____ E-MAIL: _____

MODEL: _____ SERIAL NO.: _____

PRINTED IN MEXICO
Elbrd: A.M SC: 10-25-2023
MODEL:KF9150BK OBPN: N/A



8 1 4 1 0 0 1 2 0



Quick Start Guide

The images shown here are for illustrative purposes only and may be subject to change.

BEFORE FIRST USE

Run the coffee maker through a complete brew cycle without ground coffee. Use a full carafe (10 cups) of fresh cold water.

1. INSTALLING THE CHARCOAL WATER FILTER



2. SETTING THE CLOCK

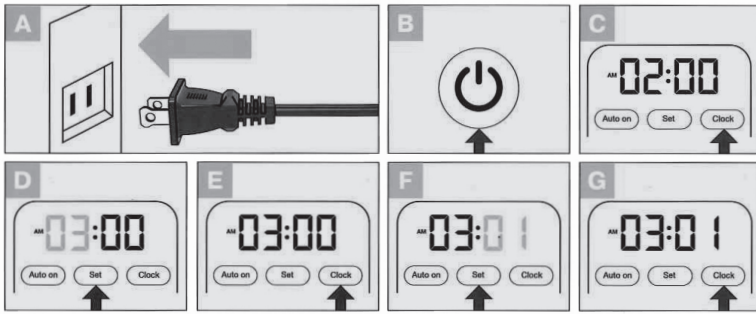

3. MAKING COFFEE

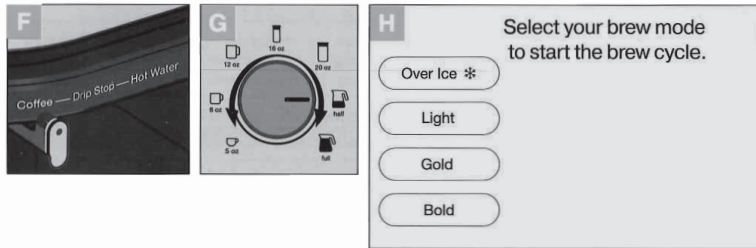
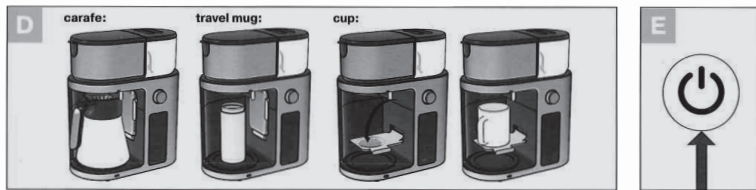
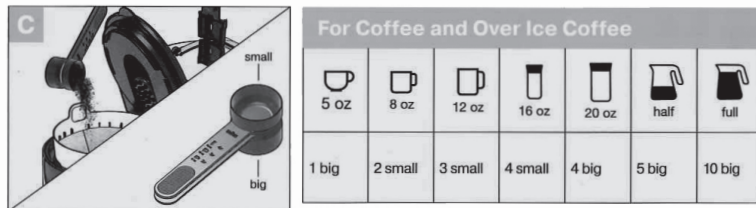
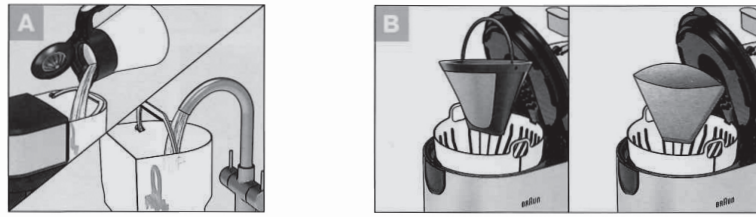

EN To brew Over Ice coffee, fill your cup or carafe up to the top with ice cubes, then first select „Over Ice“, then select the bold brew mode.

EN Hot surface indicator: after the unit is turned off, the light will remain on until the keep warm plate has cooled down.

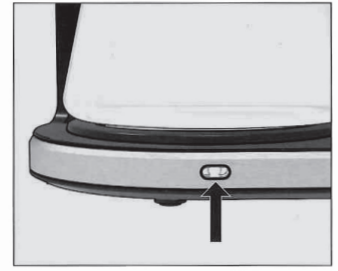

3.1 SETTING THE AUTO ON TIME

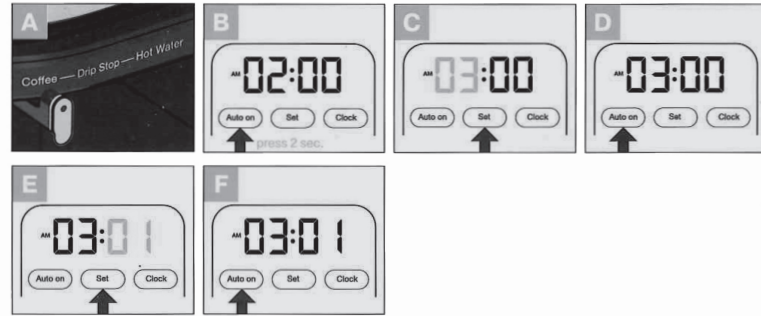

3.2 MAKING COFFEE WITH AUTO ON



4. DISPENSING WATER (certain models only)

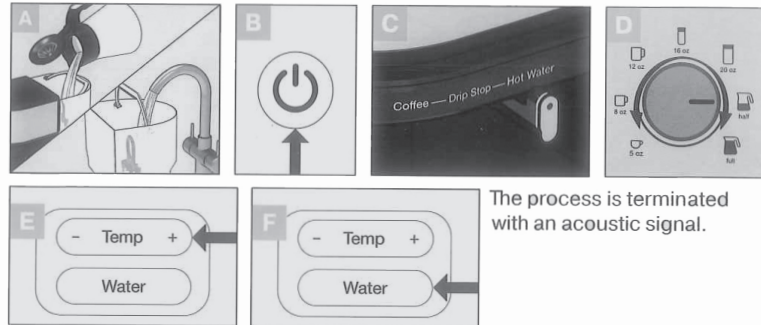

Recommended Temperature Setting Chart

This is for guidance only and temperatures can be selected for personal preference.

70°C 158°F	75°C 167°F	80°C 176°F	85°C 185°F	90°C 194°F	95°C 203°F
White tea	Green tea	Jasmine tea	Oolong tea	Instant-tea	Herbal teas and infusions

5. CLEANING

