

**DeLonghi**

PORTABLE AIR CONDITIONER

Please read this manual before using the unit for the first time.

**Specific warnings for appliances with R410A refrigerant gas**

R410A refrigerant gas conforms to EC regulations on the environment.

Avoid perforating the refrigerant circuit of the appliance.

**ENVIRONMENTAL INFORMATION:**

This unit contains fluorinated greenhouse gases covered by the Kyoto Protocol.

Maintenance and disposal must be carried out by qualified personnel only (R410A, GWP=1975).

Illustrations may differ from actual product. We are constantly striving to improve our products; therefore the specifications contained herein are subject to change without notice

804108678A

**USE**

**AIR CONDITIONING WITHOUT INSTALLATION**

For optimal results set-up in a double-hung window:

- 1) Place the bracket in the window sill, extend the bracket fully within the window frame, fix the bracket by using the pin then lower the window onto the bracket. (Should the window bracket be too large for the window. The plastic can be cut with a saw by a qualified professional.)
- 2) Fit the air exhaust hose in the housing at the back of the appliance. Insert it as shown in figure 1.

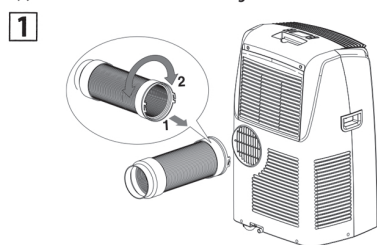

- 3) Connect the window outlet to the other end of the exhaust hose.
- 4) Insert the window outlet end of the exhaust hose into the slot of the window bracket (fig. 2).



**Other set-up methods:**

- Thanks to the locking pins, it's possible to use the window bracket also for sliding windows. Position the hole of the bracket so to allow a correct installation of the exhaust hose (see figure 3).

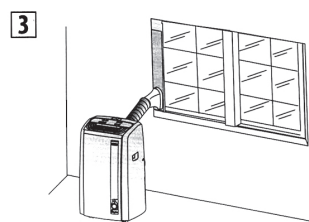

- If you have a casement window (figure 4) follow steps 2 & 3 and place the window outlet outside the window to exhaust the hot air.

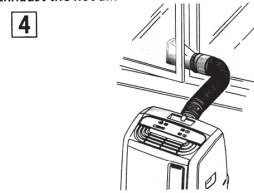

- If the windows are large, use the additional window bracket (if provided) to cover your window aperture, extending it to the required length, then blocking it with the locking pins supplied (see figure 5). Make sure you do not cover the hole for the window outlet.

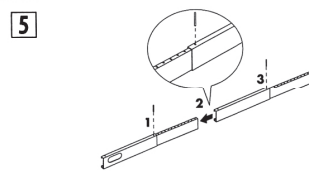

**FOAM STRIPPING INSTRUCTIONS**

1. Extend the window bracket to the desired width.

2. Remove the protection from the Tape and apply it to the window bracket as shown in figure.



**DESCRIPTION**

**Description of the appliance (fig. A)**

- A1 air outlet grille
- A2 control panel
- A3 handles
- A4 castor wheels
- A5 BioSilver filter
- A6 air intake grille
- A7 air exhaust hose housing
- A8 air intake grille
- A9 power cable
- A10 drainage hose with cap
- A11 remote control signal receiver
- A12 remote control compartment

**Descrizione of the accessories (fig. B)**

- B1 air exhaust hose
- B1a hose adapter to unit
- B1b hose adapter
- B2 window outlet
- B3 window bracket with pins
- B4 additional window bracket with pins
- B5 remote control

**Electrical connection**

Before plugging the appliance into the electrical receptacle, check that:

- The outlet's power supply corresponds to the value indicated on the rating label on the back of the appliance;
- The outlet and electrical circuit are adequate for the appliance;
- The outlet is a 3-hole grounded outlet (⏏). If this is not the case, you must choose another outlet. Failure to follow these important safety instructions absolves the manufacturer of all liability.

**If it becomes necessary, the power cable must be replaced by a qualified professional only.**

The instructions below will enable you to prepare your air conditioner for operation as efficiently as possible. Before use, make sure the air intake and outlet grilles are unobstructed.

**CONTROL PANEL**

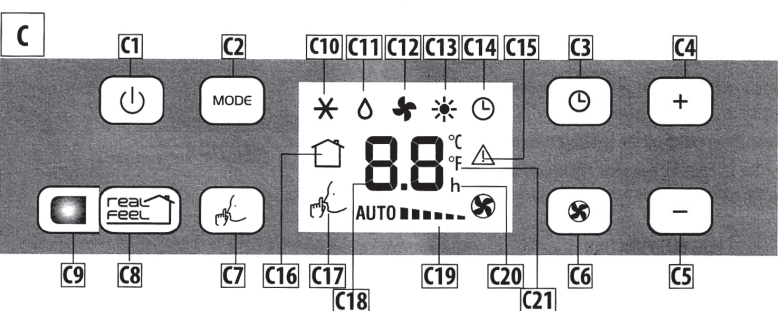

**DESCRIPTION OF THE CONTROL PANEL (fig. C)**

- C1 ON/STAND-BY button
- C2 MODE selection button (conditioning, dehumidifying, fan, heating)
- C3 Timer button
- C4 Increase temperature/programmed operation time button
- C5 Decrease temperature/programmed operation time button
- C6 Fan speed selection button (LOW/MED/HIGH/AUTO)
- C7 WHISPER COOL selection button
- C8 REAL FEEL selection button
- C9 REAL FEEL light
- C10 Air-conditioning symbol
- C11 Dehumidifying symbol
- C12 Fan symbol
- C13 Heating symbol
- C14 Timer symbol
- C15 Alarm symbol
- C16 REAL FEEL symbol
- C17 WHISPER COOL symbol
- C18 Temperature value set, programmed delayed ON/OFF time
- C19 Fan speed indicator
- C20 Timer indicator
- C21 Temperature selected scale indicator

**Note:** The panel buttons are backlit but only the buttons relevant to the active function will be on. After few seconds of the control panel inactivity, its brightness will be automatically reduced and in the next few minutes it will be further reduced.

\*The descriptions of control panel and their locations may vary, depending on the model.

**OPERATING FROM THE CONTROL PANEL**

**TURNING THE APPLIANCE ON/OFF**



Before plugging the appliance check the cap on back of the unit are correctly inserted on drainage hose A10

Plug the appliance into the electrical receptacle. Two lines appear on the display indicating that the appliance is in stand-by and the buttons (C) and (C) light on.

Press (C) button (C1) to switch the appliance on.

When turned on, the air conditioner starts operating in the same mode as when it was turned off.

**Note:** If you don't switch on the appliance, after a few minutes, the (C) and (C) buttons switch off and the display fades to reduce energy consumption.

To turn off the appliance, press the (C) button, then unplug the appliance.

**Note:** Never switch off the appliance by unplugging it: always use the (C) button, wait a few minutes and then unplug. Doing so, the appliance will run a check of the operating conditions.

**REAL FEEL FUNCTION**



REAL FEEL is the innovative De'Longhi technology that works simultaneously on temperature reduction and humidity control, securing best comfort level.

With traditional systems, during working time, optimal comfort conditions may be reached but not secured over time. With REAL FEEL, once optimal comfort is reached, PAC automatically modulates compressor action and fan speed, to keep it over time.

To activate the function, press (C) button.

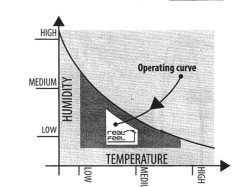

REAL FEEL light (C9) changes color when approaching the best comfort level (see following diagram).



- The well-being feeling is a subjective condition: for this reason, different people may judge differently the same environmental conditions.
- In particularly severe environmental conditions (large size of the environment, high temperature or humidity outside, poor insulation of the room, too many of people or strong heat load in the room, strong exposure to the sun ...) this device may not be able to reach the best comfort level.

**\* AIR CONDITIONING MODE**



Ideal for hot muggy weather when you need to cool and dehumidify the room. To set this mode:

- Press repeatedly the MODE button until the conditioning symbol is displayed: the display shows the desired temperature.
- Press + (C4) or - (C5) buttons to adjust the desired temperature.
- Select the fan speed by pressing the (C6) button (C6).

You can choose:

- **Minimum speed:** for silent operation.
- **Medium speed:** reduces noise levels while maintaining a comfortable temperature.
- **Maximum speed:** to achieve the target temperature as rapidly as possible.

**AUTO** the appliance automatically selects the most suitable fan speed in relation to the temperature set on the digital display and current room temperature.

The most suitable indoor temperature for the room during the summer varies from 75°F to 81°F (24 to 27°C). You are recommended, however, not to set a temperature much below the outdoor temperature.

**WHISPER COOL (available in conditioning mode only)**



By activating this function, the operating noise is further reduced. To activate it, press the (C7) button. The display shows the relative symbol (C17).

**DEHUMIDIFYING MODE**



Ideal to reduce room humidity (spring and autumn, damp rooms, rainy periods, etc). In dehumidifying mode, the appliance MUST be set-up in the same way as for air conditioning, with the air exhaust hose attached to enable the moisture to be discharged outside. To set this mode:

- Press repeatedly the MODE button until the dehumidifying symbol is displayed.

**FAN MODE**



When using the appliance in this mode, the air exhaust hose does not need to be connected.

To set this mode:

- Press repeatedly the MODE button until the fan symbol is displayed.

- Select the fan speed by pressing the (C6) button (C6). You can choose:
  - **Minimum speed:** for silent operation.
  - **Medium speed:** reduces noise levels but still maintains a good fan power.
  - **Maximum speed:** for maximum fan power.

**IMPORTANT SAFEGUARDS**

- Use this appliance only as described in this instruction manual.
- As with any electrical appliance, the instructions aim to cover as many situations as possible. Caution and common sense should be used when operating and installing this air conditioner.
- This appliance has been manufactured to cool and dehumidify domestic environments and must not be used for other purposes.
- It is dangerous to alter or modify the unit's characteristics in any way.
- The appliance must be installed in accordance with the relevant national legislation.
- Should repairs be necessary, contact a Service Center. Unauthorized servicing can be dangerous.
- The appliance is not intended for use by persons (including children) with reduced physical, sensory or mental capabilities, or lack of experience and knowledge, unless they have been given supervision or instruction concerning use of the appliance by a person responsible for their safety. Children should be supervised to ensure that they do not play with the appliance.
- In the case that the power cord becomes damaged, this must be repaired only by specialized personnel authorized by the manufacturer in order to protect against fire.
- Always ensure the appliance is plugged into a grounded 3-prong outlet. If you have any doubts check with a qualified electrician.
- We strongly discourage the use of an extension cord due to potential safety hazards.
- Before cleaning or maintenance operations, always unplug the unit from the outlet.
- Do not pull on or place strain on the power cord when moving the appliance.
- The appliance should not be installed where the atmosphere may contain combustible gases, oil or sulphur, or near heat sources.
- Do not rest hot or heavy objects on the appliance.
- Clean the filters at least once a week.
- Avoid using heaters near the unit.
- The unit should be transported in a vertical position. If this is not possible secure the unit at an angle, do not lie it horizontally.
- Before transporting the unit, drain the unit. After transportation, wait at least 6 hours before switching the unit on.
- The packaging materials can be recycled. You are therefore recommended to place them in the special containers for differentiated waste collection.
- This appliance is fitted with a special safety device. When the compressor switches off, this device prevents it from switching on again for at least 3 minutes.
- **WARNING:** Changes or modifications not expressly approved by the party responsible for compliance could void the user's authority to operate the equipment.

**SAVE THESE INSTRUCTIONS**

THIS PRODUCT IS FOR HOUSEHOLD ONLY

