

Step 2. Check the Soundbar's status

The blue LED should not be blinking once the Bluetooth connection is complete.



NOTES

- If asked for a PIN code when connecting a Bluetooth device, enter <code>0000</code>.
- The Soundbar automatically turns off after 18 minutes in the Ready state.
- The Soundbar may not perform Bluetooth search or connection correctly under the following circumstances:
 - If there is a strong electrical field around the Soundbar.
 - If several Bluetooth devices are simultaneously paired with the Soundbar.
 - If the Bluetooth device is turned off, not in place, or malfunctions.
- Electronic devices may cause radio interference. Devices that generate electromagnetic waves must be kept away from the Soundbar main unit - e.g., microwaves, wireless LAN devices, etc.

06 CONNECTING AN EXTERNAL DEVICE

Connect to an external device via an optical cable or analog cable to play the external device's sound through the Soundbar.

Connecting using an Optical Cable

Step 1. Connect using an Optical Cable

BD / DVD player / Set-top box / Game console

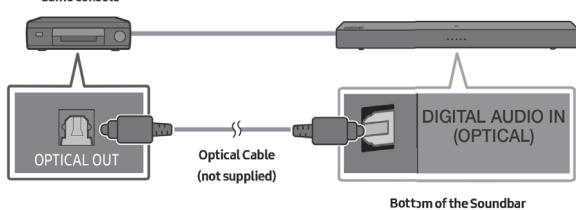

Step 2. Change the Soundbar's mode to D.IN

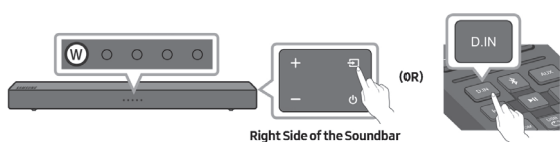

Connecting using an Analog Audio (AUX) Cable

Step 1. Connect using an Analog Audio (AUX) Cable

BD / DVD player / Set-top box / Game console

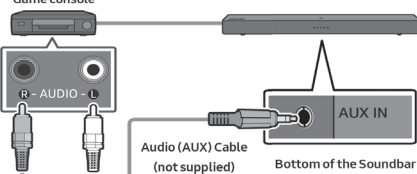

Step 2. Change the Soundbar's mode to AUX

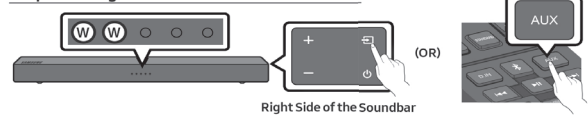

07 CONNECTING A USB STORAGE DEVICE

Step 1. Connect a USB Drive

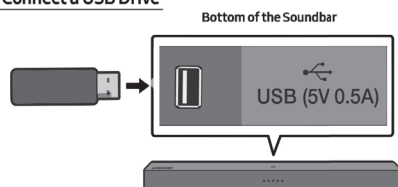

NOTE

- The Soundbar automatically turns off (Auto Power Off) if you do not connect a USB device to the Soundbar within 18 minutes.

Step 2. Change the Soundbar's mode to USB

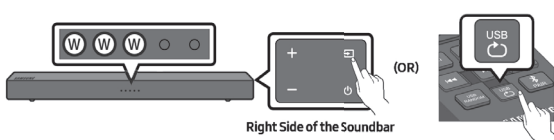

Setting Repeat Play Options

Repeat play

When the Soundbar is in "USB" mode, each time you press the button the "USB" mode changes how it plays tracks in the following order: "Repeat - Off" > "Repeat - 1 song" > "Repeat - All songs". See the table below for details.

| Mode | Remote control Button | LED Indicator |
|--------------------|-----------------------|---------------|
| Repeat - Off | | |
| Repeat - 1 song | | |
| Repeat - All songs | | |

Repeat play at Random

When the Soundbar is in "USB" mode, once you press the button, the "USB" mode changes how it plays tracks to "Repeat - Random". See the table below for details.

| Mode | Remote control Button | LED Indicator |
|-----------------|-----------------------|---------------|
| Repeat - Random | | |

Software Update

Samsung may offer updates for the Soundbar's system firmware in the future.

If an update is offered, you can update the firmware by connecting a USB device with the firmware update store on it to the USB port on your soundbar. For more information about how to download update files, go to the Samsung Electronics website at (www.samsung.com - support).

Then, enter or select the model number of your Soundbar, select the Software & Apps option, and then Downloads. Note that the option names can vary.

08 SYSTEM INITIALIZE

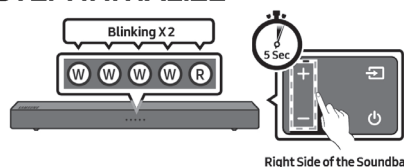

With the Soundbar on, press the **+ (Volume)** buttons on the body at the same time for at least 5 seconds.

CAUTION

- All the settings of the Soundbar are initialized. Be sure to perform this only when initialization is required.

09 INSTALLING THE WALL MOUNT (Wall mount kit not supplied)

Installation Precautions

- Install on a vertical wall only.
- Do not install in a place with high temperature or humidity.
- Verify whether the wall is strong enough to support the product's weight. If not, reinforce the wall or choose another installation point.
- Purchase and use the fixing screws or anchors appropriate for the kind of wall you have (plaster board, iron board, wood, etc.). If possible, fix the support screws into wall studs.
- Purchase wall mounting screws according to the type and thickness of the wall you want to mount the Soundbar on.
 - Diameter: M4
 - Length: 1.6 inches or longer recommended.
- Connect cables from the unit to external devices before you install the Soundbar on the wall.
- Make sure the unit is turned off and unplugged before you install it. Otherwise, it may cause an electric shock.

Wall mount Components

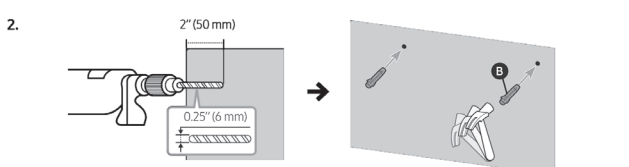
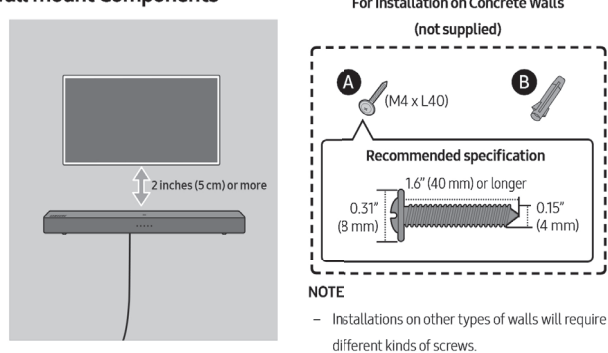

IMPORTANT NOTE

- The installation method shown here is for CONCRETE walls. Installation methods will vary depending on the wall type. For installation on dry wall, we strongly recommend you drill screw support holes into the underlying wood studs.

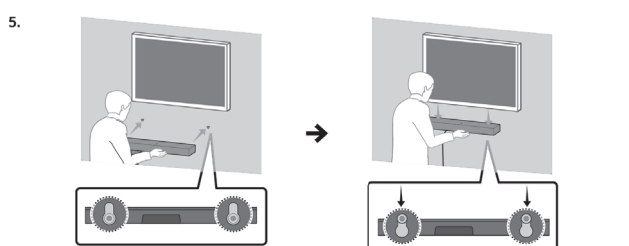
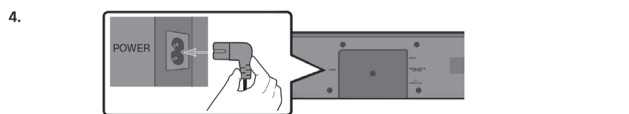
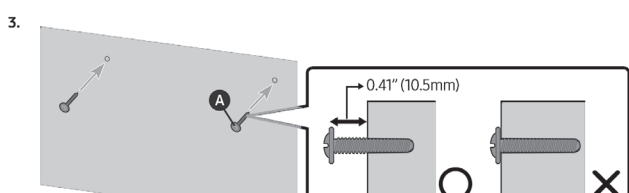

NOTE

- Supports for wall installation are built into the back of the Soundbar.

CAUTION

- Press the Soundbar down with sufficient force to fix it to the wall. If the Soundbar is not firmly fixed to the wall, it could be accidentally detached, resulting in personal injury.
- Do not bump into or strike the Soundbar (especially from the bottom). The impact could detach the Soundbar from the wall, resulting in personal injury.

The cables mentioned in this guide is not supplied with your unit.

Note: The image shown here is for illustrative purposes only and may be subject to change. The actual number of ports and their locations may vary depending on the model.

10 TROUBLESHOOTING

Refer to the table below if this product does not function properly. If the problem you are experiencing is not listed below or if the instructions below do not help, turn off the product, disconnect the power cord, and contact a service center.

| |
|--|
| The unit will not turn on. |
| Is the power cord firmly plugged into the wall outlet? |
| → Unplug and reconnect the power cord to the wall outlet to make sure the connection is secure. |
| A function does not work when the button is pressed. |
| Is there static electricity in the air? |
| → Disconnect the power plug and connect it again. |
| Sound dropouts occur in Bluetooth mode. |
| → See the Bluetooth connection sections. |
| → In Bluetooth connection mode, the Bluetooth connection will be lost if the distance between the Soundbar and the Bluetooth device exceeds 32.8 ft (10m). |
| Sound is not produced. |
| Is the Mute function on? |
| → Press the VOL button to cancel the function. |
| Is the volume set to minimum? |
| → Adjust the Volume. |
| The remote control does not work. |
| Is the battery drained? |
| → Replace with new batteries. |
| Is the distance between the remote control and Soundbar main unit too far? |
| → Move the remote control closer to the Soundbar main unit. |

11 LICENSE



Manufactured under license from Dolby Laboratories. Dolby, Dolby Audio, and the double-D symbol are trademarks of Dolby Laboratories.



For DTS patents, see <http://patents.dts.com>. Manufactured under license from DTS Licensing Limited. DTS, the Symbol, DTS in combination with the Symbol, and DTS 2.0 Channel are registered trademarks or trademarks of DTS, Inc. in the United States and/or other countries. © DTS, Inc. All Rights Reserved.



The Bluetooth® word mark and logos are registered trademarks owned by the Bluetooth SIG, Inc. and any use of such marks by Samsung Electronics Co., Ltd. is under license. Other trademarks and trade names are those of their respective owners.

12 OPEN SOURCE LICENSE NOTICE

To send inquiries and requests regarding open sources, contact Samsung via Email (oss.request@samsung.com).

13 IMPORTANT NOTES ABOUT SERVICE

- Figures and illustrations in this User Manual are provided for reference only and may differ from actual product appearance.
- An administration fee may be charged if either:
 - a. An engineer is called out to your home at your request and there is no defect in the product.
 - b. You bring the unit to a repair center and there is no defect in the product.
- You will be advised of the amount of the administration fee before any work is done or a home visit is made.
- If you have a problem with this product, we strongly recommend you read the appropriate section of this manual, contact a service center.

14 SPECIFICATIONS AND GUIDE

Specifications

| | |
|---|---|
| Model Name | HW-T400 |
| USB | 5V/0.5A |
| Weight | 4.4 lbs (2.0 kg) |
| Dimensions (W x H x D) | 25.2 x 2.6 x 4.2 inches (641.0 x 65.0 x 107.0 mm) |
| Operating Temperature Range | +41°F to +95°F (+5°C to +35°C) |
| Operating Humidity Range | 10% - 75% |
| Supported play formats (DTS 2.0 sound is played in DTS format.) | LPCM 2ch, Dolby Audio™ (supporting Dolby® Digital), DTS |

NOTES

- Samsung Electronics Co., Ltd reserves the right to change the specifications without notice.
- Weight and dimensions are approximate.

REFURBISHED PRODUCT LIMITED THIRTY DAY WARRANTY

The **Refurbished Product Service Center** offers the following WARRANTY to the ORIGINAL purchaser of a product which we have refurbished.

This product that has been refurbished is warranted against any electronic or mechanical defects for a period of THIRTY DAYS from the date of the original purchase by the consumer. Since this unit was sold as a refurbished item, the warranty does not apply to any cosmetic appearance items such as scratches. Should a defect occur, the **Refurbished Product Service Center** will repair or, at its option, replace defective unit/parts with new or rebuilt materials without charge for either parts or labor. Replacement unit/parts will be warranted for the remaining portion of the original warranty period.

This warranty does not cover installation or damage from accident, misuse, abuse, improper wiring, incorrect voltage, operating the unit against the instructions in the owner's manual or any product which has been opened, altered, or tampered with.

This warranty does not cover costs for removal and/or installation of the unit for repair. Under no circumstances shall the service center be liable for any special, incidental or consequential damages or for any other expenses incurred by reason of use or sale of this product. This warranty is in lieu of any other warranties expressed or implied warranty of merchantability of fitness for particular use or otherwise.

This warranty gives the consumer specific legal rights and they may also have other rights which vary from State to State. Some States do not follow the exclusion or limitation of incidental or consequential damages, hence the above exclusion and limitations may not apply.

Refurbished Product Service Center
13225 Marquardt Avenue Santa Fe Springs, CA 90670

WARRANTY REPAIR INFORMATION

If you need service on your unit during the 30 day warranty period; please go to www.ConsumerServiceRefurbish.com or call the Refurbished Product Service Center at 562-946-3531 to obtain the required claim number. Once you obtain your claim number, pack the unit properly (the original carton is ideal for this purpose) along with a copy of your purchase receipt. Send the unit freight prepaid and insured to:

Refurbished Product Service Center,
Att: Customer Service Department 13225 Marquardt Avenue Santa Fe Springs, CA 90670

Your unit will be promptly exchanged and returned to you. We will refuse to accept delivery of the returned unit unless the assigned claim number appears on the outside of the shipping carton.

Owner's Information
(Keep for your permanent records)

NAME: _____
ADDRESS: _____
CITY: _____ STATE: _____ ZIP CODE: _____
PHONE: _____ E-MAIL: _____
MODEL: _____ SERIAL NO.: _____

804106556



PRINTED IN MEXICO / SC. 06-09-2021
OBPN: 72-T400ZA-MANB1-SS / TAB
SHNMDL: HWT400_B / Elbrd:J.E.

