

Shark VACMOP™ PRO

Cordless Hard Floor System

OWNER'S GUIDE

It's important to read this manual prior to using your new product for the first time.



804109925A

IMPORTANT SAFETY INSTRUCTIONS

PLEASE READ ALL INSTRUCTIONS BEFORE USING THIS PRODUCT.

If the charging cord plug does not fit fully into the outlet, reverse the plug. If it still does not fit, contact a qualified electrician. DO NOT force into outlet or try to modify to fit.

WARNING

To reduce the risk of fire, electric shock, injury, or property damage:

When using an electrical appliance, basic precautions should always be followed, including the following:

THIS PRODUCT CONTAINS ELECTRICAL CONNECTIONS:

- Use only as described in this manual. **DO NOT** use the VACMOP™ for any purpose other than those described in this manual.
- These components contain electrical connections, electrical wiring, and moving parts that potentially present risk to the user.
- Before each use, carefully inspect all parts for any damage. If a part is damaged, discontinue use.
- Use only identical replacement parts.
- This VACMOP contains no serviceable parts.
- DO NOT** immerse or spray water on the body of the VACMOP. To clean the surface, wipe with a dry cloth.
- Keep the appliance and its charging cord out of reach of children. **DO NOT** allow the appliance to be used by children. Do not allow to be used as a toy. Close supervision is necessary when used near children.

GENERAL USE

- This appliance can be used by persons with reduced physical, sensory or mental capabilities or lack of experience and knowledge if they have been given supervision or instruction concerning use of the appliance in a safe way and understand the hazards involved. Cleaning and user maintenance shall not be made by children. Always turn off the VACMOP before connecting or disconnecting any current carrying hoses, chargers, batteries, or other electrical or mechanical parts.
- DO NOT** handle plug or VACMOP with wet hands.
- DO NOT** use without VACMOP disposable pad attached.
- Only use Shark® branded VACMOP disposable pads.
- DO NOT** put any objects into VACMOP base. **DO NOT** use with any opening blocked; keep free of dust, lint, hair, and anything that may reduce airflow.
- DO NOT** use if VACMOP base airflow is restricted. If the air paths or the VACMOP base become blocked, turn the VACMOP off. Remove all obstructions before you turn on the unit again.
- Keep all VACMOP base openings away from hair, face, fingers, uncovered feet, or loose clothing.
- DO NOT** use if VACMOP is not working as it should, or has been dropped, damaged, left outdoors, or dropped into water.
- Use extra care when cleaning on stairs.
- DO NOT** place VACMOP on unstable surfaces such as chairs or tables.
- DO NOT** use to pick up:
 - Large quantities of dust (including drywall, fireplace ash, or embers).
 - Smoking or burning objects (hot coals, cigarette butts, or matches)
 - Flammable or combustible materials (lighter fluid, gasoline, or kerosene)
 - Toxic materials (chlorine bleach, ammonia, or drain cleaner)

- DO NOT** use in the following areas:
 - Poorly lit areas
 - Outdoor areas
 - Spaces that are enclosed and may contain explosive or toxic fumes or vapors (lighter fluid, gasoline, kerosene, paint, paint thinners, mothproofing substances, or flammable dust)
- Release all operational triggers on the VACMOP before plugging in or unplugging the charger.
- Release all operational triggers on the VACMOP before any adjustment, cleaning, maintenance or troubleshooting.
- DO NOT** modify or attempt to repair the VACMOP or the battery yourself, except as indicated in this manual. **DO NOT** use the battery or VACMOP if it has been modified or damaged. Damaged or modified batteries may exhibit unpredictable behavior resulting in fire, explosion or risk of injury.
- Always release all operational triggers on this appliance before attaching or detaching a VACMOP disposable pad.

BATTERY

- The battery is the power source for the VACMOP. Carefully read and follow all charging instructions.
- To prevent unintentional starting, **DO NOT** carry the appliance with your finger on the trigger or spray button..
- Use only Shark® standard replacement charger. Use of an incorrect charger may result in no charging, and/or unsafe conditions. A charger that is suitable for one type of battery may create a risk of fire when used with another battery.
- Keep the battery away from all metal objects such as paper clips, coins, keys, nails, or screws. Shorting the battery terminals increases the risk of fire or burns.
- Under abusive conditions, liquid may be ejected from the battery. Avoid contact with this liquid, as it may cause irritation or burns. If contact occurs, flush with water. If liquid contacts eyes, seek medical help.
- Battery should not be stored at temperatures below 37.4°F (3°C) or above 104°F (40°C) to maintain long-term battery life.
- DO NOT** charge battery at temperatures below 40°F (5°C) or above 104°F (40°C). Charging improperly or at temperatures outside of the specified range may damage the battery and increase the risk of fire.
- Store the appliance indoors. **DO NOT** use or store it below 37.4°F (3°C). Ensure the appliance is at room temperature before operating.
- DO NOT** expose the battery to fire or temperatures above 265°F (130°C) as it may cause explosion.
- Not for wet pickup.

TECHNICAL SPECIFICATIONS

Voltage: 10.8V

ASSEMBLY

Your VACMOP™ unit comes partially assembled with a cord connecting the parts. All versions assemble the same way. This appliance is for Household use only.

- Align and insert the **Handle** into the top of the **Pole**. You will feel it click in place.
- Align and insert the pole into the **Main Body**. You will feel it click in place.s. All versions assemble the same way. This appliance is for Household use only.

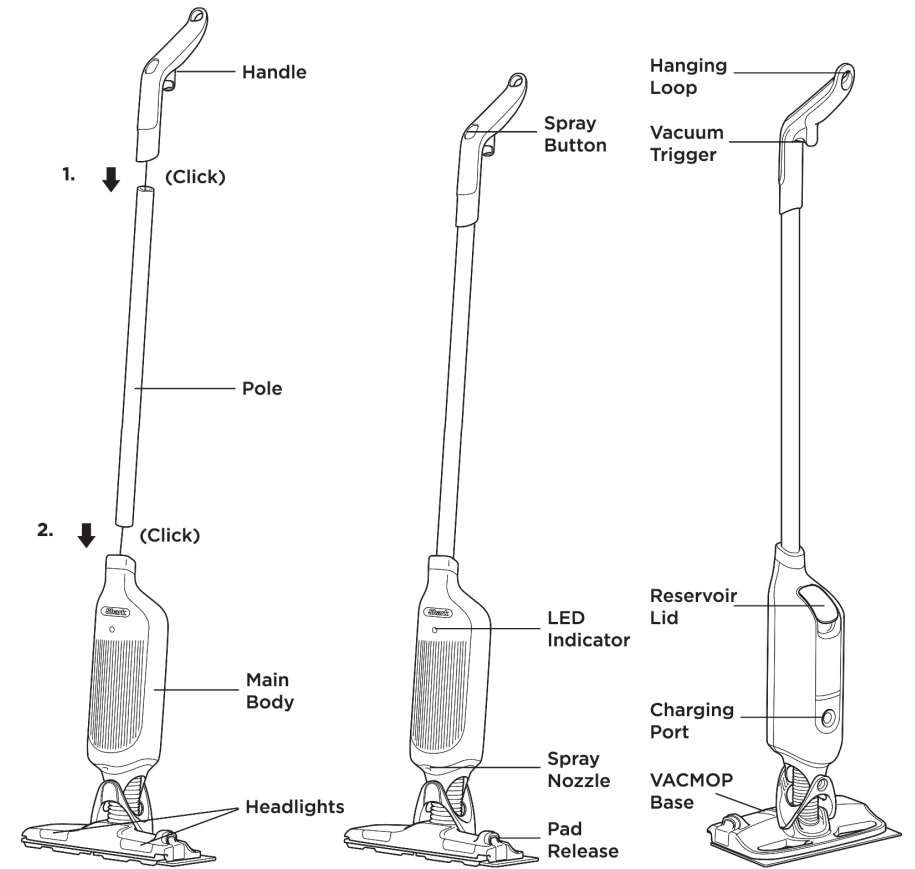

NOTE: Accessories may vary depending on the model. Refer to quick guide, if available. The images shown here are for illustrative purposes only and may be subject to change.

CONTROLS

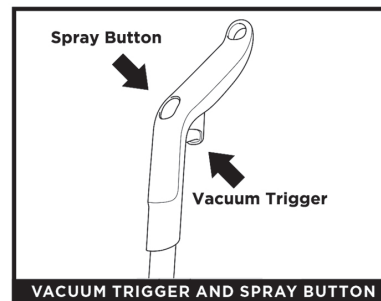

VACUUM TRIGGER AND SPRAY BUTTON

Spray Button

Press and hold the spray button on top of the handle to dispense cleaning solution through the spray nozzle.

Vacuum Trigger

To vacuum, pull the trigger and hold it in.

ATTACHING AND REMOVING PADS

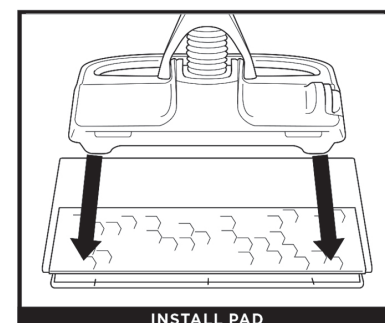

INSTALL PAD

Place the VACMOP™ Disposable Pad on the floor with the scrubbing strip down. Line up the front edge of the VACMOP into the plastic bumper on the pad. Holding the handle, press the VACMOP base down until the pad clicks into place.



PAD DISPOSAL

Dispose of dirty pads by releasing them directly into the trash. To detach the pad, press the release button on the side of the VACMOP base.

DISPOSABLE PAD FUNCTIONALITY

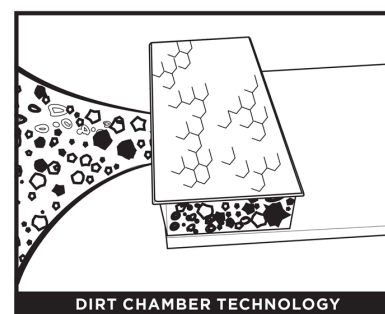

DIRT CHAMBER TECHNOLOGY

The dirt chamber collects and locks away dirt and debris when you vacuum.

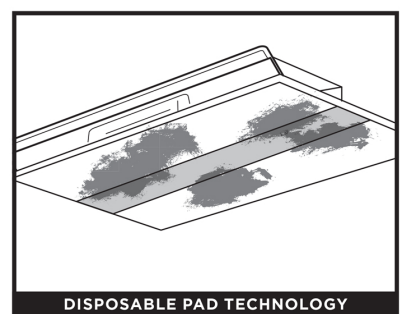

DISPOSABLE PAD TECHNOLOGY

The disposable pad's fibers absorb messes as you mop.

CHARGING THE LI-ION BATTERY

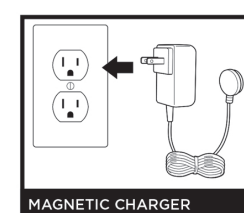

MAGNETIC CHARGER

Plug charger into an electrical outlet.

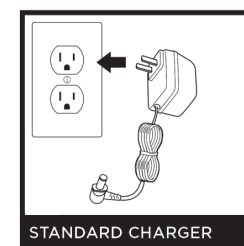

STANDARD CHARGER

NOTE: Your unit may come with one of the two chargers.

Connect the magnetic charger to the port on the back of the main body.

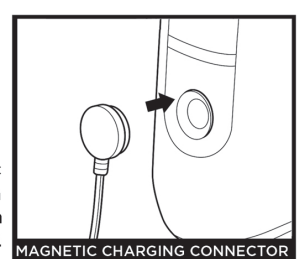

MAGNETIC CHARGING CONNECTOR

Plug the charger into the port on the back of the main body.

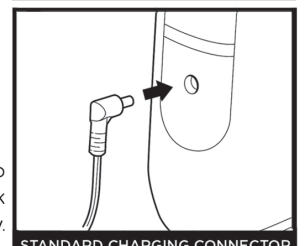

STANDARD CHARGING CONNECTOR

SAVE THESE INSTRUCTIONS

HEADLIGHTS

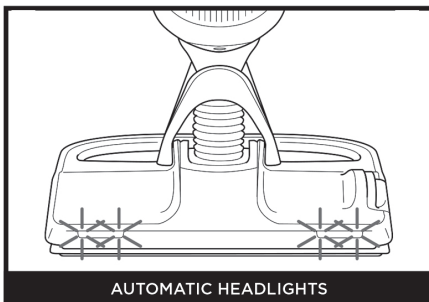

When the VACMOP™ is in use, the motion sensor will automatically activate the headlights. After 10 seconds of inactivity, the headlights will turn off.

NOTE: Headlights included depending on model

AUTOMATIC HEADLIGHTS

LI-ION BATTERY

Prior to first use, charge completely. A full charge takes approximately 3.5 hours.

BATTERY RUNTIME

The Shark VACMOP is designed to handle anything from quick pickups to whole cleaning sessions—just charge it between uses. If it's used one-off everyday messes or for more mopping than vacuuming, it will last longer on one charge. If you're continuously vacuuming, a full charge will last up to 13 minutes.

LED BATTERY POWER AND CHARGING INDICATOR

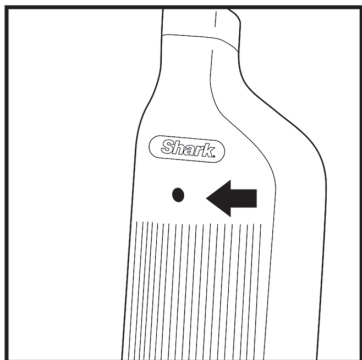

Indicator LED

IN USE:

Normal Operation - Solid green or white*

Low Battery - Blinking green or white*

Very Low Battery - Blinking red

Out of battery - Rapid blinking red

CHARGING:

Battery Charging - Pulsing green or white*

Full Charge - Solid green or white* (will turn off after 5 minutes)

*The color of the light may vary depending on the model.

RECYCLING THE LI-ION BATTERY

When the Shark® Li-Ion battery needs to be replaced, dispose of it or recycle it in accordance with local ordinances or regulations. In some areas, it is illegal to place spent lithium-ion batteries in the trash or in a municipal solid waste stream. Return spent batteries to an authorized recycling center or to the retailer for recycling. Contact your local recycling center for information on where to drop off the spent battery.

NOTE: The Shark battery, like all lithium-ion batteries, will naturally decrease in capacity over time from the 100% capacity of a new battery.

FILLING THE RESERVOIR

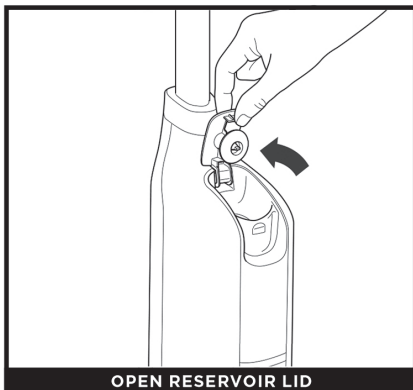

OPEN RESERVOIR LID

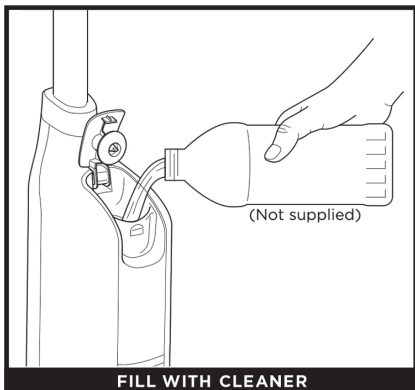

FILL WITH CLEANER

Lift the reservoir lid and press it up until it clicks into the open locked position. Carefully pour cleaner into the reservoir, up to the MAX line. When finished, press the lid closed.

NOTE: Before using your unit for the first time, carefully add a bottle of cleaner into the reservoir.

CLEANING MODES

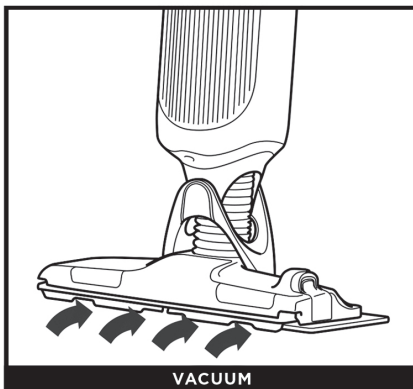

VACUUM

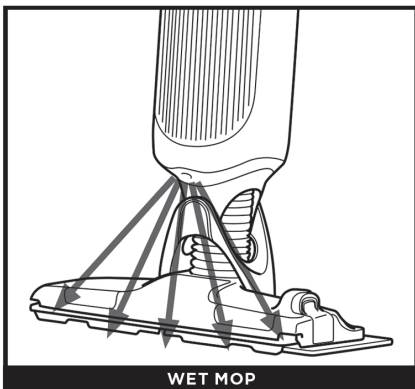

WET MOP

For best results, first use the vacuum to remove debris, then spray the cleaner to wet mop.

STORAGE

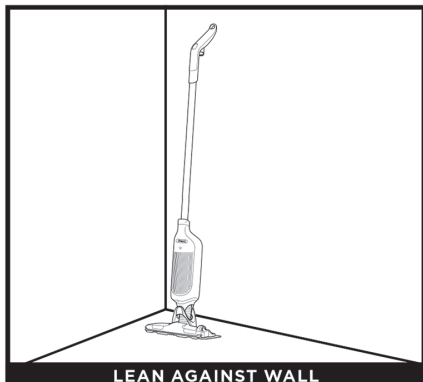

LEAN AGAINST WALL

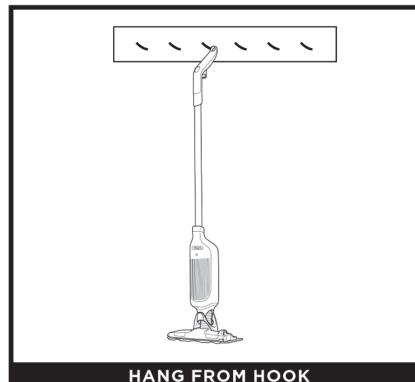

HANG FROM HOOK

After wet cleaning, remove the pad from the VACMOP™ base before storing the unit.

To store the unit, stand it upright and lean the back of the non-slip handle against a wall.

To hang the unit from a nail or wall hook (not included) align the opening at the end of the handle over the hook or nail.

DISASSEMBLY

NOTE: Once the unit is assembled, do not take it apart, unless for repacking or shipping.

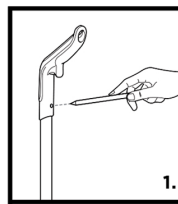

1.

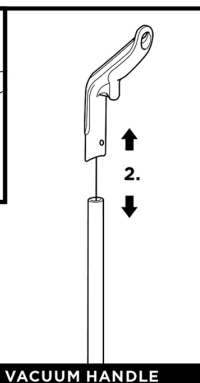

2.

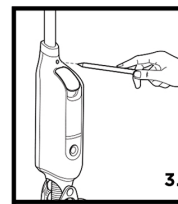

3.

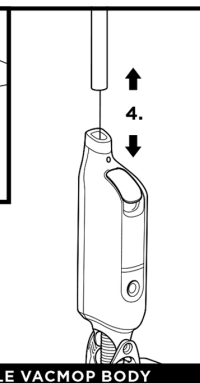

4.

DISASSEMBLE VACUUM HANDLE

DISASSEMBLE VACMOP BODY

1. Press in the snap clip with a small tool (screwdriver, pen, etc.)

2. While pressing down on the top snap clip, pull the handle out of the pole.

3. Next, press in the snap clip on the VACMOP body with a small tool.

4. While pressing down on the bottom snap clip, pull the pole out of the VACMOP body.

MAINTAINING YOUR VACUUM

TROUBLESHOOTING

VACMOP™ is not picking up debris. No suction or light suction.

- VACMOP Disposable Pad may not be securely attached. Reattach the pad.
- VACMOP Disposable Pad may be full of debris and need to be replaced.
- Battery charge may be low. Recharge the battery completely.

The unit turns off on its own. Sprayer is not spraying.

- Battery charge may be low. Recharge the battery completely.

Streaks appear on floor after wet mopping.

- Shark VACMOP Multi-Surface Cleaner has been specially formulated provide a residue-free, streak-free finish when used with the Shark VACMOP. Using other cleaning solutions may result in streaking and residue. If you find residue or streaking on your floors while using our cleaner, it may be due to one of the following:
 - Your floor might not be fully dry yet. If you see streaks or suds while cleaning, just wait 5-10 minutes, and you should see them evaporate, leaving an even finish on your floors.
 - Your Floors might have built-up grime dirt. The first few times you use your VACMOP, it will remove stuck-on dirt and debris that have built up over time. After a few cleaning sessions, the streaking and residue will subside.
 - You may be using too much solution. If you continue to see streaking, reduce the amount of cleaning solution you use. Too much solution can cause stickiness and residue if not properly cleaned off of your floor.
 - The pad might need to be replaced. If you are cleaning multiple times with the same pad, you may be reintroducing dirt onto the floors. Replace your pad, and consider starting each mopping session with a fresh pad to alleviate the issue.

FREQUENTLY ASKED QUESTIONS

When should I replace my VACMOP Disposable Pad?

- Replace the pad when it becomes fully saturated, its dust bin is full, it is noticeably dirty, or if the VACMOP is showing signs of reduced suction power.

Where can I use my VACMOP?

- VACMOP can safely be used on all sealed hard floors—stone, hardwood, vinyl, laminate, tile, marble, and linoleum.

PLEASE READ CAREFULLY AND KEEP FOR FUTURE REFERENCE.

This Owner's Guide is designed to help you keep your VACMOP running at peak performance.

BATTERY REMOVAL AND DISPOSAL

This product uses a lithium-ion rechargeable and recyclable battery. When the battery no longer holds a charge, it should be removed from the VACMOP™ and recycled. DO NOT incinerate or compost the battery.

When your lithium-ion battery needs to be replaced, dispose of it or recycle it in accordance with local ordinances or regulations. In some areas, it is illegal to place spent lithium-ion batteries in the trash or in a municipal solid waste stream. Return spent battery to an authorized recycling center or to retailer for recycling. Contact your local recycling center for information on where to drop off the spent battery.

The RBRC™ (Rechargeable Battery Recycling Corporation) seal on the lithium-ion battery indicates that the costs to recycle the battery at the end of its useful life have already been paid by SharkNinja. In some areas, it is illegal to place spent lithium-ion batteries in the trash or municipal solid waste stream and the RBRC program provides an environmentally conscious alternative.

RBRC, in cooperation with SharkNinja and other battery users, has established programs in the United States and Canada to facilitate the collection of spent lithium-ion batteries. Help protect our environment and conserve natural resources by returning the spent lithium-ion battery to an authorized SharkNinja service center or to your local retailer for recycling.

REFURBISHED PRODUCT LIMITED NINETY DAYS WARRANTY

The **Refurbished Product Service Center** offers the following WARRANTY to the ORIGINAL purchaser of a product which we have refurbished.

This product that has been refurbished is warranted against any electronic or mechanical defects for a period of NINETY DAYS from the date of the original purchase by the consumer. Since this unit was sold as a refurbished item, the warranty does not apply to any cosmetic appearance items such as scratches. Should a defect occur, the **Refurbished Product Service Center** will repair or, at its option, replace defective unit/parts with new or rebuilt materials without charge for either parts or labor. Replacement unit/parts will be warranted for the remaining portion of the original warranty period.

This warranty does not cover installation or damage from accident, misuse, abuse, improper wiring, incorrect voltage, operating the unit against the instructions in the owner's manual or any product which has been opened, altered, or tampered with.

This warranty does not cover costs for removal and or installation of the unit for repair. Under no circumstances shall the service center be liable for any special, incidental or consequential damages or for any other expenses incurred by reason of use or sale of this product. This warranty is in lieu of any other warranties expressed or implied warranty of merchantability of fitness for particular use or otherwise.

This warranty gives the consumer specific legal rights and they may also have other rights which vary from State to State. Some States do not follow the exclusion or limitation of incidental or consequential damages, hence the above exclusion and limitations may not apply.

Refurbished Product Service Center
13225 Marquardt Avenue Santa Fe Springs, CA 90670.

WARRANTY REPAIR INFORMATION

If you need service on your unit and this product requires repair during the 90 days warranty period; please go to www.ConsumerServiceRefurbish.com or call the **Refurbished Product Service Center** at 562-946-3531 to obtain the required return authorization (RA) number. Pack the unit properly (the original carton is ideal for this purpose) along with a copy of your purchase receipt and a letter describing the problem. Send the unit freight prepaid and insured to:

Refurbished Product Service Center,
Att: Customer Service Department 13225 Marquardt Avenue Santa Fe Springs, CA 90670

Your unit will be promptly repaired and returned to you. We will refuse to accept delivery of the returned unit unless the assigned RA number appears on the outside of the shipping carton.

Owner's Information
(Keep for your permanent records)

NAME: _____

ADDRESS: _____

CITY: _____ STATE: _____ ZIP CODE: _____

PHONE: _____ E-MAIL: _____

MODEL: _____ SERIAL NO.: _____



804109925A

PRINTED IN MEXICO Elbrd: Y.T. SC: 01-23-2021_TAB
OBPN: QM_VM250Series_IB_REV_Mv12
MODEL: QM250_B Add: VM251 / VM252
Rev 1_10-08-2021_J.E. / Rev 2_10-14-2021_M.C.
Rev 3_NWCHRGR_02-01-2022_M.C

