

EL SERIES



PORTABLE AIR CONDITIONER

Instructions for use. Keep these instructions

ELECTRIC CHARACTERISTICS
115V ~60 Hz

It's important to read this manual prior to using your new product for the first time.



Important safeguard

- The appliance is not intended for use by persons (including children) with reduced physical, sensory or mental capabilities, or lack of experience and knowledge, unless they have been given supervision or instruction concerning use of the appliance by a person responsible for their safety.
- Children should be supervised to ensure that they do not play with the appliance.
- If the SUPPLY CORD is damaged, it must be replaced by a qualified persons in order to avoid.
- The appliance shall be installed in accordance with national wiring regulations.

As the appliance is powered by electricity, the possibility of electrical shock cannot be excluded. The following safety precautions must therefore be followed:

- After removing the packaging, check the condition of the appliance. If in doubt, do not use the appliance and contact professionally qualified personnel.
- Before use, always check the condition of the power cord.
- It is dangerous to modify or alter the characteristics of the appliance in any way.
- This appliance must be connected to an efficient "grounding" system. Have the electrical system checked by a qualified electrician.
- Before each cleaning or maintenance operation, always disconnect the plug from the power outlet.
- Never submerge the appliance in water.
- Do not use the appliance outdoors.
- Do not obstruct the entrances and exits of air.
- When the appliance is connected to the mains, keep the following safety rules in mind:
- Do not touch the appliance with wet or damp hands;
- Do not use the appliance with bare or wet feet;
- Do not pull on the power cord or appliance to detach the plug from the power outlet;
- Do not move the appliance by pulling the power cable.
- keep the appliance far from the reach of children;
- Do not insert foreign bodies into the appliance;
- Do not insert metal objects into the apertures. Danger! Rotating parts; contact with the internal fan could cause electric shock or injury.
- Do not leave the appliance exposed to atmospheric agents;
- If you wish to permanently eliminate the appliance, after disconnecting the plug from the power outlet it is recommended to make it unusable by severing the power cord.
- In the event of a fault and/or malfunction, turn the appliance off without tampering with it. For all repairs, contact a service center only.
- Avoid the use of power cord extensions.

1.1 Designated use

This appliance must be used exclusively in domestic environment and for the intended purpose for which it was designed. All other uses are considered improper and therefore hazardous. The manufacturer shall not be held liable for any damage caused by improper, erroneous and irresponsible use, and/or due to repairs made by unqualified personnel.

1.2 Installing the appliance

- The appliance must be installed in compliance with national standards regulating electrical systems.
- Do not operate your air conditioner in a wet room such as a bathroom or laundry room.
- Do not install the appliance in rooms containing gas, oil or sulphur or near sources of heat.
- Do not use the appliance on sloping surfaces.
- Keep the appliance at least 20" (52cm) away from flammable substances (alcohol, etc.) or pressurised containers (e.g. aerosol cans).
- Do not rest objects on top of the appliance.
- When transporting, the appliance must be kept upright. If this is not possible secure the unit at an angle, do not lie it horizontally.
- Before transporting the unit, drain the unit.
- After transportation, wait at least 6 hours before switching the unit on.

1.3 Environmental information

- The materials used for packaging can be recycled. You are therefore recommended to dispose of them in special differentiated waste collection containers.

Specific information regarding appliances with R32 refrigerant gas

- Thoroughly read all of the warnings.
- When defrosting and cleaning the appliance, do not use any tools other than those recommended by the manufacturing company.
- The appliance shall be stored in a well-ventilated area;
- The appliance shall be stored in a room without continuously operating open flames (for example an operating gas appliance) and ignition sources (for example an operating electric heater).
- Do not burn any part of the appliance.
- Refrigerant gases can be odorless.
- This appliance contains R32 refrigerant gas. (For more details on the refrigerant, see back cover).
- Do not puncture any part of the refrigerant circuit.
- The servicing shall be performed only as recommended by the manufacturer.
- The appliance must be stored in a safe place in order to prevent damage to the unit.
- Individuals who operate or work on the refrigerant circuit must have the appropriate certification issued by an accredited organisation that ensures competence in handling refrigerants according to a specific evaluation recognized by associations in the industry.

- Repairs must be performed based on the recommendations from the manufacturing company. Maintenance and repairs that require the assistance of other qualified personnel must be performed under the supervision of an individual specified in the use of flammable refrigerants.

1. GENERAL INFORMATION

1.1 Instruction for Use

Read all the Instruction for Use carefully before using the appliance. Failure to follow this Instruction for Use may result in burns or damage to the appliance. The manufacturer is not liable for damage deriving from failure to respect this Instruction for Use. WARNING: Changes or modifications not expressly approved by the party responsible for compliance could void the user's authority to operate the equipment.

Please note: These safety warnings are valid for all De'Longhi air conditioners.

If the appliance is passed to other persons, they must also be provided with this Instruction for Use. This appliance is fitted with a special safety device. When the compressor switches off, this device prevents it from switching on again for at least 3 minutes.

2. BEFORE USE

Important!

Store the packaging material far from the reach of children. CHOKING HAZARD. The appliance might contain small parts. Some of those small parts might be required to get disassembled during cleaning and maintenance operations. Handle with care and keep small parts out of reach of children.

2.1 Checking the appliance

After removing the packaging, make sure the product is complete and undamaged and that all accessories are present. Do not use the appliance if it is visibly damaged. Contact a service center.

Save these instructions - This product is for household use only

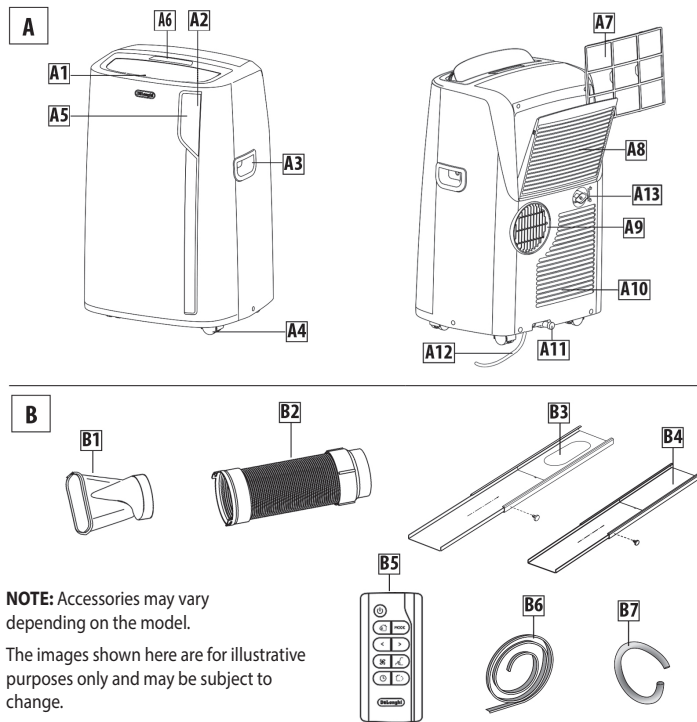

NOTE: Accessories may vary depending on the model.

The images shown here are for illustrative purposes only and may be subject to change.

INTRODUCTION

Thank you for choosing a De'Longhi product. Please take a few moments to read the instructions to avoid risks or damage to the appliance.

DESCRIPTION

Description of the appliance

- A1 Air outlet grid
- A2 Control panel
- A3 Handles
- A4 Wheels
- A5 Remote control signal receiver
- A6 Remote control storage
- A7 Filter
- A8 Air intake grille
- A9 Air exhaust hose housing
- A10 Air intake grille
- A11 Lower drainage hose with cap
- A12 Power supply cable
- A13 Upper drainage hose

Description of accessories

- B1 Window outlet vent
- B2 Assembled air exhaust hose
- B3 Window bracket with locking pin
- B4 Additional window bracket with locking pin

- B5 Remote control
- B6 Foam stripping
- B7 Evaporator water drain tube

Electrical connection

- Before plugging the appliance into the outlet, check that:
 - The outlet's power supply corresponds to the value indicated on the rating label on the back of the appliance;
 - The outlet and electrical circuit are adequate for the appliance;
 - The outlet is a 3-hole grounded outlet. If this is not the case, you must choose another outlet. Failure to follow these important safety instructions absolves the manufacturer of all liability.

If it becomes necessary, the power cable must be replaced by a qualified professional only.

The instructions below will enable you to prepare your air conditioner for operation as efficiently as possible. Before use, make sure the air intake and outlet grilles are unobstructed.

USE

Note: This appliance features an auto evaporative function to remove excess condensate water during cooling and dehumidifying modes.

AIR CONDITIONING INSTALLATION

For optimal results set up your appliance in this way:

- Fit the assembled air exhaust hose adapter B2 in the housing at the back of the appliance. Align the open lock symbol on the air hose with the arrow on the back of the unit. Turn air hose counter clockwise until the closed lock symbol is aligned with the arrow, as shown in figure 1.

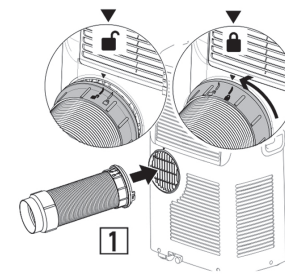

AIR CONDITIONING WITH WINDOW INSTALLATION

You can also set up in a double-hung window:

- Place the window bracket in the window sill, extend the bracket fully within the window frame, fix the bracket in place using the locking pin. Attach the foam stripping B6 to the top of the window bracket and then lower the window onto the bracket. (Should the window bracket be too large for the window, the plastic can be cut with a saw by a qualified professional.)
- Fit the air exhaust hose B2 in the relevant housing located on the rear side of the appliance. Align the open lock symbol on the air hose with the arrow on the back of the unit, turn air hose counter clockwise until the closed lock symbol is aligned with the arrow, as shown in figure 1.
- Connect the window outlet vent B1 to the other end of the exhaust hose.
- Insert the window outlet vent B1 of the exhaust hose into the slot of the window bracket (fig. 2).



Other set-up methods:

- Thanks to the locking pins, it's possible to use the window bracket also for sliding windows. Position the hole of the bracket so to allow a correct installation of the exhaust hose (see figure 3).

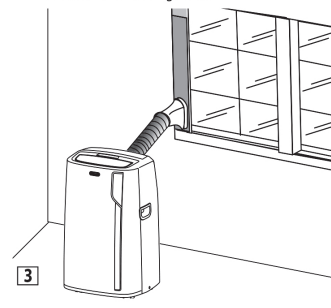

- If you have a casement window (figure 4) proceed as follows:

- Fit the assembled air exhaust hose B2 in the relevant housing located on the rear side of the appliance, align the open lock symbol on the air hose with the arrow on the back of the unit, turn air hose counter clockwise until the closed lock symbol is aligned with the arrow, as shown in figure 1, then apply the window outlet B1 to the air exhaust hose B2 and place it outside the window to exhaust the hot air.

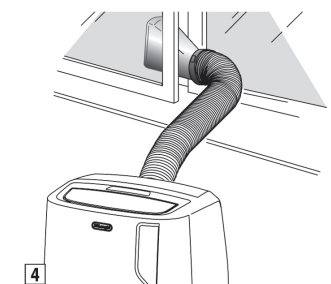

OPERATING FROM THE CONTROL PANEL

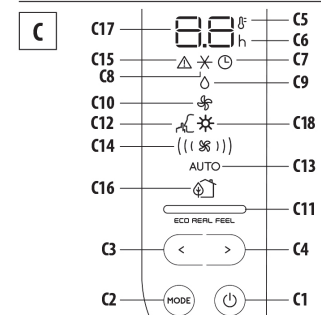

DESCRIPTION OF THE CONTROL PANEL

- C1 ON/STAND-BY (on/off) key
- C2 Mode selection key (air conditioning, dehumidifying, fan, heating)
- C3 Decrease key
- C4 Increase key
- C5 Temperature indicator
- C6 Timer hour indicator
- C7 Timer symbol
- C8 Air conditioning symbol
- C9 Dehumidifying symbol
- C10 Fan symbol
- C11 ECO REAL FEEL indicator
- C12 Arctic whisper
- C13 Auto air flow indicator
- C14 Air flow indicators
- C15 Alarm symbol
- C16 ECO REAL FEEL symbol
- C17 Set temperature display, programmed on/off time
- C18 Heating symbol (on some models only)

Note: Remote control may vary depending on the model.

TURNING THE APPLIANCE ON/OFF

Before plugging in the appliance, check the caps on back of the unit are correctly inserted on drainage hose A11 and A13.

Insert the plug in the socket. Two dashes appear on the display indicating that the appliance is in stand-by. Touch the (C1) key to turn on the appliance. When the appliance comes on, the last function set before it was shut off is activated. NOTE: After a few seconds of inactivity, the brightness of the control panel will be

automatically reduced and in the next few minutes it will be further reduced. To turn the appliance off, touch the (C1) key.

Note: Never turn off the air conditioner by simply pulling the plug. In this manner, the appliance can perform operating status checks.

MODE SELECTION

To select the desired operating mode, touch repeatedly the MODE key until the desired function is selected.



OPERATING FROM THE CONTROL PANEL - Cont.

AIR CONDITIONING MODE

This is ideal for hot and humid weather when the room needs to be both cooled and dehumidified. To correctly set this mode:

- Touch repeatedly the MODE key until the air conditioning symbol * appears.
- To change to the desired temperature, touch the < or > key.

Note: The most suitable temperatures, during the summer range from 75 to 81°F. However, setting the temperature significantly lower than the outdoor temperature is not recommended. In conditioning mode, the air flow can be selected only from the remote control.

DEHUMIDIFYING MODE

This is ideal for reducing humidity in the room (spring and autumn, damp rooms, rainy periods, etc.). For this type of use, the appliance must be set up same as in the air conditioner mode. That is, the air exhaust hose B2 must be fitted to

the appliance to allow the humidity to be discharged outside. To correctly set this mode:

- Touch repeatedly the MODE key until the dehumidifying symbol D appears.
- The appliance automatically chooses the best air flow.

Note: In case of high ambient humidity, it is possible to drain the condensation continuously by applying the tube B7 to the upper drainage hose A13 (fig. 5) and thus allowing the water to flow into a container.

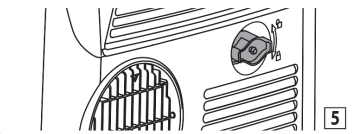

Unscrew the cap by following the directions and inserting the tube. Pay attention that water does not overflow onto the floor (fig. 6). If the connector is not in use, to avoid overflow onto the floor, remember to screw the cap into place.

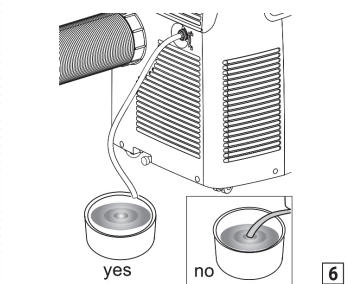

FAN MODE

When using this mode, the air exhaust hose B2 does not need to be attached to the appliance. To correctly set this mode:

- Touch repeatedly the MODE key until the fan symbol F appears.
- Select the desired air flow by touching the decrease < C3 or increase > C4 buttons.

The air flows available are:

- (F) Minimum air flow: when maximum quiet operation is desired.
- ((F)) Medium air flow: when the noise level needs to be low but with a good comfort level.
- (((F))) Maximum air flow: for maximum performance.

NOTE: The images shown here are for illustrative purposes only and may be subject to change.

HEATING MODE (on some models only)

This is ideal in spring and autumn when outdoor temperatures are not particularly severe. For this mode, the appliance should be prepared in the same way as for air conditioning, with the air exhaust hose B2 attached. To set this mode:

- Touch repeatedly the MODE button until the heating symbol H is displayed.

- Touch increase > C4 or decrease < C3 buttons to adjust the desired temperature.

Notes:

- In this mode, the air flow is selected automatically by the appliance and cannot be set manually.
- When operating in very cold rooms, the appliance defrosts automatically, momentarily interrupting normal operation. In this case, "L" appears on the display. During this operation, it is normal for the noise made by the appliance to change.
- In this mode, you may have to wait a few minutes before the appliance starts providing warm air.
- In this mode, the fan may operate for short periods, even though the set temperature has already been reached.
- If the display comes on and shows the "HL" alarm, empty the internal tray following the instructions in the Section "End of Season operations". At the end, touch again the () button to restore the heating function.

ECO REAL FEEL FUNCTION (available only from remote control)

ECO REAL FEEL is the innovative De'Longhi technology that works simultaneously on temperature reduction and humidity control, securing the best comfort level. With traditional systems, during working time, optimal comfort conditions may be reached but not secured over time. With ECO REAL

FEEL, once optimal comfort is reached, the portable air conditioner automatically modulates the compressor and air flow, to keep it over time. To activate the function, press the Eco Real Feel button. The ECO REAL FEEL symbol () appears.

Please note: For this type of use, the appliance must be set up same as in the air conditioning mode. After approx. 1 minute, the ECO REAL FEEL indicator () C11 turns on. It changes color when approaching the best comfort level (see following diagram).

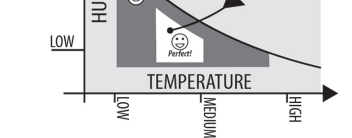

- () ORANGE LIGHT: Room conditions far from optimal level.
- () GREEN LIGHT: Most people feel good room conditions, near optimal level.
- () BLUE LIGHT: Best comfort level. Perfect!

The well-being feeling is a subjective condition: for this reason, different people may judge differently the same environmental conditions. In particularly severe environmental conditions (high temperature or humidity outside, poor insulation, too many people, high heat in the room, strong exposure to the sun, etc.) this device may not be able to reach the best comfort level.

SELECT THE TEMPERATURE SCALE

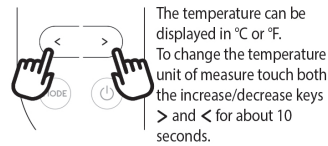

The temperature can be displayed in °C or °F. To change the temperature unit of measure touch both the increase/decrease keys > and < for about 10 seconds.

OPERATING FROM THE REMOTE CONTROL

INSERTING OR REPLACING THE BATTERIES

- Remove the cover on the rear of the remote control;
- Insert or replace the batteries with two new LR03 "AAA" 1.5V batteries, inserting them correctly (see the directions inside the battery compartment);
- Replace the cover.

Please note: If the remote control unit is replaced or discarded, the batteries must be removed and disposed of in accordance with current legislation as they are harmful to the environment. Do not mix old and new batteries. Do not mix alkaline, standard (carbon-zinc) or rechargeable (nickel-cadmium) batteries. Do not dispose of batteries in fire. Batteries may explode or leak. If the remote control is not be used for a certain length of time, remove the batteries.

USING THE REMOTE CONTROL

- Point the remote control at the receiver **A5** on the air conditioner. The remote control must be no more than 16ft/5 meters away from the appliance without obstacles between the remote control and the receiver).
- The remote control must be handled with care. Do not drop it or expose it to direct sunlight or sources of heat.

Please note: The remote control can be safely stored in the appropriate compartment **A6**.

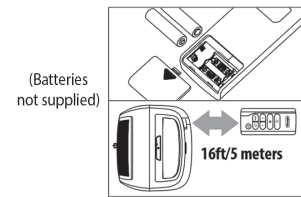

DESCRIPTION OF THE REMOTE CONTROL

- D1**) ON/STAND-BY button
- D2**) Air flow selection button
- D3**) ECO Real Feel button
- D4**) Timer button
- D5**) MODE button
- D6**) Decrease button
- D7**) Increase button
- D8**) Arctic Whisper button
- D9**) Swing button

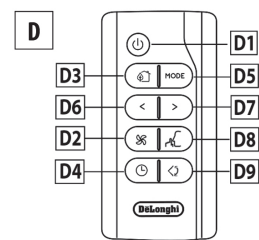

NOTE: The remote control may vary depending on the model.

TURNING THE APPLIANCE ON/OFF

- Plug into the outlet.
- Press the **D1** button to turn the appliance on (when turned on, the air conditioner starts operating in the same mode as when it was turned off).
- To switch the appliance off, press button **D1**.

Note: Never switch the appliance off by removing the plug. Always switch it off by pushing the **D1** button and waiting a few minutes before removing the plug. Only in this way will the appliance be able to perform its standard checks.

SELECTING THE OPERATING MODES

Most of the commands available on the remote control correspond to those on the appliance control panel **A2**.

SELECTING THE TEMPERATURES

In air conditioning and heating modes, press increase/decrease keys to select the desired temperature.

SELECTING THE AIR FLOW

In air conditioning and fan modes, press air flow selection button on remote control to select the desired air flow. The air flow available are:

- Minimum air flow:** when maximum quiet operation is desired.
- Medium air flow:** when the noise level needs to be low but with a good comfort level.
- Maximum air flow:** for maximum performance.
- AUTO air flow:** The appliance automatically chooses the air flow based on the temperature selected and the environmental conditions. This selection is only available in conditioning mode.

ECO REAL FEEL FUNCTION

To activate this function, push button D3 on the remote control. See description of the function.

ARCTIC WHISPER (available in conditioning mode only)

By activating this function, the operating noise is further reduced. To activate, press **D8** button on the remote control. The display shows the relative symbol **C12**.

SWING FUNCTION

The SWING button D9 moves the flap, evenly distributing the air into the room. When the SWING button is pressed, the flap will begin to move forward and backwards alternatively. If pressed again, the flap will be locked into its current position. When the button is next pressed, the flap will start to move forwards and backwards again.

Note: In order to avoid damaging the internal mechanisms, the flap must not be moved manually.

SETTING THE TIMER

The timer allows for the delayed start up or shut down of the appliance. This function will prevent wasting electricity by optimising the operating periods.

How to program delayed shut down

- While the appliance is on in any operating mode, delayed shut down can be programmed.
- Press the timer button **D4**: the timer symbol **C7** and hours **C6** light up.
- Press the timer key until the desired number of hours to shut down appears on the display (1,2,4,6,8,12 hours).

A few seconds after the timer is set, the setting is memorized and the display shows the operating mode and the timer symbol stays lit. Once the set time is elapsed, the air conditioner goes into standby.

To cancel the timer program, press the timer button **D4** twice. The timer symbol **C7** will go off.

Note: Once the timer has been activated, by pressing the timer key only one time, the remaining hours to shut down will be displayed.

How to program delayed start up

- Plug in the appliance and set to standby.
- Press the timer button **D4**: the timer symbol **C7** and hours **C6** light up.
- Press the timer key until the desired numbers of hours to start up appears (1,2,4,6,8,12 hours).

When the set time is elapsed, the appliance will start to operate in the same operating mode that was previously set.

To cancel the timer program, press the timer button **D4** twice. The timer symbol **C7** will go off.

NOTE: Once the timer has been activated, by pressing the timer key only one time, the remaining hours to the start up will be displayed.

Note:

- This equipment has been tested and found to comply with the limits for a Class B digital device, pursuant to part 15 of the FCC Rules. These limits are designed to provide reasonable protection against harmful interference in a residential installation.
- This equipment generates, uses and can radiate radio frequency energy and, if not installed and used in accordance with the instructions, may cause harmful interference to radio communications. However, there is no guarantee that interference will not occur in a particular installation. If this equipment does cause harmful interference to radio or television reception, which can be determined by turning the equipment off and on, the user is encouraged to try to correct the interference by one or more of the following measures:
 - Reorient or relocate the receiving antenna.
 - Increase the separation between the equipment and receiver.
 - Connect the equipment into an outlet on a circuit different from that to which the receiver is connected.
 - Consult the dealer or an experienced radio/TV technician for help.Changes or modifications not expressly approved by the party responsible for compliance could void the user's authority to operate the equipment.
- This device complies with Part 15 of the FCC Rules. Operation is subject to the following two conditions: (1) this device may not cause harmful interference, and (2) this device must accept any interference received, including interference that may cause undesired operation.

SELF-DIAGNOSIS

The appliance has a self diagnosis system to identify a number of warning/malfuncions. Error messages are displayed on the appliance display.

IF ... IS DISPLAYED,	IF ... IS DISPLAYED,	IF ... IS DISPLAYED,	IF ... IS DISPLAYED,
"Low Temperature" (frost prevention)	"Probe Failure" (Probe damaged)	"High Level" (Internal tray full)	"High Temperature"
..WHAT SHOULD I DO? The appliance is fitted with a frost protection device to avoid excessive formation of ice. The appliance starts up again automatically when the defrosting process is completed.	..WHAT SHOULD I DO? If this is displayed, contact a service center.	..WHAT SHOULD I DO? Empty the internal safety tank following the instructions in the section "End of season operations".	..WHAT SHOULD I DO? Empty the internal safety tank following the instructions in the section "End of season operations". If HL alarm reoccurs frequently in Air Conditioning, Dehumidifying or Reel Feel mode, contact a service center.

TIPS FOR CORRECT USE

To ensure optimal results from your air conditioner, follow these recommendations:

- Close the windows and doors in the room to be air conditioned. When installing the air conditioner semi-permanently, you should leave a door slightly open (as little as 1/2" inch. (1 cm)) to guarantee proper ventilation.

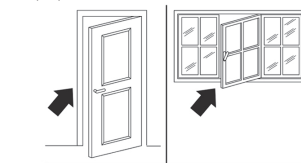

Close door and windows

- Never use the appliance in very damp rooms (laundries for example).
- Protect the room from direct exposure to the sun by partially closing curtains and/or blinds to make the appliance much more economical to run.

CLEANING

Before cleaning or maintenance, turn the appliance off by using the button, then unplug from the outlet.

CLEANING THE CABINET

You should clean the appliance with a slightly damp cloth then dry with a dry cloth. For safety reasons, never wash the air conditioner with water.

Precautions

Never use petrol, alcohol or solvents to clean the appliance. Never spray insecticide liquids or similar.

CLEANING THE BIO SILVER AIR FILTER (If fitted)

If the filter is dirty, air circulation is compromised and the efficiency of the appliance decreases. It is therefore good practice to clean the filter at regular intervals. The frequency depends on the duration and conditions of operation. If the unit is used constantly or systematically, you are recommended to clean the filter once a week.

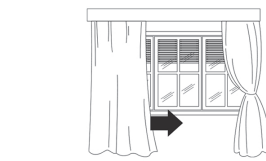

Close blinds or curtains

- Never use the appliance outdoors.
- Make sure there are no heat sources in the room.
- Make sure the air conditioner is standing on a level surface.



Do not cover the appliance

- Never rest objects of any kind on the air conditioner.
- Never obstruct the air intake or outlet grilles.

The filter is housed in the intake grille. Remove the grille to access the filter. To clean the filter, it will need to be extracted as shown in fig. 7.

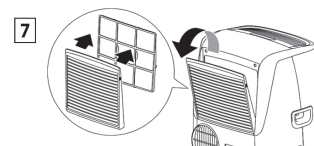

Use a vacuum cleaner to remove any dust deposited on the filter. If it is very dirty, submerge it into warm water and rinse it several times. The water temperature must be kept below 104° F (40°C).

After washing the filter, allow it to dry completely before repositioning it.

The BioSilver filter helps capture dust and pollen and helps reduce the growth of bacteria and mold on the filter.

CHECKS AT THE START OF THE SEASON

Make sure the power cable and socket are in perfect condition and make sure the grounding system is sufficient. Comply strictly with the installation standards.

END OF SEASON OPERATIONS

To drain all water from the circuit, remove the cap A11 from the drainage on the back of the appliance and allow the water to drain out into a basin (fig. 8).

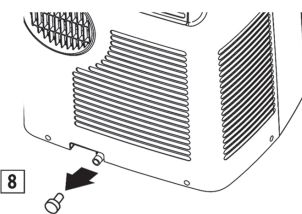

When the appliance is empty, replace the cap. Clean the filter and dry thoroughly before putting back. Unit should be stored in large, well ventilated area.

LIMIT CONDITIONS

Room temperature for air conditioning	64 ÷ 95°F (18° ÷ 35°C)
Room temperature for heating (on some models only)	50 ÷ 77°F (10 ÷ 25°C)
Maximum relative humidity :	80% RH

TECHNICAL SPECIFICATIONS

Power supply voltage	see rating label
Max. absorbed power during air conditioning	"
Refrigerant	"
Cooling capacity	"

Transport, filling, cleaning, recovery and disposal of refrigerant should be performed by a service center. The appliance should be disposed of by a specialist center.

TO AVOID DAMAGE TO THE UNIT:

NEVER TRANSPORT OR TURN THE APPLIANCE UPSIDE DOWN OR ON ITS SIDE. IF THIS OCCURS, WAIT 6 HOURS BEFORE TURNING THE APPLIANCE ON, 24 HOURS IS RECOMMENDED. After the unit has been on its side, oil needs to return to the compressor to ensure proper function. Without allowing the unit this time (6-24 hours) the unit may function for only a short time, and then the compressor will break down from lack of oil.

ELECTRICAL CONNECTION

This appliance is equipped with a 3 prong grounded plug. The plug must be connected into an outlet that is properly installed and grounded in the accordance with all local codes and ordinances. Do not modify the plug provided with the appliance. If it will not fit the outlet, have a proper outlet installed by a qualified electrician or relocate the unit to a proper outlet. If the household electrical supply does not meet the above specifications, or if you are not sure your home has an effective electrical ground, have a qualified electrician or your local electrical utility company check it and correct any problems.

TROUBLESHOOTING

Please check the following points before calling a service center.

PROBLEMS	CAUSES	SOLUTIONS
The air conditioner does not turn on	It is not plugged in	Plug it in
	There is no power	Wait for at least 3 minutes and try again
	The internal protection device was triggered	Call a service center.
The air conditioner works for a short period of time	The air exhaust hose is obstructed or bent	Correctly position the air exhaust hose, limiting the length and curves as much as possible and avoiding any obstructions
	An obstruction is impeding air exhaust outside	Identify and remove the obstacles that impede air exhaust outside
	Windows, doors, drapes open	Close the windows, doors and drapes, keeping in mind the "recommendations for proper use"
The air conditioner runs but does not cool the room	There is some heat source in the room (oven, hair dryer, etc.)	Eliminate the heat source
	The air exhaust hose is disconnected from the appliance	Attach the air exhaust hose to the housing on the back of the appliance (fig.1)
	Dust filters clogged	Clean or replace the filters as previously described
During operation there is an unpleasant odor in the room	Dust filters clogged	Clean or replace the filters as previously described
The air conditioner does not work for about 3 minutes from restart	To protect the compressor there is an internal device that delays startup for about 3 minutes from restart	Wait the recommended time and try again
The internal tank is full	High ambient humidity	Apply the evaporator water drain tube (B7) to the upper drainage hose (A13), thus allowing the water to flow into a container. Pay attention the water does not overflow on to the floor.
One of the following messages is displayed: LT/PF/HL/HT	The appliance has a self-diagnosis system that identifies some operating errors	Refer to the SELF-DIAGNOSIS chapter

REFURBISHED PRODUCT LIMITED THIRTY DAY WARRANTY

The **Refurbished Product Service Center** offers the following WARRANTY to the ORIGINAL purchaser of a product which we have refurbished.

This product that has been refurbished is warranted against any electronic or mechanical defects for a period of THIRTY DAYS from the date of the original purchase by the consumer. Since this unit was sold as a refurbished item, the warranty does not apply to any cosmetic appearance items such as scratches. Should a defect occur, the **Refurbished Product Service Center** will repair or, at its option, replace defective unit/parts with new or rebuilt materials without charge for either parts or labor. Replacement unit/parts will be warranted for the remaining portion of the original warranty period.

This warranty does not cover installation or damage from accident, misuse, abuse, improper wiring, incorrect voltage, operating the unit against the instructions in the owner's manual or any product which has been opened, altered, or tampered with.

This warranty does not cover costs for removal and or installation of the unit for repair. Under no circumstances shall the service center be liable for any special, incidental or consequential damages or for any other expenses incurred by reason of use or sale of this product. This warranty is in lieu of any other warranties expressed or implied warranty of merchantability of fitness for particular use or otherwise.

This warranty gives the consumer specific legal rights and they may also have other rights which vary from State to State. Some States do not follow the exclusion or limitation of incidental or consequential damages, hence the above exclusion and limitations may not apply.

Refurbished Product Service Center
13225 Marquardt Avenue Santa Fe Springs, CA 90670

WARRANTY REPAIR INFORMATION

If you need service on your unit during the 30 day warranty period; please go to www.ConsumerServiceRefurbish.com or call the Refurbished Product Service Center at 562-946-3531 to obtain the required claim number. Once you obtain your claim number, pack the unit properly (the original carton is ideal for this purpose) along with a copy of your purchase receipt.

Send the unit freight prepaid and insured to:

Refurbished Product Service Center,
Att: Customer Service Department 13225 Marquardt Avenue Santa Fe Springs, CA 90670

Your unit will be promptly exchanged and returned to you.
We will refuse to accept delivery of the returned unit unless the assigned claim number appears on the outside of the shipping carton.

Owner's Information
(Keep for your permanent records)

NAME: _____

ADDRESS: _____

CITY: _____ STATE: _____ ZIP CODE: _____

PHONE: _____ E-MAIL: _____

MODEL: _____ SERIAL NO.: _____

