

XR-85X93L / 85X93CL / 75X93L
XR-75X93CL / 65X93L / 65X93CL

81400173

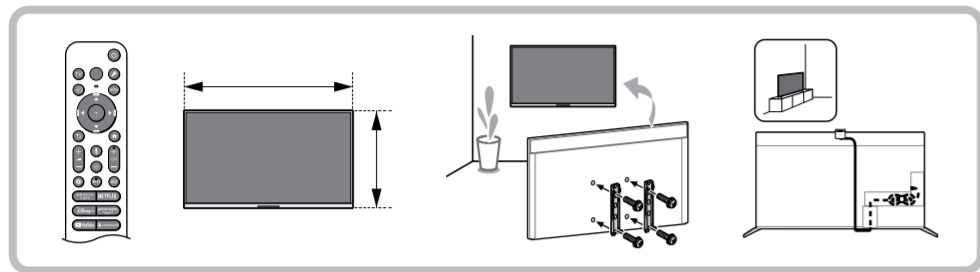

Read this manual before using this product

Dimensions and weight (without Table-Top Stand)

	(mm)/(inches)*1			(kg)/(lb.)*1	
	A	B	C	W	H
XR-85X93L / 85X93CL	1889/74 3/8	1086/42 1/8	56/2 1/4	53.2/117.2	53.2/117.2
XR-75X93L / 75X93CL	1667/65 3/4	961/37 1/8	56/2 1/4	42.7/94.1	42.7/94.1
XR-65X93L / 65X93CL	1443/56 1/8	835/32 1/8	60/2 3/8	32.1/70.8	32.1/70.8

*1 (Approx.)

Dimensions and weight (Table-Top Stand)

	(mm)/(inches)*1			(kg)/(lb.)*1	
	A	B1	B2	B3	W
XR-85X93L / 85X93CL	1889/74 3/8	1097/43 1/4	1110/43 3/4	1158/45 3/8	54.7/120.5
XR-75X93L / 75X93CL	1667/65 3/4	972/38 3/8	984/38 3/4	1033/40 3/4	44.1/97.2
XR-65X93L / 65X93CL	1443/56 1/8	846/33 3/8	859/33 1/8	907/35 3/4	33/72.7

*1 (Approx.)

	(mm)/(inches)*1								(kg)/(lb.)*1	
	A	B1	B2	B3	C	D1	D2	D3	W	H
XR-85X93L / 85X93CL	1889/74 3/8	1097/43 1/4	1110/43 3/4	1158/45 3/8	450/17 3/4	1888/74 3/8	758/29 1/8	1888/74 3/8	54.7/120.5	54.7/120.5
XR-75X93L / 75X93CL	1667/65 3/4	972/38 3/8	984/38 3/4	1033/40 3/4	391/15 1/2	1665/65 3/8	571/22 1/2	1665/65 3/8	44.1/97.2	44.1/97.2
XR-65X93L / 65X93CL	1443/56 1/8	846/33 3/8	859/33 1/8	907/35 3/4	343/13 3/8	1442/56 1/8	514/20 1/4	1442/56 1/8	33/72.7	33/72.7

*1 (Approx.)

The length of the screw for Wall-Mount Bracket differs depending on the Wall-Mount Bracket thickness

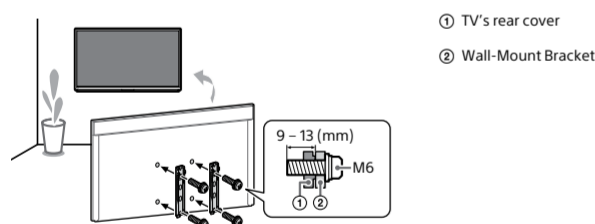

Optional Camera and Microphone Unit (not supplied) Cable Management



EN

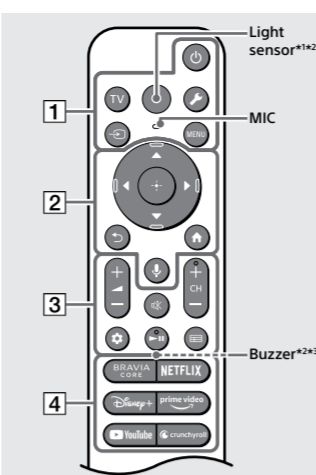

The remote control shape, layout, availability and function of remote control buttons may vary depending on your region/country/TV model/TV settings.*4

- 1 (Power)**
TV: Display TV channel list or switch to input.
⏏ (Quick settings): Display Quick Settings.
⏪ (Input): Display and select the input source, etc.
MENU (Control menu): Display the Control menu.
- 2** ▲ / ▼ / ◀ / ▶ / ⏪ / ⏩ : On screen menu navigation and selection.
⏪ (Back)
⏪ (Home)
🗣️ (Google Assistant / Microphone): Use Google Assistant**4,5.
🔇 + / - (Volume)
🔇 (Mute)*7
CH + / - (Channel)
🌟 (Dashboard): Display Dashboard.
📺 (Guide): Display the digital program guide of TV or Cable/Satellite box**4.
- 3** 🔊 + / - (Volume)
🔇 (Mute)*7
CH + / - (Channel)
🌟 (Dashboard): Display Dashboard.
📺 (Guide): Display the digital program guide of TV or Cable/Satellite box**4.
- 4 App buttons**

- The remote control backlight will illuminate when the light sensor detects the ambient light is low. Automatic illumination of the backlight can be turned off.
- RMF-TX910U only. To see the model name of the remote control, open the remote control cover and see the label on the remote control.
- The buzzer will emit a sound when you use the remote control finder function. Refer to the online Help Guide for details.
- For other remote control models, refer to the online Help Guide for details.
- Only for limited region/country/model/language.
- Google Assistant requires an Internet connection.
- Accessibility shortcut is available by pressing and holding 🔇 (Mute).
- [Cable/Satellite box setup] setting is required.

Note
• Instructions about "Installing the TV to the Wall" are included within this TV's instruction manual.
• Read the supplied safety documentation for additional safety information.

Location of the identification label
Labels for the TV Model No. and Power Supply rating are located on the rear of the TV. They can be found by removing the terminal cover.

Compatible Wall-Mount Bracket Information
Use the following Sony Wall-Mount Bracket with your TV model.

Sony TV Model No.	Sony Wall-Mount Bracket Model No.
XR-65X93L / 65X93CL	SU-WL855*1

Use with other Wall-Mount Brackets** may cause instability and could result in property damage or injury.

Before setting up your TV
Some TV models are packaged with a detached Table-Top Stand so you can mount your TV to a wall right away. See "Installing the TV to the Wall" if you want to mount the TV to a wall. If you are not mounting the TV to a wall, you will need to attach the Table-Top Stand (refer to the Setup Guide).
Be sure to consider the following while setting up your TV:

- Disconnect all cables when carrying the TV.
- Before transporting the TV set, remove the terminal covers.
- Two or more persons (three or more persons for 214.8 cm (85 inches) and above TV) are needed to transport a large TV set.
- Correct hand placement while carrying the TV is very important for safety and to avoid damage.

XR-85X93L / 85X93CL

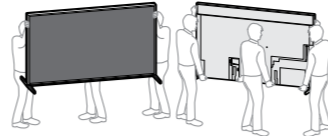

XR-75X93L / 75X93CL / 65X93L / 65X93CL

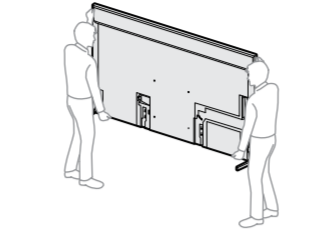

Securing the TV

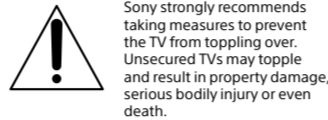

- Sony strongly recommends taking measures to prevent the TV from toppling over. Unsecured TVs may topple and result in property damage, serious bodily injury or even death.
- Preventing the TV from Toppling**
- Secure the TV to a wall and/or Stand.
 - Do not allow children to play or climb on furniture and TV sets.
 - Avoid placing or hanging items on the TV.
 - Never install the TV on:
 - slippery, unstable and/or uneven surfaces.
 - furniture that can easily be used as steps, such as a chest of drawers.
 - Install the TV where it cannot be pulled, pushed, or knocked over.
 - Install the TV so that the TV's Table-Top Stand does not protrude out from the Stand (not supplied), if the Table-Top Stand protrudes out from the Stand, it may cause TV set to topple over, fall down, and cause personal injury or damage to the TV.



- Route all AC power cords and connecting cables so that they are not accessible to curious children.

Recommended Measures to Secure the TV
Consider the following measures when securing your TV to a Stand (not supplied).

- Secure the Stand for the TV.
Make sure the Stand can adequately support the weight of the TV. Use two angle braces (not supplied) to secure the Stand. For each angle brace use the appropriate hardware to:
 - Attach one side of the angle brace to the wall stud.
 - Attach the other side to the Stand.

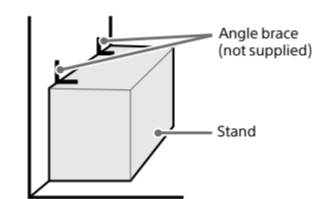

- Secure the TV to the Stand.
Use the optional hardware listed as follows (not supplied):
 - M6 machine screws (screwed into the TV's rear cover).
 - A screw or similar (attach it to the Stand).
 - Rope or chain (strong enough to support the weight of the TV). Make sure that there is no excess slack in the rope or chain.

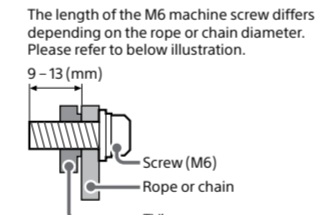
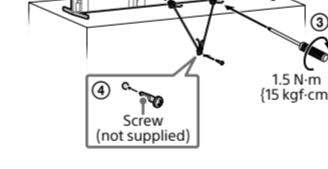
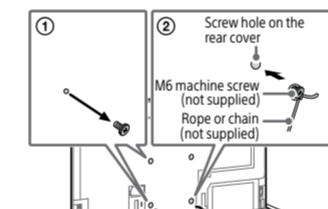

The length of the M6 machine screw differs depending on the rope or chain diameter. Please refer to below illustration.

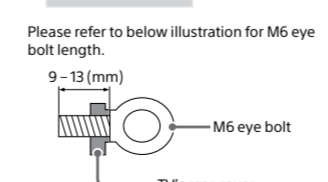
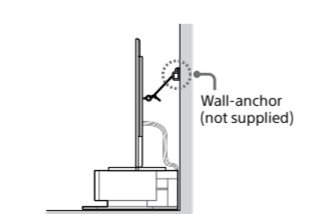
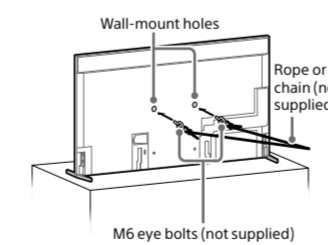

- Note
• Your TV is shipped with screws attached to the rear of the TV depending on the TV model. (They are fastened in the screw holes for wall mounting.) Be sure to remove the upper two screws prior to anchoring the TV to a wall.

- Securing the TV to the Stand without securing the TV and the Stand to the wall provides minimum protection against the TV toppling over. For further protection, be sure to follow the three measures recommended.

The BRAVIA® 4K TV Experience
Thank you for choosing Sony! Your new BRAVIA® TV opens the door to the "4K TV Experience". This document will help you get the most out of your TV.

This TV displays all video input signals in a resolution of 3840 dots × 2160 lines.

- Note
• For supported PC formats, refer to the online Help Guide.

- Guidelines for IR Remote Control
• Point your remote control directly at the IR sensor located on your TV.
• Make sure that no objects are blocking the path between the remote control and the IR sensor on your TV.

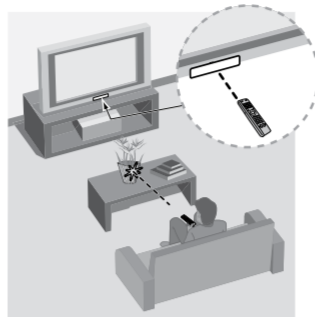

- Fluorescent lamps can interfere with your remote control; try turning off the fluorescent lamps.
- If you are having problems with the remote control, reinsert or replace your batteries and make sure that they are correctly inserted.

Installing the TV to the Wall

Using the optional Wall-Mount Bracket (SU-WL855 only)* (not supplied)

Wall-Mount Bracket Installation Information
For instructions on Wall-Mount Bracket installation, see the Installation Information (Wall-Mount Bracket) for your TV model.

- Follow the instruction guide provided with the Wall-Mount Bracket for your model. Sufficient expertise is required in installing this TV, especially to determine the strength of the wall for withstanding the TV's weight.
- Sony is not liable for any damage or injury caused by mishandling or improper installation.
- Be sure to store the unused screws and Table-Top Stand in a safe place until you are ready to attach the Table-Top Stand. Keep the screws away from small children.

- Note
• Read the supplied safety documentation for additional safety information.

* Only for limited region/country/model.

Using the optional Wall-Mount Bracket (Except SU-WL855) (not supplied)
This TV's instruction manual only provides the steps to prepare the TV for Wall-Mount installation before it is installed on the wall.

Your TV can be mounted to a wall using a suitable Wall-Mount Bracket (not supplied). If the Table-Top Stand is attached to the TV, the TV may require detaching the Table-Top Stand; see "Detaching the Table-Top Stand from the TV". Prepare the TV for the Wall-Mount Bracket before making cable connections.

For product protection and safety reasons, Sony strongly recommends that installation of your TV on the wall be performed by qualified professionals. Do not attempt to install it yourself.

- Follow the instruction guide provided with the Wall-Mount Bracket for your model. Sufficient expertise is required in installing this TV, especially to determine the strength of the wall for withstanding the TV's weight.
- The screws for installing the Wall-Mount Bracket to the TV are not supplied.
- Refer to the following table for wall-mount hole pattern.

Model Name	Wall-mount hole pattern
XR-85X93L / 85X93CL	400 × 400 mm
XR-75X93L / 75X93CL	300 × 300 mm
XR-65X93L / 65X93CL	300 × 300 mm

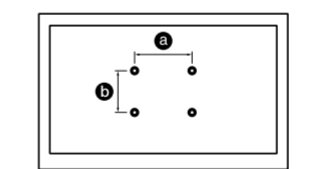

- Be sure to store the unused screws and Table-Top Stand in a safe place until you are ready to attach the Table-Top Stand. Keep the screws away from small children.

- Note
• Read the supplied safety documentation for additional safety information.

* Only for limited region/country/model.

- Remove the screws from the rear of the TV.

Specifications

System
TV system
NTSC: National Television System Committee
ATSC: 8VSB Terrestrial
NEXTGEN TV: ATSC 3.0 compliant (Single tuner)*1
QAM on cable: ANSI/SCTE 07 2000 (Does not include CableCARD functionality)
Channel coverage
Depending on your country/area selection/TV model
Analog terrestrial: 2 - 69 / Digital terrestrial: 2 - 69*2
Analog Cable: 1 - 135 / Digital Cable: 1 - 135
Panel system
LCD (Liquid Crystal Display) Panel, LED Backlight
Speaker output (W)
10 + 10 + 10 + 10 + 10 + 10
Wireless technology
Protocol IEEE 802.11a/b/g/n/ac
Bluetooth® Version 4.2

Input/Output jacks
CABLE/ANTENNA
75 ohm external terminal for RF inputs
HDMI IN 1/2/3/4 (HDCP 2.3-compatible)
Video:
4096 × 2160p (60 Hz)**4, 4096 × 2160p (24 Hz)**1, 3840 × 2160p (60 Hz)*4, 3840 × 2160p (24, 30 Hz), 1080p (24, 30, 60, 120 Hz), 1080i (60 Hz), 720p (24, 30, 60 Hz), 480p, PC Formats**5
3840 × 2160p (120 Hz)**4,6

Audio:
In eARC (Enhanced Audio Return Channel) mode
Refer to the online Help Guide for details. Except eARC mode
5.1 channel linear PCM: 32/44.1/48/88.2/96/176.4/192 kHz 16/20/24 bits, Dolby Audio, Dolby Atmos, DTS
eARC/ARC (Enhanced Audio Return Channel/Audio Return Channel) (HDMI IN 3 only)**7
In eARC mode
Refer to the online Help Guide for details. In ARC mode
Two channel linear PCM: 48 kHz 16 bits, Dolby Audio, Dolby Atmos, DTS

Ⓞ DIGITAL AUDIO OUT (OPTICAL)
Digital optical jack (Two channel linear PCM: 48 kHz 16 bits, Dolby Audio, DTS)

➡ 1, ⬅️ 2
USB port 1 supports High Speed USB (USB 2.0)
USB port 2 supports Super Speed USB (USB 3.2 Gen 1)

🌐 LAN
10BASE-T/100BASE-TX connector
(Depending on the operating environment of the network, connection speed may differ. The communication rate and quality are not guaranteed.)
Home Network supported files and formats**8

REMOTE
RS-232C mini jack, IR IN mini jack
These jacks are for receiving the external control signal.

Power and others
Power requirements
110 V - 240 V AC, 50/60 Hz (U.S.A./Canada 120 V AC, 60 Hz)
Power consumption
In use (W)
XR-85X93L / 85X93CL: 495
XR-75X93L / 75X93CL: 412
XR-65X93L / 65X93CL: 359
In standby**9,10
Less than 0.5 W with 120 V AC and less than 0.5 W with 240 V AC
Screen size (measured diagonally) (Approx.) (cm/inches)
XR-85X93L / 85X93CL: 214.8 / 84.6 (85" class)
XR-75X93L / 75X93CL: 189.3 / 74.5 (75" class)
XR-65X93L / 65X93CL: 163.9 / 64.5 (65" class)
Display resolution (horizontal × vertical) (pixels)
3840 × 2160
Output rating
500 mA (for USB 1), 900 mA (for USB 2)

Others
Optional accessories
Wall-Mount Bracket: SU-WL855 (XR-65X93L / 65X93CL only)
Camera and Microphone Unit: CMU-BC1
Operating temperature
0 °C - 40 °C / 32 °F - 104 °F

*1 Only for limited region/country/model.
*2 2 - 36 for NEXTGEN TV scanning range in U.S.A.
*3 When 4096 × 2160p is input and [Wide mode] is set to [Normal], the resolution is displayed as 3840 × 2160p. To display 4096 × 2160p, set [Wide mode] setting to [Full 1] or [Full 2].
*4 Refer to the on screen menu to set [HDMI signal format].
*5 Refer to the online Help Guide for details.
*6 HDMI IN 3 and 4 only. Use the Ultra High Speed HDMI Cable to connect.
*7 Connect your audio system to the HDMI IN 3 to route TV audio to your audio system.
*8 Specified standby power is reached after the TV finishes necessary internal processes.
*9 Standby power consumption will increase when your TV is connected to the network.

Note
• Optional accessories availability depends on countries/region/TV model/stock.
• Design and specifications are subject to change without notice.
• Subscriptions for services and applications may be required and additional terms, conditions and/or charges may apply when using Google Assistant.
• Power consumption will increase when the built-in MIC is enabled as it is always listening.

Licensing Information
• Dolby, Dolby Vision, Dolby Atmos, Dolby Audio, and the double-D symbol are trademarks of Dolby Laboratories Licensing Corporation. Manufactured under license from Dolby Laboratories. Confidential unpublished works. Copyright © 1992-2022 Dolby Laboratories. All rights reserved.
• Gracenote, the Gracenote logo and logotype, "Powered by Gracenote" logo are either registered trademarks or trademarks of Gracenote, Inc. in the United States and/or other countries.
• For DTS patents, see http://patents.dts.com. Manufactured under license from DTS, Inc. DTS, Digital Surround, and the DTS logo are registered trademarks or trademarks of DTS, Inc. in the United States and other countries.
© 2020 DTS, Inc. ALL RIGHTS RESERVED.
• TUXERA is a registered trademark of Tuxera Inc. in the US and other countries.

Troubleshooting
General troubleshooting for issues like: black screen, no sound, frozen picture, TV does not respond, or network is lost, do the following steps.
1 Restart your TV by pressing the power button on the remote control for about five seconds. The TV will restart. If the TV does not recover, try unplugging the AC power cord then press the power button on the TV for about 40 seconds until the TV turns off.
2 Refer to the Help menu shown below.
3 Connect your TV to the Internet and perform a software update. Sony recommends you to keep your TV software updated. Software updates provide new features and performance improvements.

4 Perform the factory data reset.
When you plug in the TV, the TV may not be able to turn on for a while even if you press the power button on the remote control or the TV.
It takes time to initialize the system. Wait for about one minute, then operate it again.

How to reset the TV to factory settings
WARNING: The reset will clear all of your customized settings including the parental lock setting.

- You can reset the TV to factory settings by selecting [Factory data reset]. How to select [Factory data reset], refer to the online Help Guide.
- To force factory data reset, unplug the AC power cord. Press and hold ⏪ button on the TV, then plug in the AC power cord.
- For security purposes, be sure to remove all personal and account information before discarding, selling or passing your TV to someone else by: unlinking/unregistering, signing out of and deactivating all network services as well as factory reset the TV.

The remote control does not function.
• Replace the batteries.

The parental lock password has been forgotten.
• Enter 4357 for the PIN and enter the new PIN.

For more information, refer to the Help Guide.
Press ⏪ (Input) on the remote control and select [Help]. If [Help] does not exist, select [Edit] and add [Help].

Setup Guide

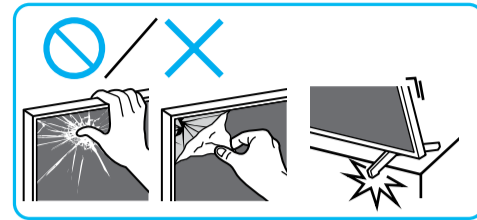
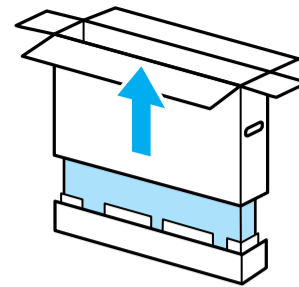

1

2

• Accessory type and quantity may vary depending on the model.

3

4

*1 Only for limited region/country/model.

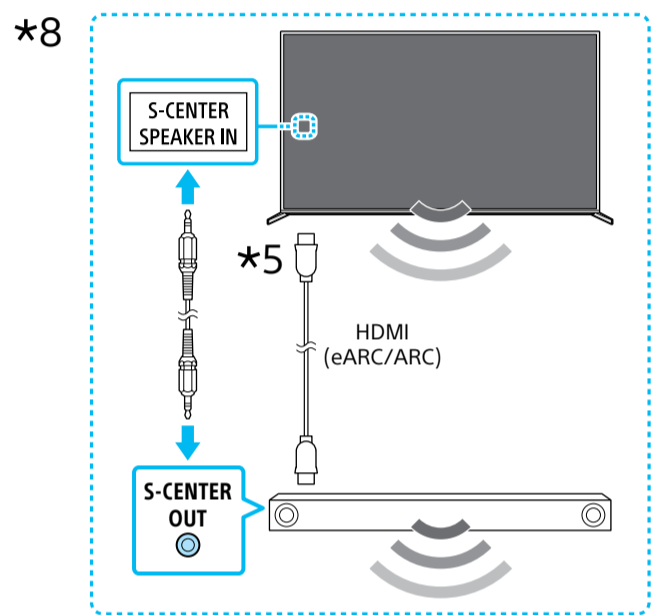
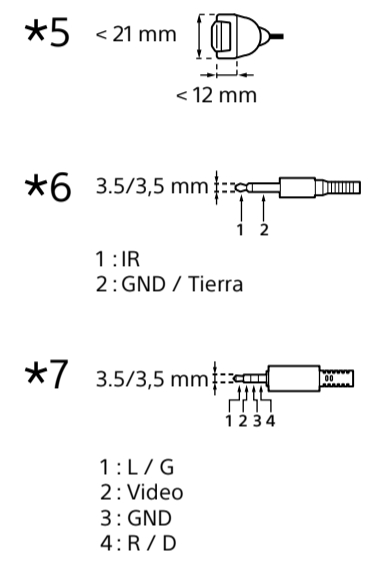
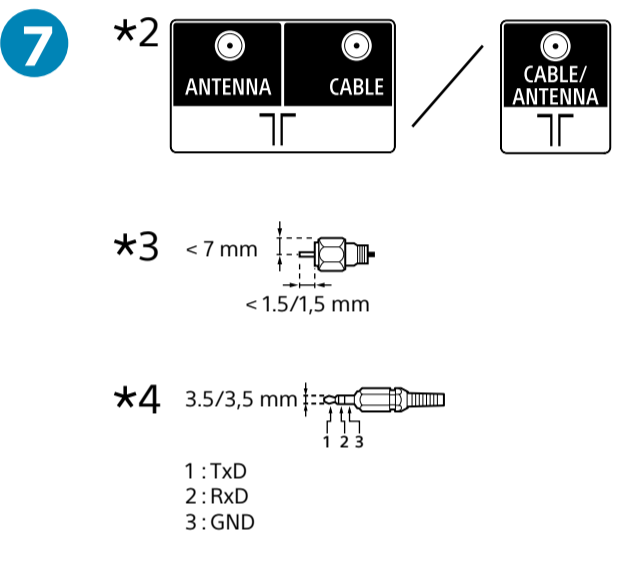
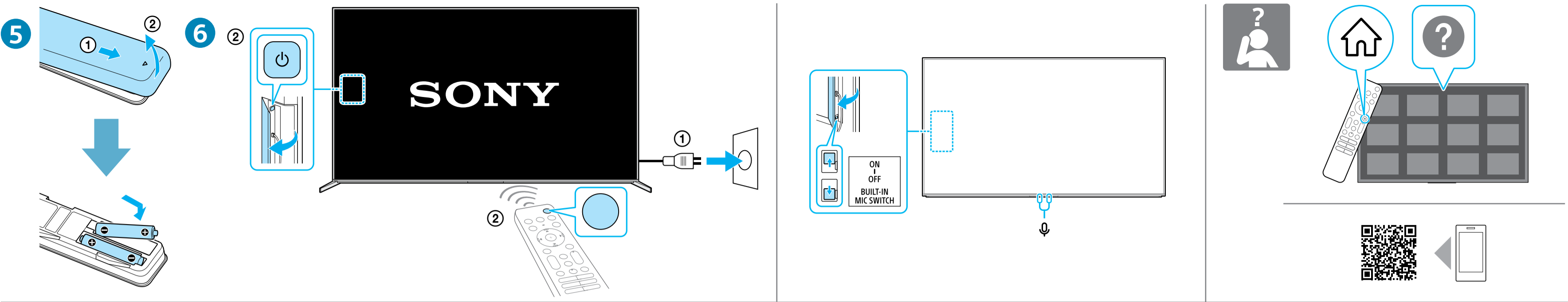

- Accessory type and quantity may vary depending on the model.
- The image shown here is for illustrative purposes only and may be subject to change.
- The remote control vary depend of model: The buttons on the remote control may have a different name or location than the remote control shows in this manual.
- The cables mentioned in this guide is not supplied with your unit.