

⚠️ IMPORTANT SAFETY INSTRUCTIONS

READ AND SAVE THESE SAFETY INSTRUCTIONS BEFORE USING THIS AIR PURIFIER

When using electrical appliances, basic precautions should always be followed to reduce the risk of fire, electric shock, and injury to persons, including the following:

1. Read all instructions before operating the air purifier.
2. Place air purifier where it is not easily overturned by persons in the household.
3. **ALWAYS** turn the air purifier controls to the **OFF** position and unplug from the wall outlet when not in use.
4. To disconnect the air purifier, make sure the unit is powered **OFF** then grip the plug and pull it from the wall outlet. **NEVER** pull by the cord.
5. **DO NOT** use any product with a damaged cord or plug, any product that malfunctions, or any product that has been dropped or damaged in any manner. Keep the cord away from heated surfaces.
6. **DO NOT** use air purifier outdoors.
7. **DO NOT** use air purifier unless it is fully assembled.
8. **DO NOT** run power cord under carpets, and **DO NOT** cover with throw rugs. Arrange cord such that it will not be a tripping hazard.
9. **DO NOT** use air purifier where combustible gases or vapors are present.
10. **DO NOT** expose the air purifier to rain, or use near water, in a bathroom, laundry area or other damp location.
11. The air purifier **MUST** be used in its upright position.
12. **DO NOT** allow foreign objects to enter ventilation or exhaust opening as this may cause electric shock or damage to the air purifier. **DO NOT** block air outlets or intakes.
13. Locate air purifier near the outlet and **DO NOT** use with extension cord or power strip.
14. This appliance has a polarized plug (one blade is wider than the other). To reduce the risk of electric shock, this plug is intended to fit only one way in a polarized outlet. If the plug does not fit fully in the outlet, reverse the plug. If it still does not fit, contact a qualified electrician. **DO NOT** attempt to defeat this safety feature.
15. A loose fit between the AC outlet (receptacle) and plug may cause overheating and a distortion of the plug. Contact a qualified electrician to replace loose or worn outlet.
16. **DO NOT** sit, stand or place heavy objects on the air purifier.
17. **ALWAYS** disconnect power supply before servicing.
18. Keep out of reach of children and pets.
19. Filters may be harmful if ingested. Avoid breathing dust when changing filters.
20. **SAVE THESE INSTRUCTIONS.**

For FCC compliance information, please see last page of this manual.

⚠️ WARNING: To Reduce The Risk of Fire or Electric Shock, Do Not Use This Air Purifier With Any Solid-State Speed Control Device.

GETTING TO KNOW YOUR AIR PURIFIER

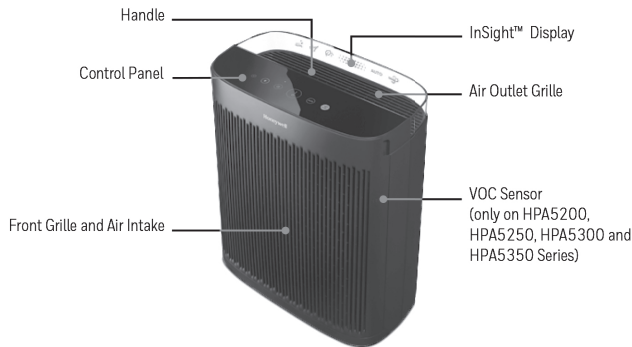

HPA5100,
HPA5150 &
HPA5220 Series
Control Panel

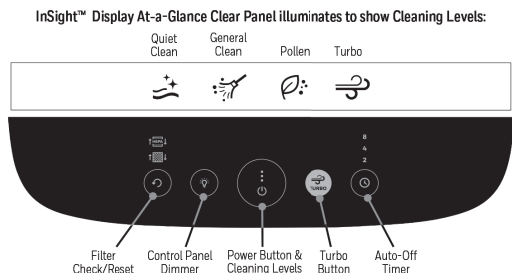

The images shown here are for illustrative purposes only and may be subject to change, the actual descriptions of control panel and their locations may vary depending on the model.

InSight™ Display At-a-Glance Clear Panel illuminates to show Cleaning Levels, Auto Mode and the Air Quality Indicator

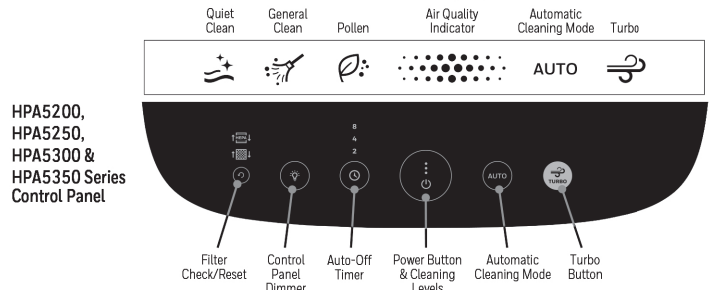

The Honeywell InSight™ Series Air Purifier delivers powerful HEPA filtration and features a cutting-edge design that provides valuable information from a distance.

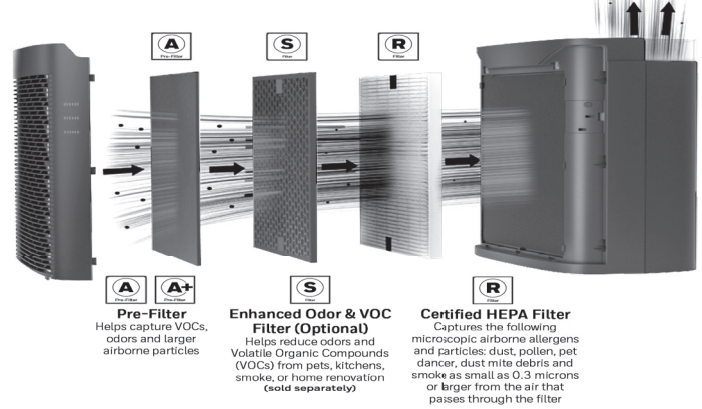

GETTING STARTED

1. Ensure that the unit is powered off and unplugged.
2. Select a firm, level, and flat location. Ensure the front of the unit faces away from the closest wall or furniture and that no grilles are blocked. Portable air purifiers are more effective in rooms where all doors and windows are closed.
NOTE: If the unit is placed on a light-colored carpet, a small mat or rug should be used underneath to prevent staining. This is especially important in homes with contamination from smoking, fireplaces, or where candles are burned.
3. Remove the front grille by grasping the sides of the grille and pulling forward. (Fig 1).
4. Remove the Pre-Filter and HEPA Filter(s) from the air purifier. Remove protective plastic wrap from filters. (Fig 2).
5. Place the Certified HEPA Filter(s) (R) back into the air purifier housing ensuring that the red removal pull tabs are facing outwards (this will facilitate filter removal later). (Fig 3).
6. If using the Optional Enhanced Odor and VOC Filter(s) (S) (sold separately), place in front of the HEPA Filters (R) with the removal pull tabs facing outwards. (Fig 4).
7. Place the Pre-Filter (A) in front of the HEPA Filter(s) (R), or if using, in front of the Optional Enhanced Odor and VOC Filter(s) (S) by securing the edges under the fasteners. (Fig 5).
8. Replace the front grille by placing the tabs on the bottom of the grille into the slots on the unit. Gently push the top of the grille until secure. (Fig 6).

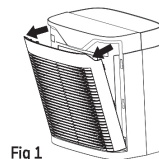

Fig 1



Fig 2

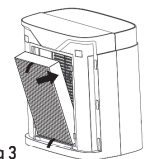

Fig 3

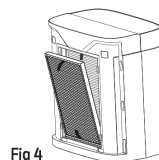

Fig 4



Fig 5

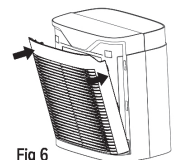

Fig 6

OPERATION



This product earned the ENERGY STAR label by meeting strict energy efficiency guidelines set by the U.S. EPA. Room air cleaners have demonstrated the potential for improving air quality and providing health benefits. EPA does not endorse manufacturer claims regarding the degree to which a specific product will produce healthier indoor air.

The energy efficiency of this ENERGY STAR certified model is measured based on a ratio between the model's CADR for Smoke and the electrical energy it consumes, or CADR/Watt.

- Ensure that the plastic wrap has been removed from the filters and the filters are replaced in the unit. Next, plug the power cord into a working electrical outlet.
- Tap Power Button to turn on the air purifier. The air purifier will start automatically on the Quiet Clean setting until another cleaning level is selected. Continue tapping to choose a different cleaning level. With each tap, one of the cleaning level icons will illuminate on the InSight Display.

QUIET CLEAN : quietest setting and optimized to capture small particles.

GENERAL CLEAN : recommended for dust and general, everyday air cleaning.

POLLEN : optimizes pollen capturing performance during pollen season.

- To shut off, tap the Power Button until the air purifier shuts off.



TURBO MODE

When Turbo mode is selected, the Turbo icon will illuminate on the InSight Display. This setting operates the air purifier at the highest cleaning level and maximizes its ability to help clean the air and help reduce odors and VOCs quickly. Tapping the Turbo button again will return the air purifier to the previous cleaning setting.



AUTOMATIC CLEANING MODE & AIR QUALITY INDICATOR

(only available in the HPA5200, HPA5250, HPA5300 and HPA5350 Series)

These select air purifier models are equipped with VOC Sensors that detect the level of VOCs in the room and provide a visual display to indicate air quality. The Air Quality Indicator color display is located on the InSight Display. The VOC Sensor is constantly monitoring the air and the Air Quality Indicator light will illuminate either green, yellow, or red depending on the level of VOCs detected in the room:

Green – Good air quality. There is a low level of VOCs detected.

Yellow – Moderate air quality. There is a moderate level of VOCs detected.

Red – Poor air quality. There is an elevated level of VOCs detected.

VOCs are gases that are emitted from certain household cleaning, home improvement, and even common home decor products.

When the Auto mode is activated, the air purifier will automatically operate at the appropriate cleaning level to reduce the VOCs that are detected in the room. To select this mode, tap the Auto button and the icon will illuminate on the InSight Display to indicate the setting has been activated.

NOTE: Upon start up, the unit may take a few minutes to calibrate and measure the air quality. During this time, the Air Quality Indicator will pulse between green, yellow, and red until the air quality is determined. When the appropriate reading is determined, the indicator will then remain a solid color.

8 AUTO-OFF TIMER

- 4** The Timer option allows you to select how long the air purifier will run before it automatically shuts off. There are three pre-set run times: 2, 4, and 8 hours. Do not use this option if you want the air purifier to run continuously. To set the timer, tap the Timer button until the desired setting (2, 4, or 8 hours) is illuminated. To exit the Timer mode, tap until the Timer button light shuts off.



CONTROL PANEL DIMMER

The Dimmer option allows you to adjust the brightness of the LEDs on the control panel and the InSight Display. This is helpful if you are looking to adjust the brightness depending on the time of day that the unit will be used. To adjust brightness, tap the Dimmer button once to dim the lights to LOW. Tap the button twice and it will shut the lights OFF. Please note that the dimmer button will remain on at 20% illumination and will not completely shut off so that the unit can be located in a dark room. All of the other lights will shut off. Tap the Dimmer button a third time to return the brightness to HIGH.



FILTER CHECK/RESET

These air purifier models each have two electronic filter checks to remind you when it is time to replace the Pre-Filter, Optional Enhanced Odor and VOC Filter(s), and HEPA Filter(s) based on the air purifier's hours of use. When it is time to replace the filters, one of the filter icon lights will illuminate above the Filter Check/Reset indicator light to identify which filter needs to be replaced at that time. For more detailed information, see the next section.

• The image shown here is for illustrative purposes only and may be subject to change.

• The images shown here are for illustrative purposes only and may be subject to change, the actual descriptions of control panel and their locations may vary depending on the model.

NOTE: In order to ensure the highest possible standard for refurbished items, all units are thoroughly inspected as part of the process.

For this item, water may be used during the refurbishing process and so; you may notice some condensation in the water reservoir. It is recommended to rinse the water reservoir with fresh water prior to its first use.

FILTER REPLACEMENT

When the Filter Reset indicator light(s) illuminate(s), it is time to replace one or more of the filters.

Indicator Light	Filter*	When to Replace	Number of Filters Needed
	Pre-Filter: Honeywell A or A+ Pre-Filter 	Every 3 months	1 Pre-Filter
	Optional Enhanced Odor & VOC Filter: Honeywell S Filter 		1 Enhanced Odor & VOC Filter for the HPA5100 & HPA5150 Series 2 Enhanced Odor & VOC Filters for the HPA5200, HPA5220 & HPA5250 Series 3 Enhanced Odor & VOC Filters for the HPA5300 & HPA5350 Series
	Honeywell HEPA R Filter 	Every 12 months	1 HEPA Filter for the HPA5100 & HPA5150 Series 2 HEPA Filters for the HPA5200, HPA5220 & HPA5250 Series 3 HEPA Filters for the HPA5300 & HPA5350 Series

*For specific filter models, reference the **Replacement Filters** section of this manual.

See the **Getting Started** section for filter replacement instructions.

To help ensure stated product performance, use only Certified Honeywell Replacement Filters.

These replacement intervals are intended as guidelines only. Performance of any filter media is dependent upon the concentration of particles going through the system. High concentrations of particles such as dust, pet dander, and smoke will reduce the useful performance of the filters.

NOTE: The Pre-Filter, Enhanced Odor & VOC Filter and HEPA Filters are NOT washable and should not be vacuumed.

DO NOT immerse the filters in water.

WARNING: Filters may be harmful if ingested. Avoid breathing dust when changing filters.

RESET FILTER CHECK INDICATOR

After you have replaced the appropriate filters, plug the unit back in. The Pre-Filter/Enhanced Odor and VOC Filter and/or HEPA Filter Reset Light will remain on until it is reset.



Pre-Filter and Enhanced Odor & VOC Filter Reset:

- With the unit powered off, press the **Filter Reset** button 2 times within one second. The Pre-Filter/Enhanced Odor & VOC Filter indicator light will blink twice to indicate the timer has been reset and will then turn off.



HEPA Filter Reset:

- With the unit powered off, press and hold the **Filter Reset** button for two seconds. The HEPA Filter indicator light will blink twice to indicate the timer has been reset and will then turn off.

CLEANING AND STORAGE

We recommend that you clean the air purifier at least once every 3 months and before extended storage. Use only a dry cloth to wipe the external surfaces of the air purifier.

DO NOT USE WATER, WAX, POLISH, OR ANY CHEMICAL SOLUTION.

If your Air Purifier will not be used for more than 30 days, we recommend that you:

- Remove the HEPA Filters from the unit.
- Wrap the HEPA Filters in an air tight plastic bag.
- Remove the Pre-Filter and Enhanced Odor and VOC Filters and place them in an air tight plastic bag.

FREQUENTLY ASKED QUESTIONS

My Air Purifier is starting to make noise and the air output is less. What's wrong?

The filters may be dirty. High amounts of particles can block the pores in the filter and stop the air from moving through it. Replace the Filters. The HEPA Filters should be replaced every year and the Pre-Filter and Enhanced Odor and VOC Filters should be replaced every 3 months. Please note these are guidelines only and filters should be checked periodically as individual home conditions may vary. To help ensure the unit is performing properly, replace with Certified Genuine Honeywell Filters.

How long should I run my Air Purifier?

In general, the unit will be most effective when doors and windows are closed. It is recommended that you run your air purifier while you are at home to help clean the air. If desired or conditions warrant, you may run your air purifier 24 hours a day.

Can I wash any of the filters in my Air Purifier?

No. Washing the filters will ruin them.

What are VOCs?

Volatile Organic Compounds (VOCs) are emitted from various solids and liquids such as paints, cleaning supplies, building materials, and permanent markers. Some of these compounds have higher concentrations indoors than outside.

Why did my Air Purifier suddenly turn on a higher setting? (only for the HPA5200, HPA5250, HPA5300 and HPA5350 Series)

Is the air purifier set to Auto Mode? If it is, the unit may have sensed a higher level of VOCs and has adjusted the cleaning level accordingly.

