

IMPORTANT SAFETY INSTRUCTIONS - FOR HOUSEHOLD USE ONLY

⚠ WARNING

To reduce the risk of fire, electric shock, injury, or property damage:

1. Do not put any object into openings. Do not use with any opening blocked; keep free of dust, lint, hair, and anything that may reduce air flow.
2. **DO NOT** modify the plug provided with the appliance. If the grounded plug does not fit fully into the outlet, reverse the plug. If it still does not fit, contact qualified electrician.
3. **DO NOT** force into outlet or try to modify it.
4. **DO NOT** pull, close door, or wrap around sharp edges or corners on the cord. To unplug, grasp the plug, not the cord. Keep cord away from heated surfaces.
5. To reduce the risk of fire or electric shock due to internal component damage, use ONLY Shark CarpetXpert/StainStriker formula in the correct tanks, as intended for use with this appliance. See Instructions below.
6. The areas around where you are cleaning may become wet, use care to avoid slipping and falling.
7. Use care when removing and reattaching the hand tool to the Spot Cleaner to avoid accidental activation of the cleaning solution.
8. **DO NOT** spray solution on your skin or in your eyes.
9. **DO NOT** fill solution tanks while installed on the appliance. Remove before filling.
10. **DO NOT** operate if there is any wetting of the exterior surfaces of the appliance. If the appliance is wet, dry with a cloth before use.
11. To reduce the risk of shock and unintended operation, turn off and unplug Spot Cleaner before any adjustment, cleaning, maintenance, or troubleshooting.
12. Before each use, carefully inspect each part for damage or wear. If a part is damaged or worn out, immediately discontinue use. **DO NOT** use if any part is damaged or if Spot Cleaner is not working as it should, has been dropped, left outdoors, or dropped into water.
13. **DO NOT** immerse or spray water on the body of the Spot Cleaner. To clean the surface, wipe with a dry cloth.
14. **DO NOT** allow to be used by children or as a toy. Close supervision is necessary when used near children.
15. **DO NOT** handle plug or Spot Cleaner with wet hands.
16. **DO NOT** use without the dirty water tank, clean solution tank, or filter in place.
17. Use only identical replacement parts. Only use Shark® branded filters and accessories.
18. If plugging unit into extension cord, ensure cord is no more than 50' to prevent damage to the motor.

19. **DO NOT** place Spot Cleaner on uneven surfaces.
20. **DO NOT** use to pick up:
 - a) Large objects
 - b) Hard or sharp objects (glass, nails, screws, or coins)
 - c) Large quantities of dust (e.g., drywall dust).
 - d) Smoking or burning objects (hot coals, cigarette butts, or matches)
 - e) Flammable or combustible materials (lighter fluid, gasoline, or kerosene)
 - f) Toxic materials (chlorine bleach, ammonia, or drain cleaner)
21. **DO NOT** use the following areas:
 - a) Poorly lit areas
 - b) Outdoor areas
 - c) Spaces that are enclosed and may contain explosive or toxic fumes or vapors (lighter fluid, gasoline, kerosene, paint, paint thinners, mothproofing substances, or flammable dust).
22. Do not leave appliance when plugged in. Unplug from outlet when not in use and before servicing.
23. Keep hair, loose clothing, fingers, and all parts of the body away from openings and moving parts.
24. Use extra care when cleaning on stairs.
25. **GROUNDING INSTRUCTIONS:** This appliance must be grounded. If it should malfunction or break down, grounding provides a path of least resistance for electric current to reduce the risk of electric shock. This appliance's cord has an equipment-grounding conductor and a grounding attachment plug. This appliance is for use on a nominal 120V circuit. Make sure that the appliance is connected to an outlet with the same configuration as the plug that is properly installed and grounded in accordance with all local codes and ordinances. No adapter should be used with this appliance.

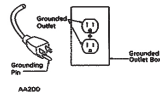

26. Do not store unit where temperatures reach freezing levels to avoid damaging internal parts.
27. First aid keep out of reach of children. Causes skin and serious eye irritation. If in eyes, rinse continuously with water for minutes. Remove contact lenses if present and easy to do so. Continue rinsing. If on skin, wash with soap and water. If skin and eye irritation persists, seek medical attention.
28. Please recycle container. Dispose of contents/container with licensed waste disposal site in accordance with the requirements of the local waste disposal authority. Do not dispose in drains or watercourses in concentrate form.

SAVE THESE INSTRUCTIONS.
READ ALL INSTRUCTIONS BEFORE USING THIS SPOT CLEANER.

GETTING STARTED WITH YOUR SPOT CLEANER

IMPORTANT: Vacuum with traditional vacuum cleaner first before using Spot Cleaner.

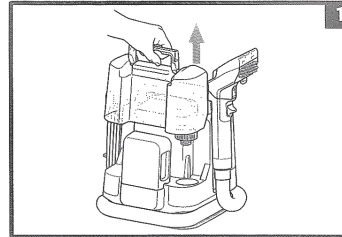

1. Lift CarpetXpert Tank by the handle to detach it, then remove the cap.

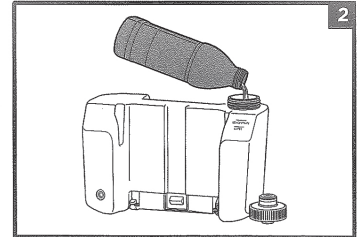

2. Add water to the CarpetXpert Tank up to the Water fill line. Then add Shark Deep Clean Pro Formula to the Concentrate fill line. Do not use water hotter than 140°F (60°C).

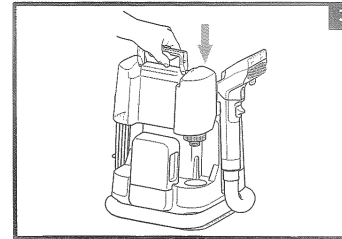

3. Reattach the cap, then reinstall the tank until it clicks into place.

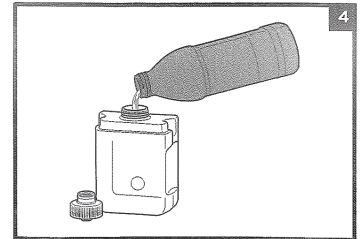

4. Lift StainStriker Tank by its sides to remove it, and fill with Shark OXY Multiplier. Replace the cap and tighten it.

Tip: For smaller stains, use the Hand Tool Attachment. For larger areas, use the Attachment.

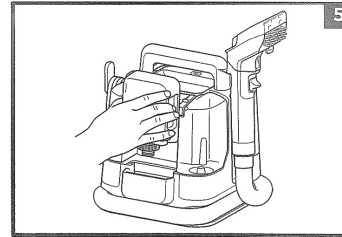

5. Reinstall the StainStriker tank until it clicks into place.

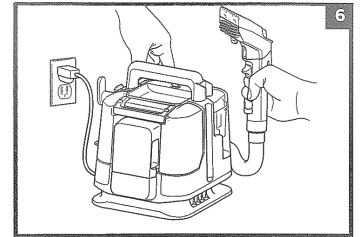

6. Attach hand tool of your choice to the crevice tool. Plug the power cord into an electrical outlet and unwrap the hose. Turn ON unit to begin cleaning. Combining both formulas will give you the best stain cleaning results.

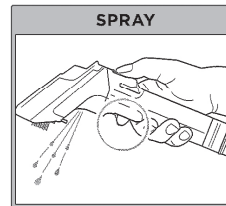

For Wet Stains, follow the Stain Guide located on the hand tool. Turn ON using the power button and vacuum up the liquid mess. Spray the stain area. Scrub stain with the bristles, then tilt hand tool forward and drag across stain area to extract liquid. Repeat if needed. To avoid longer dry times, do not over spray.

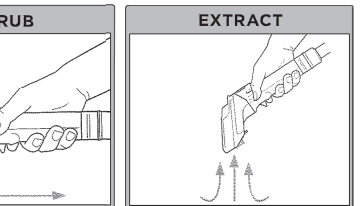
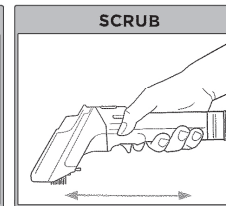

For Dry Stains, follow the Stain Guide located on the hand tool. Turn ON using the power button. Scrub stain with bristles, extract liquid and then spray the stain area. Scrub stain again, then tilt hand tool forward and drag across stain area to extract liquid. Repeat if needed. To avoid longer dry times, do not over spray.

Tips

1. For cleaning softer fabrics and easy ability to clean hair and debris from bristles, use the rubber side of the Reversible Bristles.
2. To rinse carpet or upholstery after cleaning, remove or empty the StainStriker tank and fill the CarpetXpert tank with water ONLY before spraying.

• Accessory type and quantity may vary depending on the model.

• The image shown here is for illustrative purposes only and may be subject to change.

MAINTENANCE

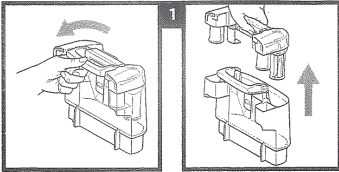

1. When the Dirty Water Tank is full, there will be a change in sound as the float valve closes. Switch off the unit and detach the tank, making sure to keep it upright to prevent spills. Pull the handle back, then lift off the lid. Pour out the contents into a sink or toilet.

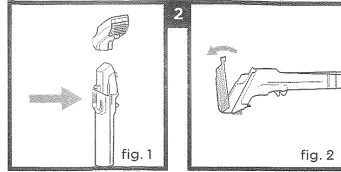

2. Remove the hand tool from the hose by pressing the Detach Button (fig. 1). To clean the airpath in the tool, open the cover (fig. 2). Aim the hand tool into a sink or toilet and press the spray trigger to release remaining pressure.

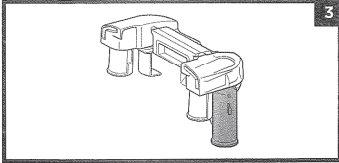

3. Clean the float valve by rinsing with water under a tap. Make sure it can move freely.

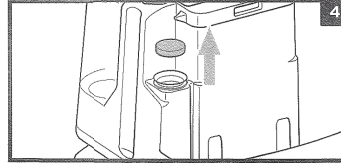

4. Remove the Dirty Water Tank. Clear off any debris from the foam filter by rinsing it under a faucet. Allow the filter to air-dry completely, then reinstall it.

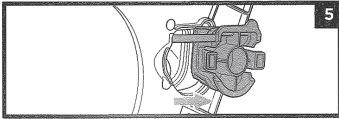

5. To clear any clogged debris at the end of the hose, open the hose clog door on the bottom of the unit. Clear all debris, then close the door.

NOTE: Clean unit after every use to avoid odors, bacteria, and mold.

CLEANING THE HOSE

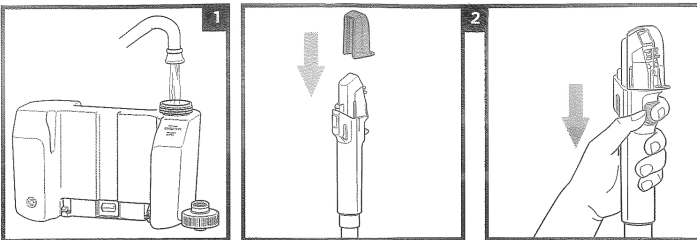

1. Make the sure the unit is turned off and remove the CarpetXpert Tank. Fill tank with water up to the Water fill line. Tip: Add Deep Clean Pro to eliminate odor.

2. Securely attach the Hose-Cleaning Tool to the Crevice Tool and turn ON power. Pull the trigger and cleaning solution will be sucked into the hose to clean the interior.

STORAGE

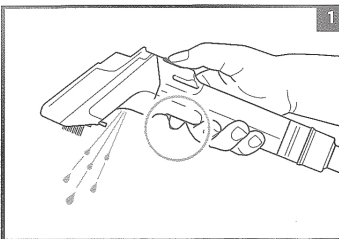

1. Before storing, follow Maintenance and Cleaning Instructions above. Be sure to release all pressure from the hand tool by placing it over a sink or toilet and pressing the spray trigger until all liquid has been released. Lay out all attachments to dry.

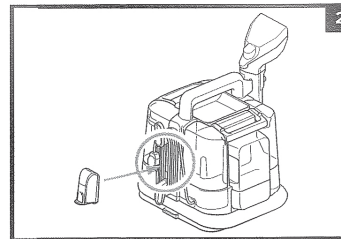

2. Once dry, reattach all tools. Wrap up the power cord, then store the hose-cleaning tool on the unit. Wrap the hose around the base of the unit and store the hand tool in its holder.

TROUBLESHOOTING

Problem	Solution
Inconsistent spray or no spray	Ensure there is cleaning formula in the CarpetXpert tank. Make sure the CarpetXpert tank is installed correctly. Make sure the unit is plugged in and the power is on.
Low suction or no suction	Make sure the dirty water tank is not overfilled. Check the clog access door and clear any debris trapped inside at the end of the hose. If a cleaning tool is attached, make sure it is connected correctly. Remove any debris from the cleaning attachments. Make sure the dirty water tank is installed correctly.
Unit not turning on	Make sure the unit is plugged in completely. Try a different outlet. Make sure the On/Off switch is turned on.
Liquid leaking from unit	The dirty water tank may be overfilled. Make sure the dirty water tank and the formula tank are both installed correctly. Make sure the float valve in the dirty water tank is not stuck. Make sure the unit is on a stable, flat surface. Make sure the hose clog door is closed completely underneath the unit.
Solution tank leaking	Make sure the cap on the CarpetXpert tank is tightened fully. Make sure the CarpetXpert tank is installed correctly and that the valve is in the tank.
Leaking from hand tool	Ensure inside of Hand Tool or Pet Mess Tool is thoroughly clean.
Tanks not dispensing liquid	Ensure CarpetXpert tank and StainStriker tank are both installed correctly. Note: Tanks dispense at different rates. CarpetXpert tank will run out of solution before the StainStriker Tank.

CLEANING FORMULAS



Deep Clean Pro Formula

The best deep carpet cleaning formula for removing dirt & grime.



OXY Multiplier

The best tough stain-eliminating formula for those stubborn stains and odors.

TECHNICAL SPECIFICATIONS

PX200 Series: 120V, 60Hz, 3.3A

• Illustrations may differ from actual product. We are constantly striving to improve our products; therefore the specifications contained herein are subject to change without notice.

PRINTED IN MEXICO Elbrd: J.E. SC: 03-27-2024 TAB
OBPN: PX200Series_IB_MP_Mv20_230615 SHNMDL: PX200_B

8 1 4 1 0 0 2 0 1



Please be sure to read the enclosed Shark® Owner's Guide prior to using your unit.

QUICK START GUIDE

1 WHAT'S INCLUDED

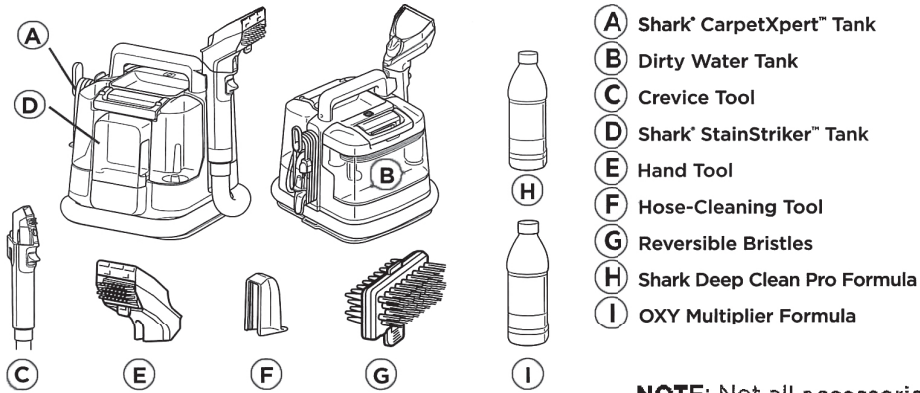

2 FILLING THE TANKS

1. Add water to CarpetXpert tank (A) up to the Water fill line. Then add Shark Deep Clean Pro formula up to the Concentrate fill line.
2. Fill StainStriker tank (D) with 1 bottle of Shark StainStriker OXY Multiplier formula.
3. Reinstall both tanks until they click into the unit.

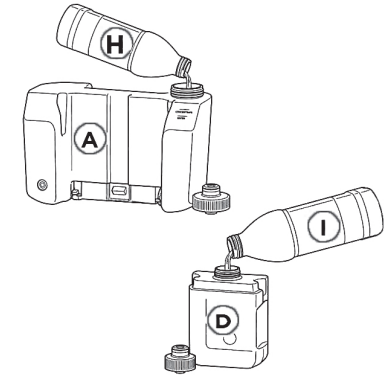

NOTE: Not all accessories come with all units. Tools may vary by model.

3 USING THE STAINSTRIKER

1. Turn ON unit, aim nozzle at the stain, and press the spray trigger underneath the hand tool.
2. Use bristles on the hand tool to work StainStriker into carpet/upholstery.
3. Tilt nozzle forward and drag across surface to extract liquid.

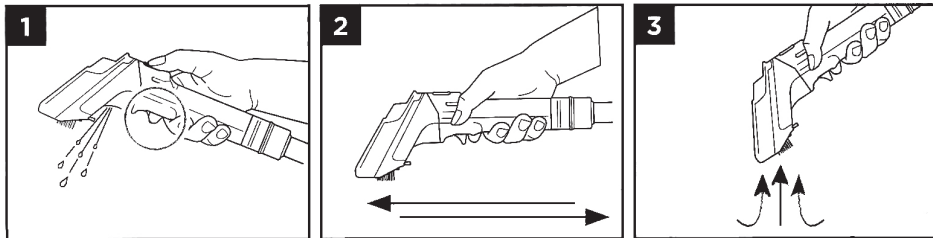

4 CLEANING THE DIRTY WATER TANK

1. Detach the Dirty Water Tank. **KEEP TANK UPRIGHT TO PREVENT SPILLS!**
2. Pull the handle back, then lift off the lid.
3. Pour out contents, clean the tank, and dry it thoroughly.
4. Insert the lid back on and flip the handle back to lock lid.

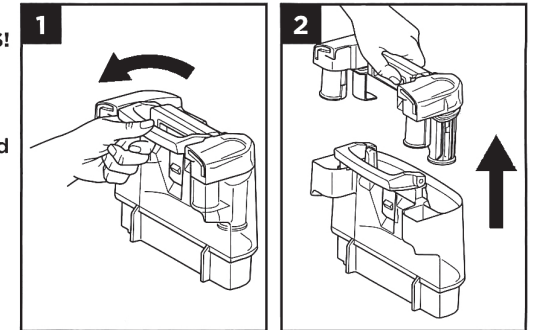

• Accessory type and quantity may vary depending on the model.

• The image shown here is for illustrative purposes only and may be subject to change.

Crevice Tool - Best for removing stains in tight spaces and spraying directly on the stain.

Hand Tool - Excellent for cleaning small stain areas on carpet and upholstery.

Hand Tool - Great for cleaning larger stain areas.

PRINTED IN MEXICO Elbrd: J.E. SC: 03-27-2024 1P

OBPN: N/A SHNMDL: PX200_B

8 1 4 0 0 0 2 0 1

