



804109969A

Please read this manual carefully before operating your unit and retain for future reference.

AN Series

PORTABLE AIR CONDITIONER

Instructions for use. Keep these instructions

ELECTRIC CHARACTERISTICS

115V~60 Hz



Important safeguard

- The appliance is not intended for use by persons (including children) with reduced physical, sensory or mental capabilities, or lack of experience and knowledge, unless they have been given supervision or instruction concerning use of the appliance by a person responsible for their safety.
- Children should be supervised to ensure that they do not play with the appliance.
- If the SUPPLY CORD is damaged, contact service center or similarly qualified persons in order to avoid a hazard.
- The appliance shall be installed in accordance with national wiring regulations.

As the appliance is powered by electricity, the possibility of electrical shock cannot be excluded. The following safety precautions must therefore be followed:

- After removing the packaging, check the condition of the appliance. If in doubt, do not use the appliance and contact service center.
- Before use, always check the condition of the power cord.
- It is dangerous to modify or alter the characteristics of the appliance in any way.
- This appliance must be connected to an efficient "grounding" system. Have the electrical system checked by a qualified electrician.
- Before each cleaning or maintenance operation, always disconnect the plug from the power outlet.
- Never submerge the appliance in water.
- Do not use the appliance outdoors.
- Do not obstruct the entrances and exits of air.
- When the appliance is connected to the mains, keep the following safety rules in mind:
 - Do not touch the appliance with wet or damp hands;
 - Do not use the appliance with bare or wet feet;
 - Do not pull on the power cord or appliance to detach the plug from the power outlet;
 - Do not move the appliance by pulling the power cable.
- keep the appliance far from the reach of children;
- Do not insert foreign bodies into the appliance;
- Do not insert metal objects into the apertures. Danger! Rotating parts; contact with the internal fan could cause electric shock or injury.
- do not leave the appliance exposed to atmospheric agents;
- If you wish to permanently eliminate the appliance, after disconnecting the plug from the power outlet it is recommended to make it unusable by severing the power cord.
- In the event of a fault and/or malfunction, turn the appliance off without tampering with it. Contact service center.
- Avoid the use of power cord extensions.

1.1 Designated use

This appliance must be used exclusively in domestic environment and for the intended purpose for which it was designed. All other uses are considered improper and therefore hazardous. The manufacturer shall not be held liable for any damage caused by improper, erroneous and irresponsible use, and/or due to repairs made by unqualified personnel.

1.2 Installing the appliance

- The appliance must be installed in compliance with national standards regulating electrical systems.
- Do not operate your air conditioner in a wet room such as a bathroom or laundry room.
- Do not install the appliance in rooms containing gas, oil or sulphur or near sources of heat.
- Do not use the appliance on sloping surfaces.
- Keep the appliance at least 20" (50 cm) away from flammable substances (alcohol, etc.) or pressurized containers (e.g. aerosol cans).
- Do not rest objects on top of the appliance.
- When transporting, the appliance must be kept upright. If this is not possible secure the unit at an angle, do not lie it horizontally.
- Before transporting the unit, drain the unit.
- After transportation, wait at least 6 hours before switching the unit on.

1.3 Enviromental information

- The materials used for packaging can be recycled. You are therefore recommended to dispose of them in special differentiated waste collection containers.

Specific information regarding appliances with R32 refrigerant gas

- Thoroughly read all of the warnings.
- When defrosting and cleaning the appliance, do not use any tools other than those recommended by the manufacturing company.
- The appliance shall be stored in a well-ventilated area;
- The appliance shall be stored in a room without continuously operating open flames (for example an operating gas appliance) and ignition sources (for example an operating electric heater).
- Do not burn any part of the appliance.
- Refrigerant gases can be odorless.
- This appliance contains R32 refrigerant gas. (For more details on the refrigerant, see back cover).
- Do not puncture any part of the refrigerant circuit.
- The servicing shall be performed only as recommended by the manufacturer.
- The appliance must be stored in a safe place in order to prevent damage to the unit.

- Individuals who operate or work on the refrigerant circuit must have the appropriate certification issued by an accredited organisation that ensures competence in handling refrigerants according to a specific evaluation recognized by associations in the industry.
- Repairs must be performed based on the recommendations from the manufacturing company. Maintenance and repairs that require the assistance of other qualified personnel must be performed under the supervision of an individual specified in the use of flammable refrigerants.

1. GENERAL INFORMATION

1.1 Instruction for Use

Read all the Instruction for Use carefully before using the appliance. Failure to follow this Instruction for Use may result in burns or damage to the appliance. The manufacturer is not liable for damage deriving from failure to respect this Instruction for Use. WARNING: Changes or modifications not expressly approved by the party responsible for compliance could void the user's authority to operate the equipment.

1.2 Installing the appliance

- The appliance must be installed in compliance with national standards regulating electrical systems.
- Do not operate your air conditioner in a wet room such as a bathroom or laundry room.
- Do not install the appliance in rooms containing gas, oil or sulphur or near sources of heat.
- Do not use the appliance on sloping surfaces.
- Keep the appliance at least 20" (50 cm) away from flammable substances (alcohol, etc.) or pressurized containers (e.g. aerosol cans).
- Do not rest objects on top of the appliance.
- When transporting, the appliance must be kept upright. If this is not possible secure the unit at an angle, do not lie it horizontally.
- Before transporting the unit, drain the unit.
- After transportation, wait at least 6 hours before switching the unit on.

1.3 Enviromental information

- The materials used for packaging can be recycled. You are therefore recommended to dispose of them in special differentiated waste collection containers.

Please note:

These safety warnings are valid for all De'Longhi air conditioners.

If the appliance is passed to other persons, they must also be provided with this Instruction for Use. This appliance is fitted with a special safety device. When the compressor switches off, this device prevents it from switching on again for at least 3 minutes.

2. BEFORE USE

Important!

Store the packaging material (plastic bags, styrofoam) far from the reach of children. CHOKING HAZARD. The appliance might contain small parts. Some of those small parts might be required to get disassembled during cleaning and maintenance operations. Handle with care and keep small parts out of reach of children.

2.1 Checking the appliance

After removing the packaging, make sure the product is complete and undamaged and that all accessories are present. Do not use the appliance if it is visibly damaged, contact service center.

Save these instructions This product is for household use only

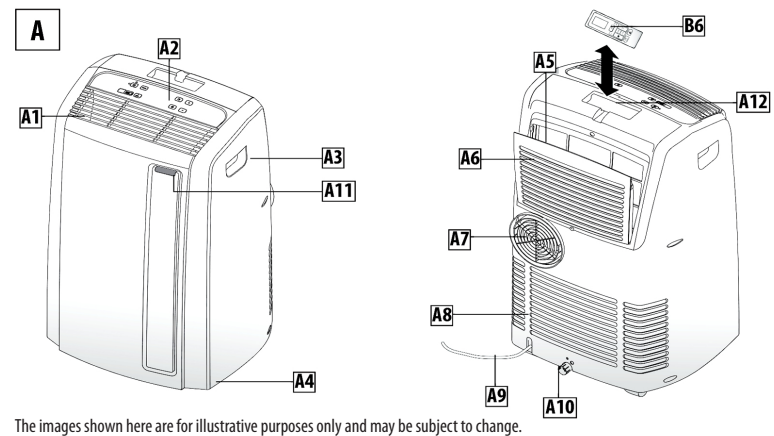

The images shown here are for illustrative purposes only and may be subject to change.

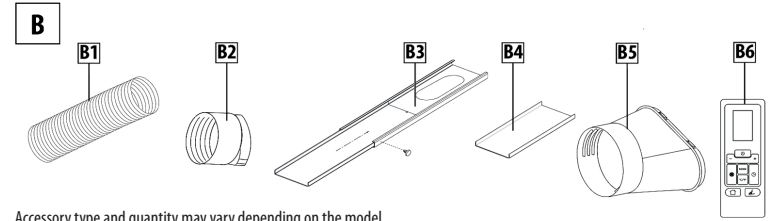

Accessory type and quantity may vary depending on the model.

INTRODUCTION

DESCRIPTION

Description of the appliance

- A1 air outlet grille
- A2 control panel
- A3 handles
- A4 castor wheels
- A5 BioSilver filter
- A6 air intake grille
- A7 air exhaust hose housing
- A8 air intake grille
- A9 power cable
- A10 drainage hose with 2 caps
- A11 remote control signal receiver
- A12 remote control compartment

Description of the accessories

- B1 air exhaust hose
- B2 hose adaptor
- B3 window bracket with pins
- B4 additional window bracket
- B5 window outlet
- B6 remote control (Batteries not included)

Electrical connection

- Before plugging the appliance into the outlet, check that:
- The outlet's power supply corresponds to the value indicated on the rating label on the back of the appliance;
 - The outlet and electrical circuit are adequate for the appliance;

- The outlet is a 3-hole grounded outlet (⏏). If this is not the case, you must choose another outlet. Failure to follow these important safety instructions absolves the manufacturer of all liability.
- If it becomes necessary, the power cable must be replaced by a qualified professional only.**

The instructions below will enable you to prepare your air conditioner for operation as efficiently as possible. Before use, make sure the air intake and outlet grilles are unobstructed.

USE

NOTE:

This appliance is provided with an auto-evaporation feature for condensate removal during cooling and dehumidifying modes.

AIR CONDITIONING WITH INSTALLATION

For optimal results set up your appliance in this way:

- Screw the hose adaptor B2 to the hose's end B1.
- Fit the air exhaust hose B1 in the housing at the back of the appliance. Insert it as shown in figure 1.

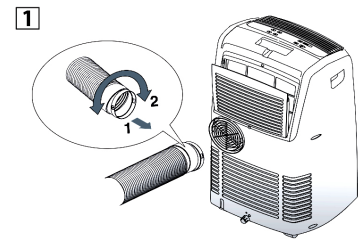

- Respect the distances given in figure 2 below.

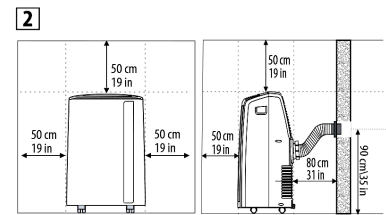

Proceed as follows:

- Drill a hole ø 5,25 inches (134 mm) in an outside wall or through a window panel. (suggested minimum height 14 inches, 35 cm)
- Respect the dimensions and height of the hole given in figure 2 and 3.

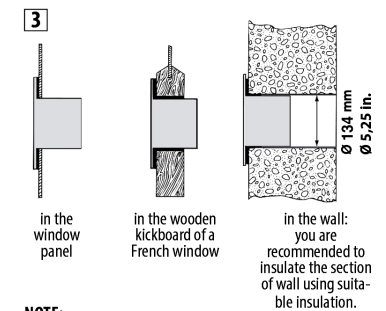

NOTE:

- As special tools are required for installation, we suggest you have the appliance installed by specialized personnel.

- When installing the air conditioner, you should leave a door slightly open as little as 1/2" (1 cm) to guarantee correct ventilation and room pressure.
- Keep the air hoses as short and free of curves as possible to avoid constrictions.

AIR CONDITIONING WITHOUT INSTALLATION

You can also set up in a double-hung window:

- Place the window bracket in the window sill, extend the bracket fully within the window frame, fix the bracket by using the pin then lower the window onto the bracket. (Should the window bracket be too large for the window the plastic can be cut with a saw by a qualified professional)
- Screw the hose adaptor B2 to the hose's end B1.
- Fit the air exhaust hose B1 in the relevant housing located on the rear side of the appliance (fig. 1).
- Connect the window outlet B5 to the other end of the exhaust hose.
- Insert the window outlet end of the exhaust hose into the slot of the window bracket (fig. 4).

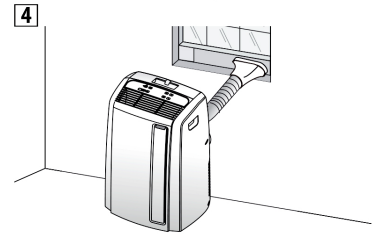

Other set up methods:

- Thanks to the locking pins, it's possible to use the window bracket also for sliding windows. Position the hole of the bracket so to allow a correct installation of the exhaust hose (see figure 5).

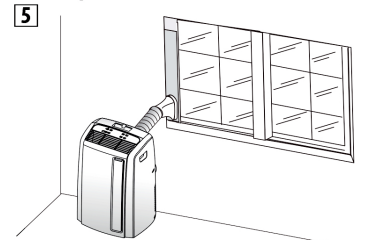

If you have a casement window (figure 6) proceed as follows:

- Screw the hose adaptor B2 to the hose's end B1.
- Fit the air exhaust hose B1 in the relevant housing located on the rear side of the appliance (fig. 1) then, place the window outlet B5 outside the window to exhaust the hot air.

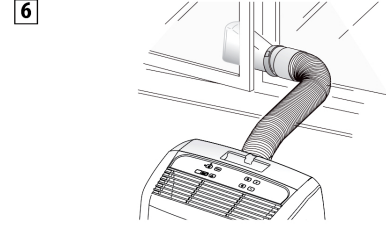

DESCRIPTION OF THE CONTROL PANEL (C)

- C1 ON/STAND-BY button
- C2 Mode selection key (air conditioning, dehumidifying, fan)
- C3 Timer button
- C4 Increase temperature/programmed operation time button
- C5 Decrease temperature/programmed operation time button
- C6 Fan speed selection button (LOW/MED/HIGH/AUTO)
- C7 ARCTIC WHISPER selection button
- C8 REAL FEEL selection button
- C9 REAL FEEL light
- C10 Air conditioning symbol
- C11 Dehumidifying symbol
- C12 Fan symbol
- C13 Timer symbol
- C14 Alarm symbol
- C15 REAL FEEL symbol
- C16 ARCTIC WHISPER symbol
- C17 Temperature display, programmed delayed ON/OFF time
- C18 Fan speed indicator
- C19 Timer hour indicator
- C20 Selected temperature scale indicator

Note: The panel buttons are backlit but only the buttons relevant to the available function will be on. After few seconds of the control panel inactivity, its brightness will be automatically reduced and in the next few minutes it will dim further.

OPERATING FROM THE CONTROL PANEL

TURNING THE APPLIANCE ON/OFF



Before plugging in the appliance, check that the cap on the back of the unit is correctly inserted on the drainage hose A10

Plug the appliance into the outlet. Two lines appear on the display indicating that the appliance is in stand-by and the buttons ⏏ and ⌚ light on.

Touch ⏏ button (C1) to switch the appliance on.

When turned on, the air conditioner starts operating in the same mode as when it was turned off.

Note: If you don't switch on the appliance, after a few minutes, the ⏏ and ⌚ buttons switch off and the display fades to reduce energy consumption.

To turn off the appliance, touch the ⏏ button. Only after that the appliance can be unplugged.

Note: Never switch off the appliance by unplugging it: always touch the ⏏ button first then wait a few minutes and then unplug. By doing so, the appliance will run a check of the operating systems

REAL FEEL FUNCTION



REAL FEEL is the innovative De'Longhi technology that works simultaneously on temperature reduction and humidity control, securing the best comfort level.

With traditional systems, during working time, optimal comfort conditions may be reached but not secured over time. With REAL FEEL, once optimal comfort is reached, the unit automatically modulates the compressor and fan speed.

To activate the function, touch REAL FEEL button.

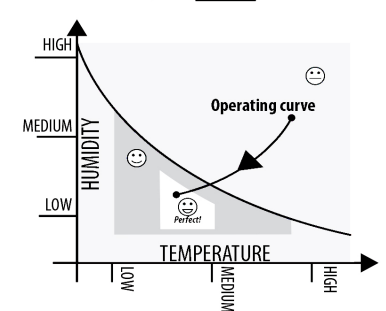

CONTROL PANEL

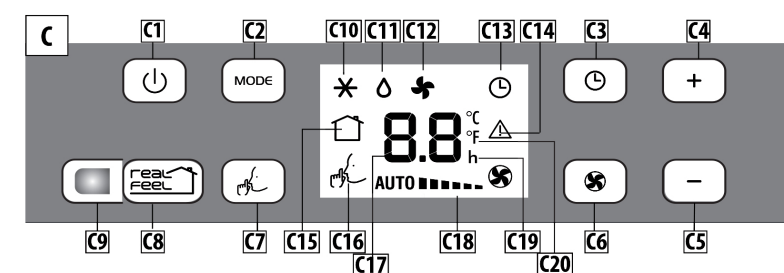

Note: The images shown here are for illustrative purposes only and may be subject to change, the actual descriptions of control panel and their locations may vary depending on the model.

REAL FEEL light (C9) changes color when approaching the best comfort level (see following diagram).

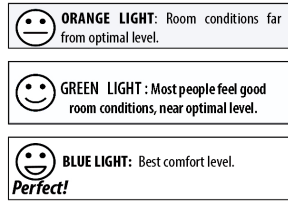

- The well being feeling is a subjective condition. For this reason, different people may judge differently the same environmental conditions.
- In particularly severe environmental conditions (high temperature or humidity outside, poor insulation, too many people, high heat in the room, strong exposure to the sun, ...) this device may not be able to reach the best comfort level.

AIR CONDITIONING MODE



When using the appliance in this mode, the air exhaust hose (B1) has to be connected.

It is ideal for hot, muggy weather when you need to cool and dehumidify the room. To set this mode:

- Touch repeatedly the **MODE** button until the air conditioning symbol (C10) is displayed: the display shows the desired temperature.
- Touch + (C4) or - (C5) buttons to adjust the desired temperature.
- Select the fan speed by touching the (C6).

You can choose:

- Minimum speed:** for quiet operation.
- Medium speed:** reduces noise level while maintaining a comfortable temperature.
- Maximum speed:** to achieve the target temperature as rapidly as possible.

AUTO the appliance automatically selects the most suitable fan speed in relation to the temperature set and current room temperature.

The most suitable temperature for the room during the summer varies from 75°F to 81°F (24 to 27°C). You are recommended, however, not to set a temperature much below the outdoor temperature.

ARCTIC WHISPER (available in air conditioning mode only)



By activating this function, the operating noise is further reduced. To activate it, touch the (C7) button. The display shows the corresponding symbol (C16).

DEHUMIDIFYING MODE



Ideal to reduce room humidity (spring and autumn, damp rooms, rainy periods, etc). In dehumidifying mode, the appliance **MUST** be set-up in the same way as for air conditioning, with the air exhaust hose (B1) attached to enable the moisture to be discharged outside. To set this mode:

- Touch repeatedly the **MODE** button until the dehumidifying symbol (C11) is displayed.

FAN MODE



When using the appliance in this mode, the air exhaust hose (B1) does not need to be connected.

To set this mode:

- Touch repeatedly the **MODE** button until the fan symbol is displayed.
- Select the fan speed by touching the (C6).

You can choose:

- Minimum speed:** for quiet operation.
- Medium speed:** reduces noise level but still maintains a good level of comfort.
- Maximum speed:** for maximum fan power.

CHANGING TEMPERATURE SCALE



The temperature can be displayed in °F or °C. To change the temperature scale, turn off the unit by touching the button, then press and hold the **MODE** button for approximately 20 seconds. The appliance emits a sound to confirm.

SETTING THE TIMER



The timer can be used to delay appliance start up or shutdown. This avoids wasting electricity by not operating the appliance when it is not needed.

How to program delayed start up

- Plug the appliance into the outlet and turn the unit to standby.
- Touch the timer button (C3): the timer symbol (C13) and the number of hours come on.
- Use the + (C4) or - (C5) buttons to set the number of hours delay before the appliance comes on.
- A few seconds after, the setting is memorized, the timer symbol is lit and the display shows that the appliance is in standby.

The appliance will restart using the mode previously set.

The appliance can be set to come on within the next 24 hours. To delete the setting, touch two times the timer button (C3). The timer symbol (C13) switches off.

How to program delayed shutdown

- With the air conditioner on, in any mode, it is possible to set the delayed shutdown.
- Touch the Timer (C3) button: the timer symbol (C13) and the hours switch on.
- Use the + (C4) or - (C5) buttons to set the number of hours delay before the appliance turns off.
- A few seconds after, the setting is memorized, the timer symbol is lit and the display shows the current mode.

At the end of the set time the appliance automatically turns to standby mode. To delete the timer setting, touch the timer button twice (C3). The timer symbol (C13) switches off.

OPERATING FROM THE REMOTE CONTROL

USING THE REMOTE CONTROL

- Point the remote control at the receiver **A11** on the air conditioner. The remote control must be no more than 16 ft (5 metres) away from the appliance (without obstacles between the remote control and the receiver).
- The remote control must be handled with extreme care. Do not drop it or expose it to direct sunlight or sources of heat.

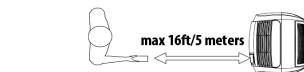

NOTE: The remote control can be safely stored in the appropriate compartment A12 (see figure A).

DESCRIPTION OF THE REMOTE CONTROL (D)

- D1) ON/STAND-BY button
- D2) Increase/decrease temperature/programmed operation
- D3) "MODE" selection button
- D4) Fan speed selection button
- D5) REAL FEEL selection button
- D6) ARCTIC WHISPER selection button
- D7) Switch button °C/°F
- D8) TIMER button

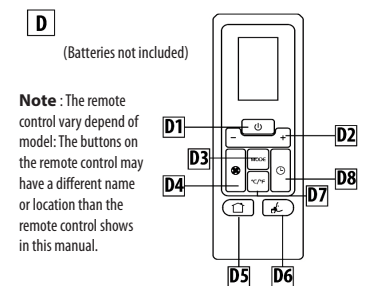

INSERTING OR REPLACING THE BATTERIES

- Remove the cover on the rear of the remote control;
- Replace the old batteries with two new R03 "AAA" 1.5V batteries, inserting them correctly (see the instructions inside the battery compartment);
- Replace the cover.

If the remote control unit is replaced or discarded, the batteries must be removed and disposed of in accordance with current legislation as they are harmful to the environment. Do not mix old and new batteries.

Do not mix alkaline, standard (carbon-zinc) or rechargeable (nickel-cadmium) batteries. Do not dispose of batteries in fire. Batteries may explode or leak. If the remote control is not be used for a certain length of time, remove the batteries.

TURNING THE APPLIANCE ON/OFF

- Plug into the outlet.
- Press the button (D1) (when turned on, the air conditioner starts operating in the same mode as when it was turned off).
- To switch the appliance off, press button **D1** , then remove the plug.

NOTE: Never switch the appliance off by removing the plug. Always switch it off by pushing on the button and waiting a few minutes before removing the plug. Only in this way will the appliance perform its standard checks.

FUNCTIONS SELECTION

The controls on the remote control are the same as those on the control panel of the appliance **C**. You should therefore refer to the instructions in the chapter "OPERATING FROM THE CONTROL PANEL" to select the desired functions. Press button D7, to switch the temperature display from °C to °F and vice versa (see "CHANGING TEMPERATURE SCALE" section for more details).

SELF-DIAGNOSIS

The appliance has a self diagnosis system to identify a number of malfunctions. Error messages are displayed on the appliance display.

IF ... IS DISPLAYED,	IF ... IS DISPLAYED,	IF ... IS DISPLAYED,	IF ... IS DISPLAYED,	IF ... IS DISPLAYED,
Low Temperature (frost prevention)	High Temperature	Low humidity	Probe Failure (Probe damaged)	High Level (Internal tray full)
..WHAT SHOULD I DO?	..WHAT SHOULD I DO?	..WHAT SHOULD I DO?	..WHAT SHOULD I DO?	..WHAT SHOULD I DO?
The appliance is fitted with a frost protection device to avoid excessive formation of ice. The appliance starts up again automatically when the defrosting process is completed.	The appliance is fitted with an overheating device which in case of operating conditions with excessive room temperature for a long period, will switch the appliance to ventilate only. The appliance will be automatically restored as soon as the temperature will be close to the operating limit conditions.	This message can be displayed, only in the Real Feel function. It indicates that the room humidity level is extremely low. To resume operation, switch the unit to any other mode other than the Real Feel function.	If this is displayed, contact service center.	Empty the internal safety tank following the instructions in the section "End of season operations". If HL alarm reoccurs frequently in Air Conditioning, Dehumidifying or Real Feel mode, contact service center

TIPS FOR CORRECT USE

To ensure optimal results from your air conditioner, follow these recommendations:

- Close the windows and doors in the room to be air conditioned
- When installing the air conditioner semi-permanently, you should leave a door slightly open (as little as 1/2 inch - 1 cm) to guarantee proper ventilation.
- Never use the appliance in very damp rooms (laundries for example).
- Protect the room from direct exposure to the sun by partially closing curtains and/or blinds to make the appliance much more economical to run.

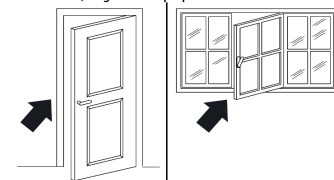

Close doors and windows

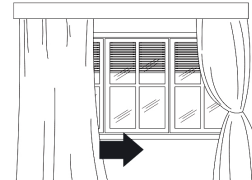

Close blinds or curtains

Note:

- This equipment has been tested and found to comply with the limits for a Class B digital device, pursuant to part 15 of the FCC Rules. These limits are designed to provide reasonable protection against harmful interference in a residential installation.
 - This equipment generates, uses and can radiate radio frequency energy and, if not installed and used in accordance with the instructions, may cause harmful interference to radio communications. However, there is no guarantee that interference will not occur in a particular installation. If this equipment does cause harmful interference to radio or television reception, which can be determined by turning the equipment off and on, the user is encouraged to try to correct the interference by one or more of the following measures:
 - Reorient or relocate the receiving antenna.
 - Increase the separation between the equipment and receiver.
 - Connect the equipment into an outlet on a circuit different from that to which the receiver is connected.
 - Consult the dealer or an experienced radio/TV technician for help.
- Changes or modifications not expressly approved by the party responsible for compliance could void the user's authority to operate the equipment.
- This device complies with Part 15 of the FCC Rules. Operation is subject to the following two conditions: (1) this device may not cause harmful interference, and (2) this device must accept any interference received, including interference that may cause undesired operation.
 - This Class B digital apparatus complies with Canadian ICES-003.

- Never use the appliance outdoors.
- Make sure there are no heat sources in the room.
- Make sure the air conditioner is standing on a level surface.



do not cover the appliance

- Never rest objects of any kind on the air conditioner.
- Never obstruct the air intake or outlet grilles.

CLEANING

Before cleaning or maintenance, turn the appliance off by means of the button, then unplug from the outlet.

CLEANING THE CABINET

You should clean the appliance with a slightly damp cloth then dry with a dry cloth. For safety reasons, never wash the air conditioner with water.

Precautions

Never use petrol, alcohol or solvents to clean the appliance. Never spray insecticide liquids or similar.

CLEANING THE BIO SILVER AIR FILTER

If the filter is dirty, air circulation is compromised and the efficiency of the appliance decreases.

It is therefore good practice to clean the filter at regular intervals. The frequency depends on the duration and conditions of operation.

If the unit is used constantly or systematically, you are recommended to clean the filter once a week. The filter is housed in the intake grille.

To clean the filter, extract as shown in fig. 7.

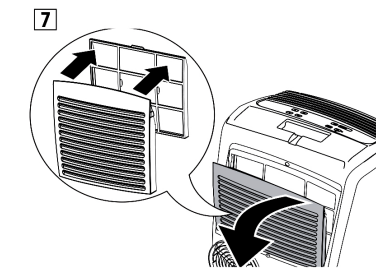

Use a vacuum cleaner to remove the dust collected on the filter. If it is very dirty, immerse in warm water and rinse a number of times. The water should never be hotter than 104°F. After repositioning the filter, allow it to dry completely before repositioning it. The BioSilver filter helps capture dust and pollen and helps reduce the growth of bacteria and mold on the filter.

START OF SEASON CHECKS

Make sure the power cable and socket are in perfect condition and make sure the grounding system is sufficient. Follow the installation instructions precisely.

END OF SEASON OPERATIONS

To drain all water from the circuit, remove the external cap by unscrewing it in the counter clockwise direction then, remove the internal cap from the drain on the back of the appliance and allow the water to drain out into a basin (fig. 8).

NOT ON ALL MODELS: In order to properly store the appliance the appliance at the end of the season.

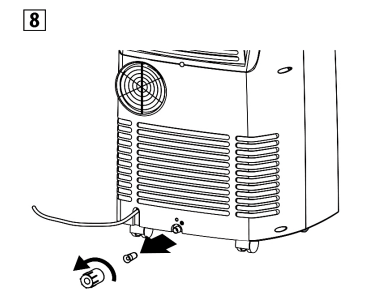

When the appliance is empty, replace the caps. Clean the filter and dry thoroughly before putting back. Unit should be stored in large, well ventilated area.

TECHNICAL SPECIFICATIONS

Power supply voltage	see rating label
Max. absorbed power during air conditioning	"
Refrigerant	"
Cooling capacity	"

LIMIT CONDITIONS

Room temperature for air conditioning	61 ÷ 95 °F (16° ÷ 35 °C)
Maximum relative humidity :	80% RH

Transport, filling, cleaning, recovery and disposal of refrigerant should be performed by a technical service centre appointed by the manufacturer only.

The appliance should be disposed of by a specialist centre appointed by the manufacturer only.

TO AVOID DAMAGE TO THE UNIT:

NEVER TRANSPORT OR TURN THE APPLIANCE UPSIDE DOWN OR ON ITS SIDE. IF THIS OCCURS, WAIT 6 HOURS BEFORE TURNING THE APPLIANCE ON, 24 HOURS IS RECOMMENDED. After the unit has been on its side, oil needs to return to the compressor to ensure proper function. Without allowing the unit this time (6-24 hours) the unit may function for only a short time, and then the compressor will break down from lack of oil.

ELECTRICAL CONNECTION

This appliance is equipped with a 3 prong grounded plug. The plug must be connected into an outlet that is properly installed and grounded in the accordance with all local codes and ordinances. Do not modify the plug provided with the appliance. If it will not fit the outlet, have a proper outlet installed by a qualified electrician or relocate the unit to a proper outlet. If the household electrical supply does not meet the above specifications, or if you are not sure your home has an effective electrical ground, have a qualified electrician or your local electrical utility company check it and correct any problems.

SAFETY PLUG

The appliance is fitted with a safety plug to protect the power cable. If power is cut off, unplug from the outlet and make sure the power cable is undamaged. If the cable is damaged, contact service center. If power cuts off frequently and the power cable is undamaged, contact a qualified electrician.

OPERATION OF THE SAFETY PLUG

If the safety device incorporated in the plug trips and cuts off the power supply, check that the power cable and plug are not damaged. If the power cable is undamaged, to restore operation press the "RESET" button. To verify correct operation of the plug, press the "TEST" button periodically and make sure the appliance disconnects. If this is not the case, contact service center. To restore operation, press the "RESET" button.

TROUBLESHOOTING

PROBLEM	CAUSE	SOLUTION
The air conditioner does not come on	it is not plugged into the outlet	plug into the outlet
	there is no current	wait for at least 3 minutes and try again
	the internal safety device has tripped	Contact service center.
The air conditioner works for a short time only	there are bends or kinks in the air exhaust hose	position the air hose correctly, keeping it as short and free of curves as possible to avoid bottlenecks
	something is preventing the air from being discharged	check and remove any obstacles obstructing air discharge
The air conditioner works, but does not cool the room	windows, doors and/or curtains open	close doors, windows and curtains, bearing in mind the "TIPS FOR CORRECT USE" given above
	there are heat sources in the room (oven, hair dryer, etc)	eliminate the heat sources
	the air exhaust hose is detached from the appliance	fit the air exhaust hose in the housing at the back of the appliance (fig. 1).
During operation, there is an unpleasant smell in the room	dust filter and electrostatic filter clogged	clean the filters as described above
	prevents the appliance from being restarted until three minutes have elapsed since it was last turned off	wait. This delay is part of normal operation.
The air conditioner does not operate for about three minutes after restarting it	the appliance has a self diagnosis system to identify a number of malfunctions.	see the SELF-DIAGNOSIS chapter
One of the following messages is displayed: LH/HL/Lh/PF/HL		

PRINTED IN MEXICO

Elbrd: J.M SC: 05-20-2024

OBPN: 5715113981_01_1020

SHDML: PACAN370G1W3ALWH

8 0 4 1 0 9 9 6 9 A

