

Important safeguard

- Use this appliance only as described in this instruction manual.
- As with any electrical appliance, the instructions aim to cover as many situations as possible. Caution and common sense should be used when operating and installing this air conditioner.
- This appliance has been manufactured to cool and dehumidify domestic environments and must not be used for other purposes.
- It is dangerous to alter or modify the unit's characteristics in any way.
- The appliance must be installed in accordance with the relevant national legislation.
- Should repairs be necessary, contact a service center.
- Unauthorized servicing can be dangerous.
- The appliance is not intended for use by persons (including children) with reduced physical, sensory or mental capabilities, or lack of experience and knowledge, unless they have been given supervision or instruction concerning use of the appliance by a person responsible for their safety.
- Children should be supervised to ensure that they do not play with the appliance.
- If the power cable is damaged, it must be replaced by the manufacturer or an authorized technical service centre in order to avoid all risk.
- Always ensure the appliance is plugged into a grounded 3-prong outlet. If you have any doubts check with a qualified electrician.
- Do not use extension cables.
- Before cleaning or maintenance operations, always unplug the unit from the outlet.
- Do not pull on or place strain on the power cord when moving the appliance.
- The appliance should not be installed where the atmosphere may contain combustible gases, oil or sulphur, or near heat sources.
- Do not rest hot or heavy objects on the appliance.
- Clean the filters at least once a week.

- Avoid using heaters near the unit.
- The unit should be transported in a vertical position. If this is not possible secure the unit at an angle, do not lie it horizontally.
- Before transporting the unit, drain the unit. After transportation, wait at least 6 hours before switching the unit on.
- The packaging materials can be recycled. You are therefore recommended to place them in the special containers for differentiated waste collection.
- This appliance is fitted with a special safety device. When the compressor switches off, this device prevents it from switching on again for at least 3 minutes.
- WARNING:** Changes or modifications not expressly approved by the party responsible for compliance could void the user's authority to operate the equipment.

Specific warnings for appliances with R410A refrigerant gas

R410A is a refrigerant that complies with European ecological standards; nevertheless, it is recommended not to pierce the cooling circuit of the machine. At the end of its useful life, deliver the appliance to a special waste collection centre for disposal.

This hermetically sealed system contains fluorinated greenhouse gases.

ENVIRONMENTAL INFORMATION:
This unit contains fluorinated greenhouse gases covered by the Kyoto Protocol.
Maintenance and disposal must be carried out by qualified personnel only (R410A, GWP=2088).

Save these instructions This product is for household only

USE

NOTE: This appliance features an auto evaporative function to remove excess condensate water during cooling and dehumidifying modes.

AIR CONDITIONING WITHOUT INSTALLATION

You can set-up in a double-hung window:

- Fit the assembled air exhaust hose in the housing at the back of the appliance. Insert it as shown in figure 1.

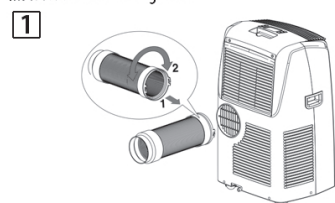

- Place the window bracket in the window sill, extend the bracket fully within the window frame, fix the bracket by using the pin then lower the window onto the bracket. (Should the window bracket be too large for the window, the plastic can be cut with a saw by a qualified professional.)
- Connect the window outlet to the other end of the exhaust hose.
- Insert the window outlet of the exhaust hose into the slot of the window bracket (fig. 2).

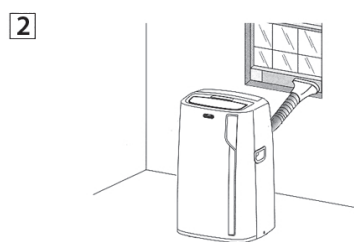

Other set-up methods:

- Thanks to the locking pins, it's possible to use the window bracket also for sliding windows. Position the hole of the bracket so to allow a correct installation of the exhaust hose (see figure 3).

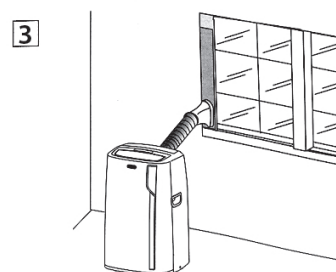

- If you have a casement window (figure 4) proceed as follows:
- Fit the assembled air exhaust hose in the relevant housing located on the rear side of the appliance, (fig. 1) then, apply the window outlet to the air exhaust hose and place it outside the window to exhaust the hot air.

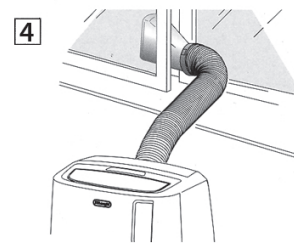

FOAM STRIPPING INSTRUCTIONS

- Extend the window bracket to the desired width
- Remove the protection from the tape and apply it to the window bracket as show in figure.

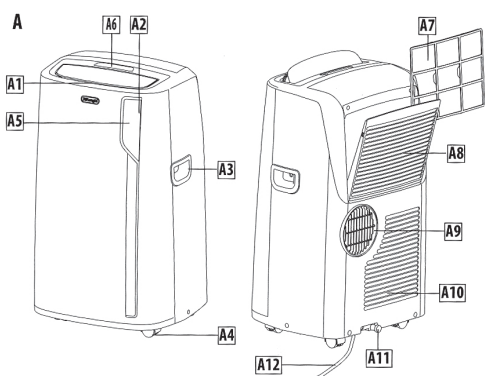

DESCRIPTION

Description of the appliance (See A)

- A1 Air outlet flap
- A2 Control panel
- A3 Handles
- A4 Wheels
- A5 Remote control signal receiver
- A6 Remote control storage
- A7 Filter
- A8 Air intake grille
- A9 Air exhaust hose housing
- A10 Air intake grille
- A11 Drainage hose with cap
- A12 Power supply cable

Description of accessories (See B)

- B1 Air exhaust hose
- B1a Hose adapter to unit
- B1b Hose adapter
- B2 Window outlet
- B3 Window bracket with pins
- B4 Additional window bracket with pins
- B5 Remote control

The image shown here is for illustrative purposes only and may be subject to change. The actual descriptions of control panel and their locations may vary, depending on the model.
Accessory type, appearance and quantity may vary depending on the model.

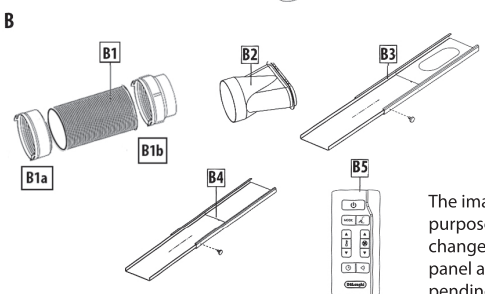

Electrical connection

- Before plugging the appliance into the outlet, check that:
- The outlet's power supply corresponds to the value indicated on the rating label on the back of the appliance;
- The outlet and electrical circuit are adequate for the appliance;
- The outlet is a 3-hole grounded outlet (Ⓛ). If this is not the case, you must choose another outlet. Failure to follow these important safety instructions absolves the manufacturer of all liability.

If it becomes necessary, the power cable must be replaced by a qualified professional only.

The instructions below will enable you to prepare your air conditioner for operation as efficiently as possible. Before use, make sure the air intake and outlet grilles are unobstructed.

INTRODUCTION

Please take a few moments to read the instructions to avoid risks or damage to the appliance.

Download the App!



This appliance can be used also with the App Pinguino that can be downloaded from the App Store® or from Google Play. To gain access to all functions you need a local net (Home WLAN) with access to Internet. Further check there are no obstacles to the Internet access, such as Firewall, Proxy, authentications, etc.,

CONTROL PANEL

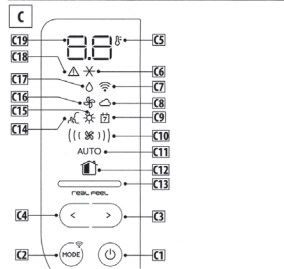

DESCRIPTION OF THE CONTROL PANEL (C)

- C1. ON/STAND-BY (on/off) key
- C2. Function selection key MODE (air conditioning, dehumidifying, fan, heating, ON-OFF WIFI - reset WLAN settings)
- C3. Increase key
- C4. Decrease key
- C5. Temperature indicator
- C6. Air conditioning symbol
- C7. Wifi symbol
- C8. App indicator
- C9. App timer/calendar
- C10. Air flow indicator
- C11. Auto indicator
- C12. REAL FEEL symbol (the function is available only from remote control and app)
- C13. REAL FEEL indicator
- C14. Whisper cool symbol (the function is available only from remote control and app)
- C15. Heating symbol
- C16. Fan symbol
- C17. Dehumidifying symbol
- C18. Alarm symbol
- C19. Set temperature values

OPERATING FROM THE CONTROL PANEL

TURNING THE APPLIANCE ON/OFF

Before plugging the appliance check the cap on back of the unit is correctly inserted on drainage hose A11. Insert the plug in the socket.

Two dashes appear on the display indicating that the appliance is in stand-by. Touch the C1 key to turn on the appliance. When the appliance comes on, the last function set before it was shut off is activated.

NOTE: After few seconds of the control panel inactivity, its brightness will be automatically reduced and in the next few minutes it will be further reduced. To turn the appliance off, touch the C1 key. NOTE: Never turn off the air conditioner by simply pulling the plug. Touch the C1 key in order to put your air conditioner in stand-by and wait a few minutes before pulling the plug. In this manner, the appliance can perform the operating status checks.

MODES SELECTION

To select the desired operating mode, touch repeatedly the MODE key until the desired function is selected.

WIFI FUNCTION

To select or deselect the Wifi function, keep touched the MODE key for 3 seconds.

AIR CONDITIONING MODE

This is ideal for hot and humid weather when the room needs to be both cooled and dehumidified.

To correctly set this mode:
• Touch repeatedly the MODE key until the air conditioning symbol appears. The display will show the desired temperature.

- To change the temperature to be reached, touch the < C4 or > C3 key.

NOTE: The most suitable temperatures, during the summer range from 75 to 81°F. However, setting the temperature significantly lower than the outdoor temperature is not recommended. In conditioning mode, the air flow can be selected only from the remote control and app.

DEHUMIDIFYING MODE

This is ideal for reducing humidity in the room (spring and autumn, damp rooms, rainy periods, etc.). For this type of use, the appliance must be set up as for air conditioning mode. That is, the air exhaust hose B2 must be fitted to the appliance to allow the humidity to be discharged outside.

To correctly set this mode:
• Touch repeatedly the MODE key until the dehumidifying symbol appears.
• The appliance automatically chooses the best air flow.

FAN MODE

When using this mode, the air exhaust hose B2 does not need to be attached to the appliance.

To correctly set this mode:
• Touch repeatedly the MODE key until the fan symbol appears.
• Select the desired air flow by touching the increase > C3 or decrease < C4 buttons.

The available air flows are:

- () Minimum air flow: when maximum silent operation is desired.
- () Medium air flow: when the noise level needs to be low but with a good comfort level.
- () Maximum air flow: for maximum performance.

HEATING MODE

This is ideal in spring and autumn when outdoor temperatures are not particularly severe. For this mode, the appliance should be prepared in the same way as for air conditioning, with the air exhaust hose B2 attached.

OPERATING FROM THE CONTROL PANEL (CONT...)

- To set this mode:
- Touch repeatedly the MODE button until the heating symbol is displayed.
 - Touch increase > C3 or decrease < C4 buttons to adjust the desired temperature.
- Notes:**
- In this mode, the air flow is selected automatically by the appliance and cannot be set manually.
 - When operating in very cold rooms, the appliance defrosts automatically, momentarily interrupting normal operation. In this case, "L" appears on the display. During this operation, it is normal for the noise made by the appliance to change.
 - In this mode, you may have to wait a few minutes before the appliance starts giving out hot air.
 - In this mode, the fan may operate for short periods, even though the set temperature has already been reached.
 - It may happen that the display shows "HL" alarm. In this case, empty the internal safety tank following the instructions in the Section "End of Season operations". At the end, press again the C1 button to restore the heating function.

SELECT THE TEMPERATURE SCALE

The temperature can be displayed in °C or °F. To change the temperature unit of measure touch both the increase/decrease keys > C3 and < C4 for about 10 sec.

OPERATING FROM THE REMOTE CONTROL

INSERTING OR REPLACING THE BATTERIES (NOT SUPPLIED)

- Remove the cover on the rear of the remote control.
- Insert or replace the batteries with two new R03 "AAA" 1.5V batteries, inserting them correctly (see the instructions inside the battery compartment).
- Replace the cover.
- If the remote control unit is replaced or discarded, the batteries must be removed and disposed of in accordance with current legislation as they are harmful to the environment.
- Do not mix old and new batteries.
- Do not mix alkaline, standard (carbon-zinc) or rechargeable (nickel-cadmium) batteries. Do not dispose of batteries in fire. Batteries may explode or leak. If the remote control is not to be used for a certain length of time, remove the batteries.

USING THE REMOTE CONTROL

- Point the remote control at the receiver A5 on the air conditioner. The remote control must be no more than 23 ft (7 metres) away from the appliance (without obstacles between the remote control and the receiver).
- The remote control must be handled with care. Do not drop it or expose it to direct sunlight or sources of heat.

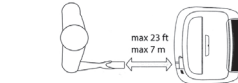

Note: The remote control can be safely stored in the appropriate compartment A6 (see figure A).

DESCRIPTION OF THE REMOTE CONTROL

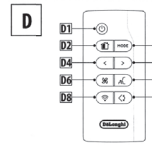

- D1. ON/STAND-BY (on/off) button
- D2. REAL FEEL button
- D3. MODE button
- D4. Decrease button
- D5. Increase button
- D6. Air flow button
- D7. Whisper cool button
- D8. WIFI button
- D9. Swing button (flap swing)

TURNING THE APPLIANCE ON/OFF

- Plug into the outlet.
- Press the C1 button D1. When turned on, the air conditioner starts operating in the same mode as when it was turned off.
- Press the C1 button again to switch the appliance off.

Note: Never switch the appliance off by removing the plug. Always switch it off by pushing the C1 button and waiting few minutes before removing the plug. Only in this way the appliance will perform the standard checkings.

SELECTING THE OPERATING MODES
The operating modes available on the remote control correspond to those on the appliance control panel C.

SELECTING THE TEMPERATURES
In conditioning and heating modes press button < D4 or > D5 to select the desired temperature.

SELECTING THE AIR FLOW
In conditioning and fan modes, press button * D6 to select the desired air flow.

- The air flow available are:
- () Minimum air flow: when maximum silent operation is desired.
 - () Medium air flow: when the noise level needs to be low but with a good comfort level.
 - () Maximum air flow: for maximum performance.
- The appliance automatically chooses the air flow based on the temperature selected and the environmental conditions. This selection is only available in conditioning mode.

REAL FEEL FUNCTION

REAL FEEL is the innovative DeLonghi technology that works simultaneously on temperature reduction and humidity control, securing best comfort level. With traditional systems, during working time, optimal comfort conditions may be reached but not secured over time. With REAL FEEL,

once optimal comfort is reached, PAC automatically modulates compressor action and air flow, to keep it over time. To activate the function, push the button D2 on remote control and the REAL FEEL symbol appears. After approx. 1 minute, the REAL FEEL indicator C13 switches on and then changes color when approaching the best comfort level (see following diagram).

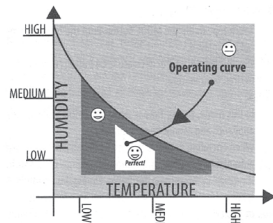

ORANGE LIGHT	GREEN LIGHT	BLUE LIGHT
Room conditions far from optimal level.	Most people feel good room conditions, near optimal level.	Best comfort level.

- The well-being feeling is a subjective condition: for this reason, different people may judge differently the same environmental conditions.
- In particularly severe environmental conditions (large size of the environment, high temperature or humidity outside, poor insulation of the room, too many of people or strong heat load in the room, strong exposure to the sun...) this device may not be able to reach the best comfort level.

WHISPER COOL (AVAILABLE IN CONDITIONING MODE ONLY)

By activating this function, the operating noise is further reduced. To activate it, press on the remote control the C14 button. The display shows the relative symbol C14.

SWING FUNCTION



The SWING button D9 moves the flap, evenly distributing the air into the room. When the SWING button is pressed, the flap will begin to move forwards and backwards alternately. If pressed again, the flap will be locked into its current position. When the button is next pressed, the flap will start to move forwards and backwards again.

WIFI FUNCTION

To activate or deactivate the WIFI function, keep touched for few seconds the WIFI button on the remote control till the emission of a double beep. Once the WIFI icon is displayed it means that the WIFI features are available.

SYMBOL WIFI FIXED

It means that the WIFI features are active AND the "Home WLAN" has been found.

SLOW FLASHING

It means that the appliance is searching for the "Home WLAN".

FAST FLASHING

It means that the "Home WLAN" has not been found or has not been set yet.

"APP CONTROL" ICON

When the APP CONTROL icon appears it means that the last command has been received via app.

- If the memorized "Home WLAN" settings needs to be changed, proceed as follows:
- keep touched for about 20 seconds the MODE button C2 on the control panel until a prolonged beep is emitted;
 - use the app to enter the new WLAN settings into the unit.

SETTING THE TIMER

Timer programming is an exclusive function of the app: thanks to the many possibilities of timer programming, you can prevent wasting electricity by optimising the operating period, setting delayed start up or shut down of the appliance.

FCC AND CANADA EMC COMPLIANCE INFORMATION

This device complies with Part 15 of the FCC Rules. Operation is subject to the following two conditions:
(1) This device may not cause harmful interference, and
(2) This device must accept any interference received, including interference that may cause undesired operation.

NOTE: This equipment has been tested and found to comply with the limits for a Class B digital device, pursuant to part 15 of the FCC Rules. These limits are designed to provide reasonable protection against harmful interference in a residential installation. This equipment generates, uses and can radiate radio frequency energy and, if not installed and used in accordance with the instructions, may cause harmful interference to radio communications. However, there is no guarantee that interference will not occur in a particular installation. If this equipment does cause harmful interference to radio or television reception, which can be determined by turning the equipment off and on, the user is encouraged to try to correct the interference by one or more of the following measures:

- Reorient or relocate the receiving antenna.
- Increase the separation between the equipment and receiver.
- Connect the equipment into an outlet on a circuit different from that to which the receiver is connected.
- Consult the dealer or an experienced radio/TV technician for help.

Approved under the certification provision of FCC Part 15 as a Class B Digital Device.

Caution: Changes or modifications not expressly approved by the manufacturer could void the user's authority to operate this device.

Caution: To comply with the limits of the Class B digital device, pursuant to Part 15 of the FCC Rules, this device is to be shielded with Class B limits. All peripherals must be shielded and grounded. Operation with non-certified peripherals or non-shielded cables may result in interference to radio or reception.

This Class B digital apparatus complies with Canadian ICES-003. CAN ICES-3 (B)/NMB-3(B)

Cet appareil numérique de la classe B est conforme à la norme NMB-003 du Canada.

WIRELESS TRANSMITTER COMPLIANCE INFORMATION

The term "IC:" before the radio certification number only signifies that Industry Canada technical specifications were met.

This device complies with Industry Canada's licence-exempt RSSs. Operation is subject to the following two conditions:

- (1) This device may not cause interference; and
- (2) This device must accept any interference, including interference that may cause undesired operation of the device.

This equipment complies with FCC and IC radiation exposure limits set forth for an uncontrolled environment. This equipment should be installed and operated with minimum distance 20cm between the radiator and your body. This transmitter must not be co-located or operating in conjunction with any other antenna or transmitter.

SELF-DIAGNOSIS

The appliance has a self diagnosis system to identify a number of warning/malfunctions. Error messages are displayed on the appliance display.

IF ... IS DISPLAYED,	IF ... IS DISPLAYED,	IF ... IS DISPLAYED,	IF ... IS DISPLAYED,
"Low Temperature" (frost prevention)	"Probe Failure" (Probe damaged)	"High Level" (Internal tray full)	"Communication Failure" (internal communication issue)
..WHAT SHOULD I DO?	..WHAT SHOULD I DO?	..WHAT SHOULD I DO?	..WHAT SHOULD I DO?
The appliance is fitted with a frost protection device to avoid excessive formation of ice. The appliance starts up again automatically when the defrosting process is completed.	If this is displayed, contact a service center.	Empty the internal safety tank following the instructions in the section "End of season operations"	If this is displayed, contact a service center.

FCC/IC RADIATION EXPOSURE STATEMENT

This equipment complies with FCC/IC RSS-102 radiation exposure limits set forth for an uncontrolled environment.

This equipment should be installed and operated with minimum distance 20cm between the radiator & your body.

Host device Labeling

This device includes the following module.

Contains FCC ID:

2ANDL3-TYWE15

Host device Labeling

This device includes the following module.

Contains IC:

23243-TYWE15

TROUBLESHOOTING

Check the following points before calling the authorised Technical Service Centre in your area.

PROBLEMS	CAUSES	SOLUTIONS
The air conditioner does not turn on	It is not plugged in	plug it in
	there is no power	wait
	the internal protection device was triggered	call a service center.
The air conditioner works for a short period of time	the air exhaust hose is obstructed or bent	correctly position the air exhaust hose, limiting the length and curves as much as possible and avoiding any obstructions
	an obstruction is impeding air exhaust outside	identify and remove the obstacles that impede air exhaust outside
The air conditioner runs but does not cool the room	windows, doors, drapes open	close the windows, doors and drapes, keeping in mind the "recommendations for proper use"
	there is some heat source in the room (oven, hair dryer, etc.)	eliminate the heat source
	the air exhaust hose is disconnected from the appliance	attach the air exhaust hose to the housing on the back of the appliance (fig.1)
	dust filters clogged	clean or replace the filters as previously described
	the technical characteristics of the appliance are not suitable for cooling the room where it is located	
During operation there is an unpleasant odour in the room	dust filters clogged	clean or replace the filters as previously described
The air conditioner does not work for about 3 minutes from restart	to protect the compressor there is an internal device that delays startup for about 3 minutes from restart	wait
The display shows the symbol with one of the following messages: HL/PF/FI	the appliance has a self-diagnosis system that identifies some operating errors	refer to the SELF-DIAGNOSIS chapter

CLEANING

Before cleaning or maintenance, turn the appliance off by touching the button, wait a few seconds, then unplug from the outlet.

CLEANING THE CABINET

You should clean the appliance with a slightly damp cloth then dry with a dry cloth. For safety reasons, never wash the air conditioner with water.

Precautions

Never use petrol, alcohol or solvents to clean the appliance. Never spray insecticide liquids or similar.

CLEANING THE BIO SILVER AIR FILTER

If the filter is dirty, air circulation is compromised and the efficiency of the dehumidifying and air purifying functions decreases.

It is therefore good practice to clean the filter at regular intervals. The frequency depends on the duration and conditions of operation.

If the unit is used constantly or systematically, you are recommended to clean the filter once a week.

The filter is housed in the intake grille.

To clean the filter, extract as shown in fig. 8.

To maintain the efficiency of the air conditioner, it is recommended to clean the dust filter after every week of use.

The filter is located near the intake grille. Remove the grille to access the filter. To clean the filter, it will need to be extracted as shown in fig. 8.

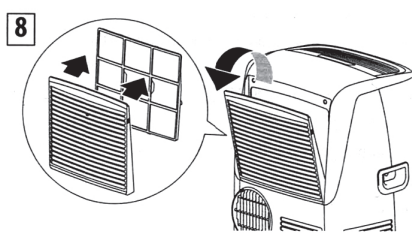

Use a vacuum cleaner to remove any dust deposited on the filter.

If it is very dirty, submerge it into warm water and rinse it several times. The water temperature must be kept below 104°F (40°C).

After washing the filter, allow it to dry.

After washing the filter, allow it to dry completely before repositioning it.

The BioSilver filter helps capture dust and pollen and helps reduce the growth of bacteria and mold on the filter.

CHECKS AT THE START OF THE SEASON

Make sure the power cable and socket are in perfect condition and make sure the earthing system is efficient. Comply strictly with the installation standards.

END OF SEASON OPERATIONS

To drain all water from the circuit, remove the cap **A11** from the drainage on the back of the appliance and allow the water to drain out into a basin (fig. 9).

To facilitate this operation, at the start of the season, it's possible to apply the water drain hose with cap **B6**.

In order to properly storage the appliance at the end of the season, we suggest you cover it with the supplied end of season dust cover **B8** and you put the accessories in the relevant end of season accessories bag **B9**.

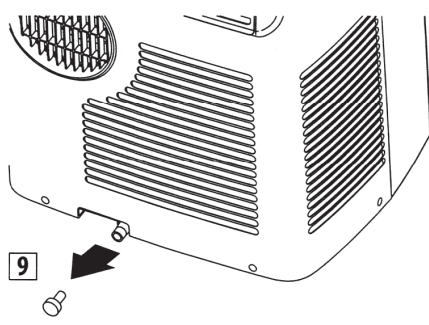

When the appliance is empty, replace the cap.
Clean the filter and dry thoroughly before putting back.

TECHNICAL SPECIFICATIONS

Power supply voltage	see rating label
Max. absorbed power during air conditioning	"
Refrigerant	"
Cooling capacity	"

LIMIT CONDITIONS

Room temperature for air conditioning	64 ÷ 95°F (18° ÷ 35°C)
Room temperature for heating	50 ÷ 77°F (10 ÷ 25°C)

Transport, filling, cleaning, recovery and disposal of refrigerant should be performed by a technical service centre appointed by the manufacturer only.

The appliance should be disposed of by a specialist centre appointed by the manufacturer only.

TO AVOID DAMAGE TO THE UNIT:

NEVER TRANSPORT OR TURN THE APPLIANCE UPSIDE DOWN OR ON ITS SIDE. IF THIS OCCURS, WAIT 6 HOURS BEFORE TURNING THE APPLIANCE ON, 24 HOURS IS RECOMMENDED. After the unit has been on its side, oil needs to return to the compressor to ensure proper function. Without allowing the unit this time (6-24 hours) the unit may function for only a short time, and then the compressor will break down from lack of oil.

ELECTRICAL CONNECTION

This appliance is equipped with a 3 prong grounded plug. The plug must be connected into an outlet that is properly installed and grounded in the accordance with all local codes and ordinances. Do not modify the plug provided with the appliance. If it will not fit the outlet, have a proper outlet installed by a qualified electrician or relocate the unit to a proper outlet. If the household electrical supply does not meet the above specifications, or if you are not sure your home has an effective electrical ground, have a qualified electrician or your local electrical utility company check it and correct any problems.

SAFETY PLUG

The appliance is fitted with a safety plug to protect the power cable. If power is cut off, unplug from the outlet and make sure the power cable is undamaged. If the cable is damaged, call the service center immediately. If power cuts off frequently and the power cable is undamaged, contact a qualified electrician.

OPERATION OF THE SAFETY PLUG

If the safety device incorporated in the plug trips and cuts off the power supply, check that the power cable and plug are not damaged. If the power cable is undamaged, to restore operation press the "RESET" button. To verify correct operation of the plug, press the "TEST" button periodically and make sure the appliance disconnects. If this is not the case, contact the service center. To restore operation, press the "RESET" button.

REFURBISHED PRODUCT LIMITED THIRTY DAY WARRANTY

The **Refurbished Product Service Center** offers the following WARRANTY to the ORIGINAL purchaser of a product which we have refurbished.

This product that has been refurbished is warranted against any electronic or mechanical defects for a period of THIRTY DAYS from the date of the original purchase by the consumer. Since this unit was sold as a refurbished item, the warranty does not apply to any cosmetic appearance items such as scratches. Should a defect occur, the **Refurbished Product Service Center** will repair or, at its option, replace defective unit/parts with new or rebuilt materials without charge for either parts or labor. Replacement unit/parts will be warranted for the remaining portion of the original warranty period.

This warranty does not cover installation or damage from accident, misuse, abuse, improper wiring, incorrect voltage, operating the unit against the instructions in the owner's manual or any product which has been opened, altered, or tampered with.

This warranty does not cover costs for removal and or installation of the unit for repair. Under no circumstances shall the service center be liable for any special, incidental or consequential damages or for any other expenses incurred by reason of use or sale of this product. This warranty is in lieu of any other warranties expressed or implied warranty of merchantability of fitness for particular use or otherwise.

This warranty gives the consumer specific legal rights and they may also have other rights which vary from State to State. Some States do not follow the exclusion or limitation of incidental or consequential damages, hence the above exclusion and limitations may not apply.

Refurbished Product Service Center
13225 Marquardt Avenue Santa Fe Springs, CA 90670

WARRANTY REPAIR INFORMATION

If you need service on your unit during the 30 day warranty period; please go to www.ConsumerServiceRefurbish.com or call the Refurbished Product Service Center at 562-946-3531 to obtain the required claim number. Once you obtain your claim number, pack the unit properly (the original carton is ideal for this purpose) along with a copy of your purchase receipt.

Send the unit freight prepaid and insured to:

Refurbished Product Service Center,

Att: Customer Service Department 13225 Marquardt Avenue Santa Fe Springs, CA 90670

Your unit will be promptly exchanged and returned to you.

We will refuse to accept delivery of the returned unit unless the assigned claim number appears on the outside of the shipping carton.

Owner's Information

(Keep for your permanent records)

NAME: _____

ADDRESS: _____

CITY: _____ STATE: _____ ZIP CODE: _____

PHONE: _____ E-MAIL: _____

MODEL: _____ SERIAL NO.: _____

PRINTED IN MEXICO

Sc:08.09.2019

obpn:5715113191_00_1218

shnmdl: PACEL295 + INSERT 8040000269

TAB / elbri.a.

804109556

