

# LED TV\*

\* LG LED TV applies LCD screen with LED backlights.

43QNED80TUA	55QNED85TUA	65QNED90TUA	75QNED99TUA	43UT7590PUA	50UT9000PUA	65UT8050AUA	75UT8000AUA
43QNED80TUC	65QNED80TUA	75QNED80TUC	86QNED80TUC	43UT8000AUA	55UT8000AUA	65UT9000PUA	75UT8050AUA
50QNED80TUC	65QNED80TUC	75QNED85TAA	86QNED85TUA	43UT9000PUA	55UT8050AUA	70UT8000AUA	75UT9000PUA
50QNED85TUA	65QNED85TAA	75QNED85TUA	86QNED90TAA	50UT8000AUA	55UT9000PUA	70UT8050AUA	86UT7590PUA
55QNED80TUC	65QNED85TUA	75QNED90TAA	86QNED90TUA	50UT8050AUA	65UT8000AUA	75UT7590PUA	86UT8000AUA
55QNED85TAA	65QNED90TAA	75QNED90TUA	86QNED99TUA				

814100243

Please read this manual carefully before operating your set and retain it for future reference.

## Important Safety Instruction

- Read these instructions.
- Keep these instructions.
- Heed all warnings.
- Follow all instructions.
- Do not use this apparatus near water.
- Clean only with dry cloth.
- Do not block any ventilation openings. Install in accordance with the manufacturer's instructions.
- Do not install near any heat sources such as radiators, heat registers, stoves, or other apparatus (including amplifiers) that produce heat.
- Do not defeat the safety purpose of the polarized or grounding-type plug. A polarized plug has two blades with one wider than the other. A grounding type plug has two blades and a third grounding prong. The wide blade or the third prong are provided for your safety. If the provided plug does not fit into your outlet, consult an electrician for replacement of the obsolete outlet.
- Protect the power cord from being walked on or pinched particularly at plugs, convenience receptacles, and the point where they exit from the apparatus.
- Only use attachments/accessories specified by the manufacturer.
- Use only with the cart, stand, tripod, bracket, or table specified by the manufacturer, or sold with the apparatus. When a cart is used, use caution when moving the cart/apparatus combination to avoid injury from tip-over.
- Unplug this apparatus during lightning storms or when unused for long periods of time.
- Refer all servicing to qualified service personnel. Servicing is required when the apparatus has been damaged in any way, such as power-supply cord or plug is damaged, liquid has been spilled or objects have fallen into the apparatus, the apparatus has been exposed to rain or moisture, does not operate normally, or has been dropped.



By using this product, you agree that all disputes between you and LG arising out of or relating in any way to this product (including but not limited to warranty disputes) shall be resolved exclusively through binding arbitration on an individual basis. The terms of the arbitration agreement (including details on the procedure for resolving disputes) is available at [www.lg.com/us/arbitration](http://www.lg.com/us/arbitration) (USA) or [www.lg.com/ca\\_en/arbitration](http://www.lg.com/ca_en/arbitration) (Canada).

## Before reading this manual

- Read this manual thoroughly before operating your TV, and keep it for future reference.
- On the website you can download the manual including installation, using, troubleshooting, specifications, license etc and view its contents on your PC or mobile device.
- User Guide** : For more information about this TV, read the USER GUIDE embedded in the product. (Depending upon model)
  - To open the USER GUIDE (Ⓢ) → (Ⓢ) → [Support] → [User Guide]

### Optional Extras

- Optional extras can be changed or modified for quality improvement without any notification. Contact a service center. These devices work only with certain models.
- The model name or design may be changed due to the manufacturer's circumstances or policies.
- Magic Remote Control :  
Check whether your TV model supports Bluetooth in the Wireless Module Specification to verify whether it can be used with the Magic Remote.
- A cable to connect antennas and external devices must be purchased separately. (Not included)

### Note

- Product specifications or contents of this manual may be changed without prior notice due to upgrade of product functions.
- The items supplied with your product may vary depending upon the model.
- Image shown may differ from your TV.

## Warning! Safety instructions



CAUTION: TO REDUCE THE RISK OF ELECTRIC SHOCK DO NOT REMOVE COVER (OR BACK). NO USER SERVICEABLE PARTS INSIDE. REFER TO QUALIFIED SERVICE PERSONNEL.

The symbol is intended to alert the user to the presence of uninsulated dangerous voltage within the product's enclosure that may be of sufficient magnitude to constitute a risk of electric shock to persons.

The symbol is intended to alert the user to the presence of important operating and maintenance (servicing) instructions in the literature accompanying this apparatus.

WARNING: TO REDUCE THE RISK OF FIRE AND ELECTRIC SHOCK, DO NOT EXPOSE THIS PRODUCT TO RAIN OR MOISTURE.

TO PREVENT THE SPREAD OF FIRE, KEEP CANDLES OR OTHER ITEMS WITH OPEN FLAMES AWAY FROM THIS PRODUCT AT ALL TIMES.

### Do not place the TV and/or remote control in the following environments:

- Keep the product away from direct sunlight.
- An area with high humidity such as a bathroom.
- Near any heat source such as stoves and other devices that produce heat.
- Near kitchen counters or humidifiers where they can easily be exposed to steam or oil.
- An area exposed to rain or wind.
- Do not expose to dripping or splashing and do not place objects filled with liquids, such as vases, cups, etc. on or over the apparatus (e.g., on shelves above the unit).
- Near flammable objects such as gasoline or candles, or expose the TV to direct air conditioning.
- Do not install in excessively dusty places.
- Otherwise, this may result in fire, electric shock, combustion/explosion, malfunction or product deformation.
- Ventilation**
  - Install your TV where there is proper ventilation. Do not install in a confined space such as a bookcase.

## OWNER'S MANUAL Safety and Reference

- Do not install the product on a carpet or cushion.
- Do not block or cover the product with cloth or other materials while unit is plugged in.

Take care not to touch the ventilation openings. When watching the TV for a long period, the ventilation openings may become hot.

Protect the power cord from physical or mechanical abuse, such as being twisted, kinked, pinched, closed in a door, or walked upon. Pay particular attention to plugs, wall outlets, and the point where the cord exits the device.

Do not move the TV whilst the Power cord is plugged in.

Do not use a damaged or loosely fitting power cord.

Be sure to grasp the plug when unplugging the power cord. Do not pull on the power cord to unplug the TV.

Do not connect too many devices to the same AC power outlet as this could result in fire or electric shock.

### Disconnecting the Device from the Main Power

The power plug is the disconnecting device. In case of an emergency, the power plug must remain readily accessible.

Do not let your children climb or cling onto the TV. Otherwise, the TV may fall over, which may cause serious injury.

### Outdoor Antenna Grounding (Can differ by country):

If an outdoor antenna is installed, follow the precautions below.

An outdoor antenna system should not be located in the vicinity of overhead power lines or other electric light or power circuits, or where it can come in contact with such power lines or circuits as death or serious injury can occur.

Be sure the antenna system is grounded to provide some protection against voltage surges and built-up static charges.

Section 810 of the National Electrical Code (NEC) in the U.S.A. provides information with respect to proper grounding of the mast and supporting structure, grounding of the lead-in wire to an antenna discharge unit, size of grounding conductors, location of antenna discharge unit, connection to grounding electrodes and requirements for the grounding electrode.

Antenna grounding according to the National Electrical Code, ANSI/NFPA 70

Never touch this apparatus or antenna during a lightning storm. You may be electrocuted.

Make sure the power cord is connected securely to the TV and wall socket if not secured damage to the Plug and socket may occur and in extreme cases a fire may break out.

Do not insert metallic or inflammable objects into the product. If a foreign object is dropped into the product, unplug the power cord and contact a service center.

Do not touch the end of the power cord while it is plugged in. You may be electrocuted.

If any of the following occur, unplug the product immediately and contact a service center.

- The product has been damaged.
- If water or another substance enters the product (like an AC adapter, power cord, or TV).
- If you smell smoke or other odors coming from the TV
- When lightning storms or when unused for long periods of time. Even the TV is turned off by remote control or button, AC power source is connected to the unit if not unplugged in.

Do not use high voltage electrical equipment near the TV (e.g., a bug zapper). This may result in product malfunction.

Do not attempt to modify this product in any way without written authorization from LG Electronics. Accidental fire or electric shock can occur. Contact a service center. Unauthorized modification could void the user's authority to operate this product.

Use only an authorized attachments / accessories approved by LG Electronics. Otherwise, this may result in fire, electric shock, malfunction, or product damage.

Never disassemble the AC adapter or power cord. This may result in fire or electric shock.

Handle the adapter carefully to avoid dropping or striking it. An impact could damage the adapter.

To reduce the risk of fire or electrical shock, do not touch the TV with wet hands. If the power cord prongs are wet or covered with dust, dry the power plug completely or wipe dust off.

### Batteries (Not Included)

Store the accessories (battery, etc.) in a safe location out of the reach of children.

Do not short circuit, disassemble, or allow the batteries to overheat. Do not dispose of batteries in a fire. Batteries should not be exposed to excessive heat.

Caution: Risk of fire or explosion if the battery is replaced by an incorrect type.

### Moving

When moving, make sure the product is turned off, unplugged, and all cables have been removed. It may take 2 or more people to carry larger TVs. Do not press or put stress on the front panel of the TV. Otherwise, this may result in product damage, fire hazard or injury.

Keep the packing anti-moisture material or vinyl packing out of the reach of children.

Do not allow an impact shock, any objects to fall into the product, and do not drop anything onto the screen.

Do not press strongly upon the panel with a hand or a sharp object such as a nail, pencil, or pen, or make a scratch on it. It may cause damage to screen.

### Cleaning

When cleaning, unplug the power cord and wipe gently with a soft/dry cloth. Do not spray water or other liquids directly on the TV. Do not clean your TV with chemicals including glass cleaner, any type of air freshener, insecticide, lubricants, wax (car, industrial), abrasive, thinner, benzene, alcohol etc., which can damage the product and/or its panel. Otherwise, this may result in electric shock or product damage.

## Installation

### Lifting and moving the TV

When moving or lifting the TV, read the following to prevent the TV from being scratched or damaged and for safe transportation regardless of its type and size.

It is recommended to move the TV in the box or packing material that the TV originally came in.

Before moving or lifting the TV, disconnect the power cord and all cables.

When holding the TV, the screen should face away from you to avoid damage.

Hold the top and bottom of the TV frame firmly. Make sure not to hold the transparent part, speaker, or speaker grille area.

Use at least two people to move a large TV.

When transporting the TV, do not expose the TV to jolts or excessive vibration.

When transporting the TV, keep the TV upright; never turn the TV on its side or tilt towards the left or right.

When handling the TV, be careful not to damage the protruding buttons.



Avoid touching the screen at all times, as this may result in damage to the screen.

Do not place the product on the floor with its front facing down without padding. Failure to do so may result in damage to the screen.

When attaching the stand to the TV set, place the screen facing down on a cushioned table or flat surface to protect the screen from scratches.

### Mounting on the Table

Lift and tilt the TV into its upright position on a table.

- Leave a minimum of 10 cm (4 inches) space from the wall for proper ventilation.

Connect the power cord to a wall outlet.



Do not apply foreign substances (oils, lubricants, etc.) to the screw parts when assembling the product. (Doing so may damage the product.)

Do not use any unapproved items to ensure the safety and lifespan of the product.

Any damages or injuries by using unapproved items are not covered by the warranty.

If you install the TV on a stand, you need to take actions to prevent the product from overturning. Otherwise, the product may fall over, which may cause injury.

When assembling the stand, ensure that all of the provided screws are attached. If the screws are not fully tightened, the product may tilt or tip over, resulting in damage. Tightening the screws with excessive force may cause them to come off due to abrasion of the screw joint.

### Securing TV to the Wall

Insert and tighten the eye-bolts or TV brackets and bolts on the back of the TV.

- If there are bolts inserted at the eye-bolts position, remove the bolts first.

Mount the wall brackets with the bolts to the wall. Match the location of the wall bracket and the eye-bolts on the rear of the TV.

Connect the eye-bolts and wall brackets tightly with a sturdy rope or cable. Make sure to keep the rope parallel to the flat surface.

Use a platform or cabinet that is strong and large enough to support the TV securely.

Brackets, bolts, and ropes are optional.

### Mounting to the Wall (KIT NOT INCLUDED)

An optional wall mount can be used with your LG Television. Consult with your local dealer for a wall mount that supports the VESA standard used by your TV model. Carefully attach the wall mount bracket at the rear of the TV. Install the wall mount bracket on a solid wall perpendicular to the floor. If you are attaching the TV to other building materials, please contact qualified personnel to install the wall mount. Detailed instructions will be included with the wall mount. We recommend that you use an LG brand wall mount. The LG wall mount is easy to adjust or to connect the cables. When you do not use LG's wall mount bracket, use a wall mount bracket where the device is adequately secured to the wall with enough space to allow connectivity to external devices. If you are using a non-adjustable mount, attach the mount to the wall. Attach the cables to the TV first, then attach the TV to the mount.



Remove the stand before installing the TV on a wall mount by performing the stand attachment in reverse.

For more information of screws and wall mount bracket, refer to manual included in the separately purchased wall mount.

If you intend to mount the product to a wall, attach VESA standard mounting interface (optional parts) to the back of the product. When you install the set to use the wall mounting bracket (optional parts), fix it carefully so as not to drop.

When mounting a TV on the wall, make sure not to install the TV by hanging the power and signal cables on the back of the TV.

Do not install this product on a wall if it could be exposed to oil or oil mist. This may damage the product and cause it to fall.

When installing the wall mounting bracket, it is recommended to cover the stand hole using tape, in order to prevent the influx of dust and insects, (Depending upon model).

## Antenna/Cable

Connect an antenna, cable, or cable box to watch TV while referring to the following. The illustrations may differ from the actual items and an RF cable is optional.

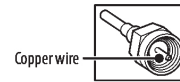

- Make sure not to bend the copper wire of the RF cable.
- Complete all connections between devices, and then connect the power cord to the power outlet to prevent damage to your TV.
- Use a signal splitter to use 2 TVs or more.
- DTV Audio Supported Codec: MPEG, Dolby Digital
- This TV cannot receive Ultra HD (3840 x 2160 pixels) broadcasts directly because the related standards have not been confirmed (Depending upon country).

## Starting TV

### Turning on the TV

You can simply operate the TV functions, using the button.

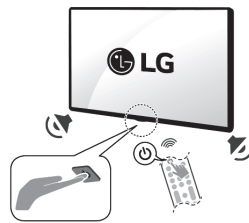

The images shown here are for illustrative purposes only and may be subject to change.

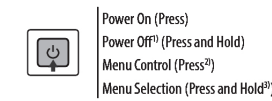

- All running apps will close.
- You can access and adjust the menu by pressing the button when TV is on.
- You can use the function when you access menu control.

### Note

- When the TV is turned on for the first time after being shipped from the factory, initialization of the TV may take approximately one minute.
- Your TV's OSD (On Screen Display) may differ slightly from that shown in this manual (Depending upon model).
- The device must be easily accessed to a location outlet near the access. Some devices are not made by turning on/off button, turning off the device and unplugging the power cord (Depending upon model).

## Connections

You can connect various external devices to the TV.

### HDMI

- When connecting the HDMI cable, the product and external devices should be turned off and unplugged.
- Supported HDMI Audio format (Depending upon model):
  - True HD (48 kHz),
  - Dolby Digital / Dolby Digital Plus (32 kHz / 44.1 kHz / 48 kHz),
  - PCM (32 kHz / 44.1 kHz / 48 kHz / 96 kHz / 192 kHz),
  - DTS (44.1 kHz / 48 kHz / 88.2 kHz / 96 kHz),
  - DTS-HD (44.1 kHz / 48 kHz / 88.2 kHz / 96 kHz / 176.4 kHz / 192 kHz)

### Note

- If the device connected to Input Port also supports HDMI Deep Color, your picture may be clearer. However, if the device doesn't support it, it may not work properly. In that case, change the TV's [HDMI Deep Color] setting to off (Depending upon model).
- → [General] → [External Devices] → [HDMI Settings] → [HDMI Deep Color] (Depending upon model).
- Use a certified cable with the HDMI logo attached. If you do not use a certified HDMI cable, the screen may not display or a connection error may occur.
- Recommended HDMI cable types (3 m (9.84 feet) or less)
  - Ultra High Speed HDMI™ cable

### USB

Some USB Hubs may not work. If a USB device connected through a USB Hub is not detected, connect it directly to the USB port on the TV. (Depending upon model)

### Note

- For an optimal connection, HDMI cables and USB devices should have bezels less than 10 mm (0.39 inches) thick and 18 mm (0.7 inches) width. (Depending upon model)
- Use an extension cable that supports USB 2.0 if the USB cable or USB flash drive does not fit into your TV's USB port.

### IR Blaster

Control the set-top box (cable/satellite/PP/OTT), Blu-ray/DVD player, soundbar, game consoles, etc., using the IR Blaster (Depending upon country) (Depending upon model).

## Specifications

Product specifications may be changed without prior notice due to upgrade of product functions.

Estimated yearly energy consumption indicated on the FTC label is measured in accordance with the Test Procedures for Television Sets (USA only).

The actual energy consumption depends on the usage environment (The content watched, TV settings, etc.).

- For information of the power supply and power consumption, refer to the label attached to the product.
  - The typical power consumption is measured in accordance with IEC 62087 or each country's energy regulations.
    - On some models, the label is inside the external device connection terminal cover.
    - Depending upon the model or country, the typical power consumption may not be on label.

Power requirement	AC 120 V ~ 50/60 Hz
-------------------	---------------------

(Depending upon country)

Broadcasting Specifications	
Television system	Terrestrial / Cable / Satellites Digital TV
External antenna impedance	75 Ω

Certain 8K input/decoding standards may not be supported. An additional device may be necessary to support certain 8K standards. Upscaled and enhanced 8K images will vary depending upon the source content (Depending upon model).

Environment Condition			
Operating Temperature	0 °C to 40 °C (32 °F to 104 °F)	Storage Temperature	-20 °C to 60 °C (-4 °F to 140 °F)
Operating Humidity	Less than 80 %	Storage Humidity	Less than 85 %

Conditions for Wall Mount Installation	
Tilt Angle	0° - 15°

\* This specification range applies to TV wall mounts when adjusting for proper viewing angle.

PRINTED IN MEXICO  
Elbrd: J.M. SC: 05-31-2024  
OBPN: \*MFL720617602401REV00\*  
SHDML: 43UT8000AUA\_B  
ADD:50UT8000AUA\_  
55UT8000AUA\_ 65UT8000AUA

814100243





# Using Magic Remote Control

- Power** Turns the TV on or off.
- Accesses the [Guide].**
- [Dash]** Inserts a — between numbers such as 2-1 and 2-2.
- LIST\*** **QUICK ACCESS\*\*** **Accesses the saved channel list.** **Accesses the [Edit Quick Access].**
  - [Edit Quick Access] is a feature that allows you to enter a specified app or Live TV directly by pressing and holding the number buttons.
- Volume buttons** Adjusts the volume level.
- Home** **Accesses the Home menu.**
- Home** **Launches the last used apps.**
- Wheel (OK)** Press the center of button to select a menu. You can change channels by using button.
- Wheel (OK)** **Accesses the [Magic Explorer].** You can run the [Magic Explorer] feature when the pointer color is changed to purple. (However, some apps may not support this feature.)
- Up/Down/Left/Right** Press the up, down, left or right button to scroll the menu. If you press buttons while the pointer is in use, the pointer will disappear from the screen and Magic Remote will operate like a general remote control. To display the pointer on the screen again, shake Magic Remote to the left and right.
- Back** Returns to the previous level.
- Back** The screen displayed on the TV is closed and the home menu appears.

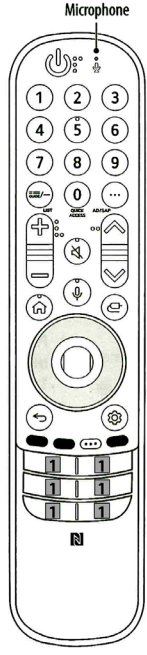

- 9\*\*** **Number buttons** Enters numbers.
- Accesses the [Quick Help].**
- More actions** Displays more remote control functions.
- AD/SAP\*\*** SAP (Secondary Audio Program) feature can also be enabled by pressing the button.
- Channel buttons** Scrolls through the saved channels.
- Mute** Mutes all sounds.
- Mute** **Accesses the [Accessibility] menu.**
- Voice recognition** Network connection is required to use the voice recognition function. **Check for recommended content.** (Some recommended services may not be available in some countries.)
- Voice recognition** Speak while pressing and holding the button to use the voice recognition feature.
- Input** Changes the input source.
- Input** **Accesses the [Home Hub].**
- Q. Settings** **Accesses the Quick Settings.**
- Q. Settings** **Displays the All Settings menu.**
- These access special functions in some menus.**
- Red button** Runs the record function.
- Various services button** Connects to various services such as streaming and voice search.
- 1**

**Note** \*\*To use the button, press and hold for more than 1 second.

The remote control vary depend of model: The buttons on the remote control may have a different name or location than the remote control shows in this manual.

The descriptions in this manual are based on the buttons on the remote control. Please read this manual carefully and use the TV correctly. This remote uses infrared light. When in use, it should be pointed in the direction of the TV's remote sensor. (Some buttons and services may not be provided depending upon models or regions.)

## How to register the Magic Remote Control

- To use the Magic Remote, first pair it with your TV.
- 1 Put batteries into the Magic Remote and turn the TV on.
- 2 Point the Magic Remote at your TV and press the **Wheel (OK)** on the remote control.
- \* If the TV fails to register the Magic Remote, try again after turning the TV off and back on.

## How to deregister the Magic Remote Control

- Press the (**Back**) and (**Home**) buttons at the same time, for five seconds, to unpair the Magic Remote with your TV.
- \* Press and hold the (**Home**) and (**Q. Settings**) buttons for more than 5 seconds to disconnect and re-register the Magic Remote at the same time.



- It is recommended that an Access Point (AP) be located more than 0.2 m (0.65 ft) away from the TV. If the AP is installed closer than 0.2 m (0.65 ft), the Magic remote control may not perform as expected due to frequency interference.

## Using Always Ready

- (Depending upon model)
- You can operate the TV and connect to Bluetooth with direct voice recognition while the power is off.
- \* → → [General] → [Always Ready], setting [Enable the function] to on.
- \* Pressing the button while watching TV switches the screen to [Always Ready] that is turned on, and pressing the button once more turns the screen to [Always Ready] that is turned off.
- \* Press the (**Home**) button or the (**Back**) button to watch TV when the screen is in [Always Ready] that is turned on.
- \* Press the **Wheel (OK)** button to display the wallpaper when the screen is in [Always Ready] that is turned off, and press the button to watch TV.

- Note**
  - Using Always Ready may increase energy consumption.
  - For more information about the feature, refer to the → → [Support] → [User Guide] → [Troubleshooting] → [Learn More About Always Ready].

## Connecting Smart Devices using NFC Tagging

NFC is technology that uses Near Field Communication (13.56 MHz), allowing you to conveniently send and receive information without separate settings. By bringing a smart device near the NFC-enabled remote control, you can install the LG ThinQ app and connect the device to the TV.

- 1 Turn on NFC in the smart device's settings. To use NFC with Android devices, set the NFC option to enable 'read/write tags' in the smart device's settings. The NFC settings may vary depending upon the device.
- 2 Bring the smart device near the (NFC) on the remote control. The required distance for NFC tagging is about 1 cm (0.39 inches).
- 3 Follow the instructions to install the LG ThinQ app on your smart device.
- 4 Retagging the smart device to the remote control allows you to conveniently access various features on the connected TV through the LG ThinQ app.

- Note**
  - This feature is available for NFC-enabled smart devices only.
  - This feature is only available if the remote control has an NFC logo.

## Specifications

Specifications (MR24GN, MR24GA)		
	Frequency range	Output Power (Max.)
Bluetooth	2,400 to 2,483.5 MHz	8 dBm
NFC	13.56 MHz	-

\* Only MR24GN

(Only 50/55/65/75/86QNED85\*, 65/75/86QNED90\*(For USA))

This product qualifies for ENERGY STAR in the factory default setting. Changing the factory default settings or enabling other features may increase power consumption that could exceed the limits necessary to qualify for ENERGY STAR. Refer to ENERGY STAR.gov for more information on the ENERGY STAR program.

# Product Information

(Only QNED99\*, QNED90TA\*, QNED85TA\*)

Wireless module(LGSBWAX12)Specifications	
Wireless LAN (IEEE 802.11a/b/g/n/ac/ax)	
Frequency range	Output Power (Max.)
2,400 to 2,472 MHz	17 dBm
5,150 to 5,725 MHz	15 dBm
5,725 to 5,850 MHz	15 dBm
5,945 to 7,125 MHz	11 dBm
Bluetooth	
Frequency range	Output Power (Max.)
2,400 to 2,483.5 MHz	9 dBm

As band channels can vary per country, the user cannot change or adjust the operating frequency. This product is configured for the regional frequency table.

For consideration of the user, this device should be installed and operated with a minimum distance of 20 cm (7.8 inches) between the device and the body.

- 1) FCC regulations restrict the operation of this device to indoor use only.
- 2) Operation prohibited on oil platforms, cars, trains, boats, and aircraft, except that operation of this device is permitted in large aircraft while flying above 10,000 feet.

FCC ID: BEJLGSBWAX12 / IC: 2703H-LGSBWAX12  
This product contains a Type Approved Module by Jamaica : SMA - LGSBWAX12

(Only QNED90TU\*)

Wireless module(LGSBWAC95)Specifications	
Wireless LAN (IEEE 802.11a/b/g/n/ac)	
Frequency range	Output Power (Max.)
2,400 to 2,483.5 MHz	18.5 dBm
5,150 to 5,725 MHz	18 dBm
5,725 to 5,850 MHz	18 dBm
Bluetooth	
Frequency range	Output Power (Max.)
2,400 to 2,483.5 MHz	9 dBm

As band channels can vary per country, the user cannot change or adjust the operating frequency. This product is configured for the regional frequency table.

For consideration of the user, this device should be installed and operated with a minimum distance of 20 cm (7.8 inches) between the device and the body.

FCC ID: BEJLGSBWAC95 / IC: 2703H-LGSBWAC95  
This product contains a Type Approved Module by Jamaica : SMA - LGSBWAC95

(Only QNED85TU\*, QNED80\*, UT90\*)

Wireless module(LGSBWAC97)Specifications	
Wireless LAN (IEEE 802.11a/b/g/n/ac)	
Frequency range	Output Power (Max.)
2,400 to 2,483.5 MHz	18.5 dBm
5,150 to 5,725 MHz	18 dBm
5,725 to 5,850 MHz	18 dBm
Bluetooth	
Frequency range	Output Power (Max.)
2,400 to 2,483.5 MHz	9 dBm

As band channels can vary per country, the user cannot change or adjust the operating frequency. This product is configured for the regional frequency table.

For consideration of the user, this device should be installed and operated with a minimum distance of 20 cm (7.8 inches) between the device and the body.

FCC ID: BEJLGSBWAC97 / IC: 2703H-LGSBWAC97  
This product contains a Type Approved Module by Jamaica : SMA - LGSBWAC97

(Only 43/50/55/65UT80\*, 43UT75\*)

Wireless module(LGSBWAC23)Specifications	
Wireless LAN (IEEE 802.11a/b/g/n/ac)	
Frequency range	Output Power (Max.)
2,400 to 2,483.5 MHz	17 dBm
5,150 to 5,725 MHz	16 dBm
5,725 to 5,850 MHz	16 dBm
Bluetooth	
Frequency range	Output Power (Max.)
2,400 to 2,483.5 MHz	8 dBm

## Open Source Software Notice Information

To obtain the source code that is contained in this product, under GPL, LGPL, MPL, and other open source licenses that have the obligation to disclose source code, and to access all referred license terms, copyright notices and other relevant documents please visit <https://opensource.lge.com>.

FCC ID: BEJLGSBWAC23 / IC: 2703H-LGSBWAC23  
This product contains a Type Approved Module by Jamaica : SMA - LGSBWAC23

(Only 70/75/86UT80\*, 75/86UT75\*)

Wireless module(LGSBWAC03)Specifications	
Wireless LAN (IEEE 802.11a/b/g/n/ac)	
Frequency range	Output Power (Max.)
2,400 to 2,483.5 MHz	20 dBm
5,150 to 5,725 MHz	18.5 dBm
5,725 to 5,850 MHz	18 dBm
Bluetooth	
Frequency range	Output Power (Max.)
2,400 to 2,483.5 MHz	9 dBm

As band channels can vary per country, the user cannot change or adjust the operating frequency. This product is configured for the regional frequency table.

For consideration of the user, this device should be installed and operated with a minimum distance of 20 cm (7.8 inches) between the device and the body.

FCC ID: BEJLGSBWAC03 / IC: 2703H-LGSBWAC03  
This product contains a Type Approved Module by Jamaica : SMA - LGSBWAC03

# Troubleshooting

In TV / HDMI input, press the button on the remote control three times to display the model name and serial number on the screen.

- Cannot control the TV with the remote control.**
- Check if anything such as tape has been placed over the receiver.
  - Check if there is any obstacle between the product and the remote control.
  - Replace the batteries with new fresh ones.

- No image display and no sound is produced.**
- Check if the product is turned on.
  - Check if the power cord is connected to a wall outlet.
  - Check if there is a problem in the wall outlet by connecting other products.

- The TV turns off suddenly.**
- Check the power control settings. The power supply may be interrupted.
  - Check if the auto-off function is activated on the settings related time.
  - The auto-off function may have worked. This product is equipped with an auto-off function that automatically turns off the power if the remote control is not used for 15 minutes without an input signal.

- Abnormal Display**
- If the product feels cold to the touch, there may be a small "flicker" when it is turned on. This is normal, there is nothing wrong with product.
  - This panel is an advanced product that contains millions of pixels. You may see tiny black dots and/or brightly colored dots (red, blue or green) at a size of 1 ppm on the panel. This does not indicate a malfunction and does not affect the performance and reliability of the product. This phenomenon also occurs in third-party products and is not subject to exchange or refund.
  - You may find different brightness and color of the panel depending upon your viewing position(left/right/top/down). This phenomenon occurs due to the characteristic of the panel. It is not related with the product performance, and it is not malfunction.
  - Avoid touching the screen or holding your finger(s) against it for long periods of time. Doing so may produce some temporary distortion effects on the screen.
  - Displaying a still image for a prolonged period of time may cause an image sticking. Avoid displaying a fixed image on the TV screen for an extended length of time.

- Generated Sound**
- **Cracking noise** A cracking noise that occurs when watching or turning off the TV is generated by plastic thermal contraction due to temperature and humidity. This noise is common for products where thermal deformation is required.
  - **Electrical circuit humming/panel buzzing** A low level noise is generated from a high-speed switching circuit, which supplies a large amount of current to operate a product. It varies depending upon the product. This generated sound does not affect the performance and reliability of the product.

- When cleaning the product, be careful not to allow any liquid or foreign objects to enter the gap between the upper, left or right side of the panel and the guide panel, (Depending upon model).
  - Make sure to wring any excess water or cleaner from the cloth.
  - Do not spray water or cleaner directly onto the TV screen.
  - Make sure to spray just enough of water or cleaner onto a dry cloth to wipe the screen.

# Regulatory

## FCC NOTICE

(For USA)  
This equipment has been tested and found to comply with the limits for a Class B digital device, pursuant to Part 15 of the FCC Rules. These limits are designed to provide reasonable protection against harmful interference in a residential installation. This equipment generates, uses, and can radiate radio frequency energy and, if not installed and used in accordance with the instructions, may cause harmful interference to radio communications. However, there is no guarantee that interference will not occur in a particular installation. If this equipment does cause harmful interference to radio or television reception, which can be determined by turning the equipment off and on, the user is encouraged to try to correct the interference by one or more of the following measures:

- Reorient or relocate the receiving antenna.
  - Increase the separation between the equipment and the receiver.
  - Connect the equipment to an outlet on a circuit different from that to which the receiver is connected.
  - Consult the dealer or an experienced radio/TV technician for help.
- This device complies with part 15 of the FCC Rules. Operation is subject to the following two conditions: (1) this device may not cause harmful interference and (2) this device must accept any interference received, including interference that may cause undesired operation. Any changes or modifications in construction of this device which are not expressly approved by the party responsible for compliance could void the user's authority to operate the equipment. and For indoor use only, use outdoors or in other modes not covered by this manual may violate the FCC regulation and violate the user authority to use the product.

## FCC Radio Frequency Interference Requirements (for UNII devices)

(For USA)  
High power radars are allocated as primary users of the 5.25 to 5.35 GHz and 5.65 to 5.85 GHz bands. These radar stations can cause interference with and/or damage this device. This device cannot be co-located with any other transmitter.

## FCC RF Radiation Exposure Statement

(For USA)  
(For having wireless function (WLAN, Bluetooth,...))  
This equipment complies with FCC radiation exposure limits set forth for an uncontrolled environment. This transmitter must not be co-located or operating in conjunction with any other antenna or transmitter. This equipment should be installed and operated with minimum distance 20 cm (7.8 inches) between the antenna and your body. Users must follow the specific operating instructions for satisfying RF exposure compliance.

## Industry Canada Statement

(For Canada)  
(For having wireless function (WLAN, Bluetooth,...))  
This device contains licence-exempt transmitter(s)/receiver(s) that comply with Innovation, Science and Economic Development Canada's licence-exempt RSS(s). Operation is subject to the following two conditions:  
(1) This device may not cause interference.  
(2) This device must accept any interference, including interference that may cause undesired operation of the device.

## IC Radiation Exposure Statement

(For Canada)  
(For having wireless function (WLAN, Bluetooth,...))  
This equipment complies with IC radiation exposure limits set forth for an uncontrolled environment. This equipment should be installed and operated with minimum distance 20 cm (7.8 inches) between the antenna & your body.

**NOTE** THE MANUFACTURER IS NOT RESPONSIBLE FOR ANY RADIO OR TV INTERFERENCE CAUSED BY UNAUTHORIZED MODIFICATIONS TO THIS EQUIPMENT. SUCH MODIFICATIONS COULD VOID THE USER'S AUTHORITY TO OPERATE THE EQUIPMENT.

## RSS-247 Requirement

- (For Canada)  
(For product having the wireless function using 5 GHz frequency bands)
- (1) The device for operation in the band 5150–5250 MHz is only for indoor use to reduce the potential for harmful interference to co-channel mobile satellite systems;
  - (2) For devices with detachable antenna(s), the maximum antenna gain permitted for devices in the bands 5250-5350 MHz and 5470-5725 MHz shall be such that the equipment still complies with the e.i.r.p. limit;
  - (3) For devices with detachable antenna(s), the maximum antenna gain permitted for devices in the band 5725-5850 MHz shall be such that the equipment still complies with the e.i.r.p. limits as appropriate; and
  - (4) (For devices operating in the band 5250-5350 MHz having an e.i.r.p. greater than 200 mW) Antenna type(s), antenna models(s), and worst-case tilt angle(s) necessary to remain compliant with the e.i.r.p. elevation mask requirement set forth in section 6.2.2.3 of RSS-247 shall be clearly indicated.

Users should also be advised that high-power radars are allocated as primary users (i.e. priority users) of the bands 5250-5350 MHz and 5650-5850 MHz and that these radars could cause interference and/or damage to LE-LAN devices.

## NOTE TO CABLE/TV INSTALLER

(For USA and Canada)  
This reminder is provided to call the CATV system installer's attention to Article 820-40 of the National Electric Code (U.S.A.). The code provides guidelines for proper grounding and, in particular, specifies that the cable ground shall be connected to the grounding system of the building, as close to the point of the cable entry as practical.

## WARNING! (STABILITY HAZARD)

- A television set may fall, causing serious personal injury or death. Many injuries, particularly to children, can be avoided by taking simple precautions such as:
- ALWAYS use cabinets or stands or mounting methods recommended by the manufacturer of the television set.
  - ALWAYS use furniture that can safely support the television set.
  - ALWAYS ensure the television set is not overhanging the edge of the supporting furniture.
  - ALWAYS educate children about the dangers of climbing on furniture to reach the television set or its controls.
  - ALWAYS route cords and cables connected to your television so they cannot be tripped over, pulled or grabbed.
  - NEVER place a television set in an unstable location.
  - NEVER place the television set on tall furniture (for example, cupboards or bookcases) without anchoring both the furniture and the television set to a suitable support.
  - NEVER place the television set on cloth or other materials that may be located between the television set and supporting furniture.
  - NEVER place items that might tempt children to climb, such as toys and remote controls, on the top of the television or furniture on which the television is placed.

If the existing television set is going to be retained and relocated, the same considerations as above should be applied.

## Symbols

	Refers to alternating current (AC).		Refers to stand-by.
	Refers to direct current (DC).		Refers to "ON" (power).
	Refers to class II equipment.		Refers to dangerous voltage.

## LG Take-back & Recycling Policy

(For USA)  
LG Electronics offers a customized e-waste take-back & recycling service that meets local needs and requirements in the countries where e-waste regulations are in place, and also provides product take-back & recycling service voluntarily in some regions. LG Electronics evaluates products' recyclability at the design step selectively, with the goal of improving recyclability where practicable. Through these activities, LG Electronics seeks to contribute to conserving natural resources and protecting the environment. For more information, please visit our global site at <https://www.lg.com/recycling>





43UT80\*\_50UT80\*\_55UT80\*\_65UT80\*\_70UT80\*  
75UT80\*\_86UT80\*\_43UT75\*\_75UT75\*\_86UT75\*

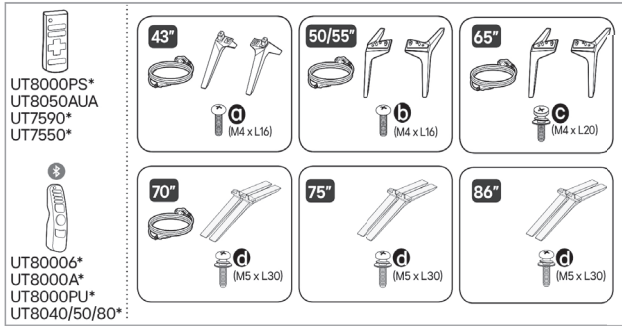

43/50/55/65/70/75/86"

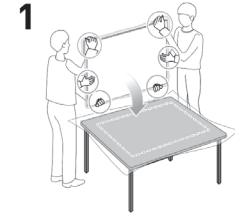

Accessory type and quantity may vary depending on the model.

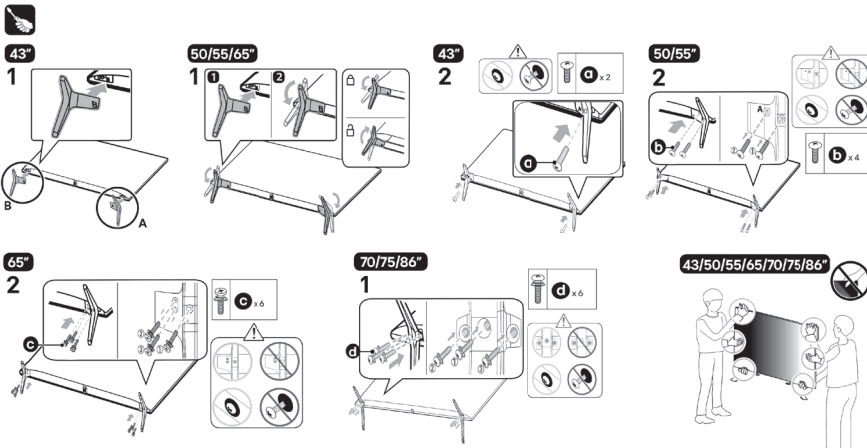

The image shown here is for illustrative purposes only and may be subject to change.

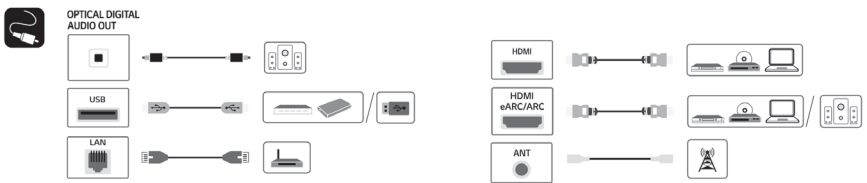

The cables mentioned in this guide is not supplied with your unit.



The remote control vary depend of model: The buttons on the remote control may have a different name or location than the remote control shows in this manual.

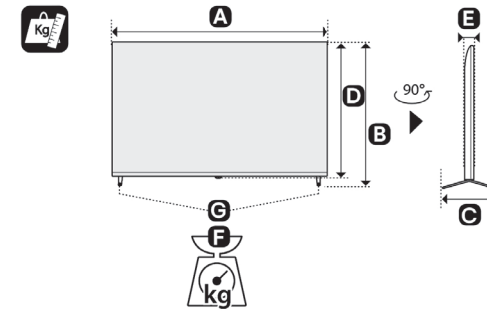

	A	B	C	D	E	F	F G	W
	mm (inches)							
	kg (lbs)							
43UT75* 43UT80*	967 mm (38.0) inches	621 mm (24.4) inches	216 mm (8.5) inches	564 mm (22.2) inches	571 mm (22.5) inches	89 kg (19.6) lbs	8.8 kg (19.4) lbs	115 W
50UT75* 50UT80*	1121 mm (44.1) inches	713 mm (28.0) inches	231 mm (9.0) inches	651 mm (25.6) inches	571 mm (22.5) inches	119 kg (26.2) lbs	11.7 kg (25.7) lbs	135 W
55UT75* 55UT80*	1235 mm (48.6) inches	776 mm (30.5) inches	231 mm (9.0) inches	715 mm (28.1) inches	575 mm (22.7) inches	14.2 kg (31.3) lbs	14.0 kg (30.8) lbs	150 W
65UT75* 65UT80*	1454 mm (57.2) inches	906 mm (35.6) inches	269 mm (10.5) inches	838 mm (32.9) inches	577 mm (22.7) inches	21.7 kg (47.8) lbs	21.4 kg (47.1) lbs	190 W
70UT75* 70UT80*	1562 mm (61.4) inches	972 mm (38.2) inches	361 mm (14.2) inches	907 mm (35.7) inches	599 mm (23.5) inches	28.1 kg (61.9) lbs	27.7 kg (61.0) lbs	205 W
75UT75* 75UT80*	1678 mm (66.0) inches	1027 mm (40.4) inches	361 mm (14.2) inches	964 mm (37.9) inches	599 mm (23.5) inches	31.8 kg (70.1) lbs	31.4 kg (69.2) lbs	230 W
86UT75* 86UT80*	1927 mm (75.8) inches	1167 mm (45.9) inches	362 mm (14.2) inches	1104 mm (43.4) inches	599 mm (23.5) inches	45.9 kg (101.1) lbs	45.2 kg (99.6) lbs	305 W

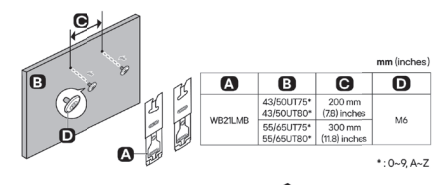
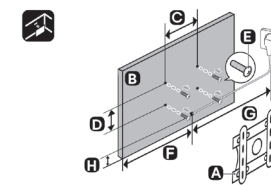

	A	B	C	D	E	F	G	H
	mm (inches)							
LSW240B MSW240	43UT75* 43UT80*	200 x 200 mm (7.8 x 7.8) inches			306 mm (12.0) inches			214 mm (8.4) inches
WB24GCB NSW240	50UT75* 50UT80*				384 mm (15.1) inches			254 mm (10.0) inches
WB24GCB NSW240	55UT75* 55UT80*	300 x 300 mm (11.8 x 11.8) inches			371 mm (14.6) inches			230 mm (9.0) inches
WB24GCB	65UT75* 65UT80*	300 x 300 mm (11.8 x 11.8) inches			480 mm (18.8) inches		±15 mm (5/60) inches	240 mm (9.4) inches
WB24GCB	70UT75* 70UT80*				485 mm (19.0) inches			275 mm (10.8) inches
	75UT75* 75UT80*	400 x 400 mm (15.7 x 15.7) inches			559 mm (22.0) inches			222 mm (8.7) inches
WB24GDB	86UT75* 86UT80*	600 x 400 mm (23.6 x 15.7) inches			599 mm (23.5) inches			215 mm (8.4) inches

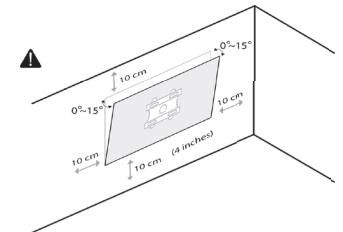

PRINTED IN MEXICO / SC: 05-30-2024 / ELBRD: J.E.

8 1 4 0 0 0 2 4 3

SHNMDL: 55UT8000AUA\_B / OBPN: \*MFL720637562402REV04\*



Add: 43UT80\*\_50UT80\*\_55UT80\*\_65UT80\*\_70UT80\*\_75UT80\*\_86UT80\*\_43UT75\*\_75UT75\*\_86UT75\*