

SONY

Sound Bar

Startup Guide

814000250

What's in the box

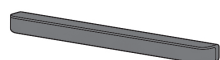

Bar speaker

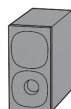

Subwoofer



Remote control

AC power cord (mains lead)
the shape of the plug differs
depending on countries/regions)



Optical digital cable

Read this guide carefully before using the device and keep it for future reference.

NOTE : The remote control vary depend of model: The buttons on the remote control may have a different name or location than the remote control shows in this manual. (BATTERIES NOT INCLUDED)

To set up the remote control

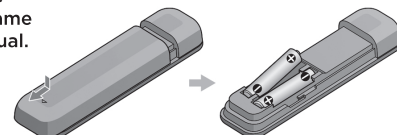

1 Choose an installation method

Installing on a shelf/stand

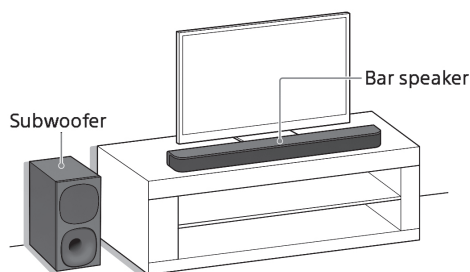

Mounting on a wall

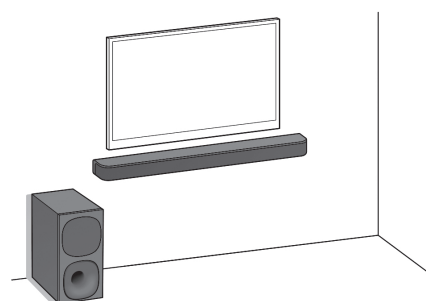

or

Note

- Disconnect the AC power cords (mains leads) of the TV and devices from the AC outlets (mains) in advance. The AC power cords (mains leads) must be reconnected in step 3.
- Place the subwoofer 5 cm (2 in) or more away from a TV rack, walls, etc.
- Do not lay the subwoofer on its side.

2 Connect with a TV

The cables mentioned in this guide is not supplied with your unit.

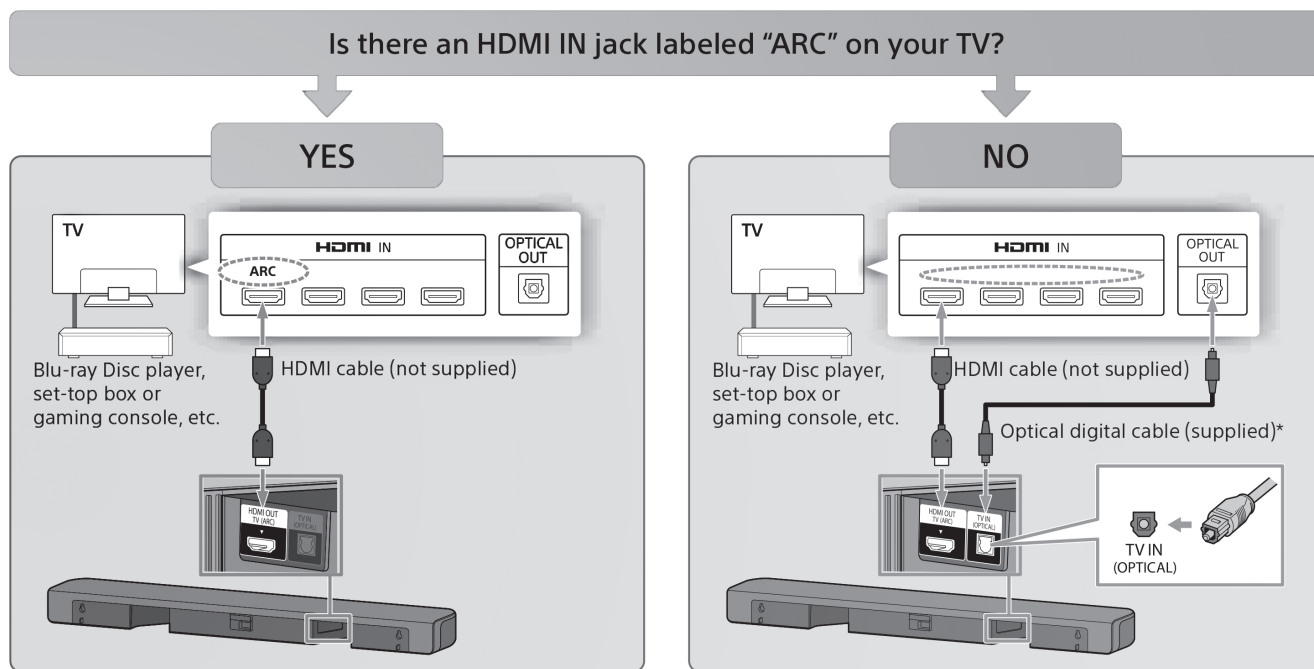

* If your TV does not support the ARC (Audio Return Channel) function, connect an optical digital cable (supplied) to listen to the TV sound.

Note

- Check the shape of the TV IN (OPTICAL) jack on the bar speaker and the optical digital cable's connector, then insert the connector into the jack in the right direction. If you insert the connector in the wrong direction, the connector and jack may be damaged.

3 Connect AC power cords (mains leads) of the TV and the speaker system

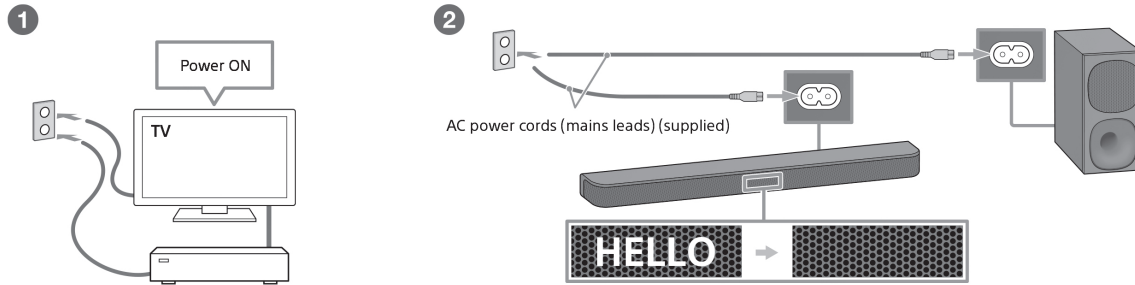

- 1 Connect the AC power cord (mains lead) of the TV and turn on.
- 2 Connect the AC power cords (mains leads) (supplied) to the bar speaker and subwoofer, and then connect the cords to the AC outlets (mains). The remote control of the speaker system does not work until [HELLO] in the front panel display on the bar speaker disappears.

4 Listen to the sound

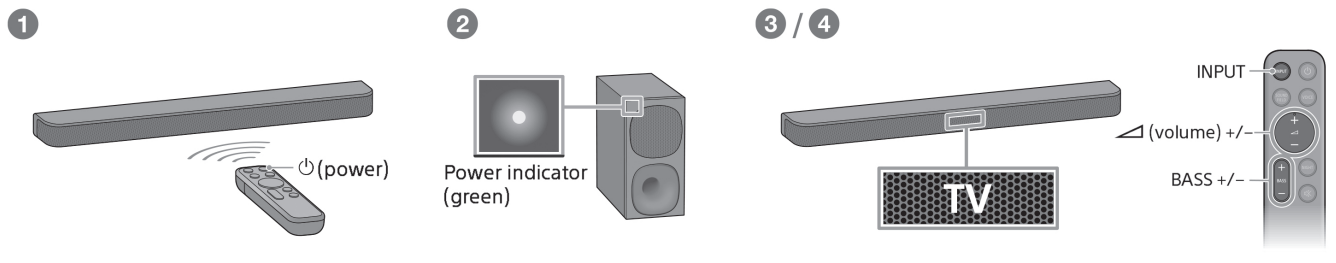

- 1 Press (power) on the remote control of the speaker system.
- 2 Confirm that the power indicator of the subwoofer is lit in green. When the connection with the bar speaker is completed, the power indicator of the subwoofer is lit in green.
- 3 Press INPUT to select [TV] input. Then select the program you want using the TV remote control.
- 4 Press (volume) +/- to adjust the speaker system volume and press BASS +/- to adjust the subwoofer volume.

Note

- Depending on the order in which you turn on the TV and the speaker system, the system may enter muting mode. In this case, turn on the TV first, then the system.

Accessory type and quantity may vary depending on the model.

The images shown here are for illustrative purposes only and may be subject to change.

PRINTED IN MEXICO
Elbrd: J.M.
SC: 06-19-2024
OBPN: 5-034-822-11
SHDM: HTSD40

814000250

