

# KEURIG® K-Elite™

804106807

Please read this manual carefully before operating your unit and retain for future reference.

## IMPORTANT SAFEGUARDS

When using electrical appliances, basic safety precautions should always be followed, including the following:

### 1. READ ALL INSTRUCTIONS

- For household use only.
- Do not fill water above max fill line or use distilled water.
- Only use capsules intended for this appliance. If the capsule does not fit, do not force the capsule into the appliance.
- Do not touch hot surfaces. Use handles or knobs.
- To protect against fire, electric shock, and injury to persons do not immerse appliance, cord, or plugs in water or other liquid.
- Close supervision is necessary when any appliance is used by or near children 12 years or younger.
- Unplug from outlet when not in use and before cleaning. Allow to cool before putting on or taking off parts, and before cleaning the appliance.
- Do not operate any appliance with a damaged cord or plug or after the appliance malfunctions, or has been damaged in any manner. Contact a service center.
- The use of accessory attachments not authorized by the appliance manufacturer may result in fire, electric shock, or injury to persons.
- Do not use outdoors.
- Do not let cord hang over edge of table or counter, or touch hot surfaces.
- Do not place on or near a hot gas or electric burner, or in a heated oven.
- Always attach plug to appliance first (if not permanently attached), then plug cord into the wall outlet. To disconnect, turn any control to "off" (if applicable) then remove plug from wall outlet.
- Do not use appliance for other than intended use.
- Use brewer in upright position only. Allow brewer to cool (90 min) prior to turning it in any position other than upright.
- Do not immerse brewer in water.

- WARNING:** To avoid risk of injury, do not open the brew chamber during the brew process.
- WARNING:** Keep all plastic bags away from children.
- CAUTION:** Keurig recommends using only Keurig® My K-Cup® Reusable Coffee Filter and Keurig® K-Cup® pods in this appliance. The use of non-Keurig® pods or accessories may cause brewer malfunction or injury.
- CAUTION:** There are two sharp needles that puncture the K-Cup® pod, one above the K-Cup® pod holder and the other in the bottom of the K-Cup® pod holder. To avoid risk of injury, be aware of the needle locations.
- CAUTION:** There is extremely hot water under pressure in the K-Cup® pod holder during the brew process. To avoid risk of injury do not lift the handle or otherwise open the handle during the brew process.
- POWER CORD INSTRUCTIONS:**
  - A short power-supply cord is provided to reduce risks resulting from becoming entangled in or tripping over a longer cord.
  - Longer detachable power-supply cords or extension cords are available and may be used if care is exercised in their use.
  - If a long detachable power-supply cord or extension cord is used:
    - The marked electrical rating of the detachable power-supply cord or extension cord should be at least as great as the electrical rating of the appliance.
    - If the appliance is of the grounded type, the extension cord should be a Grounding type 3-wire cord.
    - The longer cord should be arranged so that it will not drape over the counter top or table top where it can be pulled on by children or tripped over.
- CAUTION: HOT COCOA/OTHER NON-COFFEE PODS:** Immediately after using a hot cocoa/other non-coffee pod, run a hot water brew cycle without a pod to avoid the possibility of clogging the exit needle. DO NOT assume the next user will do this.

## SAVE THESE INSTRUCTIONS



## Before You Brew

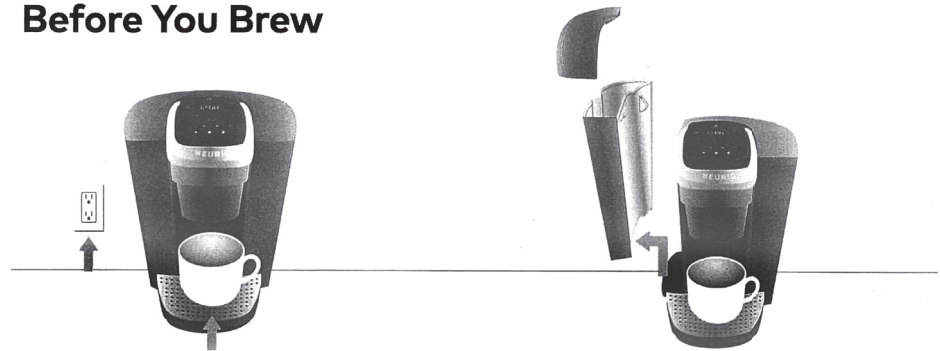

### 1 Plug & Place

Remove packing tape from brewer and plug into a grounded outlet.

Place a large mug (12oz minimum) on the drip tray.

### 2 Rinse & Fill

Remove the water reservoir lid, then lift the reservoir straight up to remove it.

If you have a Keurig® Water Filter, install it now. Refer to your Water Filter Starter Kit for instructions.

Rinse reservoir with fresh water and fill to the **MAX** fill line.

Replace water reservoir, making sure the lock tab engages with the brewer. Replace lid.

**NOTE:** Do not use distilled water.



### 3 Power On

Press **POWER** button — the green power light will illuminate.

The brewer will automatically begin heating the water. This will take about 3 minutes. Once the heating sound stops, the brewer is ready.

### 4 Cleansing Brew

**Do not insert a K-Cup® pod.** Press the **HOT WATER** button. The five brew buttons will blink. Press the small mug (8oz) button to start a cleansing brew. Pour the hot water into the sin.

**The one-time setup process is now complete and you are ready to brew!**

**NOTE:** Between brew cycles, the brewer may take about

**NOTE:** In order to ensure the highest possible standard for refurbished items, all units are thoroughly inspected as part of the process.

For this item, water may be used during the refurbishing process and so; you may notice some condensation in the water reservoir. It is recommended to rinse the water reservoir with fresh water prior to its first use.

## Brew Your First Cup

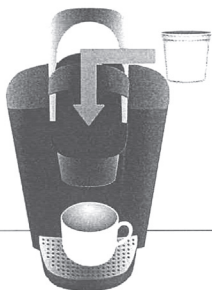

### 5 Place Mug & Pod

Place a mug on the drip tray. If using a travel mug, remove the drip tray and place the mug on the drip tray base. Lift the handle and place a K-Cup® pod in the K-Cup® pod holder. Lower the handle completely to close the lid.

**Do not remove the foil lid on the K-Cup® pod.**

**High Altitude Brewing:** While holding the brewer handle up, push down slowly on the K-Cup® pod in the pod holder until the bottom of the K-Cup® pod is punctured by the exit needle.



### 6 Brew & Enjoy!

Select your brew size — for bolder coffee, press the **STRONG** button before selecting your brew size. The brew size and **STRONG** button, if selected, will remain illuminated while brewing — about 1 minute.

For iced beverages, fill a 16oz plastic tumbler with ice. Insert any K-Cup® pod, then press the **ICED** button.

The brewer will be ready to brew another cup in about a minute.

**NOTE:** For iced beverages, only use a plastic cup. Do not use glass.

**CAUTION:** While brewing, there is extremely hot water in the K-Cup® pod holder. To avoid injury, do not lift the handle during the brewing process.

Illustrations may differ from actual product. We are constantly striving to improve our products; therefore the specifications contained herein are subject to change without notice.

## Brewer Features

**Strong Brew** increases the strength and bold taste of your coffee's flavor. For bolder coffee, press the **STRONG** button and select your brew size.

**Iced Coffee:** Brew hot over ice (do not use glass) and enjoy cold. Makes full-flavored and delicious iced coffee.

**Hot Water** on demand for instant soups and oatmeal.

**Smart Start** heats then brews in one simple process. No need to wait for the brewer to heat before selecting your brew size. Power on your brewer, place mug, insert a K-Cup® pod, and lower the handle. Then, select your brew size. The brewer will heat, then automatically begin brewing.

**Programming:** Press the settings button (ⓘ) and use the arrows to program the following settings:

**Tip:** Refer to the Use & Core Guide online for detailed programming instructions.

**Clock:** To use Auto On feature, set the time.

**Temperature Control** allows you to adjust the temperature from 187° – 192°.

**Auto On** sets your brewer to turn on at a specific time. When enabled, a sun icon ☀ will appear on the display screen.

**Auto Off** automatically turns your brewer off 2 hours after the last brew for energy savings. You can also program your brewer to shut off in 15 minute

increments after your last brew, or remain on all the time. A moon icon ☾ will appear on the display screen when Auto Off is enabled.

**High Altitude:** To ensure your brewer works properly at higher altitudes (5,000 feet), enable the High Altitude setting in the settings menu. When enabled, a mountain icon ⚓ will appear on the display screen.

**NOTE:** In high altitude mode the temperature is not adjustable. If you attempt to adjust the temperature, the mountain icon will flash indicating that you are in high altitude mode.

### Caring for your Brewer

Regular cleaning keeps your brewer running smoothly. Always be sure to turn off and unplug your brewer before cleaning. For detailed brewer cleaning instructions and videos visit support.keurig.com. Beyond these recommended cleaning instructions, this brewer is not user serviceable.

### Water Reservoir

The water reservoir lid and water reservoir should be cleaned periodically with a damp, soapy, non-abrasive cloth. Rinse the reservoir thoroughly after cleaning. This will ensure that no cleaning solutions remain in the area, as they may contaminate the water supply. After rinsing, fill the reservoir with clean water and return it to the brewer. Do not dry the inside of the water reservoir with a cloth as lint may remain.

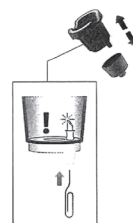

### Exit Needle

Remove the pod holder assembly and detach the funnel. Locate the exit needle on the inside bottom of the K-Cup® pod holder. Insert a straightened paper clip into the exit needle to loosen any coffee grounds.

### Entrance Needle

Lift the brewer handle and locate the entrance needle on the underside of the lid. To clean the holes in the needle, hold the brewer handle in the upward position and with your other hand, carefully insert a straightened paper clip into all the holes. Gently move it around to loosen any coffee grounds. Lower the handle completely and run two water-only brew cycles. Do not insert a K-Cup® pod.

**CAUTION:** There are sharp needles that puncture the K-Cup® pod above the K-Cup® pod holder and in the bottom of the K-Cup® pod holder. To avoid risk of injury, do not put your fingers in the K-Cup® pod holder.

## Coffeehouse taste in your own home.

### FIND YOUR PERFECT POD

With over 70 brands and hundreds of varieties, find your match at

[Keurig.com/New](http://Keurig.com/New)

### REFURBISHED PRODUCT LIMITED THIRTY DAY WARRANTY

The **Refurbished Product Service Center** offers the following WARRANTY to the ORIGINAL purchaser of a product which we have refurbished.

This product that has been refurbished is warranted against any electronic or mechanical defects for a period of THIRTY DAYS from the date of the original purchase by the consumer. Since this unit was sold as a refurbished item, the warranty does not apply to any cosmetic appearance items such as scratches. Should a defect occur, the **Refurbished Product Service Center** will repair or, at its option, replace defective unit/parts with new or rebuilt materials without charge for either parts or labor. Replacement unit/parts will be warranted for the remaining portion of the original warranty period.

This warranty does not cover installation or damage from accident, misuse, abuse, improper wiring, incorrect voltage, operating the unit against the instructions in the owner's manual or any product which has been opened, altered, or tampered with.

This warranty does not cover costs for removal and or installation of the unit for repair. Under no circumstances shall the service center be liable for any special, incidental or consequential damages or for any other expenses incurred by reason of use or sale of this product. This warranty is in lieu of any other warranties expressed or implied warranty of merchantability of fitness for particular use or otherwise.

This warranty gives the consumer specific legal rights and they may also have other rights which vary from State to State. Some States do not follow the exclusion or limitation of incidental or consequential damages, hence the above exclusion and limitations may not apply.

#### Refurbished Product Service Center

13225 Marquardt Avenue Santa Fe Springs, CA 90670

### WARRANTY REPAIR INFORMATION

If you need service on your unit during the 30 day warranty period; please go to [www.ConsumerServiceRefurbish.com](http://www.ConsumerServiceRefurbish.com) or call the Refurbished Product Service Center at 562-946-3531 to obtain the required claim number. Once you obtain your claim number, pack the unit properly (the original carton is ideal for this purpose) along with a copy of your purchase receipt.

Send the unit freight prepaid and insured to:

**Refurbished Product Service Center,**

**Att: Customer Service Department 13225 Marquardt Avenue Santa Fe Springs, CA 90670**

Your unit will be promptly exchanged and returned to you.

We will refuse to accept delivery of the returned unit unless the assigned claim number appears on the outside of the shipping carton.

#### Owner's Information

(Keep for your permanent records)

NAME: \_\_\_\_\_

ADDRESS: \_\_\_\_\_

CITY: \_\_\_\_\_ STATE: \_\_\_\_\_ ZIP CODE: \_\_\_\_\_

PHONE: \_\_\_\_\_ E-MAIL: \_\_\_\_\_

MODEL: \_\_\_\_\_ SERIAL NO.: \_\_\_\_\_

PRINTED IN MEXICO Elbrd: A.M  
SC: 08-09-2022\_TAB  
MODEL:K-Elite K90/Brushed Slate  
OBPN: DC0000001252 REV D



804106807

