

Please read this manual carefully before operating your unit and retain for future reference.

SAFETY INSTRUCTIONS

CAUTION: The laser used in the Drive can damage your eyes. Do not attempt to open the cover. To reduce the risk of electric shock, do not remove the cover (or back). There are no user-serviceable parts inside. Refer servicing to qualified service personnel. Use of controls or performance of procedures other than those specified herein may result in hazardous radiation exposure.

WARNING: To reduce the risk of fire or electric shock, do not expose this appliance to rain or moisture.

Slim External model Installation

DVD-ROM/ DVD-MULTI DRIVES

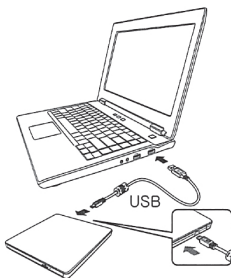

Connect the drive to the computer as shown in figure.
1 Connect the USB 2.0 cable to the drive.
2 Connect the other end of the USB 2.0 cable to your computer.

The drive may get its power from the PC USB power. All systems may not meet USB power requirements and full performance may not be achieved. In this case, connect to the USB power cable.

How to Connect with TV (A/V devices)

(Only support Slim External DVD-MULTI /BD DRIVES)

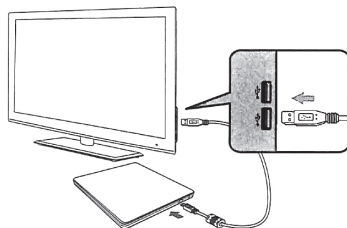

The image shown here is for illustrative purposes only and may be subject to change.

* This product is defaulted to ODD mode when it is powered on.

1. With the tray open, press and hold the 'Eject' button for 2 seconds.
(The LED indicator will turn on, switching to TV mode. Press and hold the button again for 2 seconds with the tray open to return to ODD mode).
2. Insert your supported media into the drive. The disc file system will be converted to FAT32 and will be recognized as USB flash memory.
3. Select and play the files from your A/V device to enjoy videos, pictures and music. Refer to your A/V device owner's manual for more information.

To install your product, visit: www.cyberlink.com and download the software that you need.



805001347

PRINTED IN MEXICO Elbrd: A.M.
OBPN:3840HW1018Z SC: 11-11-2022_2P SHNMDL:
GP63EX70

