

# Shark FREESTYLE

## CORDLESS VACUUM

### OWNER'S GUIDE

804109041

## IMPORTANT SAFETY INSTRUCTIONS

FOR HOUSEHOLD USE ONLY • PLEASE READ CAREFULLY BEFORE USE

If the charger plug does not fit fully into the outlet, reverse the plug. If it still does not fit, contact a qualified electrician. DO NOT force into outlet or try to modify to fit.

### ⚠ WARNING

To reduce the risk of fire, electric shock, injury, or property damage:

#### THE FLOOR NOZZLE, WAND, POD, AND HANDLE CONTAIN ELECTRICAL CONNECTIONS:

1. This vacuum consists of a motorized nozzle, wand, vacuum pod, handle, and hose. These components contain electrical connections, electrical wiring, and moving parts that potentially present risk to the user.
2. Before each use, carefully inspect all parts for any damage. If a part is damaged, discontinue use.
3. Use only identical replacement parts.
4. This vacuum contains no serviceable parts.
5. Use only as described in this manual. **DO NOT** use the vacuum for any purpose other than those described in this manual.
6. With the exception of filters, **DO NOT** expose any parts of the vacuum to water or other liquids.

#### GENERAL USE

7. This vacuum is not intended for use by anyone with reduced physical, sensory or mental capabilities, or lack of experience and knowledge, unless they have been given supervision or instruction concerning use of the appliance by a person responsible for their safety. Children should be supervised to ensure that they **DO NOT** play with the vacuum.
8. Always turn off the vacuum before connecting or disconnecting any current carrying hoses, motorized nozzles, chargers, batteries, or other electrical or mechanical parts.
9. **DO NOT** handle plug or vacuum with wet hands.
10. **DO NOT** use without dust cup, filters, and brushrolls in place.
11. Only use Shark® branded filters and accessories. Failure to do so will void the warranty.
12. **DO NOT** put any objects into nozzle or accessory openings. **DO NOT** use with any opening blocked; keep free of dust, lint, hair, and anything that may reduce airflow.
13. **DO NOT** use if nozzle or accessory airflow is restricted. If the air paths or the motorized floor nozzle become blocked, turn the vacuum off and remove the battery. Remove all obstructions before you reinsert the battery and turn on the unit again.
14. Keep nozzle and all vacuum openings away from hair, face, fingers, uncovered feet, or loose clothing.
15. **DO NOT** use if vacuum is not working as it should, or has been dropped, damaged, left outdoors, or dropped into water.
16. Use extra care when cleaning on stairs.
17. **DO NOT** leave the vacuum unattended while powered on.
18. When powered on, keep the vacuum moving over the carpet surface at all times to avoid damaging the carpet fibers.
19. **DO NOT** place vacuum on unstable surfaces such as chairs or tables.
20. **DO NOT** use to pick up:
  - a) Liquids
  - b) Large objects
  - c) Hard or sharp objects (glass, nails, screws, or coins)
  - d) Large quantities of dust (including drywall, fireplace ash, or embers). **DO NOT** use as an attachment to power tools for dust collection.

- e) Smoking or burning objects (hot coals, cigarette butts, or matches)
  - f) Flammable or combustible materials (lighter fluid, gasoline, or kerosene)
  - g) Toxic materials (chlorine bleach, ammonia, or drain cleaner)
21. **DO NOT** use in the following areas:
    - a) Poorly lit areas
    - b) Wet or damp surfaces
    - c) Outdoor areas
    - d) Spaces that are enclosed and may contain explosive or toxic fumes or vapors (lighter fluid, gasoline, kerosene, paint, paint thinners, mothproofing substances, or flammable dust)
  22. Turn off the vacuum before servicing the battery, as well as before plugging in or unplugging the charger.
  23. Turn off the vacuum before any adjustment, cleaning, maintenance, or troubleshooting. Such preventative safety measures reduce the risk of starting the appliance accidentally.
  24. During cleaning or routine maintenance, **DO NOT** cut anything other than hair, fibers, or string wrapped around the brushroll.
  25. Allow all filters to air-dry completely before replacing in the vacuum to prevent liquid from being drawn into electric parts.
  26. **DO NOT** modify or attempt to repair the vacuum or the battery yourself, except as indicated in this manual. **DO NOT** use the battery or vacuum if it has been modified or damaged. Damaged or modified batteries may exhibit unpredictable behavior resulting in fire, explosion, or risk of injury.

#### BATTERY PACK

27. The battery is the power source for the vacuum. Carefully read and follow all charging instructions.
28. To prevent unintentional starting, ensure the vacuum is powered off before picking up or carrying the vacuum. **DO NOT** carry the appliance with your finger on the power switch.
29. Use Charger XA1106N for 10.8V unit and Charger XA1106 FOR 14.4V unit
30. Keep the battery away from all metal objects such as paper clips, coins, keys, nails, or screws. Shorting the battery terminals increases the risk of fire or burns.
31. Under abusive conditions, liquid may be ejected from the battery. Avoid contact with this liquid, as it may cause irritation or burns. If contact occurs, flush with water. If liquid contacts eyes, seek medical help.
32. Battery should not be stored at temperatures below 37.4°F (3°C) or above 104°F (40°C) to maintain long-term battery life.
33. **DO NOT** charge battery at temperatures below 50°F (10°C) or above 104°F (40°C).
34. Store the appliance indoors. **DO NOT** use or store it below 37.4°F (3°C). Ensure the appliance is at room temperature before operating.
35. **DO NOT** expose the battery to fire or temperatures above 265°F (130°C) as it may cause explosion.
36. Follow all charging instructions. **DO NOT** charge the battery at temperatures below 50°F (10°C) or above 104°F (40°C). Charging improperly or at temperatures not in the specified range may damage the battery and increase the risk of fire.

## ASSEMBLING YOUR VACUUM

**TIP:** Before using vacuum, ensure the dust cup is securely in place.

**TIP:** Charge the vacuum fully before first use.

### HOW DO I KNOW WHEN THE VACUUM IS CHARGED?

The entire oval blue light around the power button flashes.

The unit is still charging.

One half of the oval blue light around the power button flashes.

The unit is fully charged.

#### STEP 1



1. Insert vacuum body into floor nozzle.

#### STEP 2

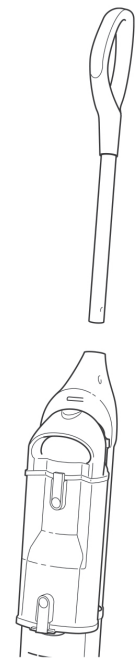

2. Insert handle pole into main body and secure by screwing in bolt (taped to handle during shipping).

#### STEP 3

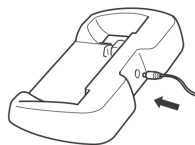

3. Insert the charging adapter plug by aligning the arrows on the plug and charging jack. Push in until it clicks into place.

#### STEP 4

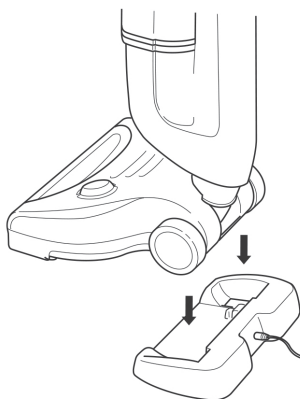

4. Place vacuum on precision charger base.

## USING YOUR VACUUM

**TIP:** The oval blue light around the power button will indicate which setting you are on.

On the high speed carpet setting, the vacuum will run for approximately 12 minutes.

On the lower speed bare floor setting, the vacuum will run for approximately 17 minutes.

1. Place foot on floor nozzle and tilt handle back.

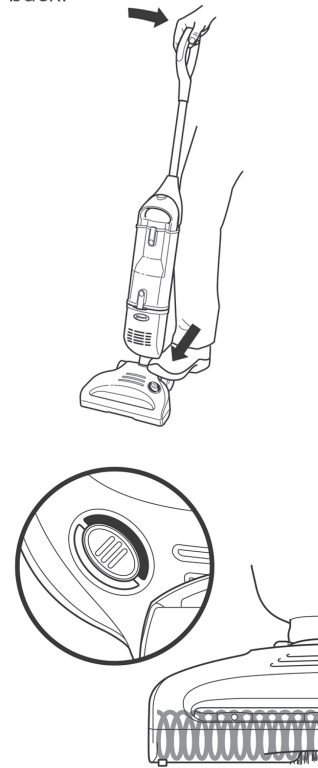

2. Press the power button once to turn on the carpet setting. The brushroll will spin quickly in this mode to get deep carpet cleaning.

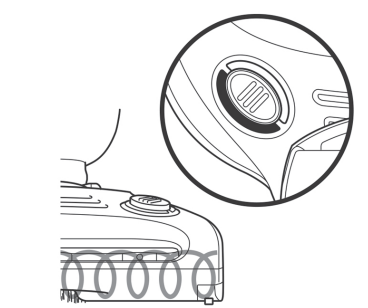

3. Press the power button a second time to turn on the bare floor setting. The brushroll will spin slowly in this setting to vacuum up all of the surface litter on carpet and bare floors. Press the power button a third time to turn off the vacuum.

## MAINTENANCE

To keep your vacuum's suction power optimal, follow these instructions. Turn off the power and remove the unit from the charger base.

**⚠ WARNING: DO NOT operate the vacuum with a wet filter.**

**DO NOT use a hair dryer or other forced hot air to dry the filter.**

**DO NOT operate vacuum without the filter in place.**

### RECOMMENDED CLEANING SCHEDULE:

**Dust Cup**  
Empty dust cup after every use or as debris approaches the MAX FILL line.

If the dust cup door does not swing open after pressing the release button, press down on the tabs on either side of the button to release the door.

**Foam Filter**  
XF1100T  
Clean the foam filter once per month.

#### STEP 1

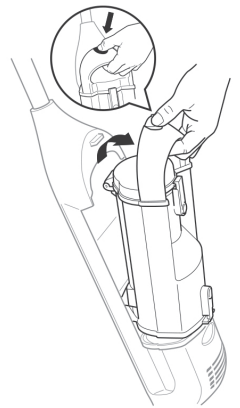

### EMPTYING THE DUST CUP

1. Press down on the dust-cup release button and lift dust cup out.

#### STEP 2

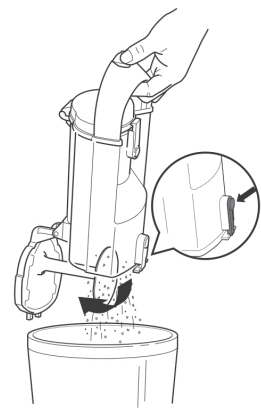

2. Hold dust cup over a trash bin and press the bottom dust-cup release latch.

#### STEP 3

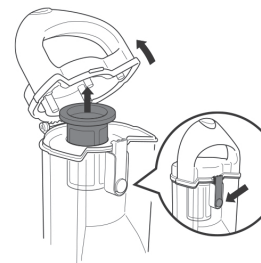

3. Press the top dust-cup release latch and pull up on handle. Lift out metal screen and clear debris.

#### STEP 1

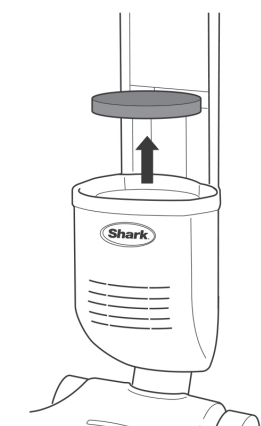

### CLEANING THE FILTER

1. Remove the dust cup, then remove the foam filter.

#### STEP 2



2. Hand wash filter with water only. Squeeze excess water out and allow filter to air-dry completely before returning filter to the unit.

**NOTE:** The images shown here are for illustrative purposes only and may be subject to change.

## SAVE THESE INSTRUCTIONS

### GETTING TO KNOW YOUR SHARK® FREESTYLE CORDLESS VACUUM WELCOME!

Congratulations on your purchase. Use this instruction manual to learn about your new vacuum's great features. From assembly to use to maintenance, you will find it all in here.

#### MAIN UNIT

- A** Handle
- B** Main Body
- C** Screw
- D** Dust Cup Release
- E** Upper Dust Cup Latch
- F** Dust Cup
- G** Lower Dust Cup Latch
- H** Motorized Floor Nozzle
- I** Power Button/Surface Selector
- J** Charging Adapter
- K** Precision Charger Base

**NOTE:** The images shown here are for illustrative purposes only and may be subject to change.

**NOTE:** Accessories may vary depending on the model.

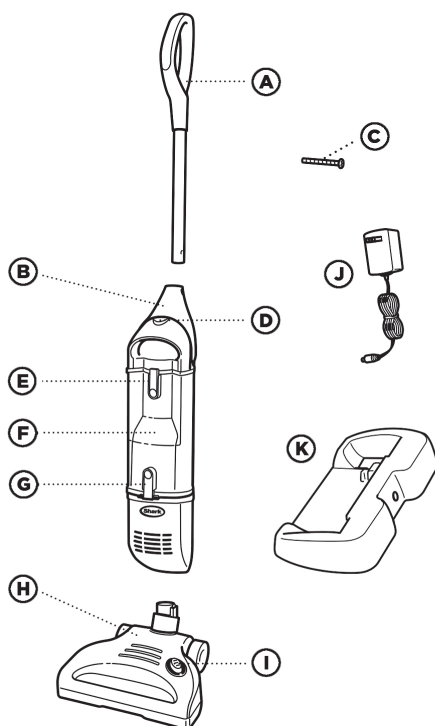

## MAINTENANCE

**TIP:** The brushroll is equipped with a raised cutting guide to easily cut hair and debris.

### STEP 1

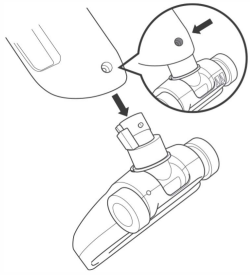

#### BLOCKAGES IN NOZZLE

1 Press the release button on the rear of the main body and remove the floor nozzle.

### STEP 2

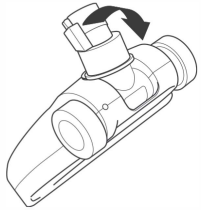

2 Pull back the neck of the floor nozzle to straighten the air passage and remove debris.

### STEP 3

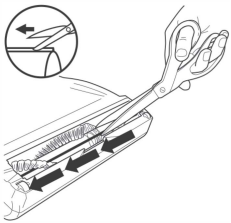

#### CLEANING THE BRUSHROLL

3 Flip the nozzle over to access brushroll. Use scissors to carefully remove hair and debris wrapped around the brushroll.

### STEP 4



#### BLOCKAGES IN MAIN UNIT

4 You can also check for blockages in the main body. Just remove floor nozzle and dust cup and shine a flashlight in the opening.

## BRUSHROLL REMOVAL AND INSERTION

### STEP 1



1 Use the edge of a coin to turn the dial near the brushroll access door to the unlocked position.

### STEP 2

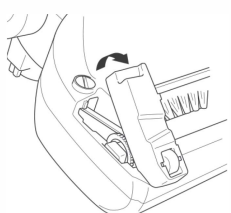

2 Remove brushroll access door.

### STEP 3

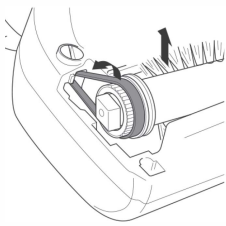

3 Slip black belt off of white gear and lift out brushroll to clean off debris.

### STEP 4

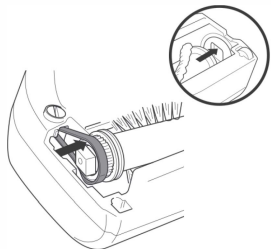

4 Once the brushroll has been cleaned, reinsert by slipping the black belt back onto the white gear.

### STEP 5

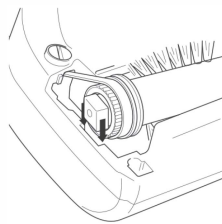

5 Align the white square at the end of the brushroll with the slot near the belt. Fit the square into the slot.

## BATTERY PACK REPLACEMENT & DISPOSAL

**WARNING:** This unit is powered by Ni-Mh batteries, which must be recycled or disposed of properly in accordance with state, federal and local laws.

If uncertain how to remove the battery pack, we suggest you take your vacuum to a reputable small appliance service technician to have this service performed.

**WARNING:** Never use ordinary batteries for replacement as these may leak and damage your vacuum. Use only the battery pack provided by SharkNinja for replacement.

**WARNING:** Do not store or charge in areas of high temperature or humidity.

#### Replacement Battery Part Number

10.8V XBT1106N :  
SV1110, SV1106N

14.4V XBT1106 :  
SV1112, SV1114, SV1115

#### Charging Adapter Part Number

10.8V XA1106N :  
SV1110, SV1106N

14.4V XA1106 : SV1112,  
SV1114, SV1115

#### MAXIMIZING THE LIFE OF YOUR BATTERY

1 This vacuum is equipped with an advanced feature that will shut off the vacuum when the battery is almost fully discharged. If the vacuum shuts off while in use, charge the unit until one half of the oval blue light around the power button flashes, indicating a full charge.

2 Charge the vacuum before initial use.

The charger monitors battery properties to extend battery life.

The entire oval LED light around the power button will flash every 2 seconds while the unit is charging. When the charge is complete, one half of the oval will flash every 2 seconds.

3 The precision charger monitors the batteries so you don't have to. Leaving the unit charging past the complete charge time will NOT harm the batteries.

4 If the vacuum has never been used or has not been used for an extended period of time, it will take 3 to 5 complete charge and run-down cycles to realize the full operational time of the vacuum.

5 Use only the charger adapter supplied with the unit : XA1106N for SV1106N, SV1110 (10.8 V) and XA1106 for SV1112, SV1114 and SV1115 (14.4V). If other chargers are used, the battery can fail, causing damage to the

### STEP 1

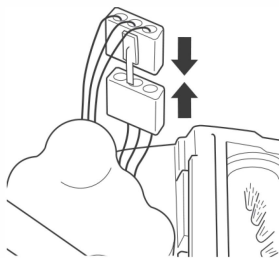

1 Push the connector terminals together until they lock into place.

### STEP 2

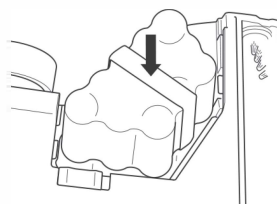

2 Place the new battery pack into the battery compartment, taking care to tuck the wiring completely so that it does not interfere with the battery access door.

### STEP 3

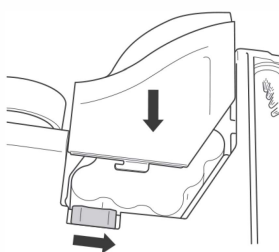

3 Place the battery door onto the bottom of the nozzle, slide it back into place and move the sliding tab next to the door to the lock position.

**NOTE:** The images shown here are for illustrative purposes only and may be subject to change.

## TROUBLESHOOTING GUIDE

**WARNING:** To reduce the risk of shock and unintended operation, turn power off and unplug unit before servicing.

**Vacuum is not picking up debris. No suction or light suction.** (Refer to Maintenance section for more information.)

- Check filters to see if they need cleaning. Follow instructions for rinsing and drying the filters before re-inserting in the vacuum.
- Dust cup may be full; empty dust cup.
- Remove any string, carpet fibers, or hair that may be wrapped around the brushroll.
- Check for blockages in the dust cup filter and floor nozzle.
- Make sure that the battery is fully charged.

**Vacuum will not operate.**

- The battery may be depleted. Charge the vacuum until half of the oval light flashes, indicating full charge.
- The brushroll may be jammed. Turn the unit off and allow it to cool down for 10 seconds.
- Ensure nothing is blocking the motorized brush or wrapped around the brushroll.

**Charging Indicator does not illuminate.**

- Check to see if the charge adapter is plugged in properly to the outlet and to the charging jack.
- Ensure there is no debris accumulated on the metal charge contacts on the floor nozzle or charging adaptor.
- Ensure that the electrical outlet is supplying power to the charger.

**Motorized brush will not work.**

- The floor nozzle may have blockage; See "Clearing Blockages".
- Ensure that the floor nozzle is properly attached.

**Dust escapes from vacuum.**

- Empty the dust cup container.
- Ensure that the filter is inserted completely into its holder below the dust cup.
- Check for punctures in dust cup filter or cracks in the dust cup and replace if necessary.

**Vacuum turns off on its own.**

- Charge the unit until half of the oval flashes, indicating a full charge.

**Run Time has decreased over time.**

If you experience shorter run time over the life of the vacuum, perform the following battery reconditioning steps. These steps can also be performed as monthly maintenance for maximum battery life.

- Make sure the vacuum is fully charged.
- Run vacuum until it turns itself off.
- Fully charge the vacuum again.